

ART. MVTTWINFC
ART. MVTTWINFCUS

For spare parts
R114952

refer to user manual
"ADJUSTING BRAKE
FORCE"

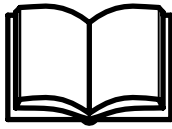

R114968

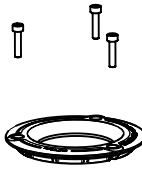

R114956



R545,07

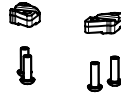

R114967



included in
R1149100

R114938



included in
R1149100



R3,2336
Exagonal 3mm



R114999
set of 3

R1149100

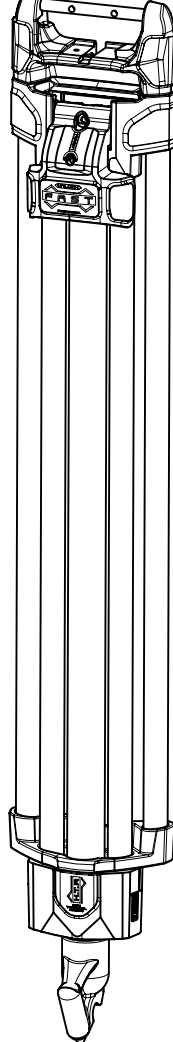

1149100L
assembled leg with laser

included in
R1149100

R114952

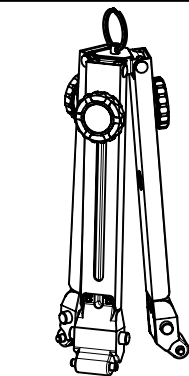
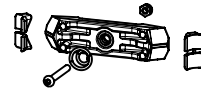

art. MVASPRM

included in
R1149100



R114944

LEG MAINTENANCE SPARE PARTS AT PAGE 2:
MANFROTTO SERVICE CENTER PROVIDE
PROFESSIONAL MAINTENANCE ON THE LEG.
PLEASE REFER TO THEM

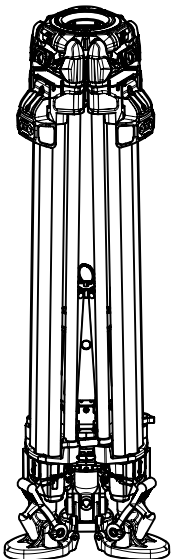

RE114943



BOX

FOR MVTTWINFC
see RI,500,18,13 set of 4

FOR MVTTWINFCUS
see RI,500,18,14 set of 4



Manfrotto
Imagine More

ART. MVTTWINFC

ART. MVTTWINFCUS

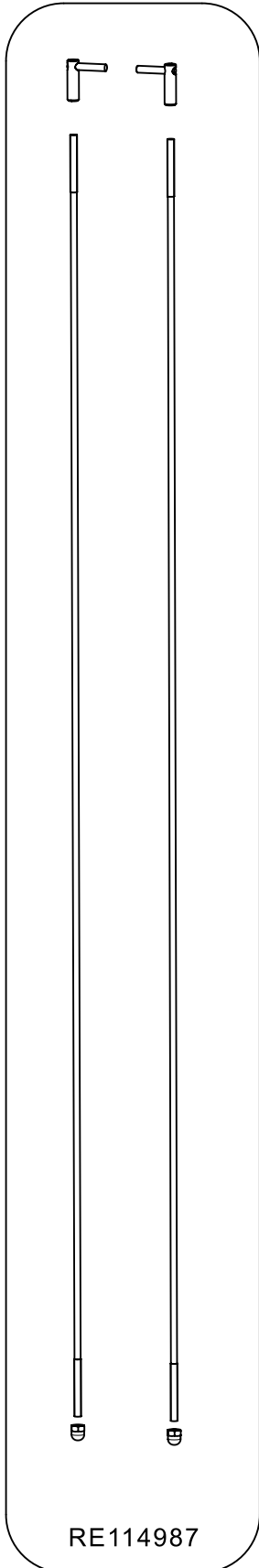

RE114987

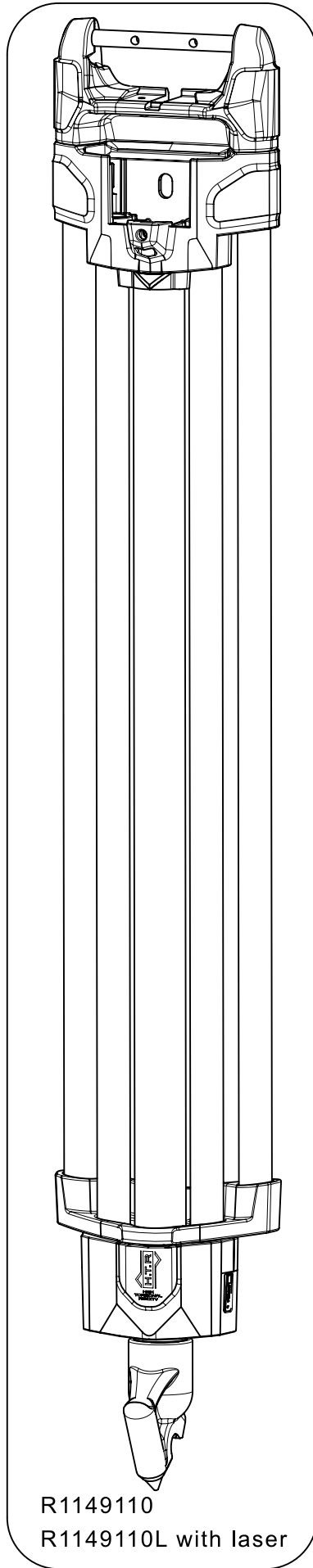

R1149110
R1149110L with laser

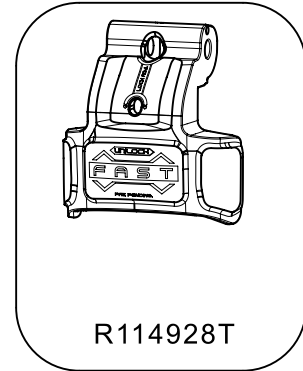

R114928T

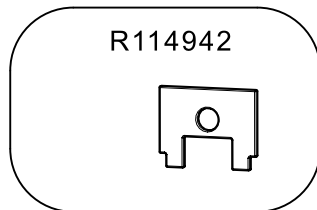

R114942

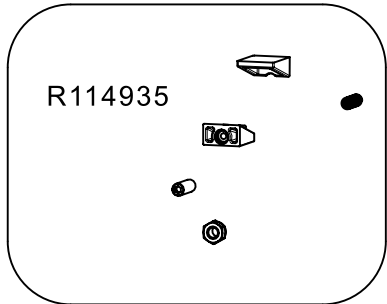

R114935

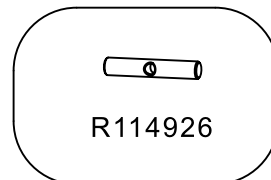

R114926

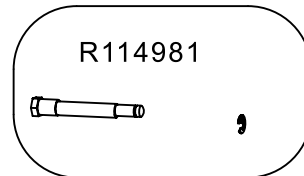

R114981

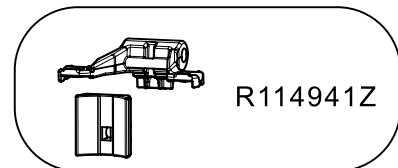

R114941Z

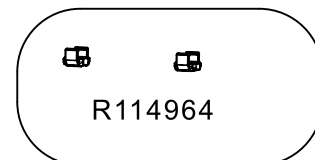

R114964

FOR ANY MANTEINANCE ON THE LEG
IS HIGHLY RECOMMENDED TO REFER TO A
MANFROTTO SERVICE CENTER