

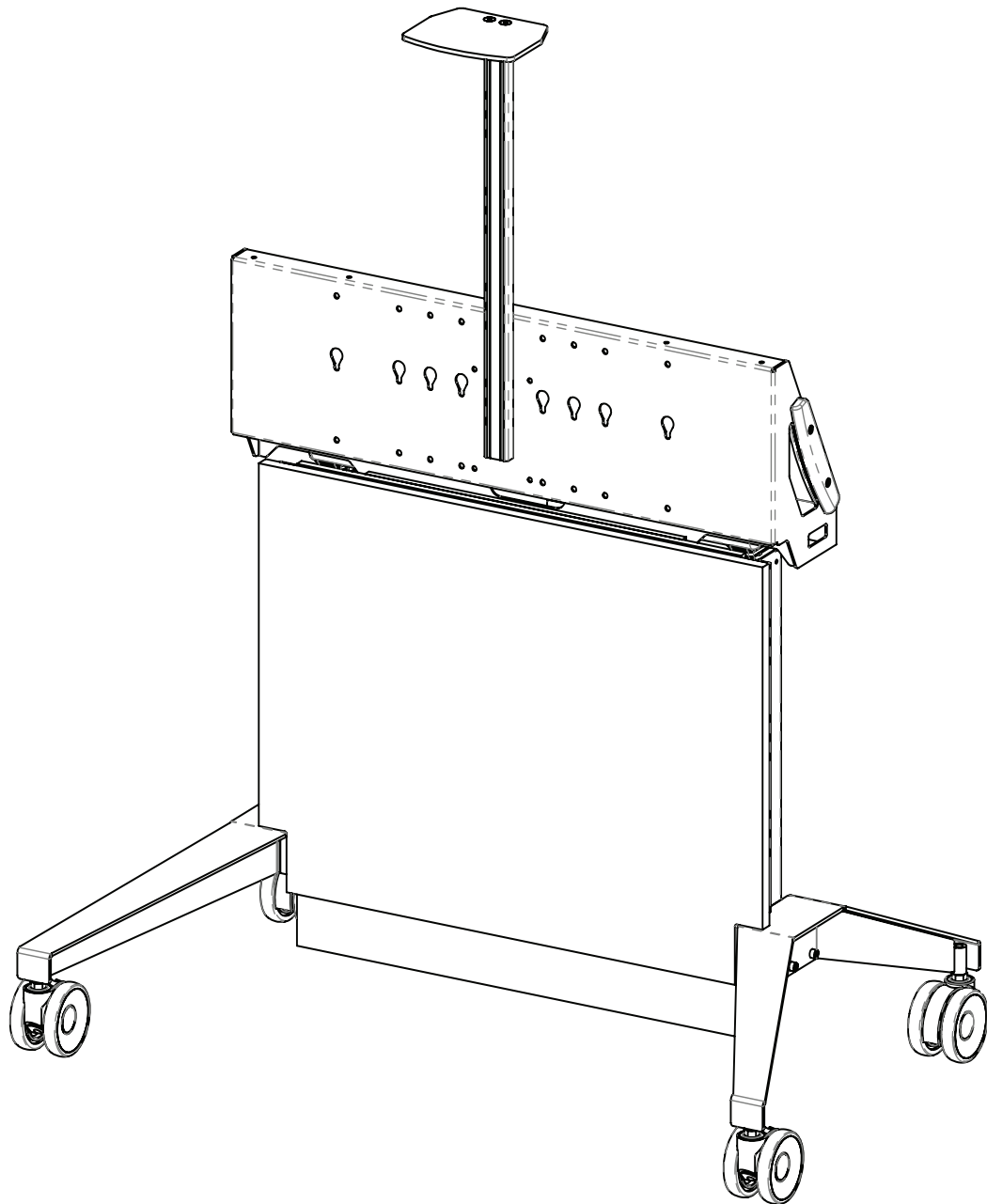

ASSEMBLY INSTRUCTIONS

FPS – CAMERA MOUNT



PARTS

ID	QTY	PART NUMBER	DESCRIPTION
A	(3)	300-560	1/4-20 Flat Nut
B	(2)	300-485	1/4-20 x 1/2" Head Socket Screw
C	(2)	300-542	5/16-18 x 1.5" Joint Connector Bolt
D	(2)	301-240	Double sided Tape 1X2
E	(1)	400-080	5/32" Hex Key
F	(1)	301-845	Camera Mounting Post
G	(1)	203-740	Single Camera Shelf
H	(1)	203-745	Dual Camera Shelf
I	(4)	300-470	5/16" Flat Washer
J	(4)	300-575	1/4 - 20 x 5/8" Button Head Screw
K	(4)	300-468	1/4" SAE Flat Washer
L	(1)	303-855	Universal Mounting Bracket

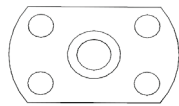

A

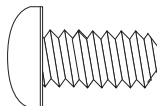

B



C



D



E

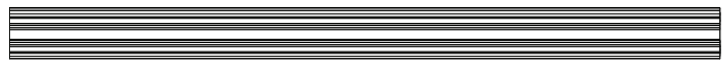

F

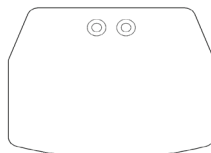

G

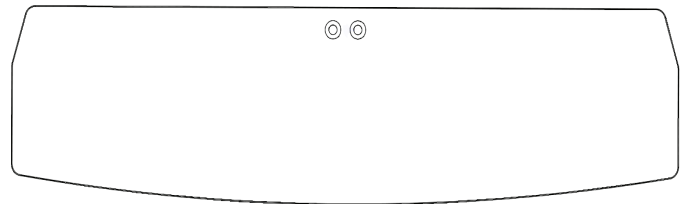

H

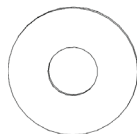

I

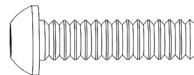

J

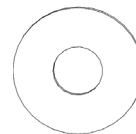

K

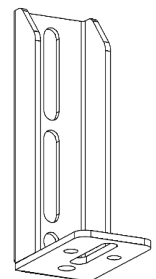

L

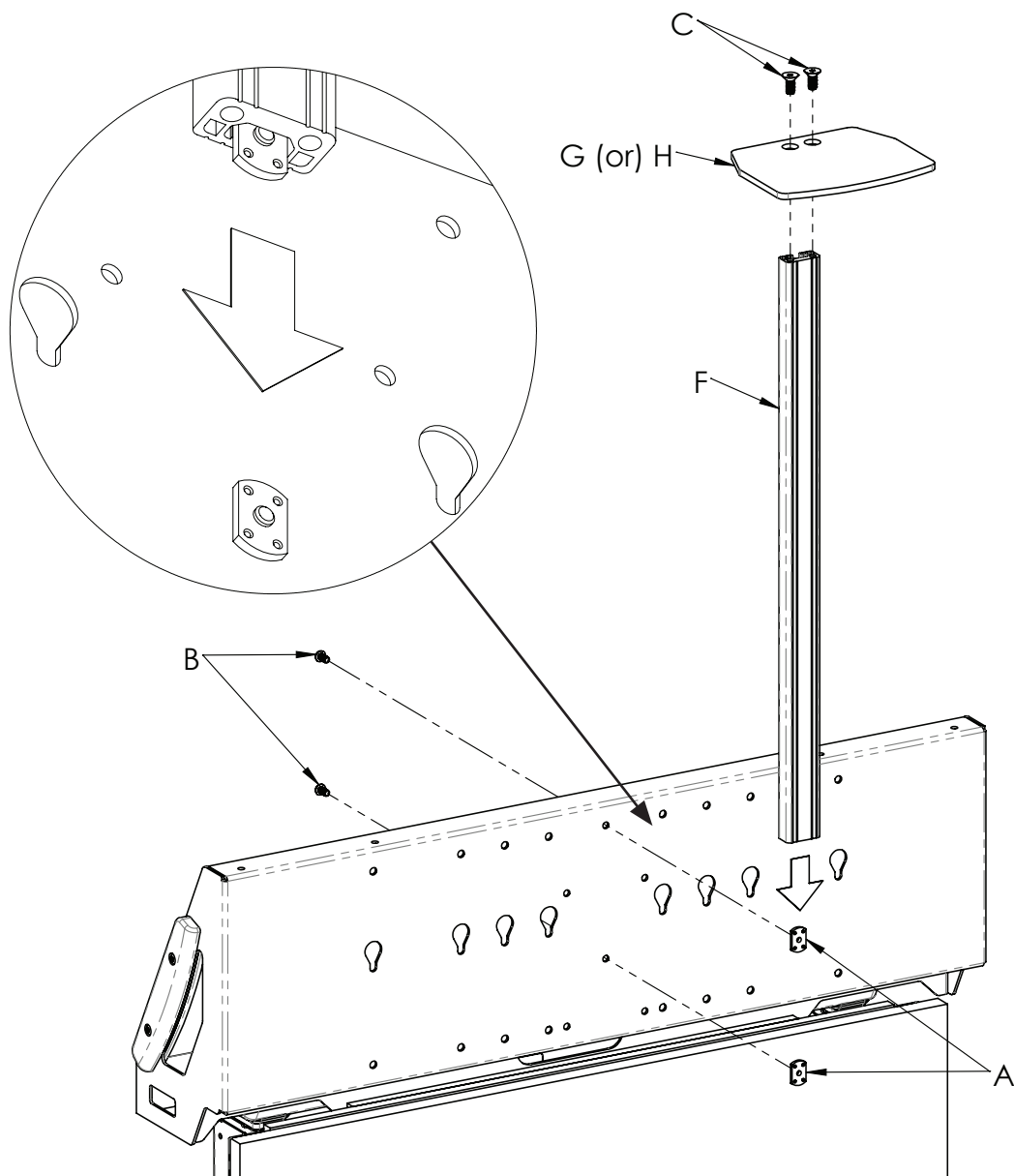

- From the rear of the header, connect the 2 (B) screws loosely to the 2 (C) Weld Nuts. Do not tighten.
- Slide the open side of (F) Mounting Posts over the Weld Nuts so that the Weld Nuts are captured inside of the Mounting Posts. With Mounting Posts at desired position, tighten screws using Hex Key (A)
- Install Bracket (E) to bottom of Mounting Posts and secure with screws (F).
- Align Speaker mounting locations with Mounting Bracket slots (fasteners not included).

FOR USE ON FPS ELECTRIC LIFT WALL STAND

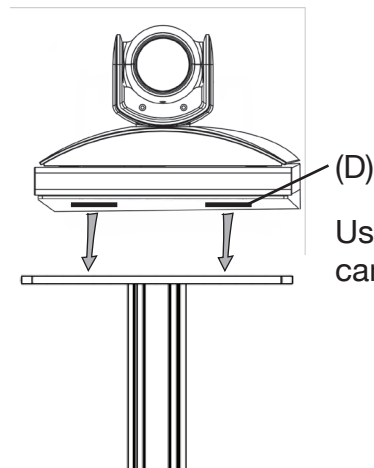
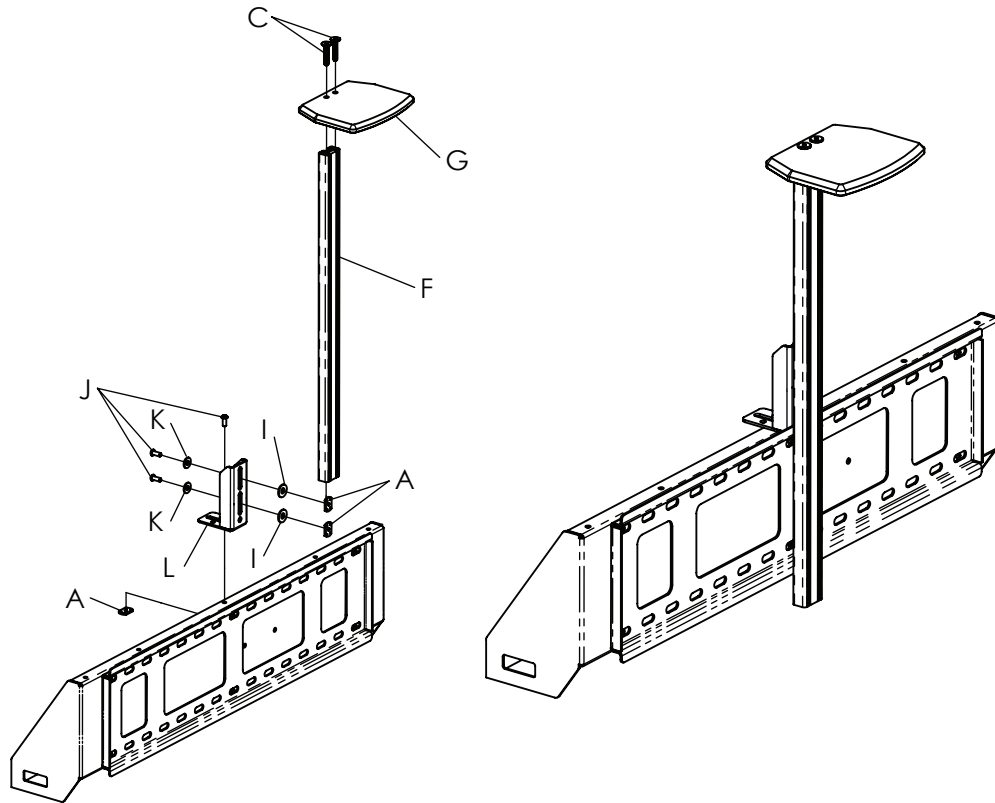

Use double side tape (D) to secure camera from sliding off shelf.



**SALAMANDER
DESIGNS**

LIMITED WARRANTY FOR COMMERCIAL VIDEO DISPLAY STANDS AND MOUNTS

Salamander is proud to stand behind our products with industry-leading warranties. Should you ever encounter any problem with your Salamander product, let us know. We are here to make it right. 1.800.535.5659 - 860.761.9500

Full warranty including limitations and warranty claim information may be found at www.salamanderdesigns.com/commercial/warranty