

# 220-240V LVC-IV Low Voltage Control Module

Part # 121226

## Overview

The LVC-IV module contains a 3-screw terminal block for a low-voltage wall switch, an IR receiver jack, a built-in RF receiver, two-RJ25 ports for RS232 / RS485, a low-voltage relay port with cable and a user-serviceable 3.15 Amp fuse. **Compatible components for each are listed below.**

### Uses

IR (Infrared)  
Remote Control

RJ25 Ports for  
RS-232/RS-485  
Communication

Low-Voltage Wall Switch

“Dry” Contact Closure

RF (Radio Frequency)  
Remote Control

3rd Party Control  
Control systems employing “dry”  
contacts or Serial Communication.

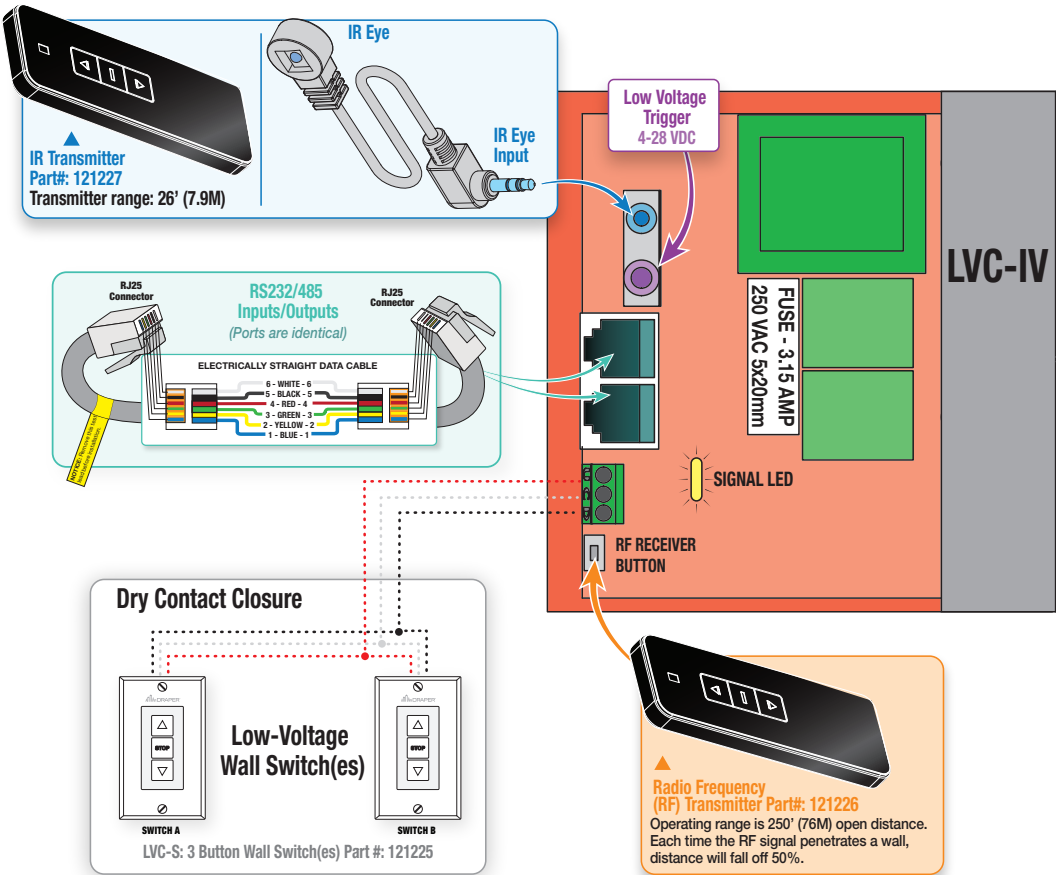

The 230V LVC-IV also used as a Single-Pole, Double-Throw dry closure to control equipment by the same means listed above.

COMPATIBLE COMPONENTS		PART NO.
IRT / R	Infrared Remote Control (Connects to IR Port)	121228
WRT / R	Radio Frequency Remote (antenna built in)	121226
LVC-S	Low-Voltage Wall Switch.	121225
	Low-Voltage Wall Switch w/ Locking Cover	121232
KS-1	Power Supply Key Switch.	121017
SP-KSM	3-position Momentary Key Switch (Please Note: 'Stop' won't work)	121022
Auxillary Control	Control systems employing “dry” contacts or Serial Communication.	By Others

CONTACTS:	Emulates Single-Pole, Double-Throw. Maintained for approx. 3 minutes.
RATING:	Input: 230 VAC +/- 10%, 50/60 Hz
	Output: 230 VAC, 3.15 Amps, 50/60 Hz. Fused with 250 VAC, 3.15 Amps
	CE Certified

