



Dell Pro 5 Webcam 2K

WB526

User's Guide

Notes, cautions, and warnings

 **NOTE:** A NOTE indicates important information that helps you make better use of your product.

 **CAUTION:** A CAUTION indicates either potential damage to hardware or loss of data and tells you how to avoid the problem.

 **WARNING:** A WARNING indicates a potential for property damage, personal injury, or death.

Contents

What's in the box	4
Overview	5
Specifications and system requirement	6
Setting up the webcam	7
Features	9
Document View	10
Object Focus	11
Securing your webcam using Kensington lock (optional)	12
Setting up Windows Hello	13
Software Support	16
Dell Display and Peripheral Manager	16
Dell Device Management Console	17
Frequently asked questions	18
Troubleshooting	19
Statutory information	20
Getting Help	21
Contacting Dell	21
Revision History	22

What's in the box

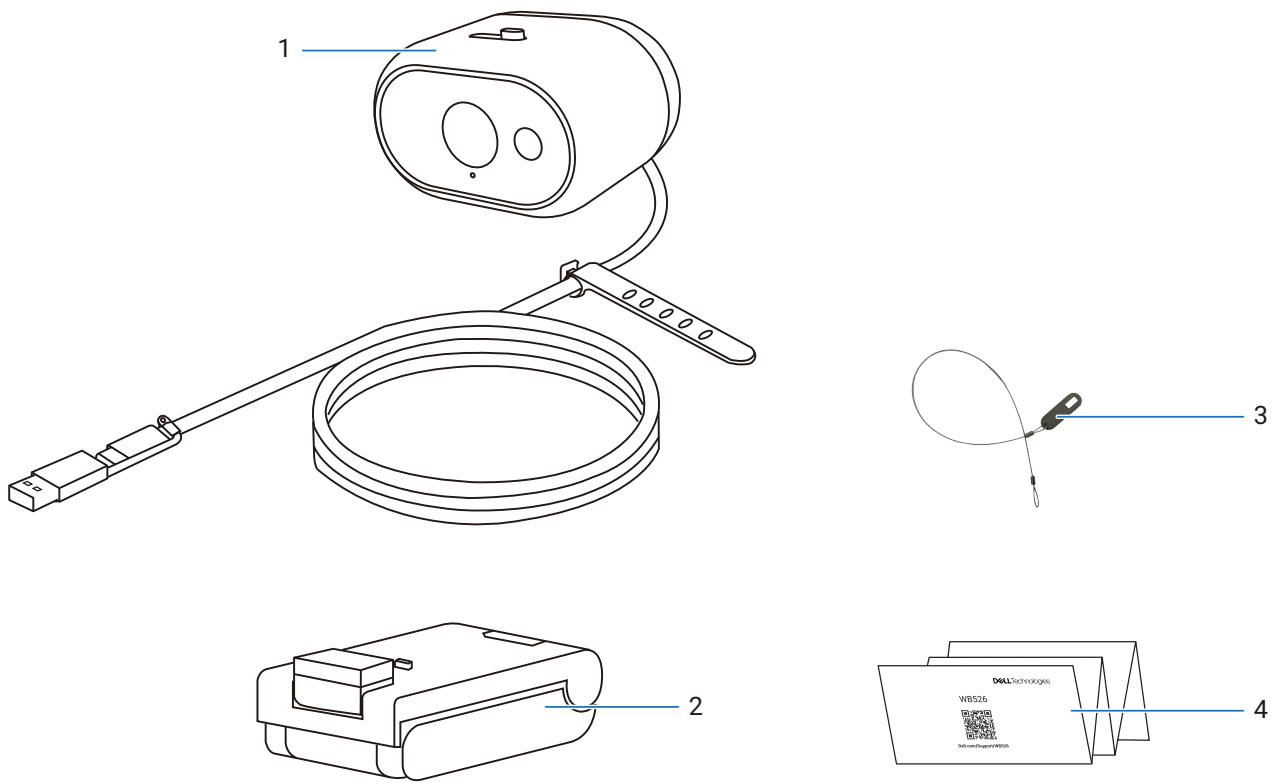

1. Dell Pro 5 Webcam 2K - WB526 (USB Type-C to USB Type-C cable with USB Type-A adapter and cable tie, 1.5 m)
2. Webcam mount
3. Security metal loop
4. User documentation

Overview

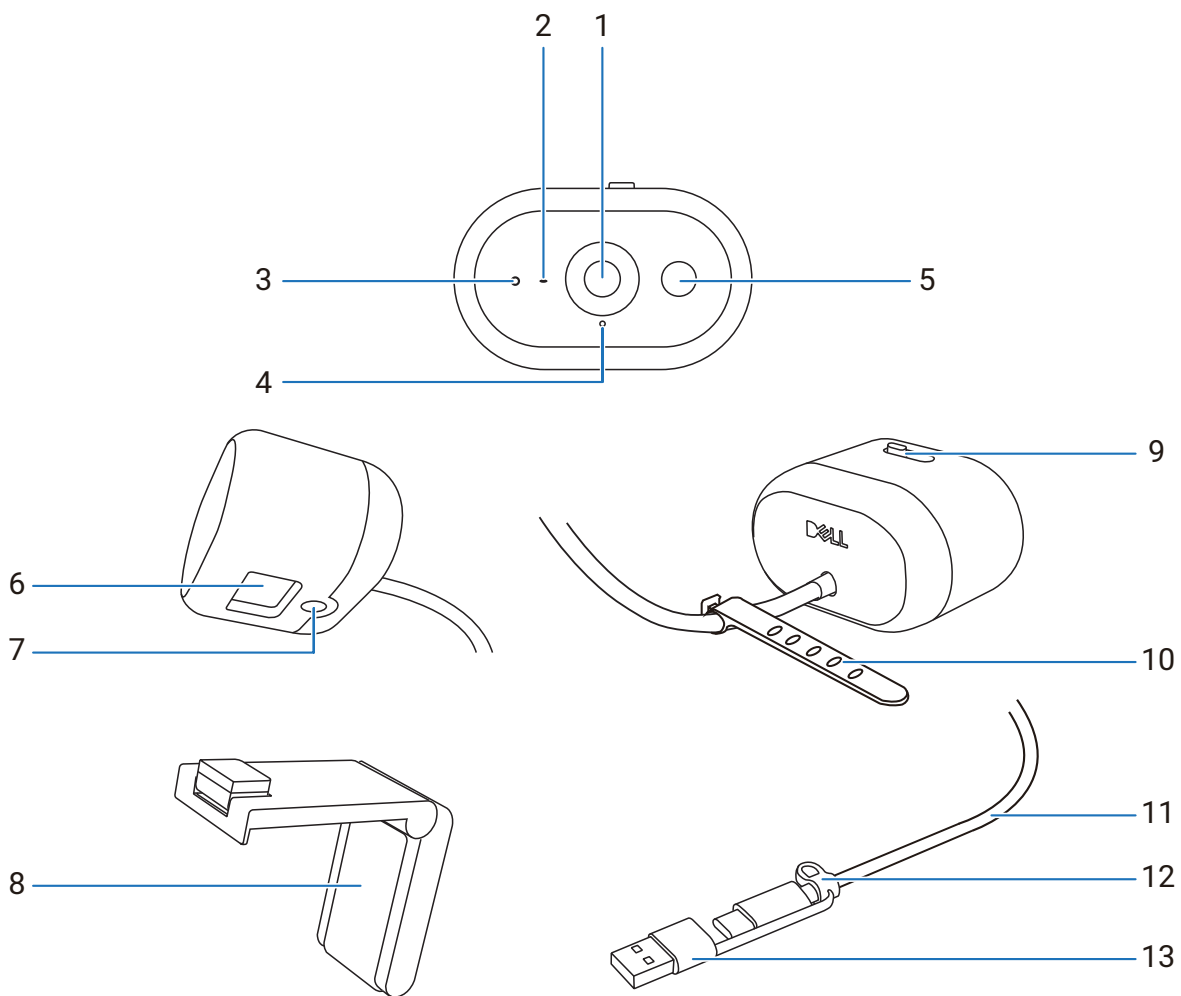

1. Multi-element lens and Sony sensor
2. LED light indicator
3. IR LED
4. Microphone
5. IR camera
6. Slot for webcam mount
7. Tripod-adaptor thread

8. Webcam mount
9. Integrated privacy shutter
10. Cable tie
11. USB-C cable
12. Interface for security metal loop
13. USB Type-C to USB Type-A adapter

Specifications and system requirement

Webcam camera stream data	USB 2.0 cable
Stream video encoding engine	MJPEG encoding engine
Video format supported	2K QHD at 30 fps Full-HD at 30 fps HD at 30 or 60 fps
Field-of-View	65°/78°
Focus	Auto
Zoom	2x digital zoom
Image processing	Smart exposure High dynamic range Auto white balance
Windows Hello facial recognition	Yes (anti-spoofing capable)
Object Focus	Yes (via gesture control)
Document view	Manual distortion correction
Auto-Framing	Yes
Certification	Microsoft Teams, Zoom
Microphone*	Omni-directional Pick-up range up to 2m * Microphone is enabled via Dell Display and Peripheral Manager software.
LED indicators	Solid White: Camera is in use Solid Green: Camera not in use, mic is in use (unmuted) Blink White (6 cycles): Camera is in use, privacy shutter is closed Blink White (repeat): Firmware update
Supported operating system	Windows 11, 64-bit Mac OS 14 and higher
Operating temperature (maximum)	The webcam can operate at a maximum ambient temperature of 40°C

Setting up the webcam

Setting up your webcam on a monitor

- NOTE:** It is recommended to have an active internet connection on your computer for the best setup experience.
- NOTE:** Download the Dell Display and Peripheral Manager from www.dell.com/support/WB526/downloads.

- Align and insert the webcam-mount head into the webcam-mount slot.

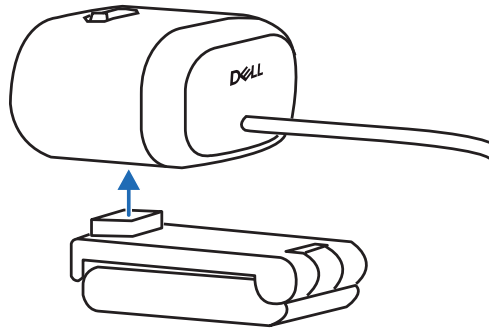

- Open the webcam mount and place the webcam on the monitor bezel. Adjust the base at the back of the monitor to ensure the webcam is attached firmly.

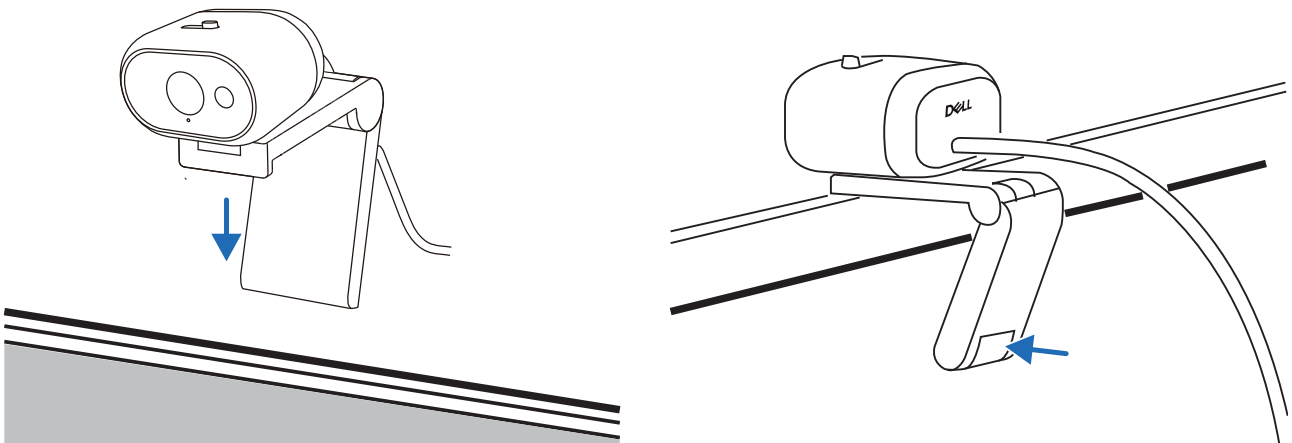

- Connect the USB Type-C cable to the USB Type-C port on your computer, desktop or monitor.
 - NOTE:** A USB Type-C to USB Type-A adapter is provided in the box for alternative connection to the USB Type-A port.
- Adjust the webcam to find the best framing for your video meetings.
 - NOTE:** Slide the privacy shutter right to open before use, and slide left to close when not in use.

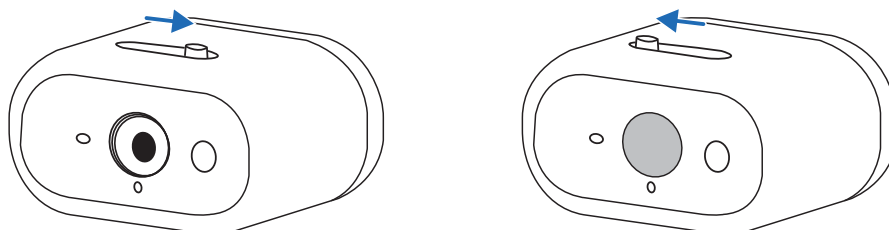

- Follow the instructions on the screen to customize the webcam setting via Dell Display and Peripheral Manager software.

Setting up your webcam on a tripod

i NOTE: Tripod is not included in the box.

1. Align the tripod mount thread on the webcam with the mounting screw on the tripod. Rotate the tripod adapter until it is firmly fixed on the tripod.

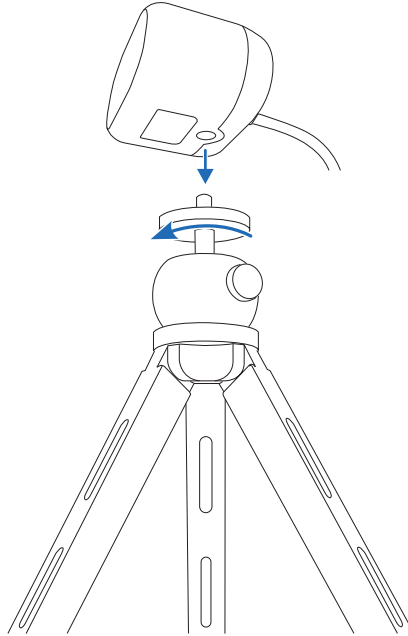

2. Connect the USB Type-C cable to the USB Type-C port on your computer, desktop or monitor.
- i NOTE:** A USB Type-C to USB Type-A adapter is provided in the box for alternative connection to the USB Type-A port.
3. Follow the instructions on screen to customize the webcam setting via Dell Display and Peripheral Manager.

Features

The Dell WB526 webcam offers a wide range of enhanced features to deliver an outstanding image quality. These features can be customized, enabled and disabled on Dell Display and Peripheral Manager software.

1. AI-powered Image Enhancements:

Smart Exposure with face and scene-based multi-detection, HDR and Auto-White Balance for an elevated conferencing experience.

2. Windows Hello certified:

Secured personal biometric facial sign-in with anti-spoofing capability.

3. Anti-theft interface:

Kensington lock compatible security metal loop for theft prevention.

4. Field of View:

Adjustable views up to 78 degree.

5. Gesture Control:

Detect human palm and zoom-in to a focused object view.

6. Document View:

Distortion correction capability for document/sketchbook view.

Document View

Effortlessly project physical item in a virtual call by tilting the camera down to present sketches, objects and documents. The Document View feature requires users to download and use Dell Display and Peripheral Manage (DDPM) software.

To begin, open DDPM application and tilt the camera down to show your desktop.

1. Open DDPM application, enable Manual under Document View and place the document in the center.
2. Click "Capture" and adjust the 4 dots to align with the document boundaries.
3. Click "Apply Document View" to apply distortion correction.
4. Repeat step 2 again to re-initiate the feature.

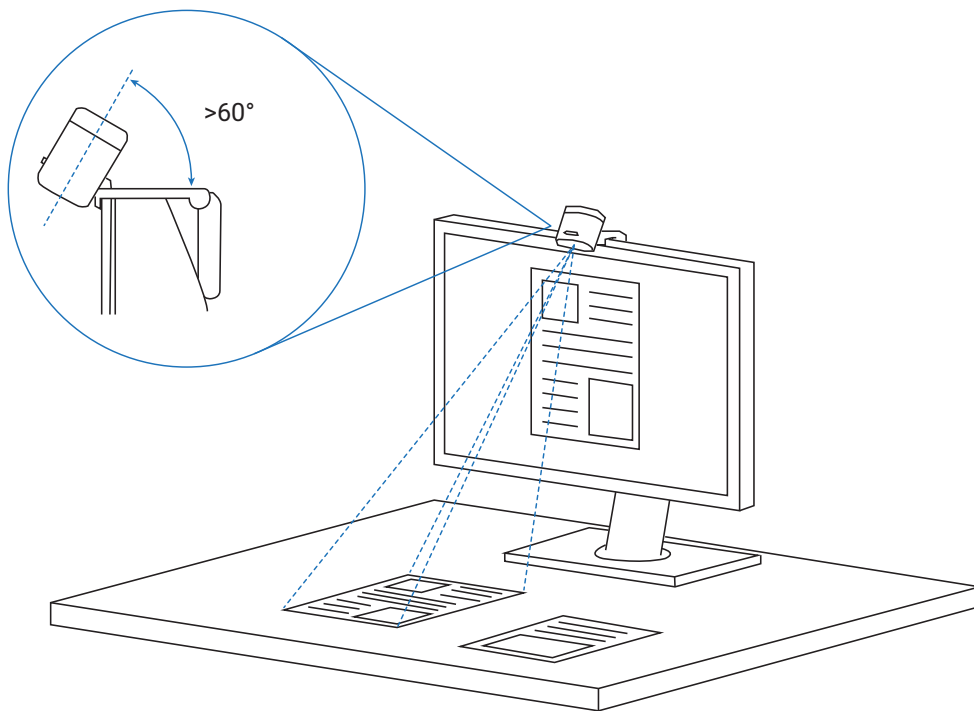

Object Focus

Enhance focus on a certain object or area in your webcam's view.

The Object Focus feature requires users to download and use Dell Display and Peripheral Manager (DDPM) software.

NOTE: This feature may be used on conference calls, but it may not be compatible with screen-sharing settings and layout options.

Gesture Control

1. Enable Gesture Control at DDPM under Object Focus.
2. Start object framing by showing your open palm to the webcam (keep your hand vertical and stationary up to 2 seconds).
3. Picture-in-picture insert allows a secondary view for continuous engagement and flexible viewing.
4. Stop object framing by showing your open palm to the webcam (keep your hand vertical and stationary up to 1 second).

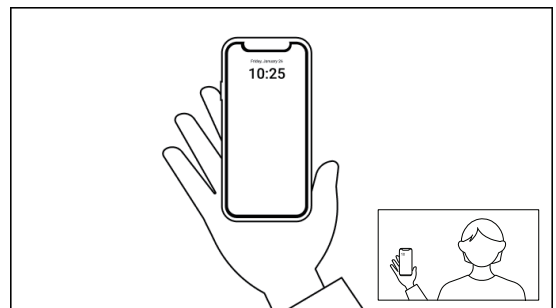
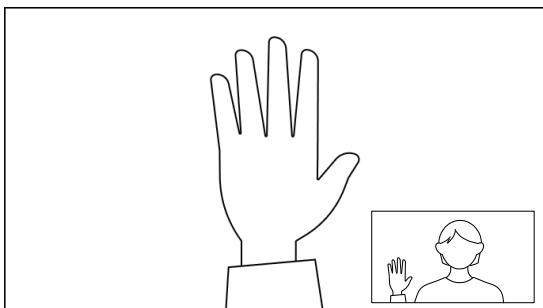
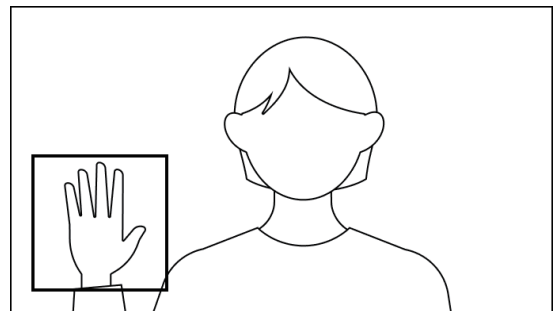
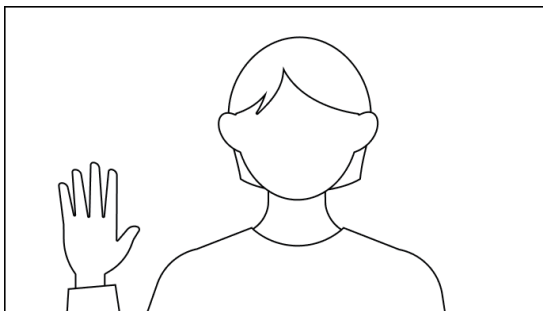

Securing your webcam using Kensington lock (optional)

A metal security loop designed for use with a Kensington lock is utilized together with the device's security lock slot to prevent unauthorized movement of the webcam.

Secure both your webcam and monitor to a stable surface using a Kensington security lock.

For detailed instructions on using the Kensington lock (sold separately), refer to the documentation provided with the lock.

i NOTE: The image is for illustration purposes only. The appearance of the lock may differ.

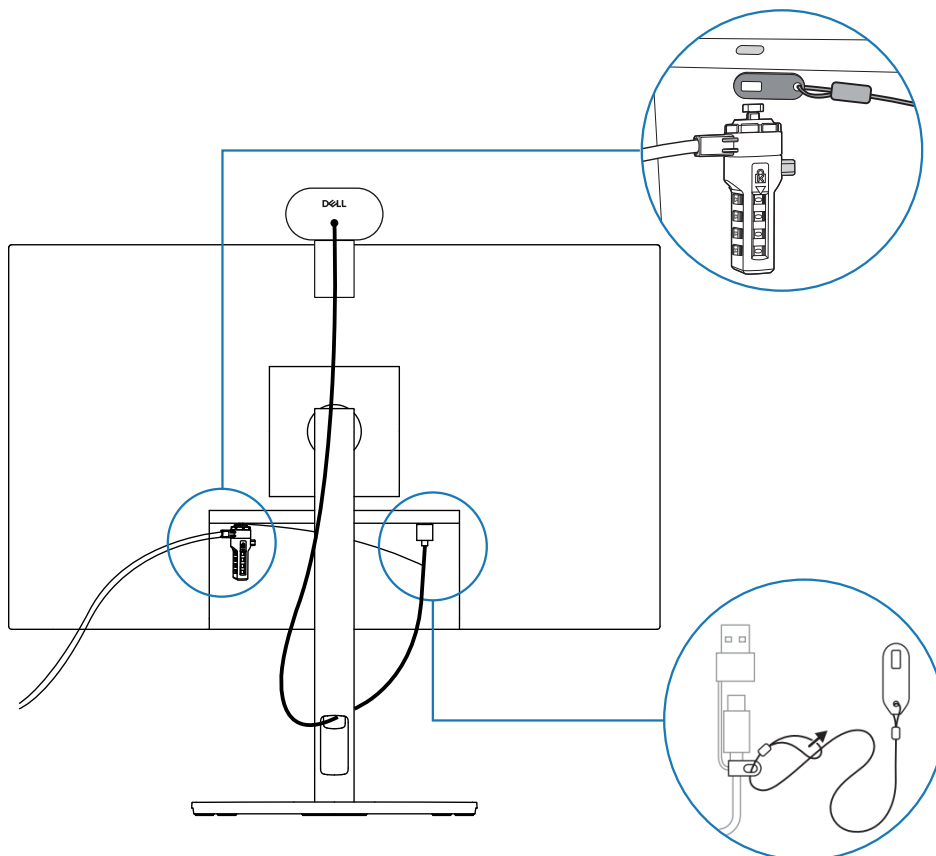

Setting up Windows Hello

In Windows® 10/Windows® 11:

Click Windows start menu, click **Settings**.

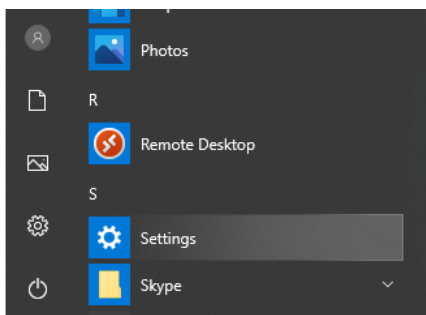

Click **Accounts**.

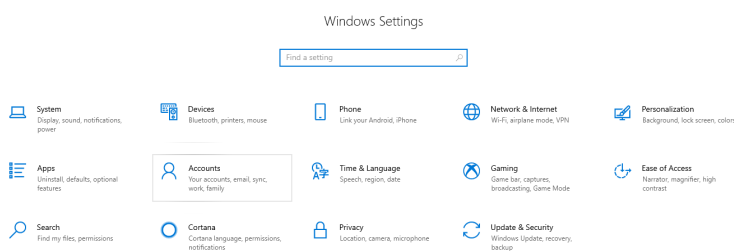

Click **Sign-in options**. You must set up a PIN before you can enroll in Windows Hello.

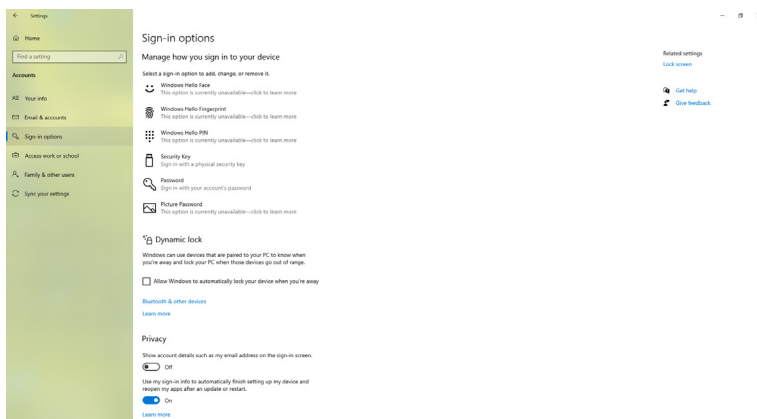

Click **Add** under **PIN** enter to **Set up a PIN**. Enter New PIN and Confirm PIN, and then click **OK**.

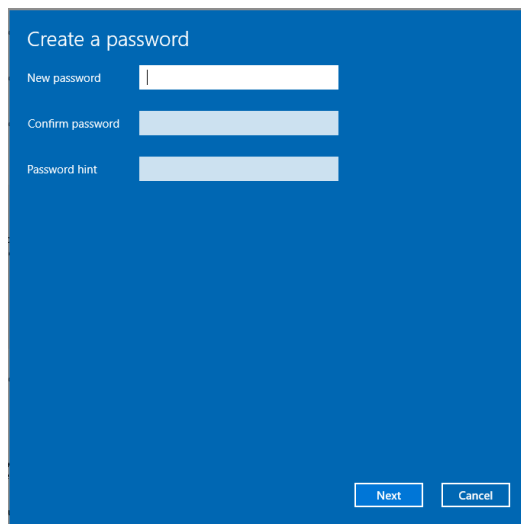

Once you've done that, the options to set up Windows Hello will unlock. Click **Set up** under **Windows Hello**, enter to **Windows Hello setup**.

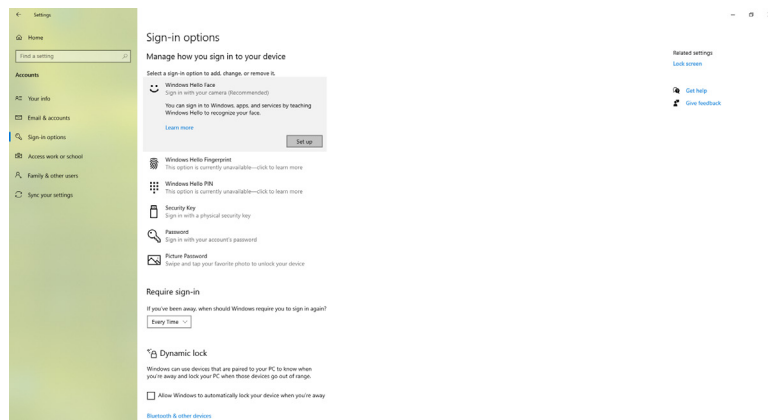

The following message is displayed, click **Get started**.

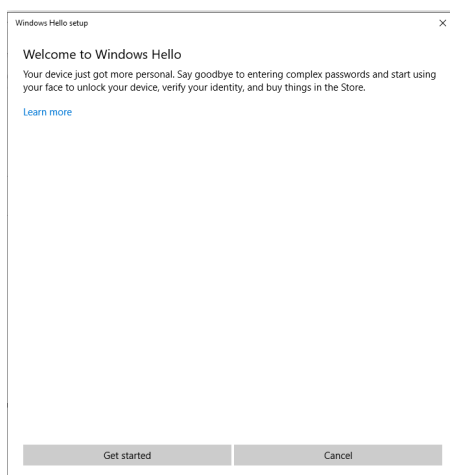

Keep looking directly at your screen and position yourself so that your face is in the center of the frame that appears on screen. The webcam will then register your face.

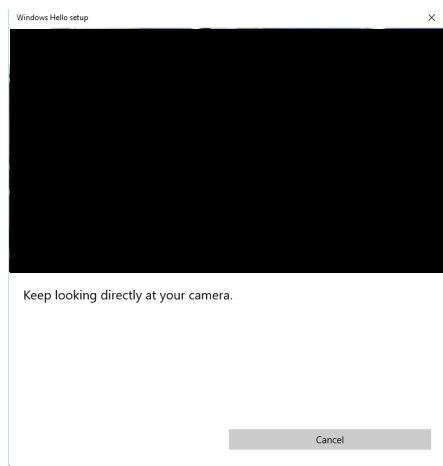

When the following message is displayed, click Close to exit **Windows Hello setup**.

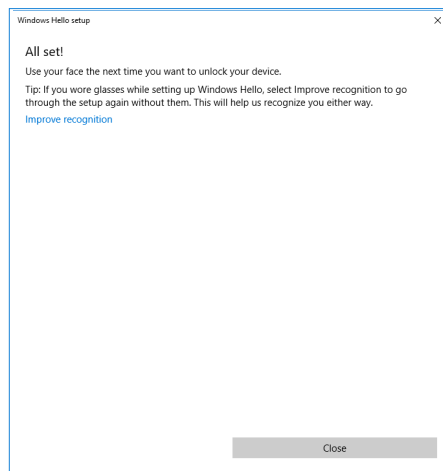

Once you have set up, you have another option to improve the recognition. Click **Improve recognition** if necessary.

Software Support

Dell Display and Peripheral Manager

Dell Display and Peripheral Manager is an app that helps you set up and configure your Dell monitors and peripherals. With this app you can make changes to settings of the device and provides additional customization like enabling HDR, AI Auto Framing, adjusting Field of View to 68.4x Zoom, enabling the microphone and more.

For mac OS users, the application supports most of the webcam customization features excluding Presence Detection, ExpressSign-In, Capture and Auto Installation.

Installing Dell Display and Peripheral Manager

When you connect the device to your computer for the first time, you will be prompted to download and install the app on Windows OS.

NOTE: If you are a macOS user or the download prompt does not appear within a few minutes, you can manually install the software from Drivers & Downloads tab on www.dell.com/support/WB526/downloads.

For more details, please refer to the Dell Display and Peripheral Manager User Guide in the documentation tab.

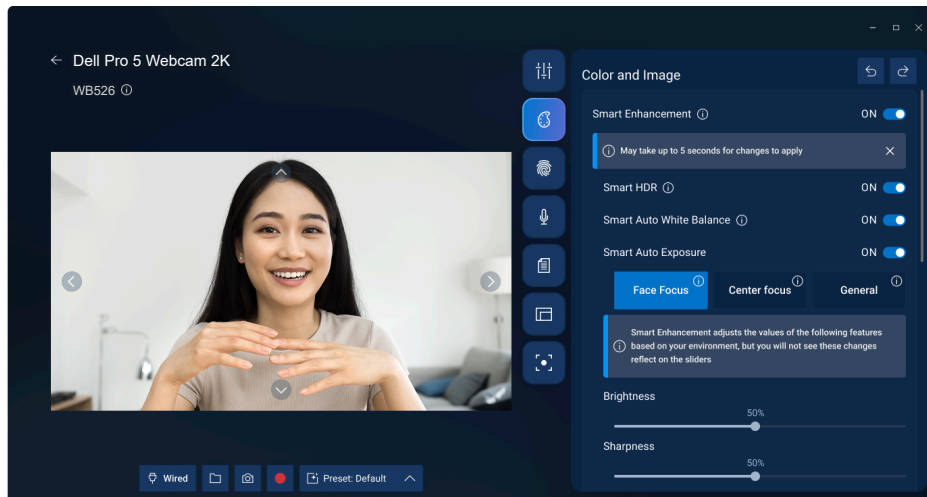

Figure 1. Dell Display and Peripheral Manager (Windows)

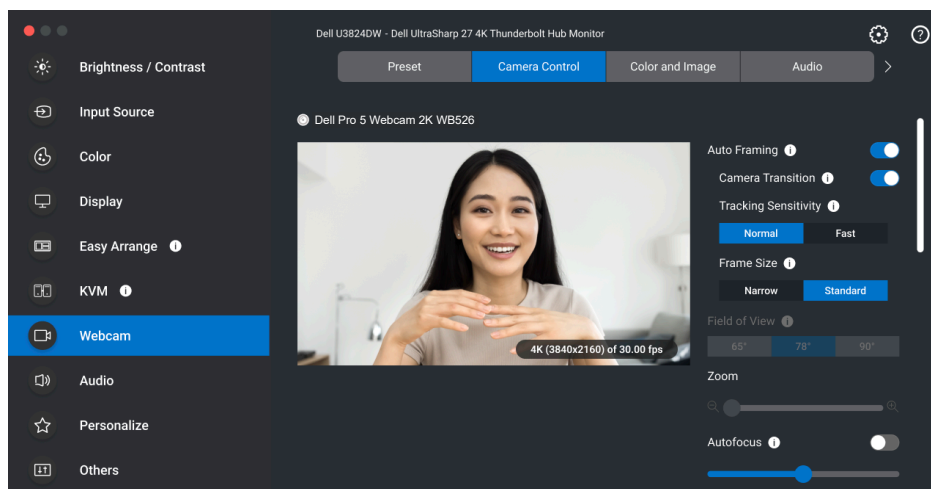

Figure 2. Dell Display and Peripheral Manager (macOS)

FAQ

What is the recommended configuration to install the software?

Operating System

- Win 11/10 + 64 bit (x86): Home/Pro/Enterprise
- Win 11 ARM

Processor

- Intel (In line with Windows 11 Processor Guideline)
- AMD (In line with Windows 11 Processor Guidelines)
- ARM- (QUALCOMM 8380 above only)

For macOS, the Dell Display and Peripheral Manager supports the following devices launched after 2018-MacBook Pro MacBook Air, Mac Mini, Mac Pro. It does not support the iMac. macOS versions 12, 13, and 14 are supported.

Dell Device Management Console

Dell Device Management Console (DDMC) is a cloud-based platform that enables IT administrators to manage Dell Pro Smart Docks, Dell Displays, and other supported Dell peripherals from a unified interface. It provides centralized access to information and management tools for these devices. The console runs on a secure cloud infrastructure and helps with inventory management, configuration, firmware updates, and ongoing operational management.

To learn more please access [Support for Dell Device Management Console | Manuals & Documents | Dell US](#)

Frequently asked questions

1. What is the recommended configuration to install the Dell Pro 5 Webcam 2K – WB526?

Windows 11, 64 bit

mac OS 14 or higher

2. What is Windows Hello camera?

A Windows Hello webcam supports Microsoft's Windows Hello biometric login system - allowing you to securely sign in using facial recognition instead of typing a password.

To enable Windows Hello, go to Settings > Accounts > Sign-in options and configure Windows Hello.

3. How do I know if my camera is on?

The Dell Pro 5 Webcam 2K - WB526 has a status-LED on the front lens that stays on (white light) when the camera is in use. The status-LED behavior is as follows:

Webcam in use - Status LED is solid white

Windows Hello authentication in progress - IR LED blinks repeatedly

4. How do I configure Windows Hello through the Dell Pro 5 Webcam 2K – WB526?

You can set the Dell Pro 5 Webcam 2K – WB526 to work with Windows Hello by following these steps:

Go to Camera Control on Dell Display and Peripheral Manager > Check "Prioritize External Webcam" option.

5. Can I use the Dell Pro 5 Webcam 2K – WB526 with a docking station or a USB Hub?

Yes, you can configure the webcam through a docking station or a USB hub connected to your computer.

6. My Dell Pro 5 Webcam 2K – WB526 is not detected by the computer.

Make sure the webcam is connected directly to the computer's USB-C port or an adapter that supports both power and video.

7. When should I activate/deactivate HDR?

It is recommended to enable HDR if you are in a high contrast light setting (Ex. facing windows with bright sunlight) and deactivate HDR in a low light setting.

8. How does document view work?

Document view works when you tilt the webcam down 60 degrees toward your desk with the DDPM application enabled. Place the document placed in the center, click Capture and adjust the 4 dots to align with the document boundary.

9. Why is the Gesture Control feature not working?

Check if the feature is enabled on DDPM.

Troubleshooting

Problem	Recommended solutions
Recommended steps for webcam issues	<p>For any issues with the Dell WB526 webcam, it is recommended to start by following these steps:</p> <ol style="list-style-type: none"> 1. Update the BIOS on your computer to the latest available version. 2. Update the operating system to the latest available version. 3. Update the USB-host and Thunderbolt driver on your computer. <p>Update the firmware on the Dell WB526 webcam to the latest version from www.dell.com/support/WB526/downloads.</p>
Webcam not detected	<ol style="list-style-type: none"> 1. Try disconnecting and reconnecting the USB cable. 2. Check if the webcam is detected in Device Manager. 3. Disconnect the webcam from any docking station or USB hub, and connect it directly to the computer.
Image or video shows artefacts and flickering, due to interference from LED or fluorescent light sources	<p>To resolve this issue, you need to adjust the settings based on your environmental lighting. For details on how to resolve this, go to DDPM > Color and Image:</p> <ol style="list-style-type: none"> 1. Switch on the Anti Flicker toggle. 2. Toggle between 50Hz and 60Hz to check which option eliminates the flickering.
Webcam does not work with Dell Display and Peripheral Manager and Camera app after hot plugging the webcam to the computer	<p>Wait for a few seconds after unplugging the camera before re-connecting it to the computer.</p>
Webcam not detected when connected to a docking station or USB hub	<ol style="list-style-type: none"> 1. Connect the dock or hub to a USB2.0/3.0 or USB Type-C port on the computer. 2. Update the firmware on the dock to the latest version.
Webcam is unable to automatically set the frame rate and exposure	<p>Auto-exposure and frame rate feature only function at low light condition and is supported only when HDR is turned off.</p> <p>Toggle off HDR on the DDPM to use auto-exposure and frame rate feature.</p>
Microphone is not functional	<ol style="list-style-type: none"> 1. Check if the microphone is enabled in the DDPM application. 2. Check if the computer has permission to access the webcam in the Windows/ MacOS system settings. 3. Try using the webcam's microphone on a different application. Adjust the application settings to choose webcam as the input device. 4. Disconnect and reconnect the webcam. 5. If the webcam is connected to the computer through a docking station or monitor, try connecting the webcam directly to the computer.

Statutory information

Warranty

Limited warranty and return policies

Dell Pro 5 Webcam 2K – WB526 webcam ships with a 3-year limited hardware.

For U.S. customers:

This purchase and your use of this product are subject to Dell's end user agreement, which you can find at www.dell.com/terms.

This document contains a binding arbitration clause.

For European, Middle Eastern and African customers:

Dell Pro 5 Webcam 2K – WB526 that are sold and used are subject to applicable national consumer legal rights, the terms of any retailer sale agreement that you have entered into (which will apply between you and the retailer) and Dell's end user contract terms.

Dell may also provide an additional hardware warranty-full details of the Dell end user contract and warranty terms can be found by going to www.dell.com, selecting your country from the list at the bottom of the "home" page and then clicking the "terms and conditions" link for the end user terms or the "support" link for the warranty terms.

For non-U.S. customers:

Dell Pro 5 Webcam 2K – WB526 that are sold and used are subject to applicable national consumer legal rights, the terms of any retailer sale agreement that you have entered into (which will apply between you and the retailer) and Dell's warranty terms. Dell may also provide an additional hardware warranty full details of Dell's warranty terms can be found by going to www.dell.com, selecting your country from the list at the bottom of the "home" page and then clicking the "terms and conditions" link or the "support" link for the warranty terms.

Getting Help

Contacting Dell

 **NOTE:** If you do not have an active Internet connection, you can find contact information on your purchase invoice, packing slip, bill, or Dell product catalog.

Dell provides several online and telephone-based support and service options. Availability varies by country and product, and some services may not be available in your area. To contact Dell for sales, technical support, or customer service issues:

Steps

Go to www.dell.com/support.

1. Select your support category.
2. Verify your country or region in the Choose a Country/Region drop-down list at the bottom of the page.
3. Select the appropriate service or support link based on your need

Revision History

The following table provides the revision history of this document:

Revision	Date	Description
A00	March 2026	Original publish date