

Acer DLP Projector

**PD1520Us / M1510U / HD6520Us /
HD2520Us / XD2520Us / U1P2407 Series**

User's Guide

Copyright © 2025. Acer Incorporated.
All Rights Reserved.
Acer Projector User's Guide
Original Issue: 07/2025





WARNING

To prevent electric shock, please do not open the device case. Internal components of the device are not user-serviceable. Please contact professional maintenance staff for repairs.

Notice

Although there is an ENCLOSED PROJECTION BARE ENGINE in the projector, avoid obstructing the air inlet with any objects during use.

No dust filter for the vents and avoid obstructing the air inlet, otherwise it will trigger the projector's LCD panel and COB protection mechanism due to poor ventilation.

Important safety announcements



Don't install equipment in a poorly ventilated area



Don't install equipment in hot and humid areas

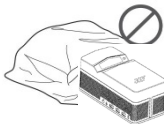

Don't block the vent (intake or exhaust)



Don't install equipment in dusty or smoky areas

Parts and Functions

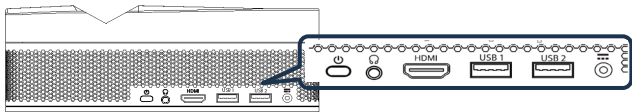

Important notice:

Audio outlet may not work properly with headsets or speakers that have a microphone function.

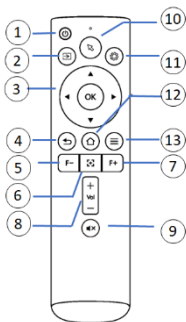

#	Icon	Function	Description
1		On/Off	Turn the projector on/off.
2		Input source	Select Input sources.
3		Select/Enter OK Four directional selection keys	Press to confirm the selection item. Use the up/down/left/right button to select items or make adjustments.
4		Back	Return to previous page.
5		Focus -	Adjust Focus down.
6		Autofocus	Press to initiate autofocus adjustment.
7		Focus +	Adjust Focus up.
8		Volume up	Increase volume.
		Volume down	Decrease volume.
9		Mute	Mute volume.
10		Mouse mode	Press to enable mouse function, press again to disable it.
11		Setup menu	Short Press to enter setting menu. Long Press to enter OSD Image adjustment menu.
12		Home	Return to Home page.
13		Auxiliary function	Functional key in app, not workable in HDMI environment.

The remote control is powered by two AAA batteries. (not included)

Connect Equipment and Apparatus

Direction of signal flow

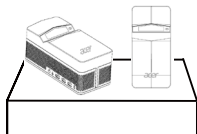
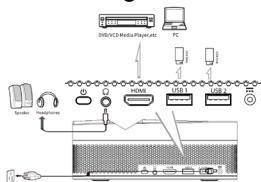

Wall / Table projection

Projection distance reference

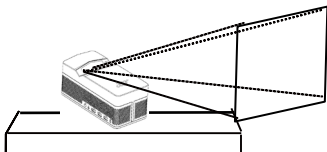

Wall Projection: Distance and Screen Size

Projection size (inch)	Screen Length (cm)	Screen Width (cm)	Distance from bottom to screen (cm)
30	67	38	3.8
40	88	50	9.3
50	112	63	15.3
60	133	75	20.8
70	156	87	26.8
80	177	100	32.3
90	199	112	38.1
100	221	125	44.0
110	244	137.5	49.8
120	265	144	55.3

Table Projection: Distance and Screen Size

Projection size (inch)	Screen Length (cm)	Screen Width (cm)	Lens distance from screen (cm)
25	56	31	14.5

Installation and Adjustment

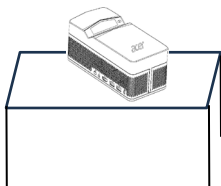

Wall projection

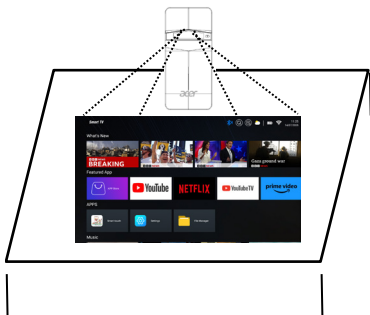
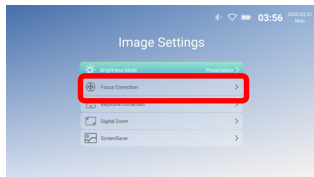
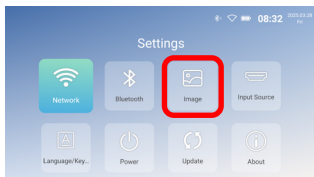

Table projection

Automatic Focus



The smart projector is equipped with an auto-focus system (laser-assisted focus optional) that supports remote control focusing, ensuring optimal picture clarity.

Automatic focus initiates upon powering on, providing a clear projection screen.

Due to different personal visual experiences, there may be differences in the criteria for judging the clarity of the projected picture. Users can use the focus button on the remote control to adjust the picture for the best viewing effect.

Keystone Correction

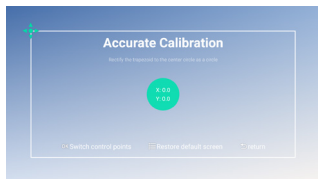
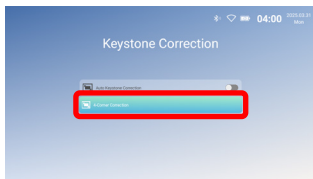
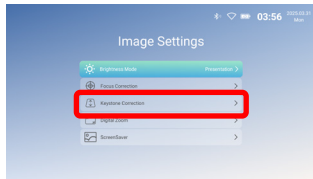
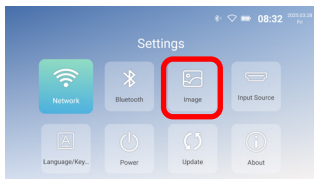

The smart projector supports automatic keystone correction when starting up, and users can also perform manual correction as needed.

Digital Zoom Adjustment

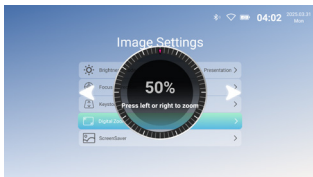
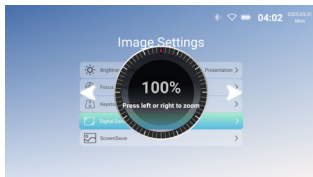
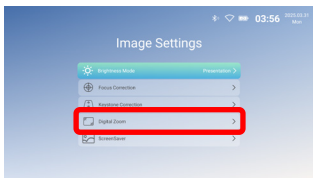
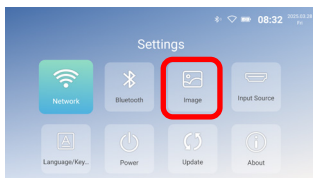

Connect to the Wireless Network

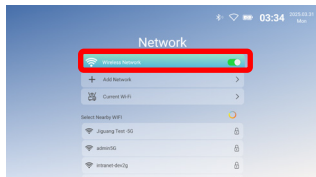
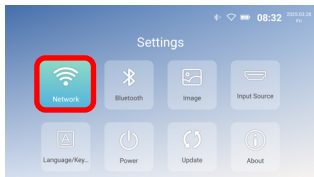

1. Turn on Wi-Fi: select “Network” and press “OK”.
2. Select the desired network and press “OK” to confirm.

Bluetooth Settings

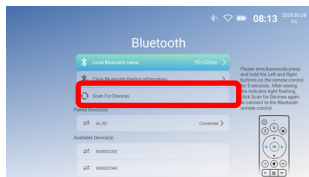
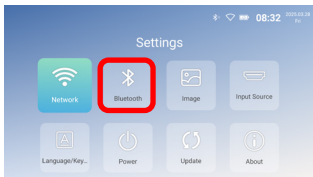

1. Select “Bluetooth” and press “OK”.
2. Search for the desired device (e.g., Bluetooth speakers), and connect.

Language Selection

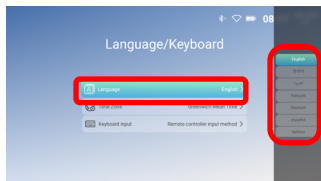
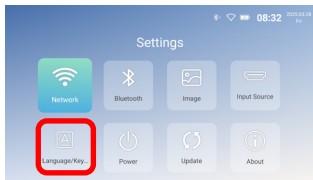

Select the language that best suits your personal preference.

Date and Time setting

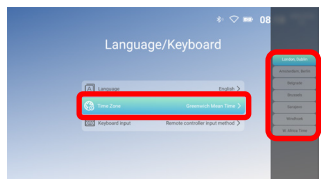
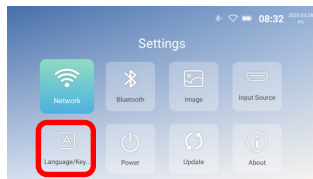

Select the preferred date and time format based on your personal preference.

Application settings

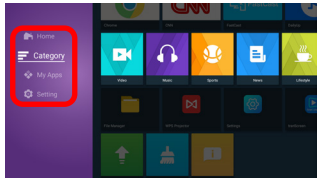
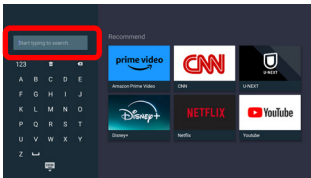
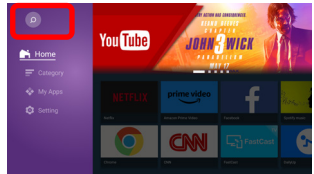
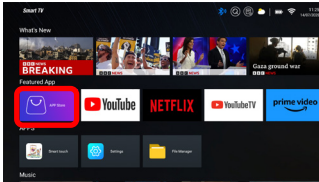

Download app from Menu, select “Search”, type app name and search, then click “My Apps” to view all downloaded apps and select the app you want to use.

Input Source Selection

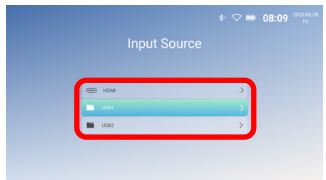
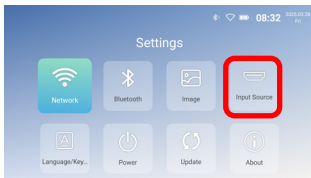

On the “Setting” menu, press the “Input Source” button to access the source menu. Select the appropriate input source based on your needs.

Screen Mirroring Instructions

- iOS/Android systems:

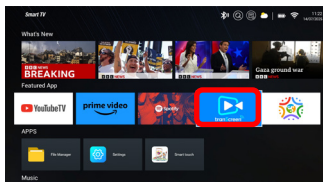

1. Go to "tranScreen", in Settings menu, and select "tranScreen" icon.
2. Press "tranScreen", then follow the instruction to start projection.

- AirPlay mirror:

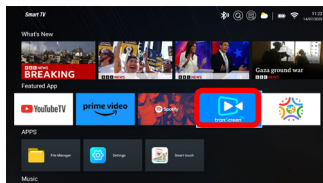

1. Go to the "tranScreen", in Settings menu, and select "AirPlay" icon.
2. Press "AirPlay", then follow the instruction to start projection.

• Miracast

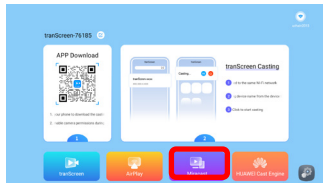
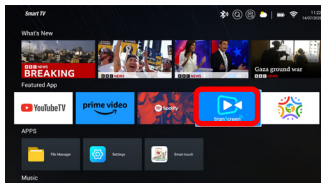

1. Go to the “tranScreen”, in Settings menu, and select “Miracast” icon.
2. Press “Miracast”, then follow the instruction to start projection.

• HUAWEI Cast Engine

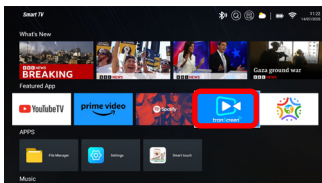

1. Go to the “tranScreen”, in Settings menu and select “HUAWEI Cast Engine” icon.
2. In HUAWEI Cast Engine, follow the instructions to start projection.

Menu Setting Instructions

- **Adjust Image:** There are four modes: **Bright**, **Presentation**, **Standard**, and **ECO** modes.

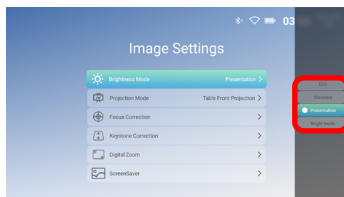

- **ScreenSaver timer adjustment:**

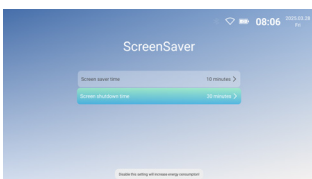
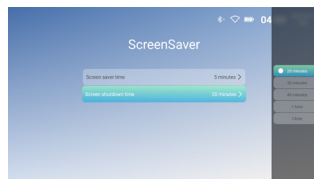
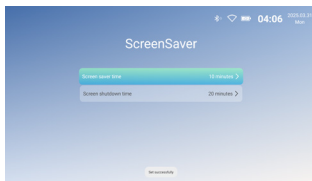
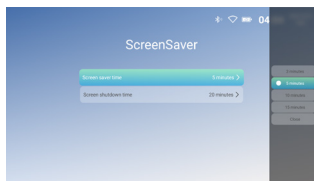
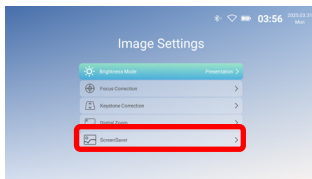
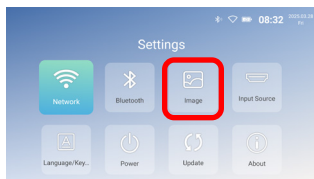

Power shut down / Timed shut down

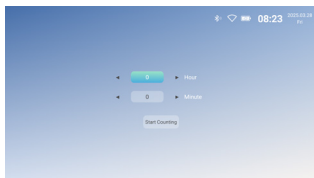
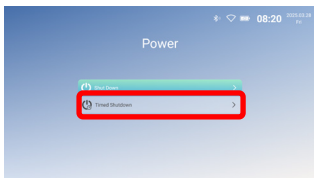
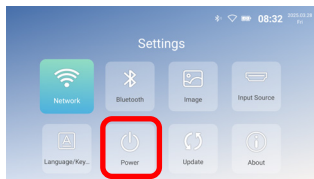
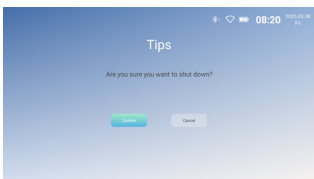
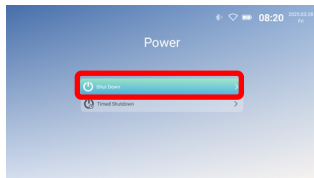
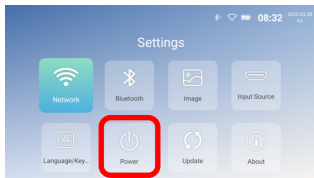

Notes:

When in table projection mode:

- Auto Focus is disabled.
- Keystone Correction is disabled.
- Digital Zoom adjustment is disabled (Default: 95%).

Touch Control Instructions (Optional)

1. Installing the Touch Control Module

- 1.1 When the touch module is connected to the projector, make sure the four corners of the projector are completely in contact with the touch module. If not, the touch function may be unresponsive.

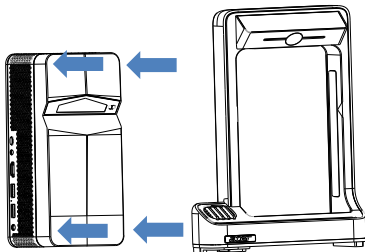

- 1.2 Attach the touch module to the device, connect it to the projector using a USB-A to Type-C cable, and place it on a level surface.

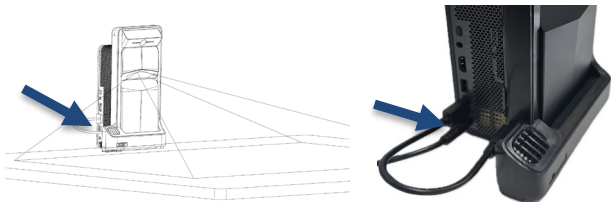
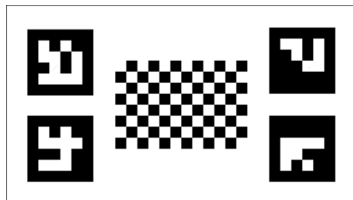

Table Projection Requirements:

1. Best with white; other colors may absorb light and affect the viewing experience.
2. Table material: frosted material is better, avoid reflective materials.
3. Keep the table surface flat and even.
4. Ensure no objects are within the projection area or within a 10 cm radius around it.

2. Touch Calibration Upon Startup

After installing the touch module, turn on the projector. A calibration screen will automatically appear, and the system will begin calibrating (as shown in the image below). Once calibration is complete, the screen will display "The touch function has been turned on", and you can start using the touch function.



Notes:

- *1) Wall Projection Limitation: The touch function is disabled when the projector is facing a wall and will only work in table projection mode.
- *2) Touch Module Indicator Light:
 - The light on the touch module will blink or stay on during operation.
 - If an object is placed in the touch area, the light will remain continuously lit, affecting touch sensitivity.

3. Using Touch Calibration

The touch function will automatically recalibrate when:

- Switching projection mode.
- USB is removed and reconnected, or the "Smart Touch" app is closed and reopen it.

4. Disabling Touch Function

- Tap the button on the floating sidebar to turn off the touch function. To re-enable it, open the "Smart Touch" app to restart the touch function.
- Unplugging the USB-A to Type-C cable from the touch module will also disable the touch function.
- When the projector is placed on a flat surface and projects onto a wall, the touch function will automatically turn off. (To resume touch function, ensure the projector is in Table mode and recalibrate if needed.)

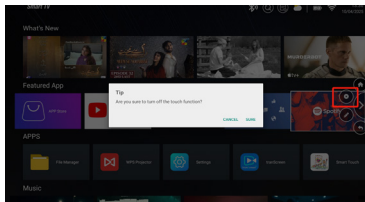

Projector / Touch Control Common Issues and Solutions

Issues	Solutions
No power, LED off, and the projector cannot power on.	Check the power cable for loose connection.
LED on but the projector cannot power on	Check the power cable for loose connection. Press the Power button to turn on the projector.
Cannot screen mirror	<ol style="list-style-type: none"> 1. Refer to the user guide for the correct screen mirroring function. 2. Shorten the distance between the smart device and the projector for better screen mirroring quality. 3. Ensure that the smart device is connected to the correct Wi-Fi network SSID.
Cannot stream media	Check the internet connection for your smart device.
Remote not responsive	<ol style="list-style-type: none"> 1. Replace remote batteries. 2. Make sure the remote control is aligned with the IR sensor. 3. Confirm whether the Bluetooth remote control is successfully connected to the projector.
Unable to power off the projector	Press and hold the Power button for 5 seconds until the projector turns off.
Touch function not working	<ol style="list-style-type: none"> 1. Ensure it has been assembled according to the operation guide in the manual. 2. Check whether the connection cable is properly connected. 3. Ensure the touch control has been calibrated.
Touch function not responsive	<ol style="list-style-type: none"> 1. Check whether the red indicator light at the bottom of the laser emitter is functioning normally. 2. Ensure the touch control has been calibrated. 3. Make sure there are no obstructions in the projector area.

Reminder

1. The projector is mainly used to watch native video or online video and cannot be used as a mobile phone or computer.
2. If the remote control cannot operate a third-party app, use a USB mouse to assist.
3. To download a third-party video app, please note that you need to download the TV version, not the mobile or other versions.
4. This machine does not support Dolby-encoded audio or video files.
5. If not used for a long time, cover the lens to prevent dust.
6. Do not look into the projector's lens when the lamp is on. The bright light may harm your eyes.
7. Adjusting power-related functions may increase energy consumption.
8. For optimal performance, please use the supplied, certified power adapter.

Disposal Instructions



This symbol on the product or its packaging indicates that the product must not be disposed of with other household waste. When disposing of used devices, it is your responsibility to bring it to a collection point that recycles used electrical and electronic equipment. The separate collection and recycling of used devices helps conserve natural resources and ensures that they are recycled in a manner that protects human health and the environment. For more information about recycling points for used devices, please contact your local city office, household waste disposal service, or the shop where you purchased the product.

Cleaning Methods

Before cleaning, ensure that the power socket is unplugged. Do not use pesticides or other volatile chemicals on the projector or lens, and avoid leaving rubber or vinyl products in contact with the projector for extended periods of time, as this may damage or peel off the remaining layers.

Cleaning the projector:

1. Use a soft and dry cotton cloth to wipe the surface of the projector.
2. Dampen a soft cotton cloth with a diluted neutral cleaner, and gently wipe the projector surface. Dry with a dry cotton cloth.
3. Do not use water, benzene, or other solvents on the projector.
4. Do not scratch the main body of the projector with fingernails or other hard objects.

Cleaning the lens:

1. Blow off the dust on the lens surface, and wipe off any stains with a soft cloth.
2. Use a professional dryer or lens cleaning paper specifically for camera and glasses.

REMARKS: Do not use ordinary tissue to clean the lens. Ordinary tissue contains large particles of impurities that may scratch the lens.

Cleaning the outlet dust filter:

Turn off the power and unplug the power cord before cleaning the outlet dust filter of vents every three months. This will prevent poor ventilation from triggering the projector LCD panel and COB protection mechanism.

Projector Specifications

Model	PD1520Us
CPU	Amlogic T972
DDR/eMMC	2G / 16G
Android System	Android 9.0
Wi-Fi	2.4G & 5G dual band Wi-Fi 6
Native Resolution	1920*1080
Max Resolution Supported	1080P
Contrast Ratio	10,000:1
Aspect Ratio	16:9
Projection Size	30"-100"
DMD Display	0.23 inch
Light Source	RGB LED
Zoom Function	50%-100%
Focusing	Auto focus
Port	1* HDMI port / 2* USB ports / 1* Audio port
Package Contents	1* Projector
	1* Adaptor
	1* Power Cord
	1* HDMI Cable
	1* Remote Control
	1* Touch Module / 1* USB-A to Type-C Cable (Optional)