

1D BARCODES, 2D BARCODES, MRZ OCR FONTS,  
POSTAL CODES

## XtremeScan Mag XG640

Rugged BYOD 1D/2D Barcode Scanner w/  
Pistol Grip

**High-Volume Scanning** | **Rugged IP67 Rated**  
**Scans Damaged Barcodes**

The XG640 is designed for BYOD (Bring Your Own Device) operations and easily integrates with any mobile device, providing the optimal solution to enhance efficiency and convenience in mobile workforces.



The XtremeScan Mag XG640 delivers exceptional scanning performance. Featuring a secure magnetic attachment system, workers can easily attach and detach their personal mobile devices to the scanner throughout the workday. This versatility empowers users to utilize their smartphones for tasks such as navigation, photos, and communication while adding high-performance barcode scanning when needed. The XG640's innovative BYOD design and rugged durability make it ideal for modern delivery operations, ensuring that tasks are handled efficiently without the need for multiple devices.

Featuring a comfortable pistol grip handle and fast, omnidirectional 1D/2D barcode scanning, the XG640 provides a convenient "point and shoot" approach for effortless data capture during work shifts. It boasts extended battery life for continuous operation, military-grade durability to withstand drops and harsh conditions, and a user-friendly interface with intuitive LED indicators and a multi-function trigger button to simplify scanning tasks.

With Bluetooth connectivity and a strong metal plate attachment system, the XG640 ensures optimal compatibility with any chosen mobile device and ensures reliable integration with iOS and Android business applications.

## Magnetic Adapter Compatibility

To ensure proper magnetic attachment, please ensure your device is equipped with a compatible magnetic mounting system.

- **Rokform Case Users:** If you're using a Rugged Rokform Case for iPhone 15, 16, 16e, or 17 no additional adapter is needed.
- **Other Phones:** For other devices, we recommend one of the following magnetic adapters from Rokform:
  - [Rokform MagSafe® Magnetic Universal Adapter](#) ↗
  - [Rokform Magnetic RokLock Plug](#) ↗
- **Tablets:** For tablet setups, we suggest the Oqtiq Magnetic Universal Strip as a reliable third-party option.

### Features

- **Multi-Device Compatibility** — Apple® Certified for iOS devices (iPhone®, iPad®) and compatible with Android® and Windows® 11.
- **Rapid Scanning** — Fast 1D/2D scanning for both printed and on-screen barcodes, featuring omnidirectional capability for intuitive, rapid scanning.
- **Rugged Design** — Built to withstand drops and harsh environments, with an IP67 sealed housing for protection from dust, water exposure, and water immersion.
- **One-Handed Solution** — Easily combine the mobile device and data reader for a one-handed scanning solution.
- **Bluetooth Classic Wireless Integration** — Dependable Bluetooth connection to host devices.
- **Pistol Grip Handle** — Comfortable point-and-shoot barcode reading.
- **Long-Lasting Battery** — Scanner features rechargeable and field-replaceable battery that lasts a full shift.
- **Easy Updates** — Firmware can be updated over Bluetooth using an iOS or Android app.
- **Intuitive User Indicators** — **LED lights** that indicate successful data read/write and battery charging status.
- **Audible Feedback** — Multiple **feedback tones** to indicate successful data read/write and other important action confirmations.
- **Developer Support** — Our support team is available to assist with set-up and operation.

- **Easy App Integration** — Socket Mobile's CaptureSDK (version 2.0.29 or higher) enables easy integration in your applications to improve business productivity with fast, efficient, and reliable data transfer over Bluetooth wireless technology. Data reader works out of the box for apps that have already integrated CaptureSDK, with support for Bluetooth LE devices.
- **1-Year Warranty Included** — **Extended warranty** options also available.
- **Designed and Assembled in the USA** — Socket mobile data readers are built at our headquarters in Fremont, CA.

## Dimensions

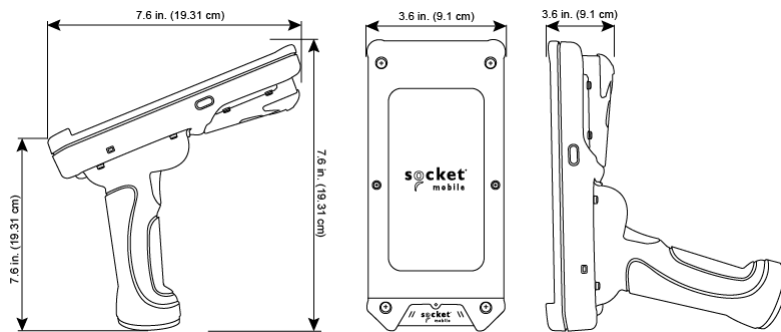

## External Control

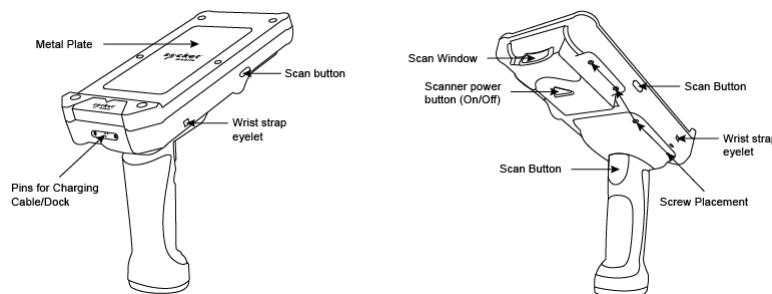

## Reading Performance

### Default Barcode Symbologies

- **1D Symbologies:** Bookland Ean, Codabar, Code 128, Code 39, Code 93, Ean Jan 13, Ean Jan 8, Gs1 128, Gs1 Databar Expanded, Gs1 Databar Limited, Gs1 Databar Omnidirectional, Interleaved 2 5, Isbt 128 Udi, Trioptic, Upc A, Upc E
- **2D Symbologies:** Aztec, Composite, Data Matrix, Dotcode, Gs1 Data Matrix, Gs1 Qr, Han Xin, Maxicode, Micropdf417, Micro Qr, Pdf417, Qr
- **OCR Typeface:** Ocr B

Learn how to **enable and disable** data types.

**Supported Barcode Symbologies**

- **1D Symbologies:** Chinese 2 5, Code 11, Matrix 2 5, Msi
- **Postal Codes:** Australia Post, Japan Postal, Mailmark, Netherlands Kix, Uk Postal, Us Planet, Us Postnet, Usps 4Cb One Intelligent Mail
- **OCR Typeface:** Micr E13b, Ocr A

Learn how to [enable and disable](#) data types.

**Print Contrast** Down to 25%-20%

**Scan Angle** 44.5° (Horizontal) - 33.5° (Vertical)

**Sensor Resolution** 1280 horizontal x 960 vertical pixels

3.0 to 49.5 cm (1.2 to 19.5 in.) Depends on barcode size, symbology, label media

**Reading Distance**

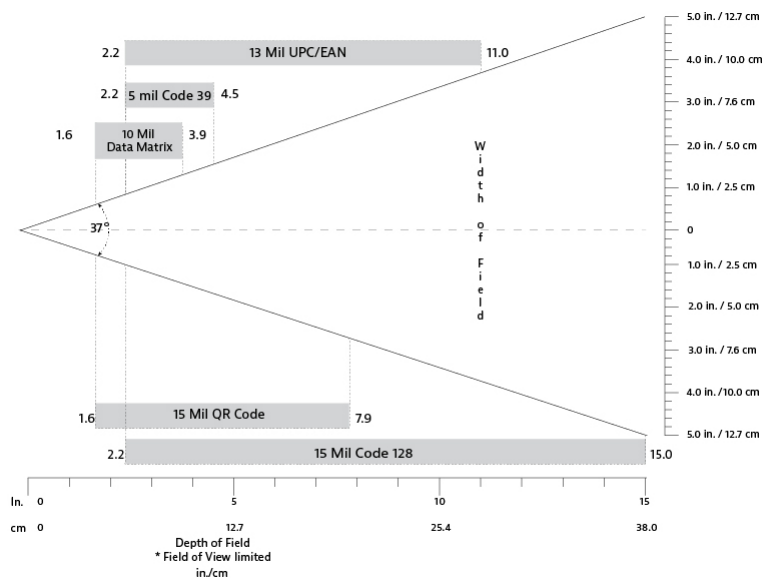

3.0 to 49.5 cm (1.2 to 19.5 in.) Depends on barcode size, symbology, label media.

**Decode Ranges**

	<b>Near</b>	<b>Far</b>
5 mil Code 39	2.2 in/5.5 cm	4.5 in/11.5 cm
10 mil DataMatrix	1.6 in/4.0 cm	3.9 inc/10.0 cm
13 Mil UPC/EAN	2.2 in/5.5 cm	11.0 in/28.0 cm
15 Mil Code 128	2.2 in/5.5 cm	15.0 in/38.0 cm
15 mil QR Code	1.6 in/4.0 cm	7.9 inc/20.0 cm

**Battery Information**

<b>Battery Type</b>	1 rechargeable Lithium Ion Polymer (replaceable battery)
<b>Charge Time</b>	8 Hours
<b>Life of battery</b>	500 charge-discharge cycles
<b>Life per full charge</b>	<p><b>Standby time:</b> 25 hours</p> <p><b>Active Scan Time:</b> 10,000 scans within 11 hours (based on one scan every 4 seconds)</p> <p><i>Note: Battery life varies depending on ambient temperature, ambient light, and the age of the battery.</i></p>
<b>Battery weight</b>	12.5g
<b>Percentage lithium</b>	36.3%
<b>mAh</b>	700
<b>Cells per battery</b>	1
<b>Watts per battery</b>	2.59
<b>Cell type</b>	Proprietary
<b>Chemical composition</b>	Lithium - polymer
<b>Lithium content</b>	4.5g
<b>Voltage</b>	3.7v
<b>Hazmat UN Number</b>	UN3481, P.I. 967
<b>ROHS Compliance</b>	Yes, Included with Scanner
<b>Country of origin</b>	China
<b>Commodity code</b>	8507.60.0000

## Bluetooth Information

### Bluetooth Profiles

- **Basic Mode** - Human Interface Device (HID)
- **Application Mode** - Serial Port Profile (SPP)
- **iOS Application Mode** (Default)

Some Operating Systems or smartphone/tablet models may support only one profile.

**Bluetooth Radio**

Class 2 Bluetooth, version 2.1 + EDR (Enhanced Data Rates) with 56-bit data encryption

**Bluetooth Range**

Up to 10 meters (33 ft.), depending on the environment. The range limit is usually due to the Host Device (phone, tablet, or notebook).

## Operating Systems



## Packaging

### Data Reader with Charging Cable

- Data Reader
- Charging Cable with USB-C to USB-A adapter
- Get Started Guide

### Data Reader with Charging Dock

- Data Reader
- Charging Dock
- USB-C Cable
- Get Started Guide

### Data Reader with Charging Dock and Mount

- Data Reader
- Charging Dock
- Mount
- USB-C Cable
- Get Started Guide

### Data Reader with Holster

- Data Reader
- Charging Cable with USB-C to USB-A adapter
- Holster
- Get Started Guide

## Common Uses

- Warehouse Management
- Logistics Management
- Baggage Handling
- Industrial & Manufacturing Solutions
- Inspections & Audits
- Mobile Delivery Services
- Manufacturing
- Transportation & Logistics Solutions

## User Environments

<b>Ambient Light</b>	From 0 to 100 000 lux. From pitch black to direct sunlight.
<b>Charging Temperature</b>	Charging in an ambient temperature above 40° C / 100° F may result in charging issues.
<b>Operating Temperature</b>	0° to 45° C (32° to 113° F)
<b>Relative Humidity</b>	95% at 60° C (140° F) (non-condensing)
<b>Storage Temperature</b>	-40° to 70° C (-40° to 158° F)
<b>Sealing</b>	IP67 (Ingress protection rating for dust and water) meets IEC sealing and EN60529 specifications.
<b>Drop Specifications</b>	<b>Standard:</b> <ul style="list-style-type: none"><li>• 10 ft. (3.1m) drop at room temperature per MIL-STD-810G</li></ul> <b>Freezer:</b> <ul style="list-style-type: none"><li>• 8 ft. (2.4m) drop to concrete across temperature per MIL-STD-810G</li><li>• 7 ft. (2.1m) drop to concrete across temperature per MIL-STD-810G.</li></ul>
<b>Tumble Specification</b>	2,500 cycles at 3.3 ft. (1 m) to a metal plate, IEC6008-2-31, IEC60068-2-32 3.

## Certification & Regulatory

### Bluetooth SIG:

- Declaration ID: D030529

- QD ID: 82009

### Electrical Safety:

- EN 62368-1:2020 + A11:2020
- IEC 62368-1:2018
- UL 62368-1:2019 R10.21
- CSA C22.2 NO. 62368-1:19

### Environmental:

- RoHS EN 50581

### EMI / RFI:

- FCC Part 15 Class C, RSS 210, iCES 003, C-Tick, CISPR 22, CE EN55022, EN55024
- TELEC: 020-240046
- FCC ID: LUBMA41
- IC ID: 2529A-MA41M9

### LED Safety:

- IEC 60825-1
- EN 60825-1



## Product SKUs

- **CX4274-3386** - XG640 (Cable Only)
- **CX4579-3833** - XG640 (Charging Dock)
- **CX4580-3834** - XG640 (Charging Dock w/ Mount)
- **CX4581-3835** - XG640 (Holster)
- **CX4523-3764** - XG640 (Rokform Case for iPhone 15)
- **CX4524-3765** - XG640 (Rokform Case for iPhone 16)
- **CX4841-4151** - XG640 (Rokform Case for iPhone 17)
- **CX4525-3766** - XG640 (Rokform Case for iPhone 17e/16e)

