

# SmartVision80 Installation and Deployment Guide

## Package Contents

### NOTE

We recommend that you use the accessories provided or approved by Yealink. The use of unapproved third-party accessories may result in poor performance.

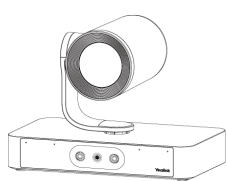

SmartVision 80

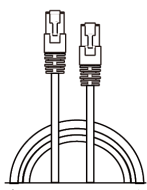

(7.5m, 24.61ft)  
CAT5e UTP  
(RJ45 - RJ45) Cable

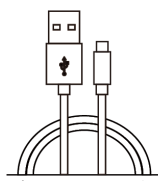

(2.5m, 8.20ft)  
USB 3.0 (A - B) Cable

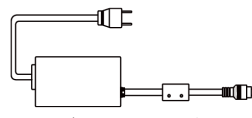

(3.5m, 11.49ft)  
Power Adapter  
(48V/1.36A)

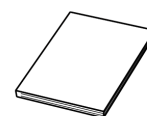

Quick Start Guide

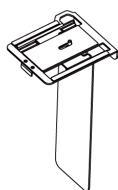

TV Bracket

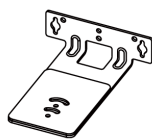

Mounting Bracket

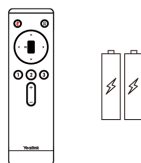

VCR20 Remote Control  
and AAA Battery

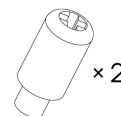

× 2  
Φ5 \* 11 mm  
Positioning Screw



Velcro

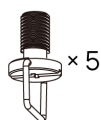

× 5  
1/4inch\*8.0mm



× 4  
Φ6 \* 30 mm, white,  
Polyamide



× 4  
T4\*30  
FAHOZN3+ (+)



× 5  
(20 \* 100 mm)  
Cable Ties

## SmartVision 80 Installation

### Deployment

The SmartVision 80 can be deployed at heights ranging from 1.2m to 2.2m, ensuring the camera covers a height range of 60cm to 210cm.

#### Above the TV

If deploying SmartVision 80 at the front of the meeting room (above the TV), the installation height must be less than the straight-line distance from the camera to the nearest participant.

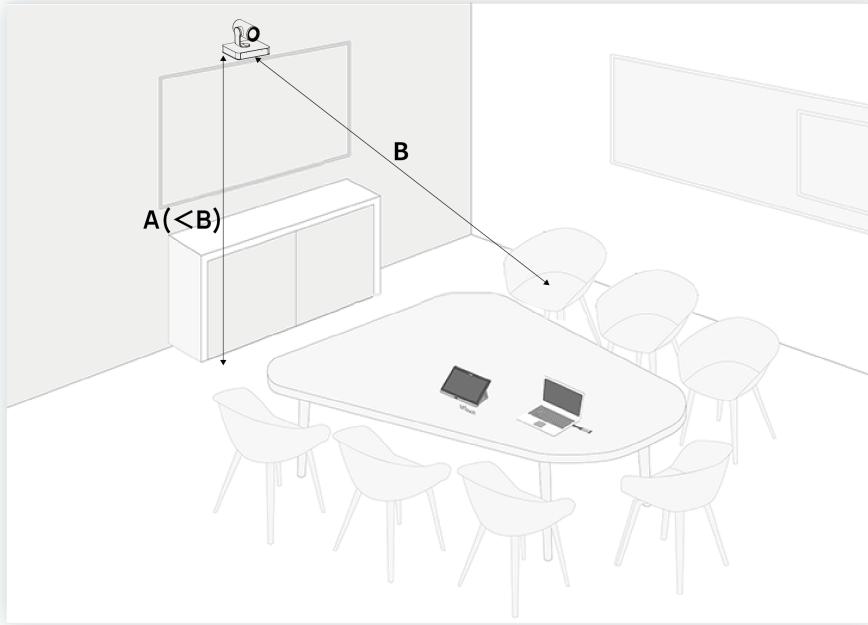
**Below the TV**

With the lens facing upwards, the recommended installation height is 800 mm. Adjust the lens angle to ensure the desired area is fully covered.

**Put on a Flat Surface**

Place the SmartVision 80 on the conference table, ensuring the angle of inclination is no more than 5 degrees for proper operation.

**Mount on Top of a TV**

- TV thickness ranges from 0 mm to 70 mm.

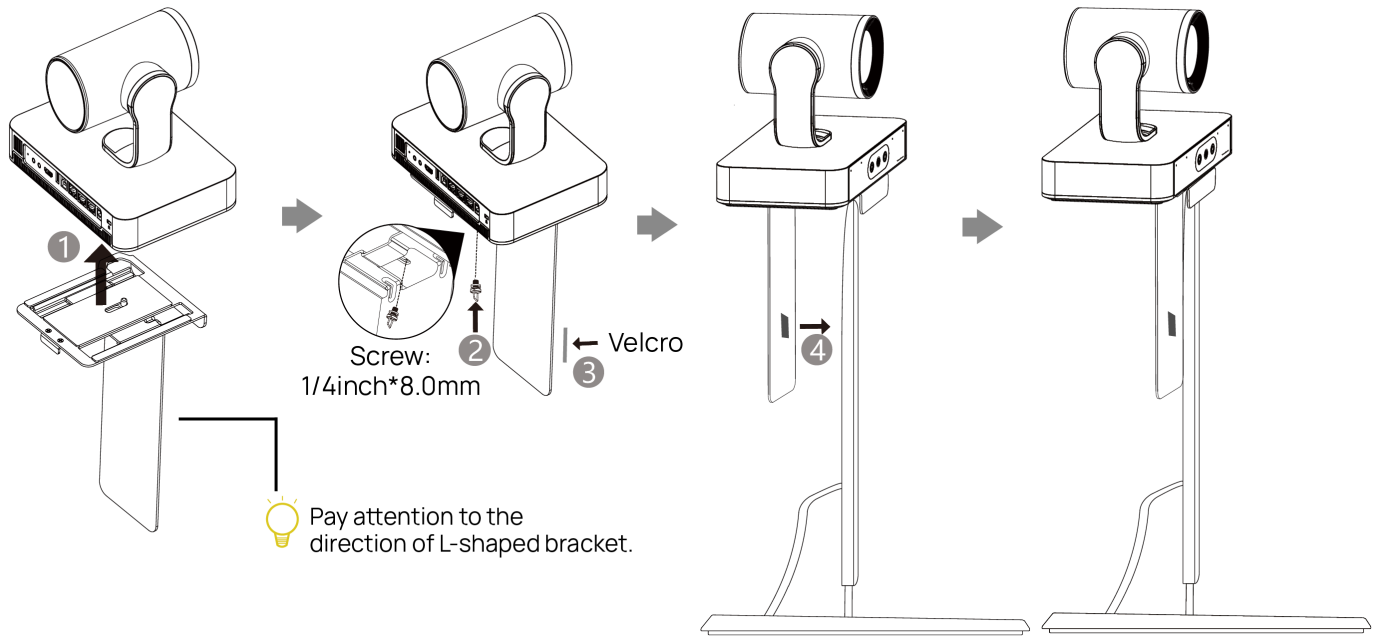

- TV thickness ranges from 46 mm to 146 mm.

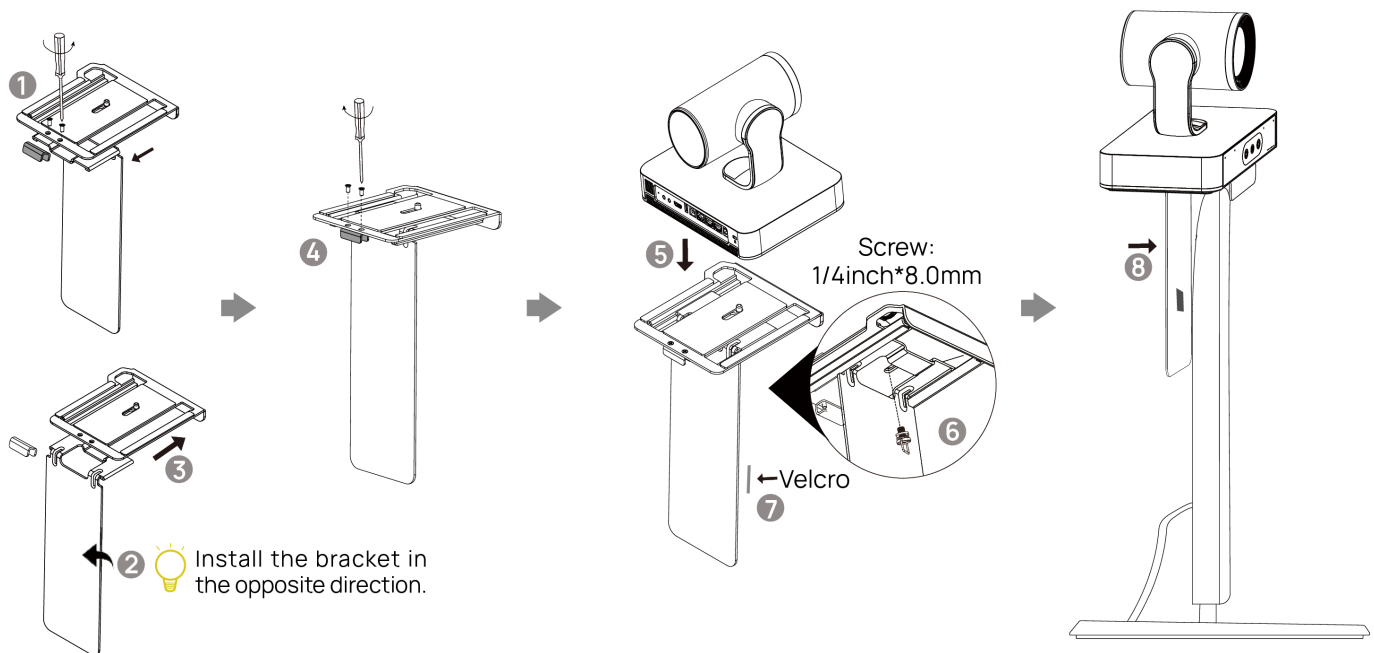

## Mount on the Wall

The recommended height is 1.2m to 2.2m above the ground.

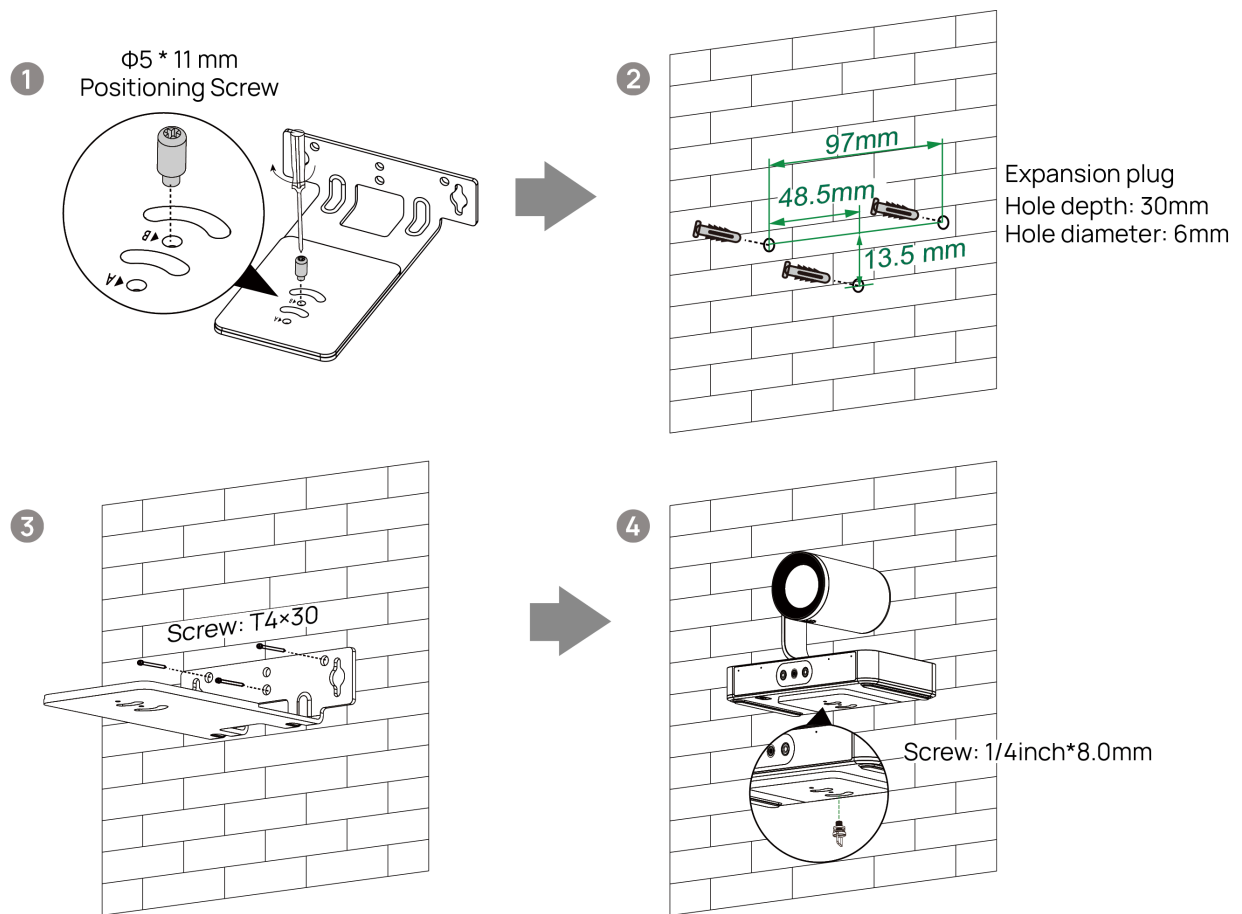

### Mount onto a TV Mount

#### **NOTE**

Before installation, please make sure that the bottom of the camera is higher than the desktop. If this is not the case, other installation methods are recommended.

You need to purchase a TV mount separately.

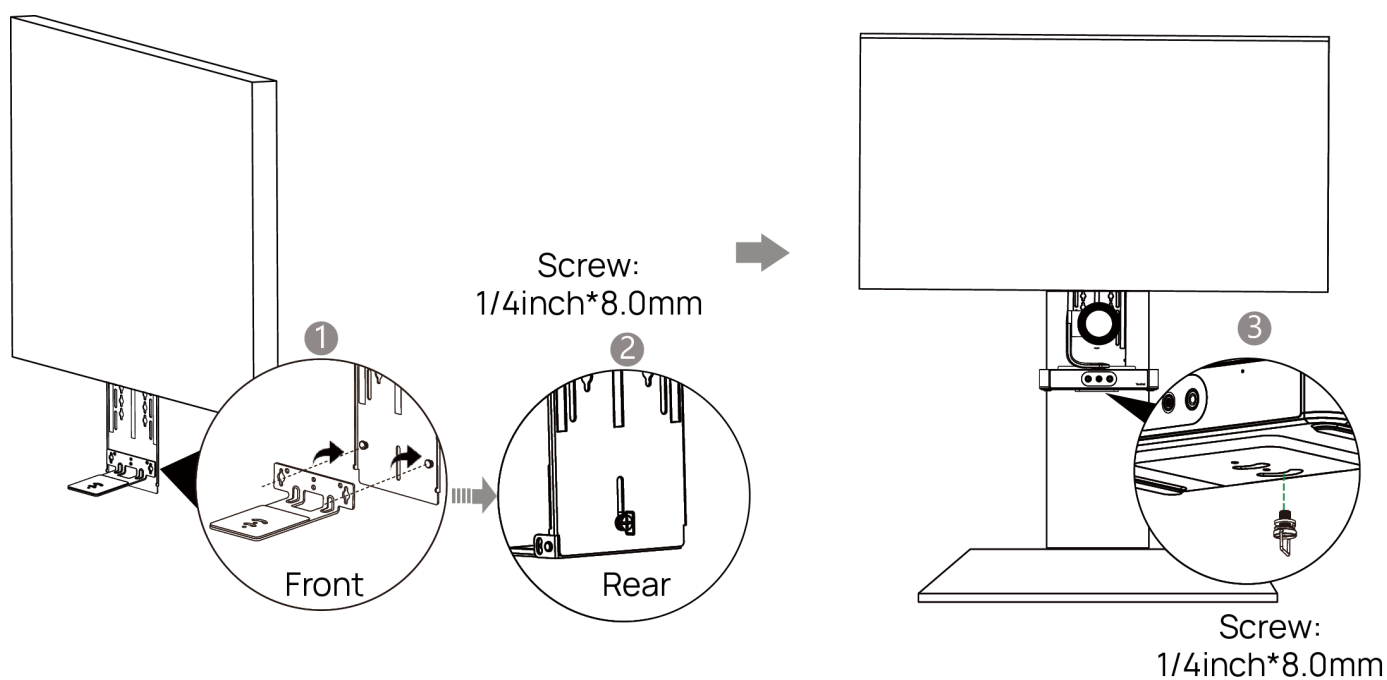

## Lens Calibration

### 1. Horizontal Coverage Adjustment

When using the mounting bracket to install the device, you can adjust the direction of SmartVision 80 to adjust the coverage according to the actual deployment situation. The angle adjustment can be viewed through the sticker on the bottom.

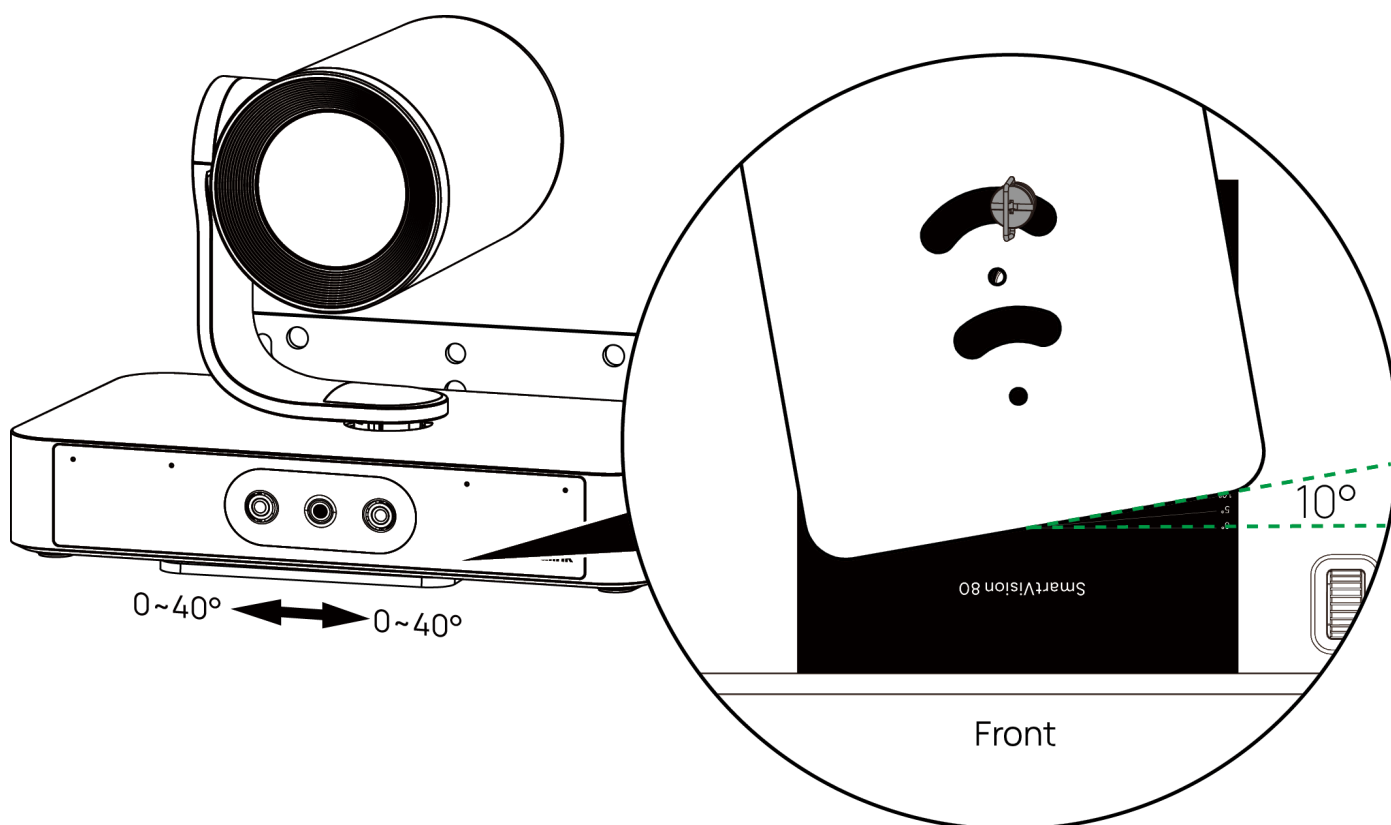

### 2. Vertical Coverage Adjustment

SmartVision 80 is equipped with four cameras (one PTZ camera, two telephoto cameras, and one panoramic camera). Telephoto and panoramic cameras allow for manual adjustment of the pitch angle within  $\pm 10^\circ$ . According to the actual usage scenarios, you can manually adjust the lens gear at the bottom of the SmartVision 80.

**NOTE**

When you place the SmartVision 80 on the desk, you need to adjust the lens upward.

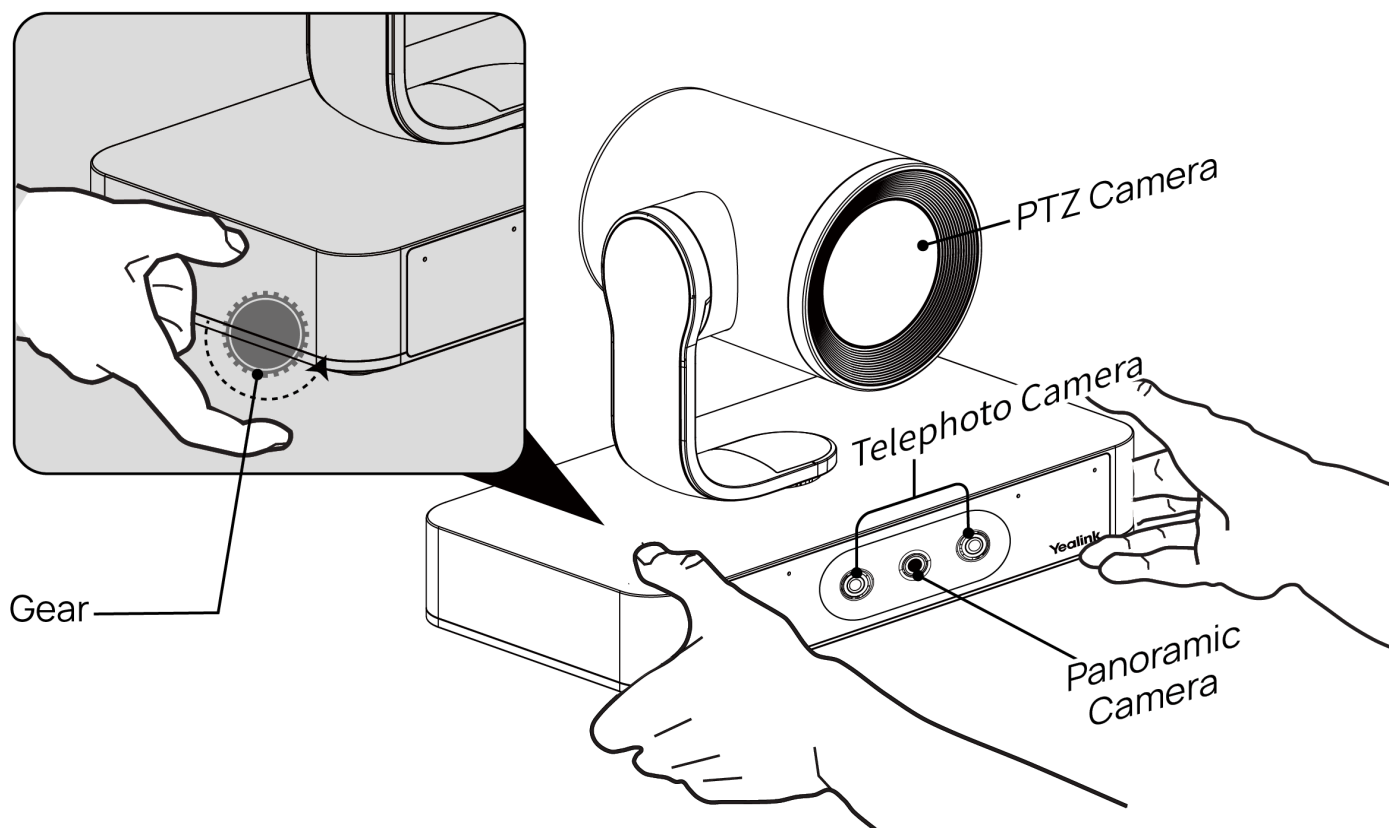
**3. Lens Calibration Using Yealink RoomConnect Software**

After manually adjusting the lens to a suitable angle, please use the Yealink RoomConnect software to calibrate the lens.

1. Open the Yealink RoomConnect software, click Device Settings > Lens Calibration.
2. Click OK (the camera cannot be adjusted during the lens calibration).

**NOTE**

During the lens calibration process, please ensure that there is no obstruction in front of the lens, and the lens cannot be adjusted manually. If one calibration fails, try calibrating again.

**Hardware Interface**

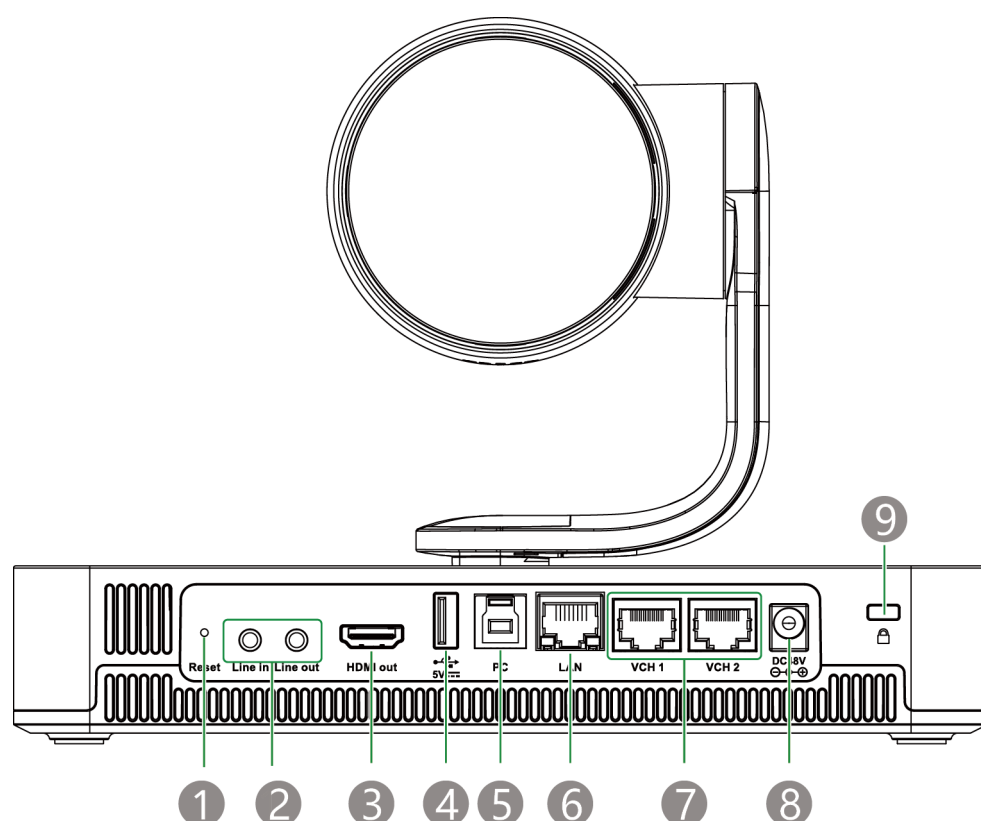

No.	Item	Description
1	Reset	Reset the SmartVision 80 to factory defaults.
2	Line In/Line Out	Connect to an audio input/output device via a 3.5 mm audio cable.
3	HDMI Out	Connect to a TV to share content or camera images.
4	USB-A Port	Connect to the Yealink DD10 device or the USB disk.
5	PC Port	Connect to a PC as video output.
6	LAN	Connect to network and support power supply via PoE+. SmartVision 80 connects to AVHub or RCH40 E2 via the LAN port.
7	VCH1/VCH2	In the MVC system, connect to audio device (for example: VCM35, MSpeaker Pro).
8	DC48V	Connect to the power adapter.
9	Security Slot	Connect a universal security cable to the SmartVision 80 so that you can lock the SmartVision 80 down.

## Connect SmartVision 80

### Single SmartVision 80 Connection

**NOTE**

Supports directly connect to PC/MCore 4/MCore Pro, the figure below takes MCore 4 connection as an example.

**Powered by Power Supply**

**SmartVision 80**

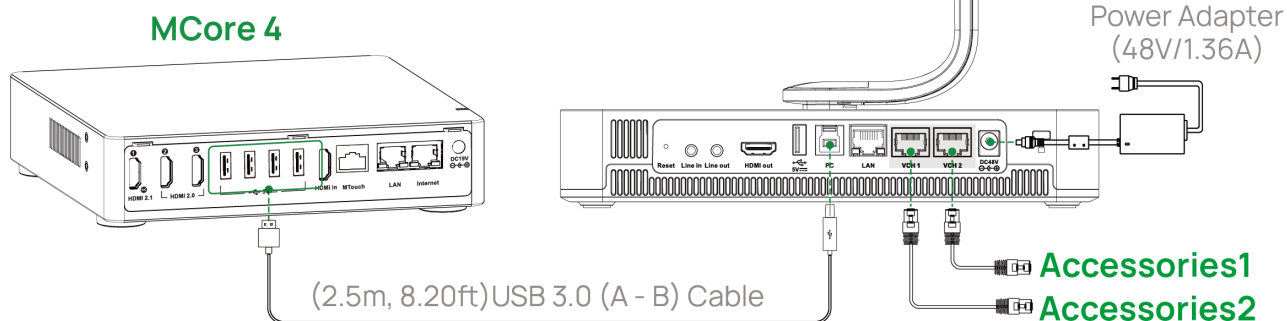

**Powered by POE+**

**NOTE**

When the number of accessories is greater than 2 and POE+ is used to power SmartVision 80, the VCH port and LAN port cannot be connected to the same LAN.

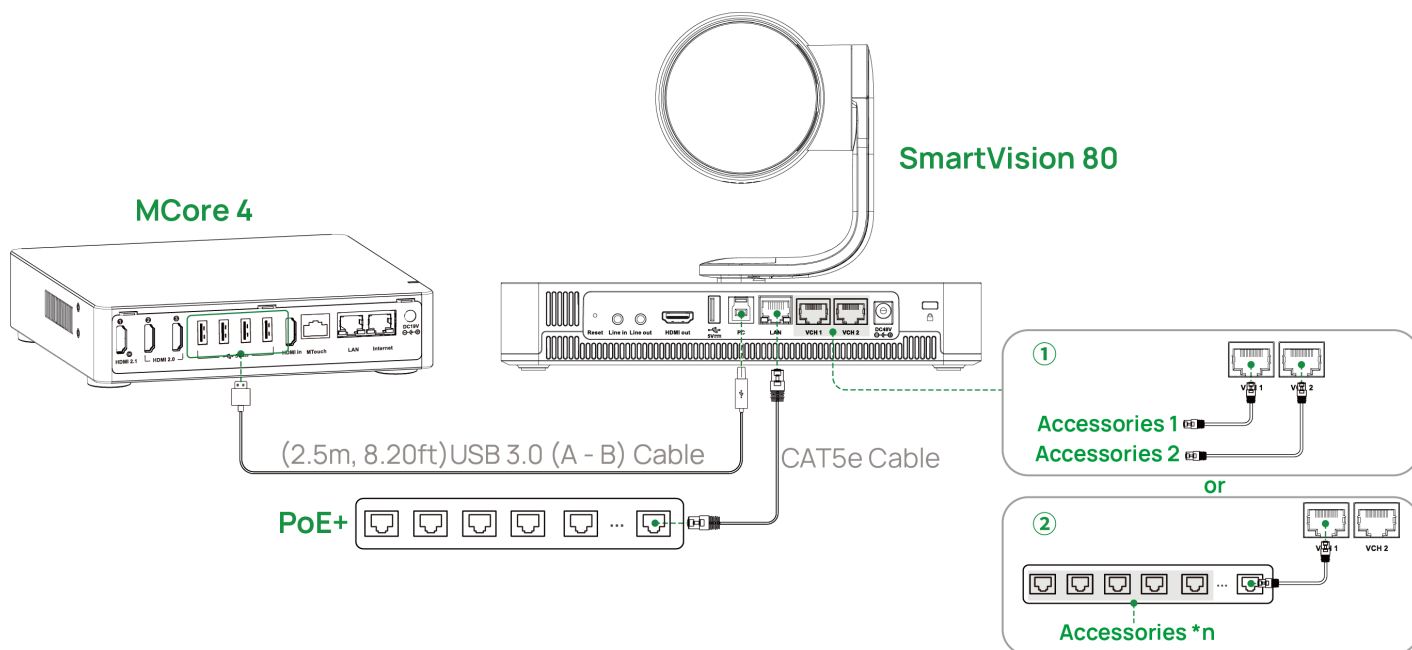



## Multiple SmartVision 80 Connection

### NOTE

Supports connect to PC/MCore 4/MCore Pro via AVHub, the figure below takes MCore 4 connection as an example.

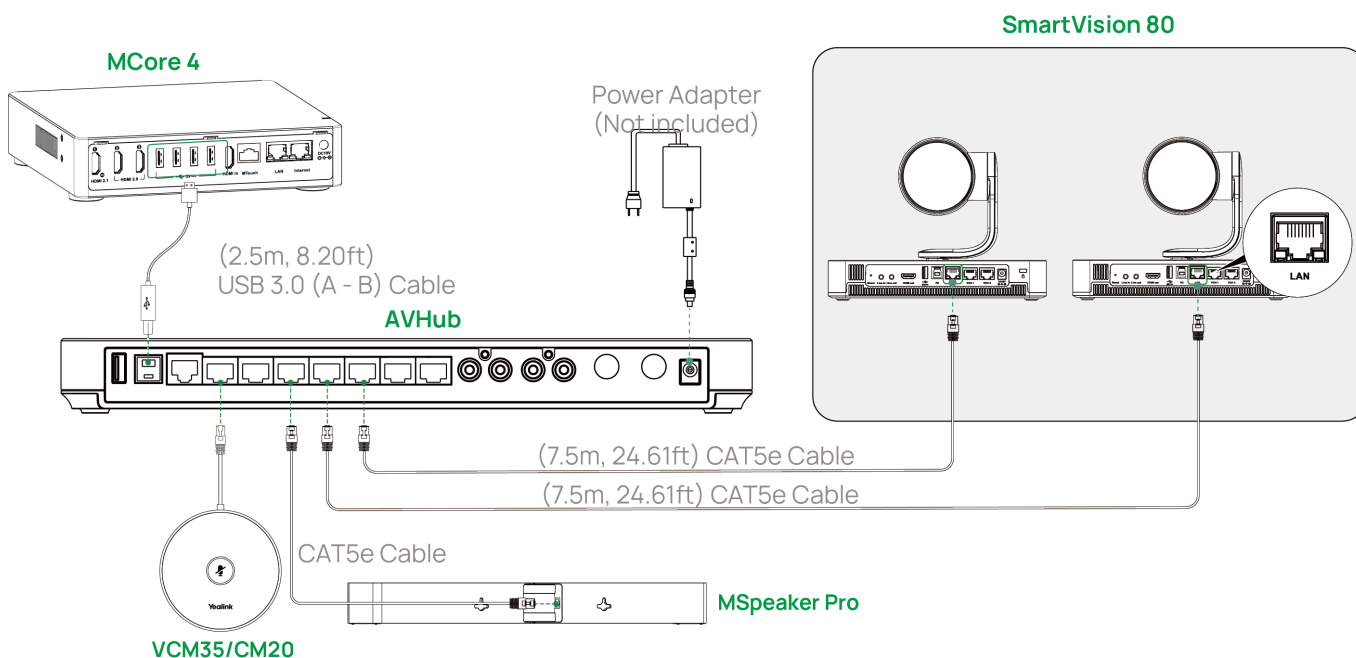

### NOTE

- Supports connecting up to two SmartVision 80 devices via AVHub.
- When more than two SmartVision 80 devices are connected, AVHub needs to connect an additional PoE+ switch and connect the extra SmartVision 80 to the PoE+ switch.
- Audio accessories need to be connected to the VCH port of AVHub.

## LED Indicator

LED Status	Description
Off	The SmartVision 80 is powered off.
Solid Green	The SmartVision 80 is active.
Solid Red	The SmartVision 80 is in sleep mode.
Flashing Orange	The SmartVision 80 is upgrading firmware.
Flashing Red	The SmartVision 80 is in recovery mode.

## VCR20 Remote Control

Please refer to [VCR20 Remote Control](#) for details.

### Notes After Installation

- Ensure the device is installed stably to avoid vibration affecting the view.
- Regularly check the device status to ensure regular operation.