

USER MANUAL

ProLite

LCD Monitor

ENGLISH

ProLite LH4364UHS
ProLite LH5064UHS
ProLite LH5564UHS
ProLite LH6564UHS
ProLite LH7564UHS
ProLite LE9864UHS

Thank you very much for choosing the iiyama LCD monitor for signage.

We recommend that you take a few minutes to read this comprehensive manual carefully before installing and switching on the monitor. Please keep this manual in a safe place for your future reference.



Scan the QR code to find out additional software/services available for your IIYAMA product or go to:
iiyama.com/signup



Dear user, we congratulate you on the purchase of your iiyama LCD.

For details on warranty and locally used pixel policies that apply directly after installation of your product please check the iiyama website.

**To report a fault, please contact
your local support centre found at <https://iiyama.com>**

Things to check before you call the iiyama information line

- | if the power cable is connected securely and turned on?
- | if the display has been turned on?
- | if the signal cable is connected securely and the correct input selected?
- | if the computer has been restarted with the display connected?
- | if the graphics card is correctly installed with the latest drivers possible?
- | if the correct native resolution has been selected via 'Display Properties'?
- | If the R/G/B signal configuration is correct?
- | if the displays On Screen Menu is shown?
- | if the correct brightness and contrast settings have been set?
- | if given display tolerances and compatibility have been considered?
- | if via the On Screen Menu you have performed a Factory Reset/Recall?

Before reporting the screen defect, please prepare the following information/evidence:

- | model number *
- | purchase receipt and serial number *
- | name and address for collection
- | telephone/fax number, for availability during the day
- | convenient collection date (date, time)
- | short description of the defect

Important Note:

If there is no fault found in the collected equipment after inspection, the transferring party shall incur charges for transport and administration.

If you have checked all of the above and there is still no picture, call our information line for assistance in your country.

Feedback on health and safety issues

If you have any health and safety concerns or questions about the product (including when using the product), please contact iiyama support through our website. You can also contact us by calling +31 204460404. After receiving your feedback, we will ask the responsible unit to handle it as soon as possible and a dedicated person will get back to you. Your feedback will also be recorded and incorporated into our evaluation for improvements.

* see the identification plate on the back of the case.

CE MARKING DECLARATION OF CONFORMITY

This LCD monitor complies with the requirements of the EC/EU Directive 2014/53/EU "RED Directive", 2009/125/EC "ErP Directive" and 2011/65/EU "RoHS Directive".

The electro-magnetic susceptibility has been chosen at a level that gives correct operation in residential areas, business and light industrial premises and small-scale enterprises, inside as well as outside of the buildings. All places of operation are characterised by their connection to the public low voltage power supply system.

Radiation Exposure Statement:

This equipment complies with CE radiation exposure limits set forth for an uncontrolled environment. This equipment should be installed and operated with minimum distance 20cm between the radiator & body.

Operating Frequency range and the maximum output power (EIRP) are listed below:

PL4364U, PL5064U, PL5564U, PL6564U, PL7564U, PL9864U

Function	Frequency	Maximum Output Power (EIRP)
WiFi	2412-2472 MHz	19.28 dBm
	5180-5320 MHz	20.88 dBm
	5500-5700 MHz	19.26 dBm
	5745-5825 MHz	13.49 dBm

IYYAMA CORPORATION: Wijkmeerstraat 8, 2131 HA Hoofddorp, The Netherlands

Model No. : PL4364U, PL5064U, PL5564U, PL6564U, PL7564U, PL9864U



mark: Equipment protected throughout by Double insulation or Reinforced insulation.



WARNING



THIS PRODUCT CONTAINS two AAA Alkaline Batteries.

- Do not heat batteries.
- Do not deform battery.
- Do not recharge battery.
- Do not dispose of battery in fire.
- Keep battery away from direct sunlight and heat sources, do not storage in high temperature and humidity environment.
- Do not ingest battery, Chemical Burn Hazard.
- Keep new and used batteries away from children.
- If the battery compartment does not close securely, stop using the product and keep it away from children.
- If you think batteries might have been swallowed or placed inside any part of the body, seek immediate medical attention.

Battery Model : LR03

Battery Voltage / Typical Capacity : 1.5V, 1200 mAh

Battery Manufacturer : TP Vision Europe B.V.

Prins Bernhardplein 200, 1097 JB Amsterdam,
The Netherlands

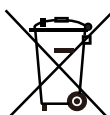

Please inform yourself about the local separate collection system for electrical and electronic products.

Please act according to your local rules and do not dispose of your old products with your normal household waste. Correct disposal of your old products helps to prevent potential negative consequences for the environment and human health.

Your product contains batteries covered by the European Regulation (EU) 2023/1542, which cannot be disposed with normal household waste. Alternatively, please visit https://iiyama.com/gl_en/support/#recycling



We recommend recycling of used product. Please contact your dealer or iiyama service center. Recycle information is obtained via the Internet, using the address: <https://iiyama.com>

You can access the Web page of different countries from there.

- We reserve the right to change specifications without notice.
- All trademarks used in this user manual are the property of their respective owners.
- Eprel registration number

LH4364UHS-B1AG : 2228334

LH6564UHS-B1AG : 2225787

LH4364UHS-B1AG A : 2481206

LH6564UHS-B1AG A : 2480879

LH5064UHS-B1AG : 2223718

LH7564UHS-B1AG : 2226746

LH5064UHS-B1AG A : 2480961

LH7564UHS-B1AG A : 2480716

LH5564UHS-B1AG : 2224809

LE9864UHS-B1AG : 2229563

LH5564UHS-B1AG A : 2480926

LE9864UHS-B1AG A : 2481169

TABLE OF CONTENTS

FOR YOUR SAFETY.....	1
SAFETY PRECAUTIONS.....	1
SPECIAL NOTES ON LCD MONITORS.....	3
CUSTOMER SERVICE	5
CLEANING	6
BEFORE YOU OPERATE THE MONITOR.....	7
FEATURES.....	7
CHECKING THE CONTENTS OF THE PACKAGE	8
UNPACKING	8
CONTROLS AND CONNECTORS.....	9
INSTALLATION	12
FUNCTIONS OF THE REMOTE CONTROL	18
PREPARING THE REMOTE CONTROL.....	19
ID REMOTE CONTROL.....	20
BASIC OPERATION.....	21
CONNECTING YOUR MONITOR : ProLite LH4364UHS /	
ProLite LH5064UHS / ProLite LH5564UHS / ProLite LH6564UHS /	
ProLite LH7564UHS.....	23
CONNECTING YOUR MONITOR : ProLite LE9864UHS	24
COMPUTER SETTING	26
OPERATING THE MONITOR.....	27
ADJUSTMENT MENU CONTENTS	28
STANDBY FEATURE	54
TROUBLE SHOOTING	55
RECYCLING INFORMATION.....	56
APPENDIX	57
SPECIFICATIONS : ProLite LH4364UHS-B1AG / B1AG A.....	57
SPECIFICATIONS : ProLite LH5064UHS-B1AG / B1AG A.....	58
SPECIFICATIONS : ProLite LH5564UHS-B1AG / B1AG A.....	59
SPECIFICATIONS : ProLite LH6564UHS-B1AG / B1AG A.....	60
SPECIFICATIONS : ProLite LH7564UHS-B1AG / B1AG A.....	61
SPECIFICATIONS : ProLite LE9864UHS-B1AG / B1AG A.....	62
DIMENSIONS : ProLite LH4364UHS	63
DIMENSIONS : ProLite LH5064UHS	63
DIMENSIONS : ProLite LH5564UHS	64
DIMENSIONS : ProLite LH6564UHS	64
DIMENSIONS : ProLite LH7564UHS	65
DIMENSIONS : ProLite LE9864UHS	65
DIMENSIONS : WALL MOUNTING.....	66
COMPLIANT TIMING.....	68

FOR YOUR SAFETY

SAFETY PRECAUTIONS

WARNING

STOP OPERATING THE MONITOR WHEN YOU SENSE TROUBLE

If you notice any abnormal phenomena such as smoke, strange sounds or fumes, unplug the monitor and contact your dealer or iiyama service center immediately. Further use may be dangerous and can cause fire or electric shock.

NEVER REMOVE THE CABINET

High voltage circuits are inside the monitor. Removing the cabinet may expose you to the danger of fire or electric shock.

DO NOT PUT ANY OBJECT INTO THE MONITOR

Do not put any solid objects or liquids such as water into the monitor. In case of an accident, unplug your monitor immediately and contact your dealer or iiyama service center. Using the monitor with any object inside may cause fire, electric shock or damage.

INSTALL THE MONITOR ON A FLAT, STABLE SURFACE

The monitor may cause an injury if it falls or is dropped.

DO NOT USE THE MONITOR NEAR WATER

Do not use where water may be splashed or spilt onto the monitor as it may cause fire or electric shock.

OPERATE UNDER THE SPECIFIED POWER SUPPLY

Be sure to operate the monitor only with the specified power supply. Use of an incorrect voltage will cause malfunction and may cause fire or electric shock.

PROTECT THE CABLES

Do not pull or bend the power cable and signal cable. Do not place the monitor or any other heavy objects on the cables. If damaged, the cables may cause fire or electric shock.

ADVERSE WEATHER CONDITIONS

It is advisable not to operate the monitor during a heavy thunder storm as the continual breaks in power may cause malfunction. It is also advised not to touch the plug in these circumstances as it may cause electric shock.

CAUTION

INSTALLATION LOCATION

Do not install the monitor where sudden temperature changes may occur, or in humid, dusty or smoky areas as it may cause fire, electric shock or damage. You should also avoid areas where the sun shines directly on the monitor.

DO NOT PLACE THE MONITOR IN A HAZARDOUS POSITION

The monitor may topple and cause injury if not suitably located. Please also ensure that you do not place any heavy objects on the monitor, and that all cables are routed such that children may not pull the cables and possibly cause injury.

MAINTAIN GOOD VENTILATION

Ventilation slots are provided to keep the monitor from overheating. Covering the slots may cause fire. To allow adequate air circulation, place the monitor at least 10 cm (or 4 inches) from any walls. Operating the monitor on its back, side, upside down or on a carpet or any other soft material may also cause damage.

DISCONNECT THE CABLES WHEN YOU MOVE THE MONITOR

When you move the monitor, turn off the power switch, unplug the monitor and be sure the signal cable is disconnected. If you do not disconnect them, it may cause fire or electric shock.

UNPLUG THE MONITOR

If the monitor is not in use for a long period of time it is recommended that it is left unplugged to avoid accidents.

HOLD THE PLUG WHEN DISCONNECTING

To disconnect the power cable or signal cable, always pull it by the plug. Never pull on the cable itself as this may cause fire or electric shock.

DO NOT TOUCH THE PLUG WITH WET HANDS

Pulling or inserting the plug with wet hands may cause electric shock.

DO NOT USE ALCOHOL OR DISINFECTANTS ON THE MONITOR

Do not spray alcohol or disinfectants directly onto the monitor or use them near the monitor. Also, do not wipe the monitor with a cloth or sheet that contains alcohol or disinfectants. These may cause discoloration, deterioration, or cracking of the cabinet, damage to the surface treatment of the LCD panel, and deterioration of components.

SPECIAL NOTES ON LCD MONITORS

- The following symptoms are normal with LCD monitors and do not indicate a problem.

NOTE

- When you first turn on the LCD monitor, the picture may not fit in the display area because of the type of computer that is used. In this case, adjust the picture position to the correct position.
 - You may find slightly uneven brightness on the screen depending on the desktop pattern you use.
 - Due to the nature of the LCD screen, an afterimage of the previous screen may remain after switching the image, when the same image is displayed for hours. In this case, the screen is recovered slowly by changing the image or turning off the Power Switch for hours.
- This LCD cannot be used outdoors.
 - This LCD cannot be used with the screen facing upwards.
 - If you use a cable longer than the supplied one, the picture quality is not guaranteed.

USAGE CONFIRMATION

Product maximum non-stop usage hours following the installation guidelines in a clean and temperature-controlled environment: 24/7

The monitor is compatible for usage in Landscape/Portrait applications.

* Only ProLite LE9864UHS is compatible for usage in landscape applications.

IMAGE PERSISTENCE / IMAGE STICKING

Please be aware that all LCD screens can experience Image Persistence or Image Sticking. This occurs when a residual image remains visible on a screen when static images are displayed for long periods of time. LCD Image Persistence is not permanent but constant images being displayed for a long period of time should be avoided.

To counteract Image Persistence, turn off the monitor for as long as the previous image was displayed, so if an image was on the monitor for 1 hour and there is evidence of a residual or “ghost” image, you should turn off the monitor for 1 hour in order to clear the residual image.

For all LFD products, iiyama recommends displaying moving images and utilising a moving screen saver at regular intervals whenever the screen is idle. You could also turn off the monitor when not in use to assist the prevention.

Other ways to reduce the risk of Image Persistence will be to utilise the FAN-on function (if available), Low Backlight and Low Brightness settings.

FOR EXTENDED USE AS A PUBLIC MONITOR

■ Image Sticking on LCD Panel

When a static image is displayed for hours, an electric charge trace remains near the electrode inside the LCD producing a “ghost” image. (Image Persistence).

Image Persistence is not a permanent feature.

■ Recommendations

To prevent Image Sticking and promote longer life expectancy of monitor, we recommend the following:

1. Avoid static images displayed for long periods – change static images on continuous loop.
2. Turn off monitor when not in use, either by remote control or use Standby or Schedule functions.
3. Check the Monitor Menu Settings for "Pixel Shift" etc. and activate it when available. This will reduce the Image Sticking Effect.
4. When monitor is installed in high ambient temperature environment(s) or in an enclosed position, utilise the Cooling Fan, Screen Saver and Low Brightness functions.
5. Suitable ventilation for any monitor is an expectation of any installation – climate control systems may need to be employed.
6. We strongly recommend utilisation of active cooling with fans for long operation times or high ambient temperature environments.

CUSTOMER SERVICE

NOTE

- If you have to return your unit for service and the original packaging has been discarded, please contact your dealer or iiyama service center for advice or replacement packaging.

CLEANING

WARNING

If you drop any materials or liquids such as water into the monitor when cleaning, unplug the power cable immediately and contact your dealer or iiyama service center.

- For safety reasons, turn off the power switch and unplug the monitor before you clean it.

CAUTION

- Do not spray alcohol or disinfectants directly onto the monitor or use them near the monitor. Also, do not wipe the monitor with a cloth or sheet that contains alcohol or disinfectants. These may cause discoloration, deterioration, or cracking of the cabinet, damage to the surface treatment of the LCD panel, and deterioration of components.
- To avoid potential damage on the monitor (LCD panel / cabinet / connector terminals) or accessories, never use the following strong solvents or cleaning sheets. These may cause discoloration, deterioration, or cracking of the cabinet, damage to the surface treatment of the LCD panel, and deterioration of components.

Benzine	Hypochlorous acid water
Thinner	Acidic or alkaline solvents
Alcohol	Wax
Bleach	Abrasives
Peroxide	Office equipment cleaner
Acetone	Glass cleaner
Methylene chloride	Tissue paper
Toluene	Wet tissue
Ammonia	Chemical cloth
Sodium hypochlorite solution (Chlorine bleach)	Cleaning paper
	etc.

NOTE

- To protect the LCD panel, do not scratch or rub the screen with a hard object.
- Do not leave the LCD panel wet. If water droplets or the like get on it, immediately wipe it off with a dry, soft cloth. Leaving it on may cause discoloration or stains on the LCD panel. In addition, if moisture gets inside the monitor, it may cause damage.
- Touching the cabinet with any product made from rubber or plastic for a long time may cause degeneration or loss of paint on the cabinet.

Regular care

Gently wipe the cabinet with a soft, dry and clean cloth. If your monitor is particularly dirty, soak the cloth in a mild detergent thoroughly diluted with water, wring it out tightly, and then wipe the dirt off. Then immediately wipe it with a soft, dry cloth.

Alcohol disinfection

Alcohol disinfection may cause discoloration, deterioration, or cracking of the cabinet, damage to the surface treatment of the LCD panel, and deterioration of components. Instead, we recommend disinfecting your hands away from the monitor before and after use.

If you absolutely must disinfect the monitor with alcohol, please understand above warnings and cautions in advance. Also, avoid frequent alcohol disinfection.

BEFORE YOU OPERATE THE MONITOR

FEATURES

- ◆ Supports Resolutions up to 3840 × 2160
- ◆ High Contrast 4000:1 (Typical) / Brightness 500cd/m² (Typical) : ProLite LH4364UHS
- ◆ High Contrast 1200:1 (Typical) / Brightness 500cd/m² (Typical) : ProLite LH5064UHS
- ◆ High Contrast 5000:1 (Typical) / Brightness 500cd/m² (Typical) : ProLite LH5564UHS / ProLite LH6564UHS / ProLite LH7564UHS / ProLite LE9864UHS
- ◆ Digital Character Smoothing
- ◆ 2 × 10W Stereo Speakers : ProLite LH4364UHS / ProLite LH5064UHS / ProLite LH5564UHS / ProLite LH6564UHS / ProLite LH7564UHS
- ◆ 2 × 20W Stereo Speakers : ProLite LE9864UHS
- ◆ Standby Feature
- ◆ VESA Mounting Standard (300mm×300mm) Compliant : ProLite LH4364UHS
- ◆ VESA Mounting Standard (400mm×300mm) Compliant : ProLite LH5064UHS
- ◆ VESA Mounting Standard (400mm×400mm) Compliant : ProLite LH5564UHS
- ◆ VESA Mounting Standard (500mm×500mm) Compliant : ProLite LH6564UHS / ProLite LH7564UHS
- ◆ VESA Mounting Standard (700mm×500mm) Compliant : ProLite LE9864UHS

CHECKING THE CONTENTS OF THE PACKAGE

The following accessories are included in your package. Check to see if they are enclosed with the monitor. If anything is missing or damaged, please contact your local iiyama dealer or regional iiyama office.

- | | | |
|------------------------------------|---------------------|-----------------------------------|
| ■ Power Cable (2pcs) ^{*1} | ■ HDMI Cable | ■ RS-232C Cable |
| ■ Remote Control | ■ Battery (2pcs) | ■ Wall Mounting Kit ^{*2} |
| ■ Safety Guide | ■ Quick Start Guide | |

CAUTION

^{*1} All guarantees and warranties are void for any problems or damage caused by a power cable not supplied by iiyama

An approved power cable greater or equal to H03VVH2-F, 2x0.75mm² must be used.

^{*2} Different monitor sizes are supplied with different types of wall mounting brackets. Please refer to the corresponding installation instructions based on your model number to ensure proper installation.

UNPACKING

CAUTION

Moving the monitor requires at least two people. If not, it may drop and could result in a serious injury.

<Front>

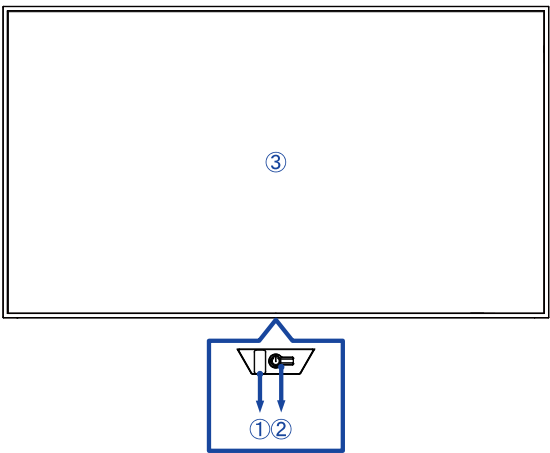

①	Power Indicator	Off	Normal Operation
		Red	Lighting : Standby Mode Flash : 3-second intervals : Signal Standby Mode 5-second intervals : Network Standby Mode 7-second intervals : When SCHEDULE is enabled.
②	Power Button 	Short press to toggle standby/on. Long press for 3 seconds to open the input source menu when the monitor is powered on.	
③	Remote Sensor		

LED color	Status	Description
Red	Fast blinking (three seconds on, three seconds off)	The monitor is in signal standby mode, waiting for input signals while saving power.
Red	Slow blinking (five seconds on, five seconds off)	The monitor is in network standby mode, staying connected for quick response while saving power.
Lights off		The monitor is activated.
Red	Slow blinking (seven seconds on, seven seconds off)	Blinking red light indicates the activation of scheduled operations.
Red	Solid	The monitor is in standby mode, using minimal power until active.

NOTE

If standby modes overlap, the light color reflects the priority order: Signal standby mode → Network standby mode → Standby mode

<Back>

■ ProLite LH4364UHS / ProLite LH5064UHS / ProLite LH5564UHS / ProLite LH6564UHS

ENGLISH

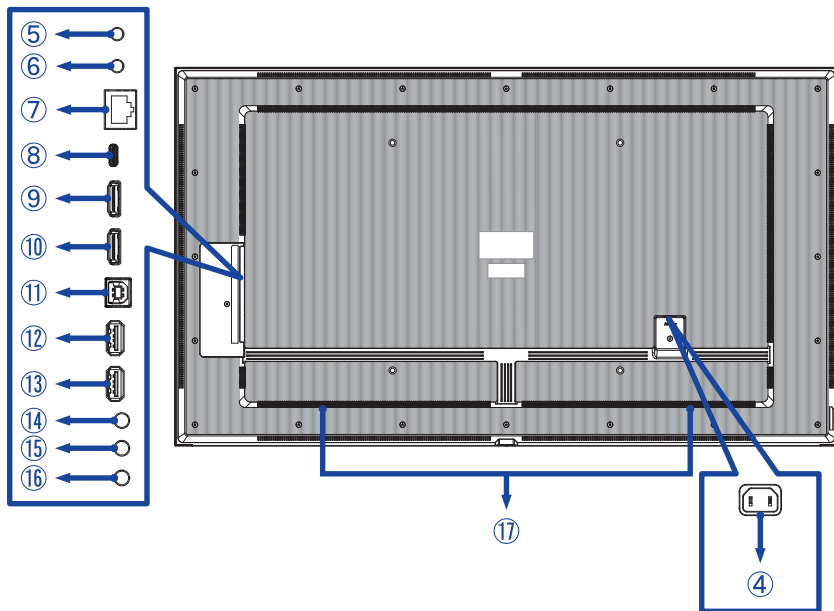

■ ProLite LH7564UHS

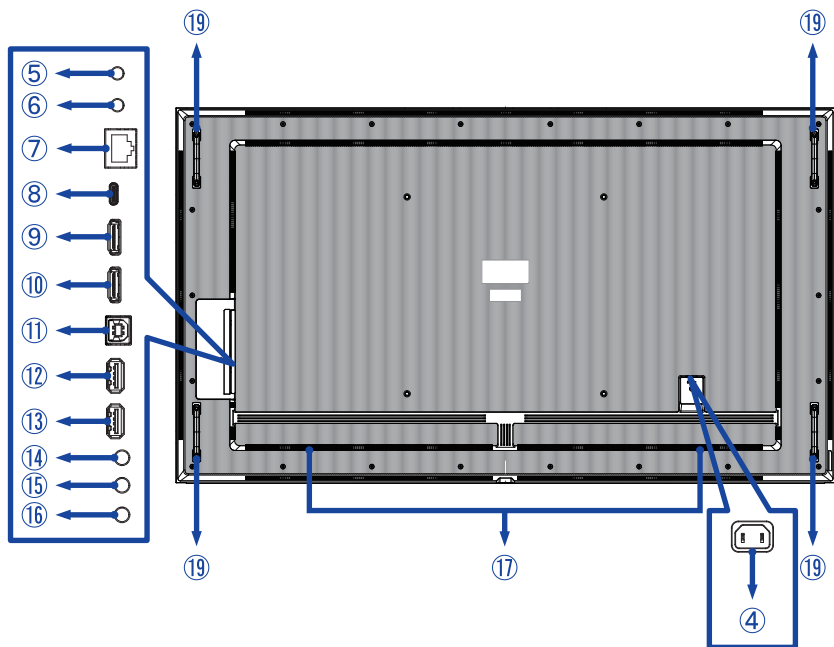

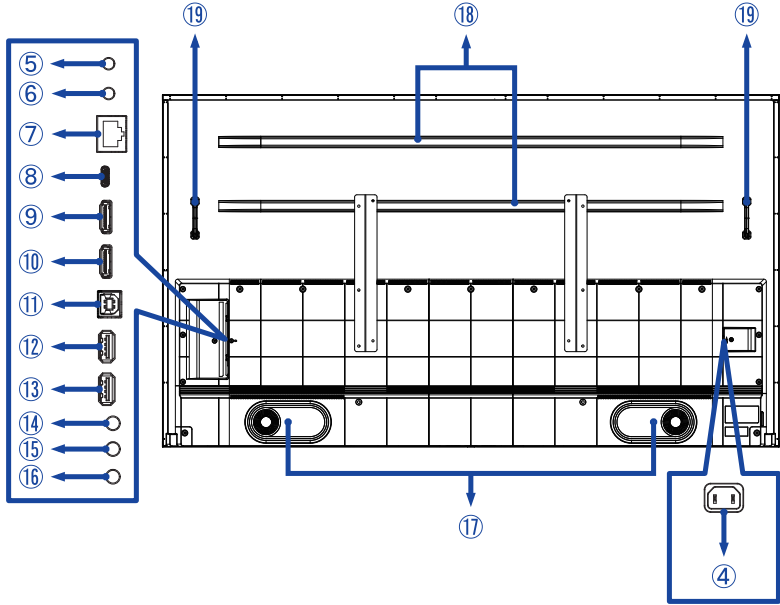

④	AC IN	AC-INLET	AC Connector(~ : Alternating current) (~) (AC-IN)
⑤	RS232C IN	ø 2.5mm Sub-mini Jack	RS232C Connector
⑥	RS232C OUT	ø 2.5mm Sub-mini Jack	RS232C Connector
⑦	LAN	RJ45	RJ45 Connector
⑧	USB-C2.0 IN	USB-C 2.0 (5V, 3A)	USB-C Connector
⑨	HDMI1 IN	HDMI	HDMI Connector
⑩	HDMI2 IN	HDMI (HDMI ARC support)*	HDMI Connector
⑪	USB-B upstream	USB-B 2.0 (5V, 500mA)	USB-B Connector
⑫	USB	USB2.0 (5V, 500mA)	USB Connector
⑬	USB	USB2.0 (5V, 500mA)	USB Connector
⑭	AUDIO OUT	ø 3.5mm Mini Jack	Headphone Connector
⑮	IR IN	ø 3.5mm Mini Jack	IR Connector
⑯	IR OUT	ø 3.5mm Mini Jack	IR Connector
⑰	Speakers		
⑱	Reinforcing rib		
⑲	Handles		

* The HDMI ARC function is only available when you enable HDMI with One Wire.
The connected device (e.g. soundbar) needs to have/support HDMI ARC.

INSTALLATION

CAUTION

- Follow the manual instructions for the type of mount you have selected. Refer all servicing to qualified service personnel.
- Moving the monitor requires at least two people.
- Before installing, please make sure the wall is strong enough to hold the necessary weight of the monitor and the mount.
- This product cannot be used with the monitor screen facing downward/upward.
- Regularly check the tightness of the screws. If the screws are not tight enough, the monitor may come off and cause injury or damage.

[WALL MOUNTING]

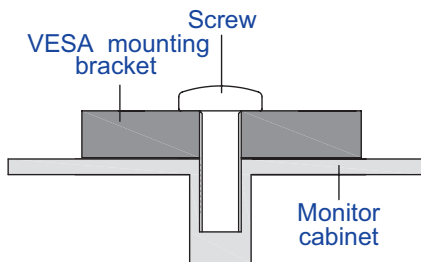

CAUTION

Use four M6/M8 x 16/18 mm* screws to fix a VESA mounting bracket to the monitor. Make sure that all screws are tightened and secured properly.

When using the wall mounting, consideration of thickness of the VESA mounting bracket needs to be taken. The thickness of the VESA mounting bracket is assumed to be approx. 2.5 mm.

Using a screw longer than this may cause electric shock or damage because it may contact with the electrical parts inside the monitor.

- * M6(L=18mm) : ProLite LH4364UHS / ProLite LH5064UHS / ProLite LH5564UHS
 M8(L=16mm) : ProLite LH6564UHS / ProLite LH7564UHS / ProLite LE9864UHS

• ProLite LH4364UHS / ProLite LH5064UHS / ProLite LH5564UHS

- ① Use 4pcs of M6x18mm screws to fix two brackets at the back of monitor.

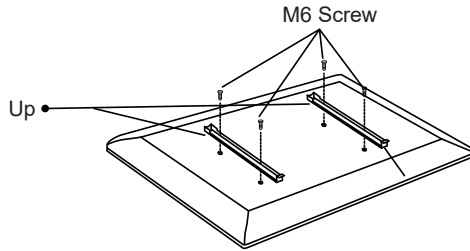

- ② Position the wall plate and secure it with 4pcs of ST7x55mm screws and anchors; drill holes if needed.

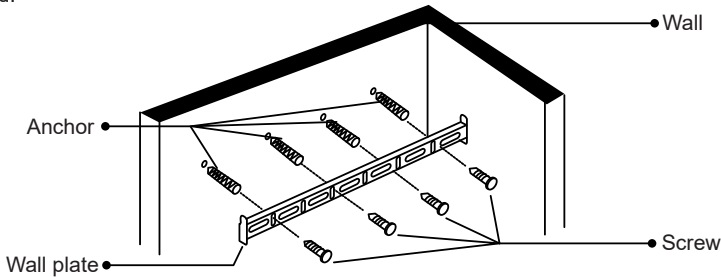

- ③ Hang the pre-assembled monitor unit onto the wall plate and push the bottom of the monitor to secure the brackets. To remove the monitor, simply pull down the straps to release the brackets. After assembly is complete, neatly organize all wires and cables.

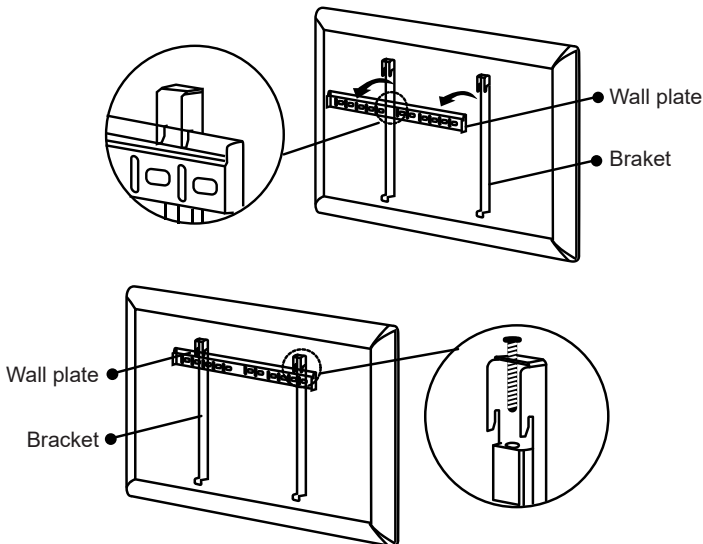

• **ProLite LH6564UHS**

- ① Use 4pcs of M8x16mm screws to fix two brackets at the back of monitor.

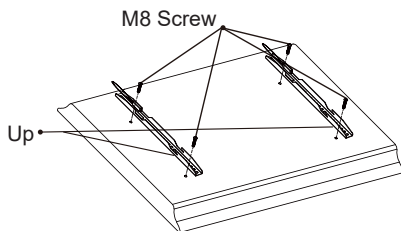

- ② Position the wall plate and secure it with 6pcs of ST7x55mm screws and anchors; drill holes if needed.

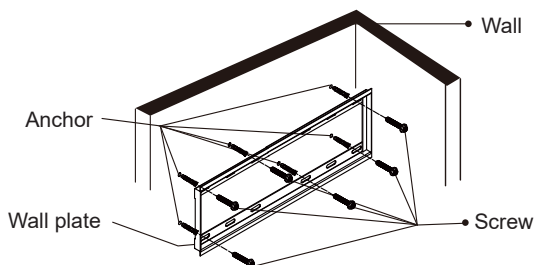

- ③ Hang the pre-assembled monitor unit onto the wall plate and push the bottom of the monitor to secure the brackets. To remove the monitor, simply pull down the straps to release the brackets. After assembly is complete, neatly organize all wires and cables.

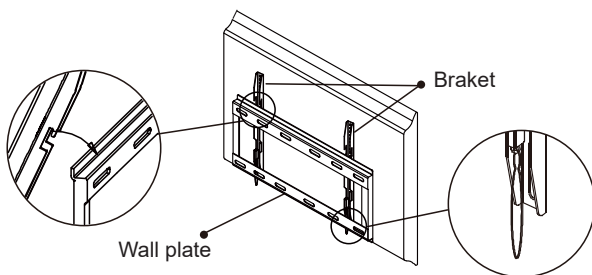

• ProLite LH7564UHS

- ① Use 4pcs of M8x16mm screws to fix two brackets at the back of monitor.

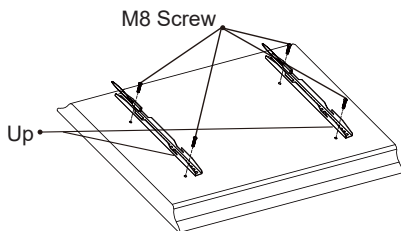

- ② Position the wall plate and secure it with 6pcs of ST7x55mm screws and anchors; drill holes if needed.

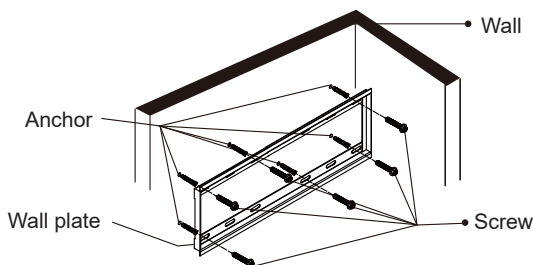

- ③ Before wall mounting, connect the power and signal cables to the device without plugging into the power supply. Attach the brackets to the wall plate, then turn on the power.

1. Slide the bracket hook to the notch or right end of the wall plate, then align the device vertically to secure it tightly.

2. Slide the device horizontally to hook the bracket onto the non-notch or leftmost end of the wall plate as shown.

3. Tilt the bottom of the device slightly upward to check stability. A small tilt confirms the bracket is securely fixed.

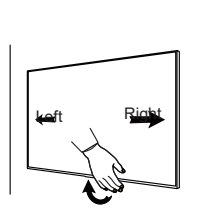
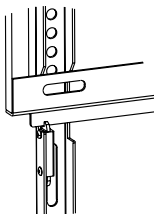
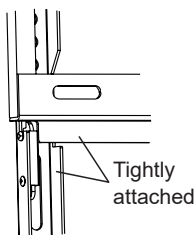

- ④ Turn off the power and unplug the device before removing it.

NOTE At least 2 people are required to prevent damage to the device and ensure safety.

1. Slide the bracket hook to the right end of the wall plate.
2. Lift the monitor off the wall plate.

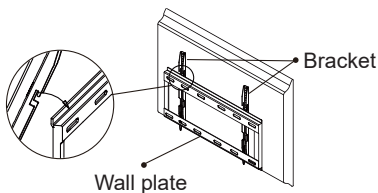
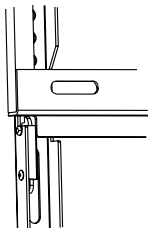

• ProLite LE9864UHS

- ① Mark the hole positions on the wall and ensure the wall plate is level.

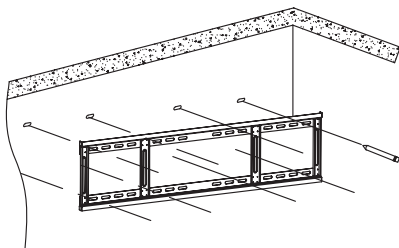

- ② Attach the wall plate to the wall. Position the wall plate and secure it with 8pcs of ST7x55mm screws and anchors; drill holes if needed.

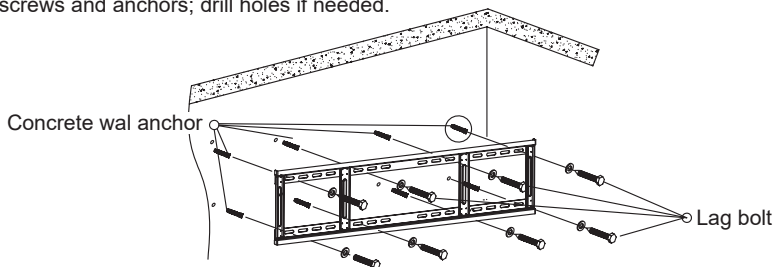

- ③ Use 4pcs of M8x16mm screws to fix the brackets to the back of the interactive panel. Screw them in and tighten the safety screws.

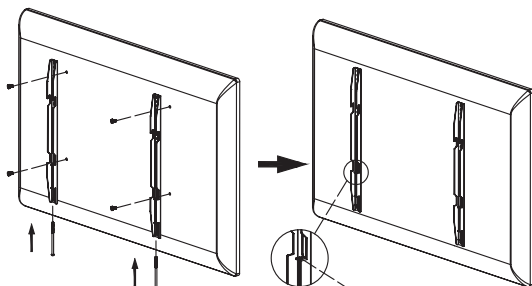

* You could screw the safety screw out about 2mm.

- ④ Carefully mount the interactive flat panel onto the wall plate.

NOTE Ensure that the safety bolt is fully tightened after the brackets are securely hung on the wall plate.

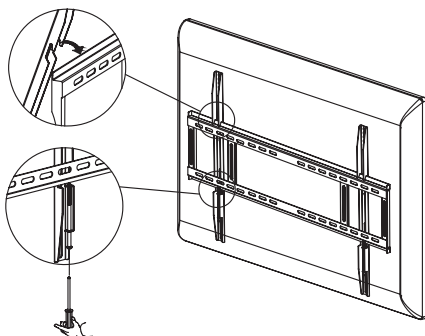

[ROTATING THE MONITOR]

- ProLite LH4364UHS / ProLite LH5064UHS / ProLite LH5564UHS / ProLite LH6564UHS / ProLite LH7564UHS

The monitor is designed to be compatible with both landscape and portrait modes.

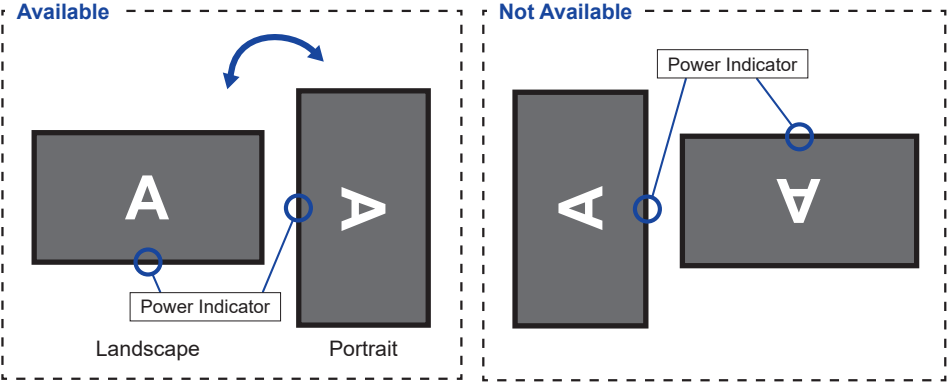

- ProLite LE9864UHS

The monitor is designed to be compatible only with the landscape mode.

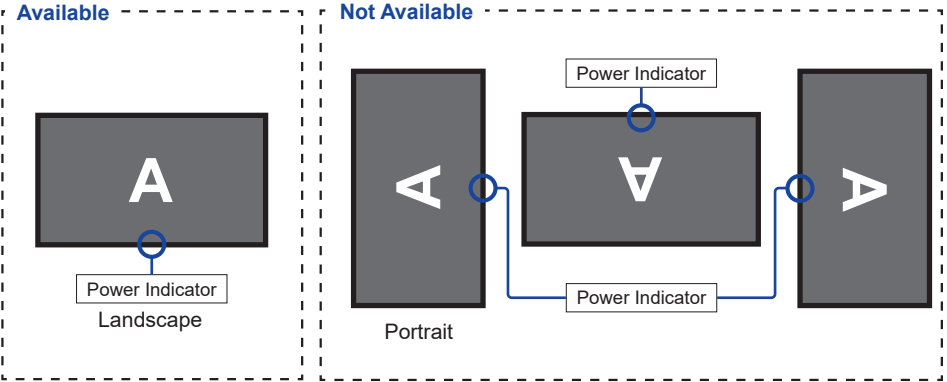

FUNCTIONS OF THE REMOTE CONTROL

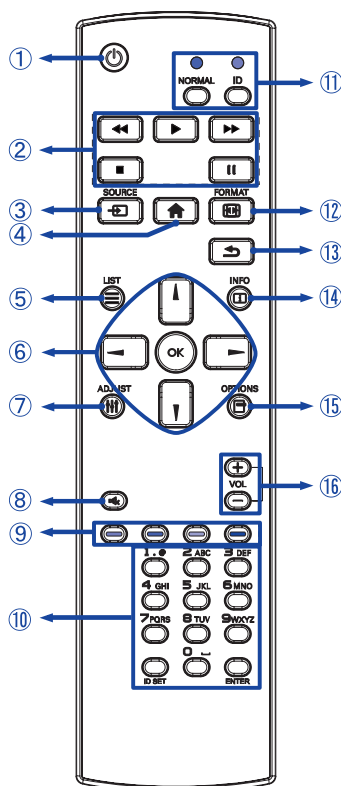

①		Turns the display ON and OFF. Quickly start "Meeting room".
②	[PLAY]	Control playback of media files. ▶ : Play ■ : Stop ⏸ : Pause ◀◀ : Fast-Rewind ▶▶ : Fast-Forward
③	SOURCE	Selects the source. Press ▲ / ▼ / ◀ / ▶ button to select from HDMI1, HDMI2, TYPE C, Web Player, CMS, File Manager, Media Player, PDF Player or Custom. Press [OK] button to confirm and exit.
④	HOME	Opens the display's on-screen menu systems.
⑤	LIST	Return to the previous menu.
⑥		Navigates through menus and settings. ▲ : Up Button ▼ : Down Button ◀ : Left Button ▶ : Right Button In Media Player: ◀ : Previous file ▶ : Next file In PDF Player: ◀ : Previous page ▶ : Next page
	OK	Confirms your selection or save changes.
⑦	ADJUST	Not available on this model.
⑧	MUTE	Turns on or off the mute function when the Menu is not displayed.
⑨	COLOR	Not available on this model.
⑩	NUMBER/ ID SET/ ENTER	Enter text for network setting or ID setting.
⑪	ID Mode	ID: To enter ID Mode NORMAL: To leave ID Mode
⑫	FORMAT	Change picture format.
⑬	BACK	Returns to a previous menu or closes the OSD Menu.
⑭	INFO	Provides source and resolution information. Press the button for 6 seconds to unlock the remote control.
⑮	OPTIONS	Operates media files in Media Player.
⑯	VOLUME - / +	VOLUME- : Decreases the sound volume. VOLUME+ : Increases the sound volume.

PREPARING THE REMOTE CONTROL

To use the remote control, insert the two dry batteries.

CAUTION

- Do not use any other batteries other than those specified in this manual for the Remote Control.
- Do not insert old and new batteries together in the Remote Control.
- Make sure that the terminals match the "+" and "-" indications in the battery compartment.
- Remove the dead batteries immediately to prevent them from liquid leaking into the battery compartment.
- Burst batteries or the electrolyte from these batteries may cause stains, fire or injury.

- ① Press and then slide the battery cover to open it.

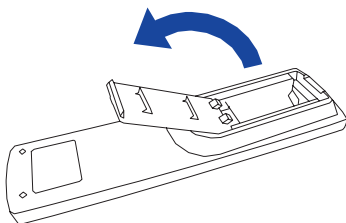

- ② Align and insert two AAA batteries according to their plus and minus ports (as indicated in the remote control).

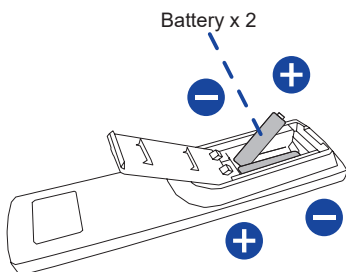

- ③ Replace the battery cover.

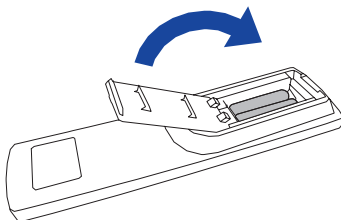

NOTE

- Refer to the above instructions when taking out the batteries.
- Replace with new batteries when the Remote Control does not work close to the monitor. Use AAA dry batteries. Risk of explosion if battery is replaced by an incorrect type.
- Operate the Remote Control by pointing it toward the Remote Sensor on the monitor.
- Other manufacturers remote control will not work with this monitor. Use the provided Remote Control ONLY.
- Used batteries needed to follow the city rule to be discarded. (suggestion: to dispose of used batteries please follow correct policy as per your council regulations)
- Batteries shall not be exposed to excessive heat such as sunshine, fire or the like.
- If you do not intend to use the remote control for a long period, remove the batteries.

ID REMOTE CONTROL

You can set the remote control ID when you want to use the remote control on specific monitors.

ID Mode (To enter ID Mode) :

Press and hold the ID button until the red LED blinks twice.

Normal Mode (To leave ID Mode) :

Press and hold the Normal button until the green LED blinks twice.

■ Programming ID Mode

To assign an ID to a remote control.

1. Enter ID Mode.
2. Press and hold the ID SET button until the red LED blinks twice.
3. Using the number button, input the desired ID. (01 - 255)
4. Press the ENTER button to confirm ID.
5. The red LED will blink twice when ID has been confirmed.

NOTE

- Not pressing any button within 10 seconds will exit the ID Mode.
- If an error pressing of buttons other than the digits occurred, wait 1 second after the red LED lights off and then lights up again, then press the correct digits again.
- To cancel or stop programming an ID, press the ID SET button.
- It is necessary to set up the ID number for each monitor before selecting its ID number.

■ Use ID Mode

1. Enter ID Mode.
2. Input the ID of the monitor which would like to control by number button.
3. Press the INPUT button.

■ Turning the monitor ON



The monitor is turned On and the Power Indicator turns Transparent when you press the POWER button on the monitor or the Remote Control. The monitor is turned Off and the Power Indicator turns to Red when you press the POWER button on the monitor or the Remote Control. Press again to turn On the monitor.

NOTE

Even when using the standby mode or turning OFF the Power Switch, the monitor will consume a small amount of electricity. Disconnect the Power Cable from the power supply whenever the monitor is not in use or during the night, to avoid unnecessary power consumption



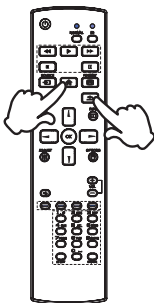

■ Display the adjustment menu page

The menu page appears on the screen when you press the  HOME button on the Remote Control. The menu page disappears when you press the  BACK button on the Remote Control again.



■ Move the cursor vertically

Select adjustment by pressing the  /  button on the remote control while the menu page is displayed on the screen.

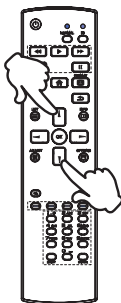

■ Move the cursor horizontally

Select menu or setting, or perform the adjustment by pressing the ◀ / ▶ button on the remote control while the menu page is displayed on the screen.

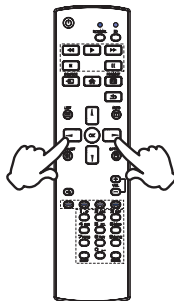

■ Adjust the volume of sound

Press the + / - button on the remote control to adjust the volume of sound when the menu page is not displayed on the screen.

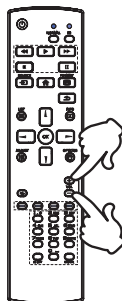

■ Switch the input signal

This is activated when you successively press the SOURCE button on the remote control.

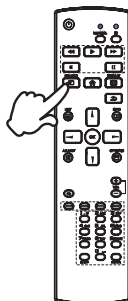

CONNECTING YOUR MONITOR : ProLite LH4364UHS / ProLite LH5064UHS / ProLite LH5564UHS / ProLite LH6564UHS / ProLite LH7564UHS

- ① Ensure that both the computer and the monitor are switched off.
- ② Connect the computer to the monitor with the signal cable.
- ③ Connect the computer with the RS-232C Cable from the monitor.
- ④ Connect the Power Cable to the monitor first and then to the power source.
- ⑤ Turn on your monitor (Main Power Switch and Power Switch) and computer.
- ⑥ Follow the OOB's instructions and finish the screen setup.

NOTE

- Make sure that the building installation has a circuit breaker of 120/240V, 20A (maximum).
- The signal cables used for connecting the computer and monitor may vary with the type of computer used. An incorrect connection may cause serious damage to both the monitor and the computer. The cable supplied with the monitor is for a standard connector. If a special cable is required please contact your local iiyama dealer or regional iiyama office.
- The socket-outlet shall be installed near the equipment and shall be easily accessible.
- Excessive sound pressure from ear-/headphones can cause hearing damage/hearing loss.

[Example of Connection]

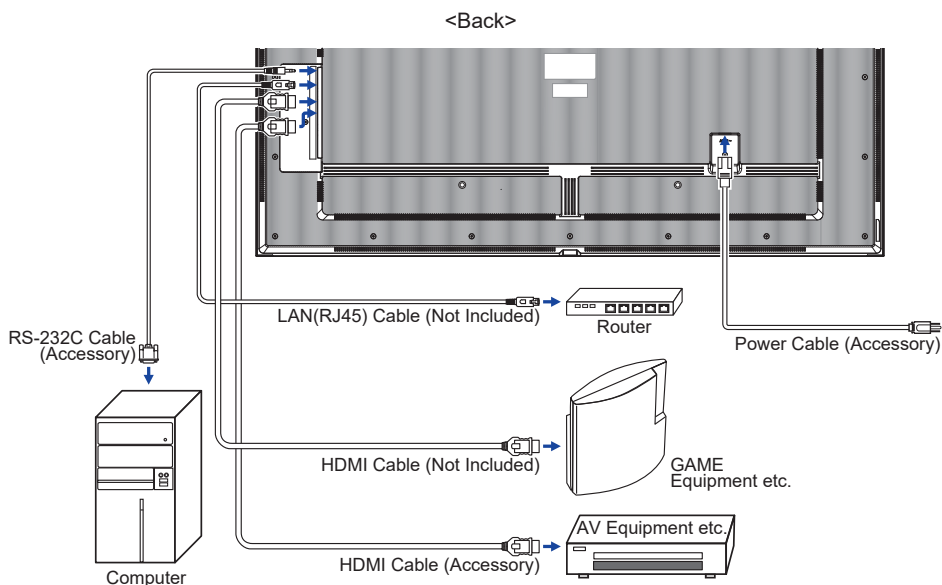

CONNECTING YOUR MONITOR : ProLite LE9864UHS

- ① Ensure that both the computer and the monitor are switched off.
- ② Connect the computer to the monitor with the signal cable.
- ③ Connect the computer with the RS-232C Cable from the monitor.
- ④ Connect the Power Cable to the monitor first and then to the power source.
- ⑤ Turn on your monitor (Main Power Switch and Power Switch) and computer.
- ⑥ Follow the OOB's instructions and finish the screen setup.

NOTE

- Make sure that the building installation has a circuit breaker of 120/240V, 20A (maximum).
- The signal cables used for connecting the computer and monitor may vary with the type of computer used. An incorrect connection may cause serious damage to both the monitor and the computer. The cable supplied with the monitor is for a standard connector. If a special cable is required please contact your local iiyama dealer or regional iiyama office.
- The socket-outlet shall be installed near the equipment and shall be easily accessible.
- Excessive sound pressure from ear-/headphones can cause hearing damage/hearing loss.

[Example of Connection]

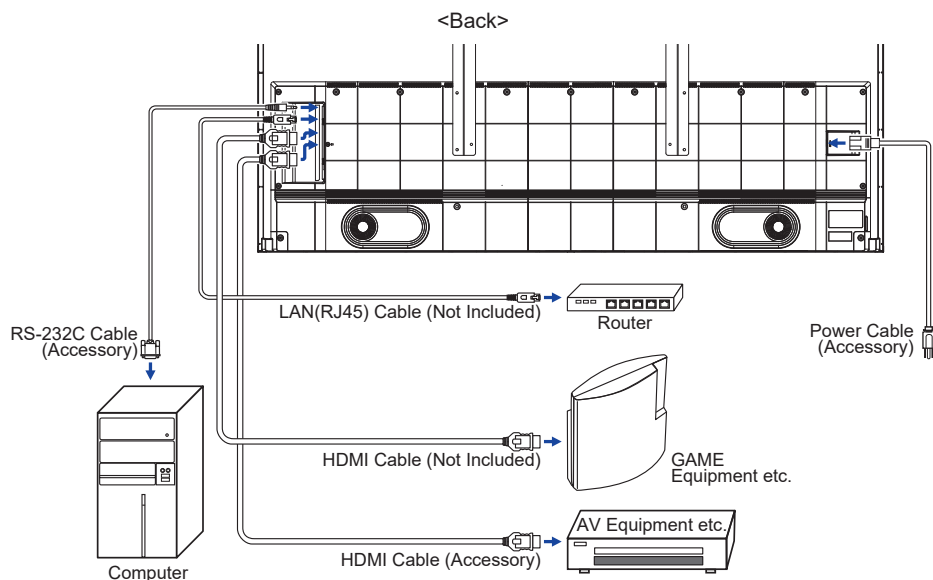

[Connection example with the peripheral device]

CAUTION

Turn off the power switch and unplug the monitor and peripherals before connection to avoid electric shock or damage.

NOTE

- Refer to the user manual of peripherals at the same time.
- Ensure you have the necessary cables as required.

- ProLite LH4364UHS
- ProLite LH5064UHS
- ProLite LH5564UHS
- ProLite LH6564UHS
- ProLite LH7564UHS

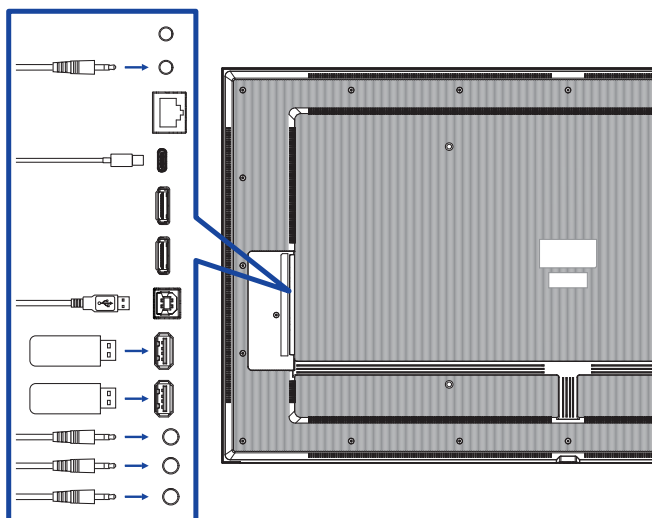

- ProLite LE9864UHS

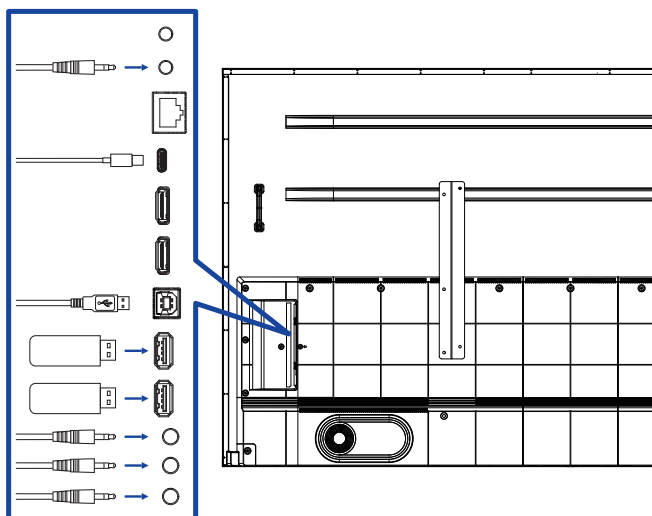

[About the daisy chain]

■ Monitor control connection

RS-232C

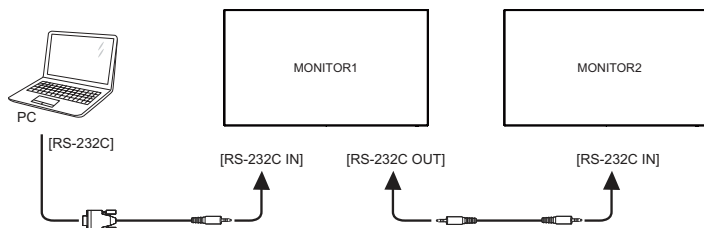

[To setup the network]

1. Switch on the router and switch on its DHCP setting.
2. Connect the router to this monitor with an Ethernet cable.
3. Press HOME button and 1668 on the remote control, then select Settings.
4. Select "Network & internet", then press OK button.
5. Select "Ethernet", then press OK button.
6. Follow the on-screen instructions to install the network.

NOTE

Connecting with a shielded CAT-5 Ethernet cable to comply with the EMC directive.

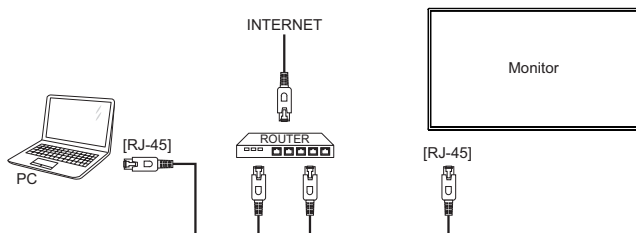

COMPUTER SETTING

■ Signal Timing

Change to the desired signal timing listed on page 68: COMPLIANT TIMING.

OPERATING THE MONITOR

To create the best picture, your iiyama LCD monitor has been preset at the factory with the COMPLIANT TIMING shown on page 68. You are also able to adjust the picture by following the button operation shown below.

- ① Press the **HOME** button on the remote control or select **System Settings** on the desktop to start the **On Screen Display** feature. There are additional **Menu** items which can be switched by using the **▲/▼** buttons on the remote control.

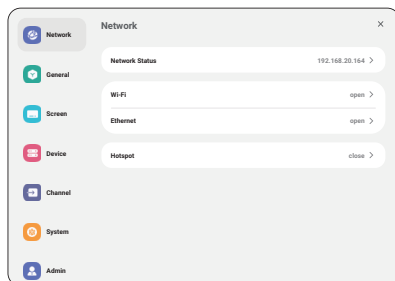

- ② Select the menu item you want to adjust. Press the **▶** button on the remote control, and use the **▲/▼** buttons to highlight the desired adjustment item. Then, press the **OK** button to enter the menu page.
- ③ Use the **▲/▼/◀/▶** buttons on the remote control to make the appropriate adjustment or setting.
- ④ Press the **↶** **BACK** button on the remote control to leave the menu, and the settings you just made would be automatically saved.

For example, to correct for sharpness, select Menu item of "General". Press the **▶** button on the remote control, then use the **▲/▼** buttons to select "Picture". Press **OK**, and then use the **▲/▼** buttons to select "Sharpness".

Use the **◀/▶** buttons on the remote control to change the sharpness settings. The sharpness of the overall monitor should be changing accordingly while you are doing this.

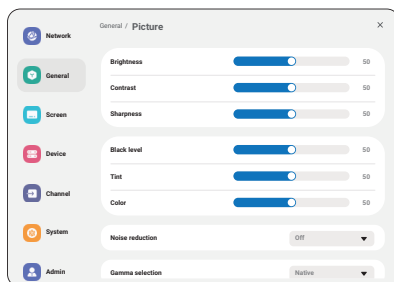

Press the **↶** **BACK** button on the remote control lastly, it ends, all changes are saved in the memory.

NOTE

- The **↶** **BACK** button on the remote control can be used to return previous menu item.
- Any changes are automatically saved in the memory when the On Screen Display disappears. Turning off the power should be avoided while using the Menu.
- All adjustments have only one setting which applies to all signal timings.

ADJUSTMENT MENU CONTENTS



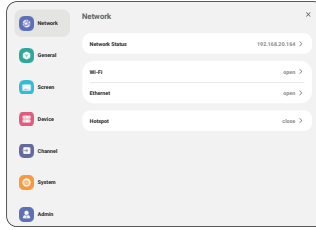





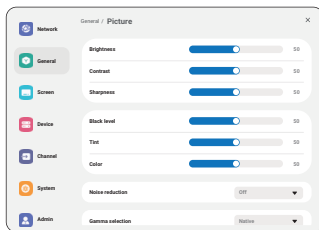



Network



Adjustment Item	Problem / Option	
Network Status	Once you are connected, the IP Address, Default gateway, Subnet mask and DNS are displayed automatically.	
WiFi	Set the wifi function Enable / disable and pairing to WiFi device.	
Ethernet	Set the wired network. On / Off	
	Acquire IP address	Auto acquire
		Configure manually
Hotspot	Set the Hotspot function.	

General



Adjustment Item	Problem / Option		Button to Press		
Picture	Brightness* ¹	Too dark Too bright		 	
	Contrast* ²	Too dull Too intense		 	
	Sharpness* ²	Too soft Too sharp		 	
	Black level* ²	Black is too dark Black is too bright		 	
	Tint* ²	Purplish Greenish		 	
	Color* ²	Too weak Too strong		 	
	Noise reduction* ²	Off	Noise Reduction is turned off.		
		Low	Electronic image noise caused by different media players is reduced.		
		Middle	Electronic image noise caused by different media players is reduced more than Low.		
		High	Electronic image noise caused by different media players is reduced more than Medium.		
	Gamma selection* ²	You can set the Gamma. Native / 2.2 / 2.4 / Sgamma / D-image			
	Color temperature	3000°K	9300°K		
		4000°K	10000°K		
		5000°K	Native	Original color temperature	
		6500°K	User1	User preset 1	
		7500°K	User2	User preset 2	
	Color control* ³	Set user color.			
		User1	R	Too weak Too strong	
			G		
			B		
	User2	2000K-10000K			
	Picture reset	Cancel	Return to Menu.		
		Reset	Picture setting will be restored to factory-preset data.		

General

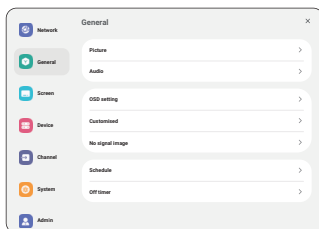

Adjustment Item	Problem / Option		Button to Press
Audio	Balance	Left side speaker is louder. Right side speaker is louder.	
	Treble	Too weak Too strong	
	Bass	Too weak Too strong	
	Volume	Too soft Too loud	
	Audio out (Line out)	Adjust audio output volume. Too soft Too loud	
	Maximum volume	Set the maximum volume.	
	Minimum volume	Set the minimum volume.	
	Mute	Off	Return the sound volume to the previous level.
		On	Turn off the sound temporarily.
	Audio out sync	Off	The speaker volume is different from the audio out (line-out) volume.
		On	The speaker volume is consistent with the audio out (line-out) volume.
	Speaker setting	Off	Disable the built-in speaker.
		On	Enable the built-in speaker.
	Audio reset	Cancel	Return to Menu.
		Reset	Audio setting will be restored to factory-preset data.
OSD setting	OSD timeout	You can set the OSD display duration time between 5 and 120 seconds. Off / 5 - 120 seconds	
	OSD H position	OSD is too left OSD is too right	
	OSD V position	OSD is too low OSD is too high	
	OSD Transparency	The background of OSD is made transparent. Off / 5 - 100	

General

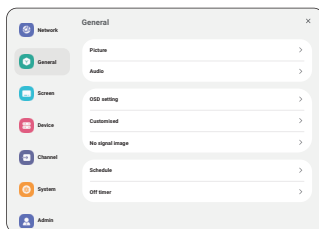

Adjustment Item	Problem / Option		Button to Press
OSD setting	Information OSD	Set the period of time the information OSD is displayed on the upper right corner of the screen. Off / 1 - 60 seconds	
Customised	Logo and animation	Off	iiyama Logo and animation does not display when the monitor is turned on.
		On	iiyama Logo and animation display when the monitor is turned on.
		Logo setting	Select boot logo.
		Animation setting	Select boot animation.
	Wallpaper	Set the Wallpaper.	
No signal image	Customize the image for the no signal screen. Off / On / User		
Schedule	Schedule list	Up to 7 schedules can be set.	
	Start time* ⁴	Set start time.	
	End time* ⁴	Set end time.	
	Input	Select default input source to use when the monitor is automatically turned on next time. HDMI1 / HDMI2 / USB-C / Web Player / CMS / File Manager* ⁵ / Media Player / PDF Playeer / Custom	
	Playlist	Choose playlist for the mediaplayer, PDF player and browser.	
	Days of the week	Set the day of the week. Mon. / Tues. / Wed. / Thur. / Fri. / Sat. / Sun.	
	Only execute for one week	Set whether to repeat every week. Off / On	
	Enable* ⁶	Enable / disable schedule.	
Off timer	Set when turn off the monitor. Off / 1 - 24 hours		

*¹ Adjust the Brightness when you are using the monitor in a dark room and feel the screen is too bright.

Brightness adjustment is disabled when Brightness of Panel saving is on.

*² Not available for Media Player, Browser, CMS, PDF Player and Custom inputs.

*³ It can be chose only when Color temperature is set to "User1/User2".

*⁴ The start time in the Schedule must be less than the end time.

*⁵ The photo or video files in the iiyama_play folder inside the USB flash drive can be automatically played using the Schedule setting.

Play order is alphabetical, 0 ~ 9, aA~ zZ, case-insensitive.

*⁶ Adjustments to "Enable" should be made only after Start time, End time, Input and week have been correctly set.

Screen

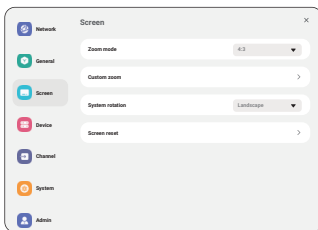

Adjustment Item	Problem / Option	
Zoom mode* ¹	Full	Enlarge the picture horizontally to fill the screen if the picture source is 4:3 (standard definition). When the picture source is 16:9 (high definition), it is not scaled.
	4:3	Display all pictures in 4:3 aspect ratio.
	Real	Display the picture dot by dot.
	21:9	Display all pictures in 21:9 aspect ratio.
	Custom	Customize zoom screen.
Custom zoom* ²	Zoom	Zoom the horizontal and vertical size of the image simultaneously.
	H zoom	Zoom the horizontal size of the image.
	V zoom	Zoom the vertical size of the image.
	H position* ³	Zoom / H Zoom values.
	V position* ³	Zoom / V Zoom values.
System rotation	Landscape	Display the OSD in Landscape mode.
	Portrait	Display the OSD in Portrait mode.
Screen reset	Cancel	Return to Menu.
	Reset	Screen setting will be restored to factory-preset data.

*¹ Not available for Media Player, Browser, CMS, PDF Player and Custom inputs.

*² It can be chose only when Zoom mode is set to "Custom".

*³ When the value of Zoom, H zoom and V zoom is "0", H position and V position cannot be adjusted.

Device

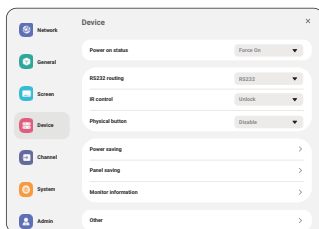

Adjustment Item	Problem / Option		
Power on status	Forced on	The monitor will turn on when the power cord is connected to a wall outlet.	
	Power off	The monitor will remain off when the power cord is connected to a wall outlet.	
	Last status	The monitor will return to the previous power status (on/off/standby) when removing and replacing the power cord.	
RS232 routing	Select the RS232 control port. RS232 / LAN RS232		
IR control	Select the operation mode of the remote control when multiple monitors are connected via an RS232C connection.		
	Lock All	Lock all of the remote control.	
	Lock all but Power	Lock all except the power of the remote control.	
	Lock all but Volume	Lock all except the volume of the remote control.	
	Lock all except PWR & VOL	Lock all except the volume and power of the remote control.	
	Unlock* ¹	Unlock the remote control.	
Physical button	Enable	Allows the use of physical buttons on the monitor.	
	Disable	Disables the physical buttons to prevent accidental use.	
Motorized stand* ²	When using a motorized stand, you can adjust and customized the height.		
	Up	Raise the motorized stand.	
	Down	Lower the motorized stand.	
	Slot 1 / Slot 2	Memorize your preferred height in Slot 1 or Slot 2.	
Power saving	WOL	Off	Disable wake on LAN function.
		On	Enable wake on LAN function.
	Source input wake up	Off	Disable Source input wake up function.
		On	Enable to wake the monitor from standby when an active signal is detected.
	Auto power off * ³	Off	Disable Auto power off function.
		On	Enable Auto power off the display after certain period 60mins / 90mins / 120mins / 150mins / 180mins / 210mins / 240mins
Panel saving	Brightness	Off	Backlight adjustment is off.
		On	The image brightness will be reduced to 40% of the maximum.

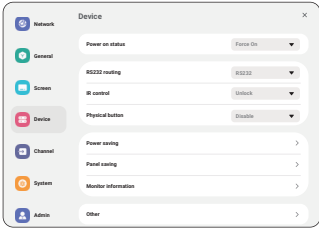
Device	
	
Adjustment Item	Problem / Option
Panel saving	Pixel shift
	For the monitor to slightly shift the position of pixels in four directions (up, down, left or right).
	Auto
	Move the position of the image automatically.
	Off
	Pixel shift is turned off.
	On
	Move the position of the image at set intervals. 10 - 900 seconds
Monitor information	Shows information about your monitor, including Model name, Serial No., Operation hours and SW version.
Other	Monitor ID
	Set ID to the monitor. 1 - 255
	Power LED light
	Off
	The Power Indicator is turned Off.
	On
	The Power Indicator is turned On.

- *¹ To unlock, press and hold the INFO button on the remote control for 6 seconds.
- *² Disabled if not connected to a motorized stand.
- *³ Auto power off default timing is 180mins, the function can be disabled or change to different timing at display first boot up or OSD advance option menu.

Channel

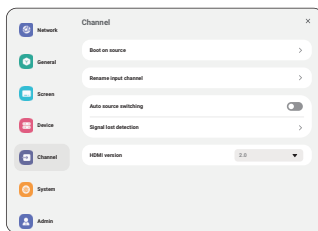

Adjustment Item	Problem / Option	
Boot on source ^{*1}	Last input	When the power is turned on, it starts with the same setting as when the power was last turned off. Off / On
	Input	Select input source when boot up. HDMI1 / HDMI2 / USB-C / Web Player / CMS / File Manager / Media Player / PDF Player / Custom
	Playlist	Select playlist index for Browser, Mediaplayer and PDF player.
Rename input channel	Customize the names of each signal source.	
Auto source switching ^{*2}	Off	Disable the Auto signal detection.
	On ^{*3}	Detects all sources automatically if there is no signal on the default input and selects the available signal automatically.
Signal lost detection	Switch when signal lost	Detects sources automatically by selecting the most recently used source, locking to a specified input, or following a user-defined order if there is no signal on the default input.
		Off / Recent input / Fixed source / By order
HDMI version ^{*4}	Set the version of the HDMI. 2.0 / 1.4	

^{*1} No failover function, system will keep source even the source is no signal input.

^{*2} The display detects and select available signal source automatically.

^{*3} Order of detection: HDMI1 → HDMI2 → USB-C → Web Player → CMS → File Manager → Media Player → PDF Player → Custom

^{*4} Suitable for HDMI input only.

System

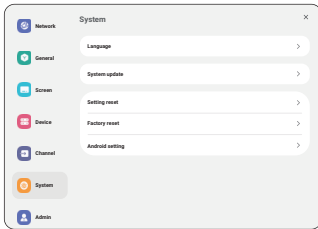

Adjustment Item	Problem / Option			
Language	English	English	Deutsch	German
	Français	French	Italiano	Italian
	Español	Spanish	Русский	Russian
	Polski	Polish	Nederlands	Dutch
	Dansk	Danish	Svenska	Swedish
	Suomi	Finnish	Norsk bokmål	Norwegian
	Čeština	Czech	Türkçe	Turkish
System update	OTA	Firmware update.		
	Local update			
Setting reset	Cancel	Return to Menu.		
	Reset	System setting will be restored to factory-preset data.		
Factory reset	Cancel	Return to Menu.		
	Reset	Factory-preset data is restored.		
Android setting	Enable Android launcher in settings to access feature.			

Admin

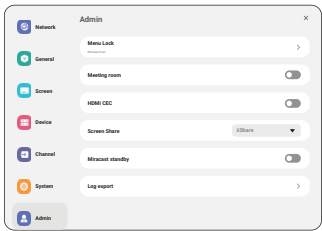

Adjustment Item	Problem / Option	
Menu Lock	The administrator can set a six-digit password when entering for the first time, and after setting it, users need to enter the corresponding password to enter the administrator page again.	
Meeting room	When it is turned on, no signal only resting screen, users can wake up the screen at any time using the remote control, buttons, or any signal-carrying cable to connect the screen and the system.	
HDMI CEC	Off	Disable link according to HDMI CEC.
	On	Enable link according to HDMI CEC.
Screen Share	Select the system for screen sharing. iiShare / EsharePro	
Miracast standby	Off	Disables Miracast reception during standby mode.
	On	Enables Miracast reception during standby mode.
Log export	Exports system logs for troubleshooting or review.	

INITIAL SETUP

① Select display language.

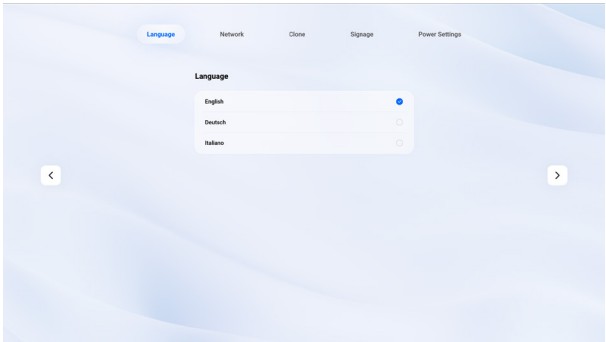

② Select Network Connection.

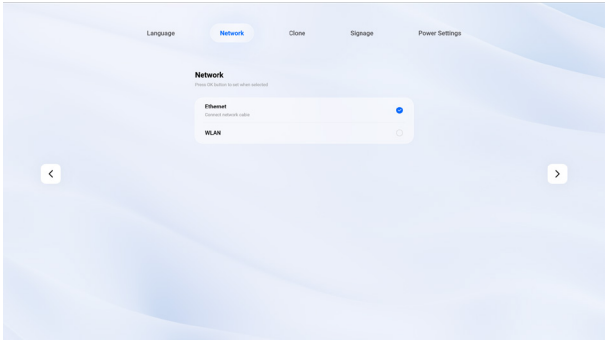

③ Select clone source.

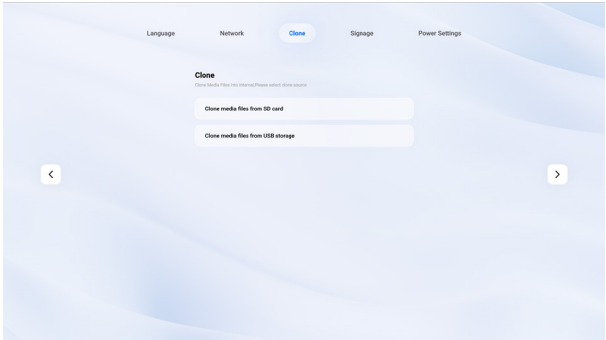

④ Set parameters for your monitor.

The screenshot shows the 'Signage' settings page. At the top, there are tabs for 'Language', 'Network', 'Clone', 'Signage', and 'Power Settings'. The 'Signage' tab is selected. Below the tabs, the 'Signage' section is titled 'Personalized to the user'. It contains several input fields: 'Signage display name' with the value 'FD6462940714a', 'Account/organization ID' with the value '001', 'Server Address', 'Expire video count', and 'Storage Path'. The 'Storage Path' is set to 'Internal storage' and is expanded to show a list of options: '内置存储一' (Internal storage 1), '内置存储二' (Internal storage 2), '内置存储3' (Internal storage 3), '内置存储4' (Internal storage 4), and '内置存储5' (Internal storage 5). Navigation arrows are visible on the left and right sides of the screen.

⑤ Setting up your energy strategy.

The screenshot shows the 'Power saving' settings page. At the top, there are tabs for 'Language', 'Network', 'Clone', 'Signage', and 'Power Settings'. The 'Power Settings' tab is selected. Below the tabs, the 'Power saving' section is titled 'Setting up your energy saving strategy'. It contains three settings: 'Auto power off' set to '180mins', 'WOL' set to 'OFF', and 'Source input auto up off' set to 'OFF'. Navigation arrows are visible on the left and right sides of the screen.

APPLICATION

Press the  LIST button on the remote control.

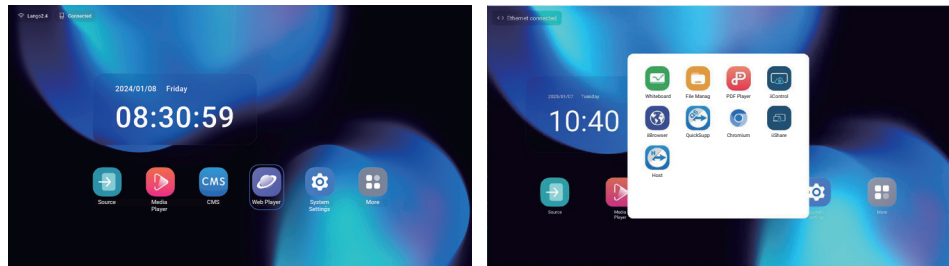

[Source]

Select an input source for connection.

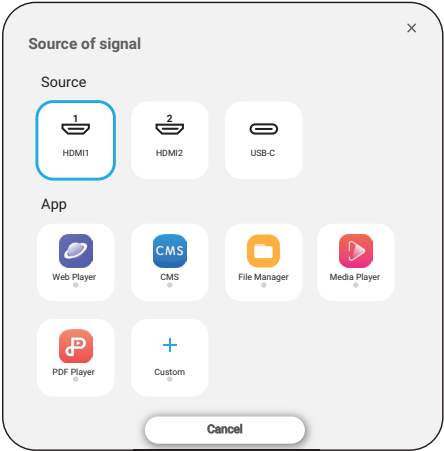

[Android Setting]

Access the Android settings through the OSD menu by selecting the 'Android Setting' option.

Network & internet 		
Adjustment Item	Problem / Option	
Wi-Fi	Set the wifi function Enable / disable and pairing to WiFi device.	
	Wifi list	Display a list of WiFi networks
	Add network	Network name
		Security
		Advanced options
	Network preferences	Turn on wifi automatically
		Notify for public networks
		Install certificates
		Wi-Fi Direct
	Saved networks	Save wifi networks on this monitor.
Ethernet** ¹	Set the wired network. On / Off	
	MAC** ²	Assign MAC for this monitor.
	IP address	Assign IP address for this monitor.
	Netmask	Assign Netmask for this monitor.
	Gateway	Assign Gateway for this monitor.
	DNS1	Assign DNS server address.
	DNS2	
	IPv6 address	Assign IPv6 address for this monitor.
	IPv6 Default gateway	Assign IPv6 Default gateway for this monitor.
	IPv6 DNS Server	Assign IPv6 DNS server address.
	Ethernet IP mode	Static
		DHCP
	Proxy	Set the proxy server. None / Manual / Proxy Auto-Config
Hotspot & tethering	Wifi hotspot	Set the Hotspot function.
	Ethernet tethering	Set the tethering function

*1 The MAC address/Ethernet address can be found on the label located on the back of the monitor.

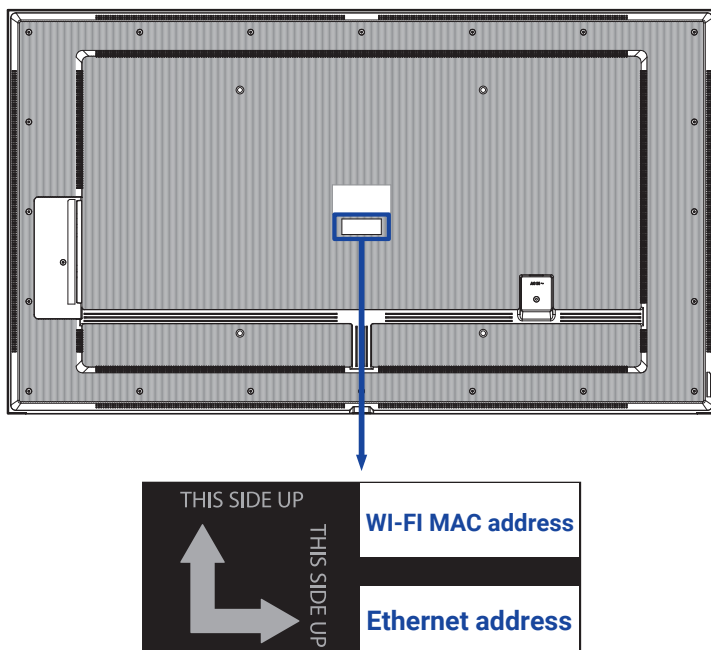

*2 If needed to use the Wi-Fi MAC address for some specific Network settings, please ensure that the Wi-Fi MAC address setting to "Use device MAC".

Apps & Notification

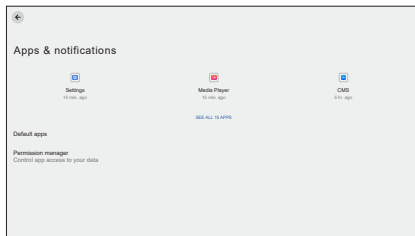

Adjustment Item	Problem / Option	
App info	Display all applications.	
Default apps	Browser app	Set the default apps.
	Home app	
	Opening links	
Permission manager	App permissions	Set app permissions.

Display

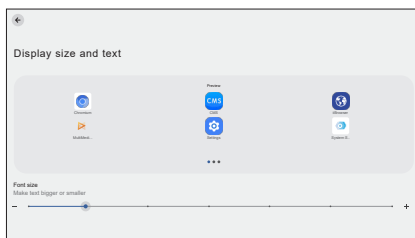

Adjustment Item	Problem / Option	
Font size	Small	Set the font size.
	Default	
	Large	
	Largest	

Signage display

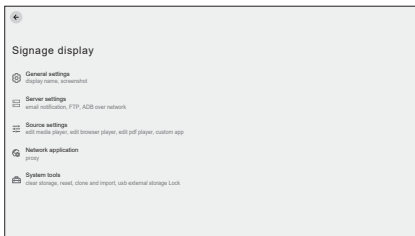

Adjustment Item	Problem / Option		
General settings	Signage display name	Set the monitor name.	
	Screenshot	Disable / Enable(Interval, Start time, End time, Repeat, Save to, Purge Screenshots, Send screenshots via email)	
Server settings	Email Notification	Disable / Enable(SMTP, Manager Email, Test)	
	FTP	Disable / Enable(Account, Password, Storage Path, Port)	
	ADB over network	Access network connection with port 5555.	
Source settings	Edit Media Player	Edit Media Player playlist and effect settings.	
	Edit Browser Player	Edit Browser list and effect settings.	
	Edit PDF Player	Edit PDF Player playlist and effect settings.	
	Storage path	Set the Media player, PDF player, Browser storage location.	
	Custom app	Edit the Custom app.	
Network application	Proxy	Set the proxy server. Disable / Enable (Hostname: Proxy server IP Address, Port: Proxy server port number, Type: Proxy server type) Authentication / Username / Password	
System tools	Clear Storage	Clear all data in signage folders. All / Internal storage / USB storage	
	Reset	Erase all data	Factory-preset data is restored.
	Clone and Import	Clone	Copy the OSD setting, playlist and media files*.
		Import	Import from signage folder under USB. Internal storage
	USB external storage Lock	Disable	USB External Storage unlock.
		Enable	USB External Storage lock.

* Media files are the media contents that are copied to this device while creating playlists in Browser, Media Player and PDF player source.

Security

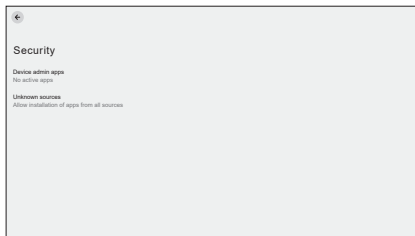

Adjustment Item	Problem / Option
Device admin apps	Display credential storage information.
Unknown sources	Disable / Enable installation of apps from unknown sources.

System

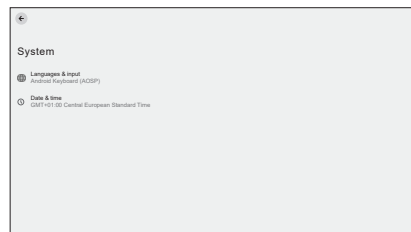

Adjustment Item	Problem / Option	
Language & Input	Languages	Set display language, keyboard and input method.
	On-screen keyboard	Language: English / Deutsch / Français / Italiano / Español / Русский / Polski / Nederlands / Česky / Dansk / Svenska / Suomi / Norsk bokmål
Date & time	Set time automatically	Set the Date and Time.
	Time zone	Set Time zone.
	Ntp server	

About device



Adjustment Item	Problem / Option	
Legal information	Third-party licenses	Main info in About: Legal / Model / Android version / Build number / Build version Automatically search update .zip from USB or SD card. When you select the updated .zip file, the monitor will restart and the update will start.
	System Webview licenses	
Model	Model	
	Serial number	
	Hardware version	
Android version	Android version	
	Android security update	
	Kernel version	
	Build number	
Build number		
Build version		

■ Quick Info
Press the Info button and number 77 on the remote control.
Display the Network and Monitor etc. information.

[Media Player]

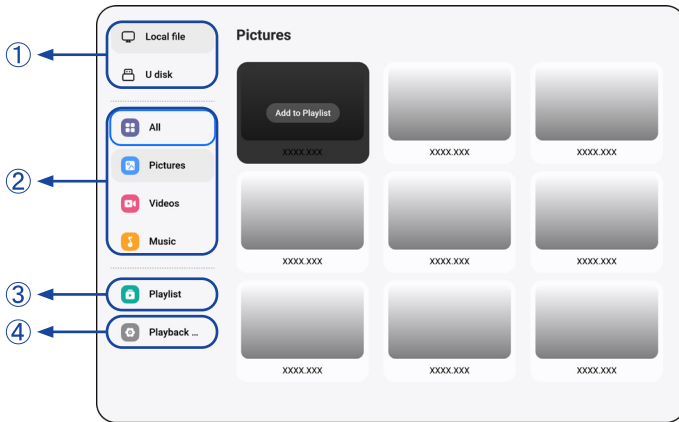

① Browse the files stored in the internal storage device and the USB storage.

② Play file

1. Navigate through different types of media files: All, Pictures, Videos, and Music.
2. Select the file and press OK button to play.

NOTE

■ Supported file system:
FAT32

■ Supported file format:

- **Picture:** JPG, JPEG, BMP, PNG, GIF
- **Video:** 3G2, 3GP, AVI, F4V, FLV, MP4, M2TS, M2V, M4V, MKV, MOV, MPEG, MTS, OGM, PMP, TP, TS, VOB, WEBM
- **Music:** MP3, M4A, AAC, LPCM

■ Media Hotkey

- ► : To play the media file.
- || : To pause the media file.
- ►| : Play the next file.
- ◀| : Play the previous file.
- ↺ : Repeat Playback.
- ⇄ : Sequential Playback.
- ⇄ : Reverse Playback.
- ✂ : Random Playback.







■ Arrow Hotkey

- ◀ : Previous file
- ▶ : Next file

■ Edit Options

Press "Option" to display the edit options.

- **Add to playlist:** Select the file and add to the list.

- Remote control
-  **Option key:** Display edit options
-  **OK key:** Select / deselect file
-  **Back key:** Return
-  **Play:** To play the media file.
-  **Pause:** To pause the media file.
-  **Fast forward:** To skip forward 10 seconds.
-  **Rewind:** To skip backward 10 seconds.
- ■ **Stop:** To stop the playing file and return to Menu

③ Playlist

Display the current playlist or create new ones.



1. Select "Add" on the page.
2. Enter the name of the playlist.

■ Edit Options

Press "Option" to display the edit options.

- **Play:** Play files from the list.
- **Remove:** Delete the list.
- **Move up:** Move the files to the top of the list.
- **Move down:** Move the files to the bottom of the list.
- **Remove:** Delete files.

■ Remote control

-  **Option key:** Display edit options
-  **OK / ► Play key:** Play files from the list.
-  **Back key:** Return

④ Playback settings

■ Play order

- **Sequences:** Play files in sequences.
- **Reverse:** Play files in reverse.
- **Random:** All files in the list play randomly.
- **Cycle:** All files in the list play repeatedly.

■ Play mode

- **Auto:** Autoplay duration(s) Auto 5s / Auto 15s / Auto 30s / Auto 60s
- **Manual:** Play the file manually.

■ Play style

- **Full:** Enlarge the image to full screen.
- **Scale:** Display the image in its original aspect ratio.

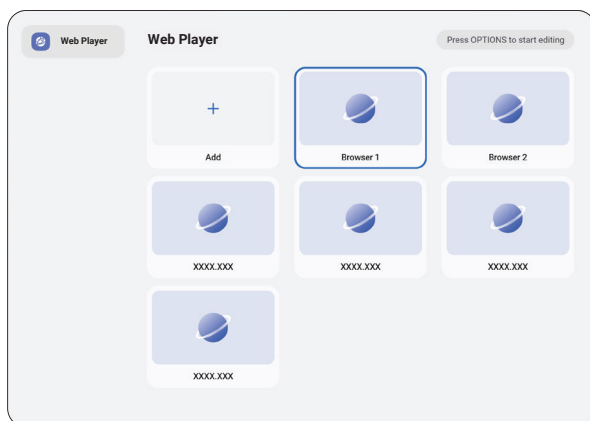

① Playlist



Set frequently used URL.

1. Select "Add" on the page.
2. Enter URL and press Confirm to access.

■ Edit Options

- **Play:** Open the web page
- **Remove:** Delete a URL.

■ Remote control

-  **Option key:** Display edit options
-  **OK / ► Play key:** Open the web page
-  **Back key:** Return

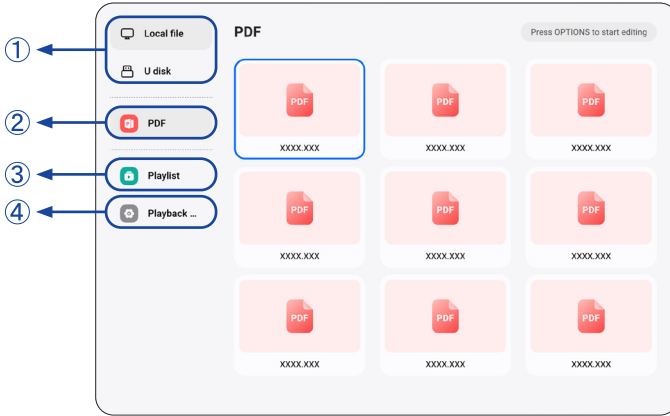

① Browse the files stored in the internal storage device and the USB storage.

② Play file

1. Select the file and press OK button to view it.

■ Arrow Hotkey

- ◀ : Previous page
- ▶ : Next page

■ Edit Options

Press "Option" to display the edit options.

- **Add to playlist:** Select the file and add to the list.

■ Remote control

- **Option key:** Display edit options
- **OK key:** Select / deselect file
- **Back key:** Return
- **Play:** To play the media file.
- **Pause:** To pause the media file.
- **Stop:** To stop the playing file and return to Menu

③ Playlist



Display the current playlist or create new ones.

1. Select "Add" on the page.
2. Enter the name of the playlist.

■ Edit Options

Press "Option" to display the edit options.

- **Play:** Open the PDF file from the list.
- **Remove:** Delete the list.
- **Move up:** Move the files to the top of the list.
- **Move down:** Move the files to the bottom of the list.
- **Remove:** Delete files.

- Remote control
-  **Option key:** Display edit options
-  **OK / ► Play key:** Open the PDF file from the list.
-  **Back key:** Return

④ Playback settings

- Play order
 - **Sequences:** Play files in sequences.
 - **Reverse:** Play files in reverse.
 - **Random:** All files in the list play randomly.
 - **Cycle:** All files in the list play repeatedly.
- Play mode
 - **Auto:** Autoplay duration(s) Auto 5s / Auto 15s / Auto 30s / Auto 60s
 - **Manual:** Play the file manually.

[File Manager]

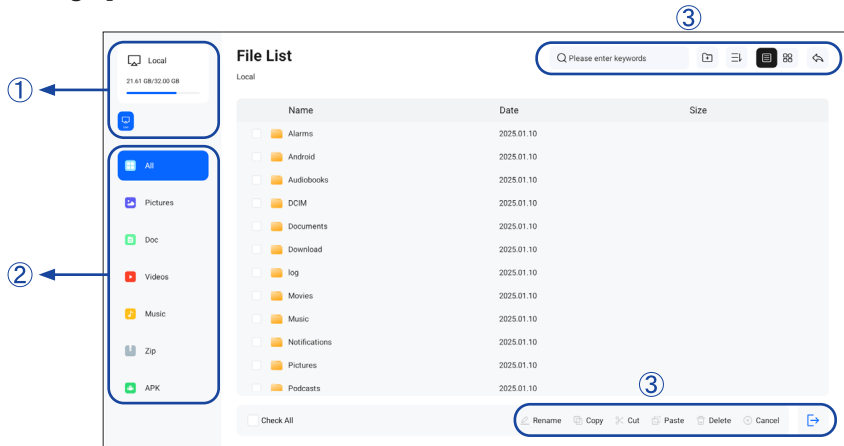

① Browse the files stored in the internal storage device and the USB storage.

② Manage file

1. Navigate through different types of files: All, Pictures, Doc, Videos, Music, Zip and APK.
2. Select the file to organize and view.

NOTE

■ Supported format:

- **Picture:** JPG, JPEG, BMP, PNG, GIF
- **Doc:** PPT, Word, Excel, PDF (Open the file by using the WPS Office)
- **Videos:** 3G2, 3GP, AVI, F4V, FLV, MP4, M2TS, M2V, M4V, MKV, MOV, MPEG, MTS, OGM, PMP, TP, TS, VOB, WEBM
- **Music:** MP3, M4A, AAC, LPCM
- **Zip**
- **Apk**

③ Tools

: Rename

: Copy

: Cut

: Paste

: Delete

: Cancel

: Exit

: Search

: Create

: Sort (Date, Size, Name)

: List

: Grid

: Return

[CMS]

Manage the digital signage content.

To be able to use functionality, please download the CMS Software and User Manual from our Website <https://iiyama.com/iisignage>

CMS software is using the network Port: 9989, future information are available in the iiSignage User Manual.

[iiControl]

This software provides organizations with a convenient and fast unified management solution for terminal equipment, builds an efficient and real-time equipment management system, helps digitize the campus environment and makes campus management more convenient.

[iiBrowser]

Connect to the network and browse the web.

[QuickSupport]

TeamViewer QuickSupport mobile app allows you to quick receive remote support on your smartphone or tablet.

[Chromium]

Connect to the network and browse the web.

[iiShare]

This is the software that can wirelessly share the screen with other notebook etc..

[Host]

The TeamViewer Host app for Android allows for remote control of unattended Android devices. A connection is possible even when the device is not being actively used.

STANDBY FEATURE

This product features the standby function. When activated, it automatically reduces unnecessary power consumption of the monitor when your computer is not in use.

There is a standby step the monitor takes as described below. The standby function, including any timer settings is configured by the operating system. Check your operating system manual for information on how this can be configured.

■ Standby Mode

When the video signal from the computer is off, the monitor enters into Standby Mode which reduces the power consumption to less than 0.5W*. The screen becomes dark, and the power indicator turns to red. From Standby Mode, the image reappears in several seconds when either the keyboard or the mouse are touched again.

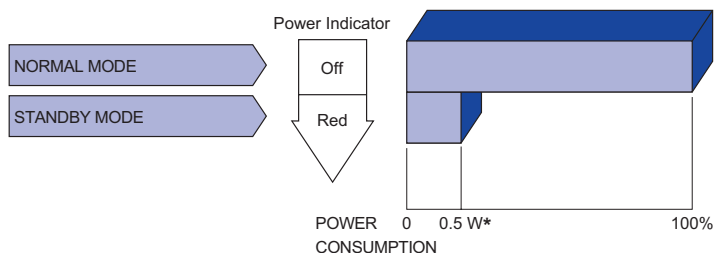

* When the USB devices are not connected.

TROUBLE SHOOTING

If the monitor fails to operate correctly, please follow the steps below for a possible solution.

1. Perform the adjustments described in OPERATING THE MONITOR, depending on the problem you have. If the monitor does not get a picture, skip to 2.
2. Consult the following items if you cannot find an appropriate adjustment item in OPERATING THE MONITOR or if the problem persists.
3. If you are experiencing a problem which is not described below or you cannot correct the problem, discontinue using the monitor and contact your dealer or iiyama service center for further assistance.

Problem	Check
① The picture does not appear. (Power indicator does not light up.)	<input type="checkbox"/> The Power Cable is firmly seated in the socket. <input type="checkbox"/> The Power Switch is turned ON. <input type="checkbox"/> The AC socket is live. Please check with another piece of equipment.
(Power indicator is green.)	<input type="checkbox"/> Increase the Contrast and/or Brightness. <input type="checkbox"/> The computer is ON. <input type="checkbox"/> The Signal Cable is properly connected. <input type="checkbox"/> The signal timing of the computer is within the specification of the monitor.
(Power indicator is red.)	<input type="checkbox"/> If the monitor is in standby mode, press the POWER button on the remote control. <input type="checkbox"/> The computer is ON. <input type="checkbox"/> The Signal Cable is properly connected. <input type="checkbox"/> The signal timing of the computer is within the specification of the monitor.
② The screen is not synchronized.	<input type="checkbox"/> The Signal Cable is properly connected. <input type="checkbox"/> The signal timing of the computer is within the specification of the monitor.
③ The screen position is not in the center.	<input type="checkbox"/> The signal timing of the computer is within the specification of the monitor.
④ The screen is too bright or too dark.	<input type="checkbox"/> The video output level of the computer is within the specification of the monitor.
⑤ The screen is shaking.	<input type="checkbox"/> The power voltage is within the specification of the monitor. <input type="checkbox"/> The signal timing of the computer is within the specification of the monitor.
⑥ No sound.	<input type="checkbox"/> The audio equipment (computer etc.) is ON. <input type="checkbox"/> The Audio Cable is properly connected. <input type="checkbox"/> The Volume is turned up. <input type="checkbox"/> The Mute is OFF. <input type="checkbox"/> The audio output level of the audio equipment is within the specification of the monitor.
⑦ The sound is too loud or too quiet.	<input type="checkbox"/> The audio output level of the audio equipment is within the specification of the monitor.
⑧ A strange noise is heard.	<input type="checkbox"/> The Audio Cable is properly connected.

RECYCLING INFORMATION

For better environment protection please don't dispose your monitor.
Please visit our web site: <https://iiyama.com> for monitor recycling.

APPENDIX

Design and specifications are subject to change without prior notice.

SPECIFICATIONS : ProLite LH4364UHS-B1AG / B1AG A

Size Category		43"
LCD Panel	Panel technology	VA
	Size	Diagonal: 42.5" (108cm)
	Pixel pitch	0.0817mm H × 0.2451mm V
	Brightness	500cd/m ² (Typical), 330cd/m ² (Default / Energy Saving)
	Contrast ratio	4000 : 1 (Typical)
	Viewable angle	Horizontal : 89 degrees, Vertical: 89 degrees (Typical)
	Response time	6.5ms (Typical, Gray to Gray)
Display Colors		Approx.1.07G
Sync Frequency		Horizontal: 28.0-160.0kHz, Vertical: 57-62Hz
Native Resolution		3840 × 2160, 8.3 MegaPixels
Support Max. Resolution		HDMI: 3840 × 2160 60Hz
Input Video Signal		HDMI, USB-C 2.0 (DisplayPort 1.2)
LAN		RJ45
Serial Port		RS-232C In/Out ø 2.5mm sub-mini jack
IR Extender Connector		IR In/Out
USB Connector		USB2.0(DC5V, 500mA) (USB Media Player) × 2 USB-C 2.0(5V, 3A) (DisplayPort 1.2 ALT mode) × 1
Number of USB Ports		1 Upstream : Type C × 1, Type B × 1
Connector shape		2 Downstream : Type A
Headphone Connector* ¹		ø 3.5mm mini jack (Stereo)
Speakers		Internal: 10W×2 (Stereo speakers)
RAM		4GB DDR4
ROM		32GB eMMC
WIFI		2.4-2.5 GHz / 5.15-5.825 GHz / 802.11a/b/g/n/ac
Maximum Screen Size		941.18mm W × 529.42mm H / 37.1" W × 20.8" H
Power Source		100-240VAC, 50/60Hz, 2.1A
Power Consumption* ²		98W typical, Standby mode: 0.5W maximum, Off mode: 0.3W maximum
Dimensions / Net Weight		973.0 × 560.5 × 70.0mm / 38.3 × 22.1 × 2.8" (W×H×D) 8.0kg / 17.6lbs
Environmental Considerations	Operating: Temperature	0 to 40°C / 32 to 104°F
	Humidity	20 to 80% (No condensation)
	Storage: Temperature	-20 to 60°C / 4 to 140°F
	Humidity	10 to 90% (No condensation)
Approvals		CE, UKCA, EAC, TÜV-Bauart

NOTE

*¹ Proper operation of connected external devices other than headphones is not guaranteed.

*² When the USB devices are not connected.

SPECIFICATIONS : ProLite LH5064UHS-B1AG / B1AG A

Size Category		50"
LCD Panel	Panel technology	IPS (In-Plane-Switching)
	Size	Diagonal: 49.5" (125.7cm)
	Pixel pitch	0.09513mm H × 0.28539mm V
	Brightness	500cd/m ² (Typical), 315cd/m ² (Default / Energy Saving)
	Contrast ratio	1200 : 1 (Typical)
	Viewable angle	Horizontal : 89 degrees, Vertical: 89 degrees (Typical)
	Response time	6.5ms (Typical, Gray to Gray)
Display Colors		Approx.1.07G
Sync Frequency		Horizontal: 28.0-160.0kHz, Vertical: 57-62Hz
Native Resolution		3840 × 2160, 8.3 MegaPixels
Support Max. Resolution		HDMI: 3840 × 2160 60Hz
Input Video Signal		HDMI, USB-C 2.0 (DisplayPort 1.2)
LAN		RJ45
Serial Port		RS-232C In/Out ø 2.5mm sub-mini jack
IR Extender Connector		IR In/Out
USB Connector		USB2.0(DC5V, 500mA) (USB Media Player) × 2 USB-C 2.0(5V, 3A) (DisplayPort 1.2 ALT mode) × 1
Number of USB Ports Connector shape		1 Upstream : Type C × 1, Type B × 1 2 Downstream : Type A
Headphone Connector*1		ø 3.5mm mini jack (Stereo)
Speakers		Internal: 10W×2 (Stereo speakers)
RAM		4GB DDR4
ROM		32GB eMMC
WIFI		2.4-2.5 GHz / 5.15-5.825 GHz / 802.11a/b/g/n/ac
Maximum Screen Size		1095.94mm W × 616.41mm H / 43.2" W × 24.3" H
Power Source		100-240VAC, 50/60Hz, 2.4A
Power Consumption*2		123W typical, Standby mode: 0.5W maximum, Off mode: 0.3W maximum
Dimensions / Net Weight		1123.5 × 644.0 × 68.5mm / 44.2 × 25.3 × 2.7" (W×H×D) 10.4kg / 22.9lbs
Environmental Considerations		Operating: Temperature 0 to 40°C / 32 to 104°F Humidity 20 to 80% (No condensation) Storage: Temperature -20 to 60°C / 4 to 140°F Humidity 10 to 90% (No condensation)
Approvals		CE, UKCA, EAC, TÜV-Bauart

NOTE *1 Proper operation of connected external devices other than headphones is not guaranteed.

*2 When the USB devices are not connected.

SPECIFICATIONS : ProLite LH5564UHS-B1AG / B1AG A

Size Category		55"
LCD Panel	Panel technology	VA
	Size	Diagonal: 54.6" (139cm)
	Pixel pitch	0.105mm H × 0.315mm V
	Brightness	500cd/m ² (Typical), 335cd/m ² (Default / Energy Saving)
	Contrast ratio	5000 : 1 (Typical)
	Viewable angle	Horizontal : 89 degrees, Vertical: 89 degrees (Typical)
	Response time	6.5ms (Typical, Gray to Gray)
Display Colors		Approx.1.07G
Sync Frequency		Horizontal: 28.0-160.0kHz, Vertical: 57-62Hz
Native Resolution		3840 × 2160, 8.3 MegaPixels
Support Max. Resolution		HDMI: 3840 × 2160 60Hz
Input Video Signal		HDMI, USB-C 2.0 (DisplayPort 1.2)
LAN		RJ45
Serial Port		RS-232C In/Out ø 2.5mm sub-mini jack
IR Extender Connector		IR In/Out
USB Connector		USB2.0(DC5V, 500mA) (USB Media Player) × 2 USB-C 2.0(5V, 3A) (DisplayPort 1.2 ALT mode) × 1
Number of USB Ports		1 Upstream : Type C × 1, Type B × 1
Connector shape		2 Downstream : Type A
Headphone Connector ^{*1}		ø 3.5mm mini jack (Stereo)
Speakers		Internal: 10W×2 (Stereo speakers)
RAM		4GB DDR4
ROM		32GB eMMC
WIFI		2.4-2.5 GHz / 5.15-5.825 GHz / 802.11a/b/g/n/ac
Maximum Screen Size		1209.6mm W × 680.4mm H / 47.6" W × 26.8" H
Power Source		100-240VAC, 50/60Hz, 2.7A
Power Consumption ^{*2}		135W typical, Standby mode: 0.5W maximum, Off mode: 0.3W maximum
Dimensions / Net Weight		1238.5 × 709.0 × 70.0mm / 48.8 × 27.9 × 2.7" (W×H×D) 13.0kg / 28.7lbs
Environmental Considerations		Operating: Temperature 0 to 40°C / 32 to 104°F Humidity 20 to 80% (No condensation) Storage: Temperature -20 to 60°C / 4 to 140°F Humidity 10 to 90% (No condensation)
Approvals		CE, UKCA, EAC, TÜV-Bauart

NOTE

^{*1} Proper operation of connected external devices other than headphones is not guaranteed.

^{*2} When the USB devices are not connected.

SPECIFICATIONS : ProLite LH6564UHS-B1AG / B1AG A

Size Category		65"
LCD Panel	Panel technology	VA
	Size	Diagonal: 64.5" (164cm)
	Pixel pitch	0.124mm H × 0.372mm V
	Brightness	500cd/m ² (Typical), 335cd/m ² (Default / Energy Saving)
	Contrast ratio	5000 : 1 (Typical)
	Viewable angle	Horizontal : 89 degrees, Vertical: 89 degrees (Typical)
	Response time	6.5ms (Typical, Gray to Gray)
Display Colors		Approx.1.07G
Sync Frequency		Horizontal: 28.0-160.0kHz, Vertical: 57-62Hz
Native Resolution		3840 × 2160, 8.3 MegaPixels
Support Max. Resolution		HDMI: 3840 × 2160 60Hz
Input Video Signal		HDMI, USB-C 2.0 (DisplayPort 1.2)
LAN		RJ45
Serial Port		RS-232C In/Out ø 2.5mm sub-mini jack
IR Extender Connector		IR In/Out
USB Connector		USB2.0(DC5V, 500mA) (USB Media Player) × 2 USB-C 2.0(5V, 3A) (DisplayPort 1.2 ALT mode) × 1
Number of USB Ports Connector shape		1 Upstream : Type C × 1, Type B × 1 2 Downstream : Type A
Headphone Connector* ¹		ø 3.5mm mini jack (Stereo)
Speakers		Internal: 10W×2 (Stereo speakers)
RAM		4GB DDR4
ROM		32GB eMMC
WIFI		2.4-2.5 GHz / 5.15-5.825 GHz / 802.11a/b/g/n/ac
Maximum Screen Size		1428.48mm W × 803.52mm H / 56.2" W × 31.6" H
Power Source		100-240VAC, 50/60Hz, 3.2A
Power Consumption* ²		184W typical, Standby mode: 0.5W maximum, Off mode: 0.3W maximum
Dimensions / Net Weight		1456.5 × 831.5 × 69.0mm / 57.3 × 32.7 × 2.7" (W×H×D) 17.7kg / 39.0lbs
Environmental Considerations		Operating: Temperature 0 to 40°C / 32 to 104°F Humidity 20 to 80% (No condensation) Storage: Temperature -20 to 60°C / 4 to 140°F Humidity 10 to 90% (No condensation)
Approvals		CE, UKCA, EAC, TÜV-Bauart

NOTE *¹ Proper operation of connected external devices other than headphones is not guaranteed.

*² When the USB devices are not connected.

SPECIFICATIONS : ProLite LH7564UHS-B1AG / B1AG A

Size Category		75"
LCD Panel	Panel technology	VA
	Size	Diagonal: 74.5" (189.5cm)
	Pixel pitch	0.42975mm H × 0.42975mm V
	Brightness	500cd/m ² (Typical), 330cd/m ² (Default / Energy Saving)
	Contrast ratio	5000 : 1 (Typical)
	Viewable angle	Horizontal : 89 degrees, Vertical: 89 degrees (Typical)
	Response time	6.5ms (Typical, Gray to Gray)
Display Colors		Approx.1.07G
Sync Frequency		Horizontal: 28.0-160.0kHz, Vertical: 57-62Hz
Native Resolution		3840 × 2160, 8.3 MegaPixels
Support Max. Resolution		HDMI: 3840 × 2160 60Hz
Input Video Signal		HDMI, USB-C 2.0 (DisplayPort 1.2)
LAN		RJ45
Serial Port		RS-232C In/Out ø 2.5mm sub-mini jack
IR Extender Connector		IR In/Out
USB Connector		USB2.0(DC5V, 500mA) (USB Media Player) × 2 USB-C 2.0(5V, 3A) (DisplayPort 1.2 ALT mode) × 1
Number of USB Ports		1 Upstream : Type C × 1, Type B × 1
Connector shape		2 Downstream : Type A
Headphone Connector ^{*1}		ø 3.5mm mini jack (Stereo)
Speakers		Internal: 10W×2 (Stereo speakers)
RAM		4GB DDR4
ROM		32GB eMMC
WIFI		2.4-2.5 GHz / 5.15-5.825 GHz / 802.11a/b/g/n/ac
Maximum Screen Size		1650.24mm W × 928.26mm H / 65.0" W × 36.6" H
Power Source		100-240VAC, 50/60Hz, 4.3A
Power Consumption ^{*2}		219W typical, Standby mode: 0.5W maximum, Off mode: 0.3W maximum
Dimensions / Net Weight		1679.0 × 957.0 × 69.0mm / 66.1 × 37.7 × 2.7" (W×H×D) 27.7kg / 61.1lbs
Environmental Considerations		Operating: Temperature 0 to 40°C / 32 to 104°F Humidity 20 to 80% (No condensation) Storage: Temperature -20 to 60°C / 4 to 140°F Humidity 10 to 90% (No condensation)
Approvals		CE, UKCA, EAC, TÜV-Bauart

NOTE

^{*1} Proper operation of connected external devices other than headphones is not guaranteed.

^{*2} When the USB devices are not connected.

SPECIFICATIONS : ProLite LE9864UHS-B1AG / B1AG A

Size Category		98"
LCD Panel	Panel technology	VA
	Size	Diagonal: 97.5" (247.7cm)
	Pixel pitch	0.4875mm H × 0.4875mm V
	Brightness	500cd/m ² (Typical), 330cd/m ² (Default / Energy Saving)
	Contrast ratio	5000 : 1 (Typical)
	Viewable angle	Horizontal : 89 degrees, Vertical: 89 degrees (Typical)
	Response time	6.5ms (Typical, Gray to Gray)
Display Colors		Approx.1.07G
Sync Frequency		Horizontal: 28.0-160.0kHz, Vertical: 57-62Hz
Native Resolution		3840 × 2160, 8.3 MegaPixels
Support Max. Resolution		HDMI: 3840 × 2160 60Hz
Input Video Signal		HDMI, USB-C 2.0 (DisplayPort 1.2)
LAN		RJ45
Serial Port		RS-232C In/Out ø 2.5mm sub-mini jack
IR Extender Connector		IR In/Out
USB Connector		USB2.0(DC5V, 500mA) (USB Media Player) × 2 USB-C 2.0(5V, 3A) (DisplayPort 1.2 ALT mode) × 1
Number of USB Ports Connector shape		1 Upstream : Type C × 1, Type B × 1 2 Downstream : Type A
Headphone Connector* ¹		ø 3.5mm mini jack (Stereo)
Speakers		Internal: 10W×2 (Stereo speakers)
RAM		4GB DDR4
ROM		32GB eMMC
WIFI		2.4-2.5 GHz / 5.15-5.825 GHz / 802.11a/b/g/n/ac
Maximum Screen Size		2158.85mm W × 1214.35mm H / 85.0" W × 47.8" H
Power Source		100-240VAC, 50/60Hz, 5.9A
Power Consumption* ²		388W typical, Standby mode: 0.5W maximum, Off mode: 0.3W maximum
Dimensions / Net Weight		2203.0 × 1258.0 × 110.5mm / 84.7 × 49.5 × 4.4" (W×H×D) 61.0kg / 134.5lbs
Environmental Considerations		Operating: Temperature 0 to 40°C / 32 to 104°F Humidity 20 to 80% (No condensation) Storage: Temperature -20 to 60°C / 4 to 140°F Humidity 10 to 90% (No condensation)
Approvals		CE, UKCA, EAC, TÜV-Bauart

NOTE *¹ Proper operation of connected external devices other than headphones is not guaranteed.

*² When the USB devices are not connected.

DIMENSIONS : ProLite LH4364UHS

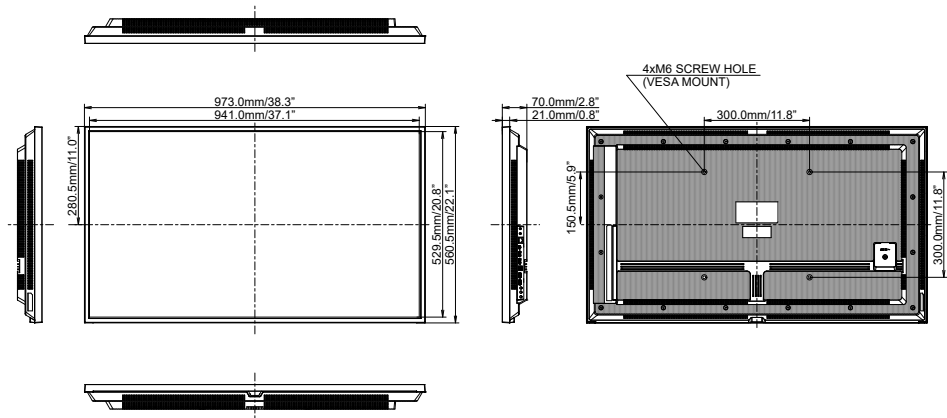

DIMENSIONS : ProLite LH5064UHS

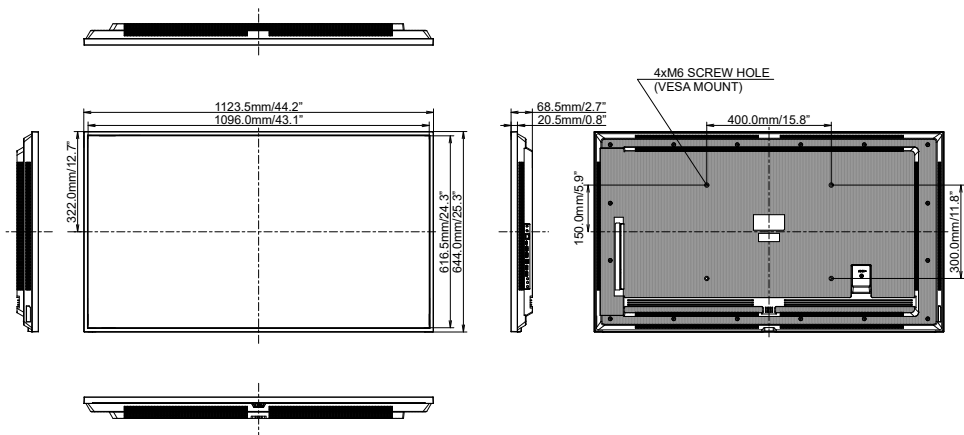

DIMENSIONS : ProLite LH5564UHS

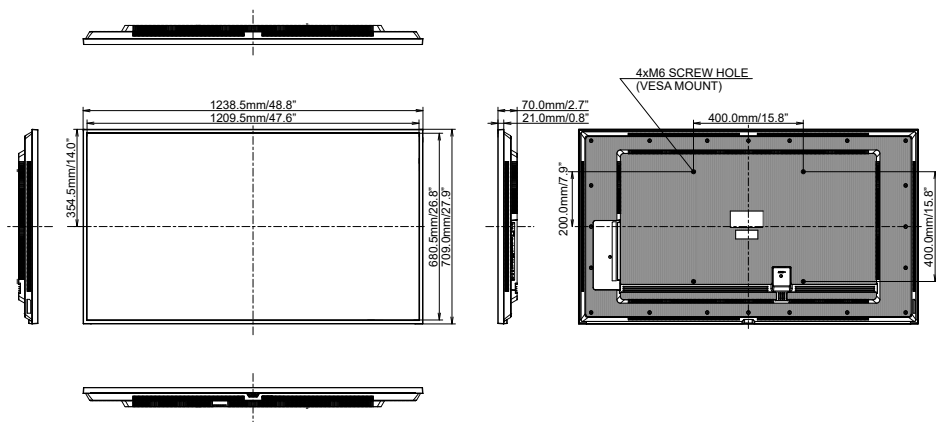

DIMENSIONS : ProLite LH6564UHS

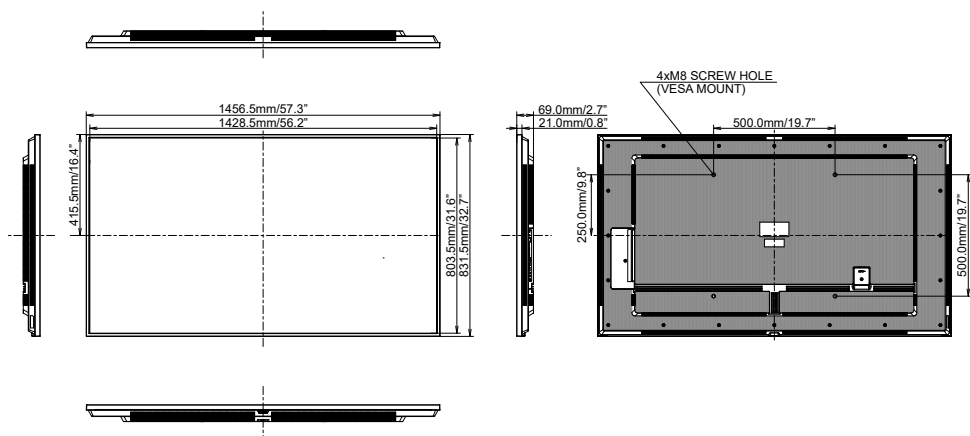

DIMENSIONS : ProLite LH7564UHS

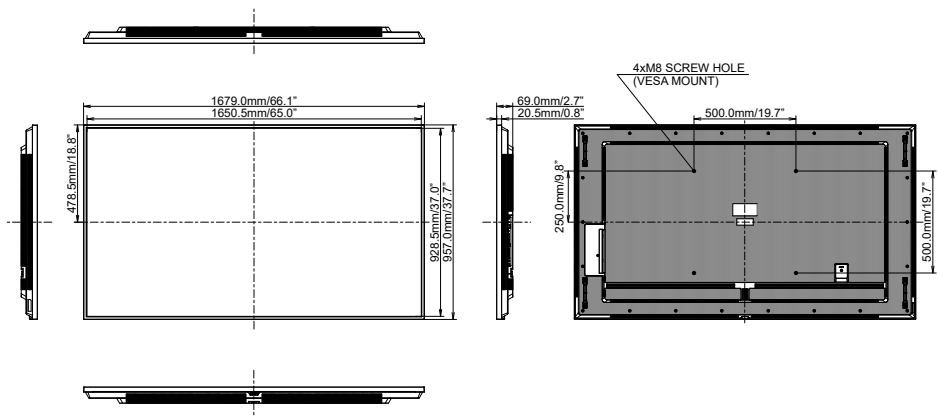

ENGLISH

DIMENSIONS : ProLite LE9864UHS

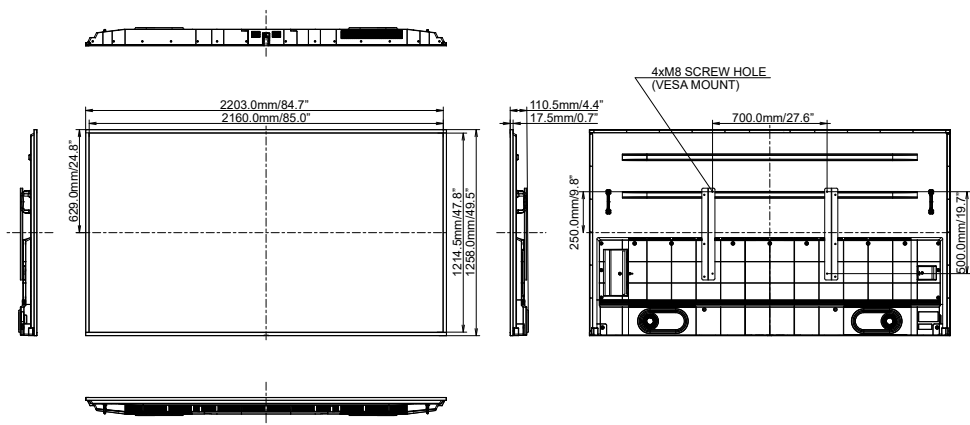

DIMENSIONS : WALL MOUNTING

• ProLite LH4364UHS / ProLite LH5064UHS / ProLite LH5564UHS

ENGLISH

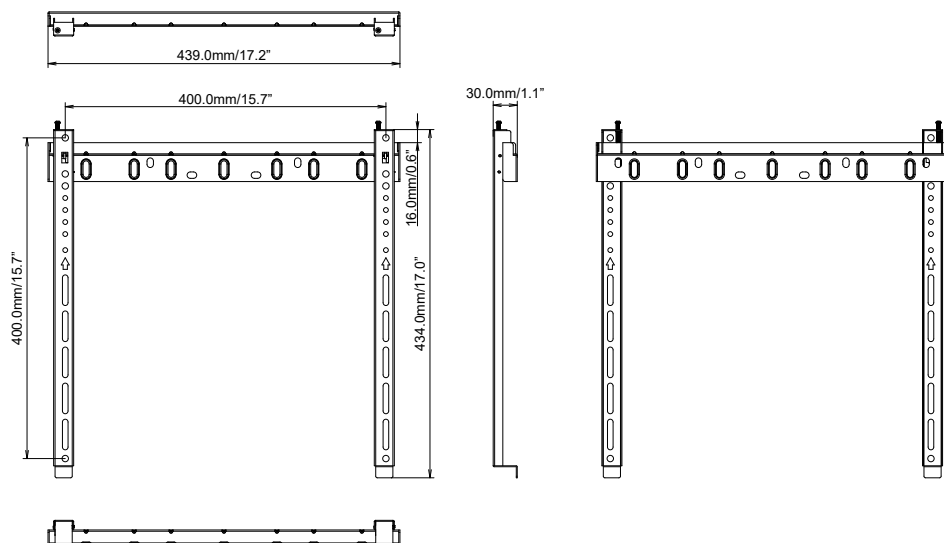

• ProLite LH6564UHS

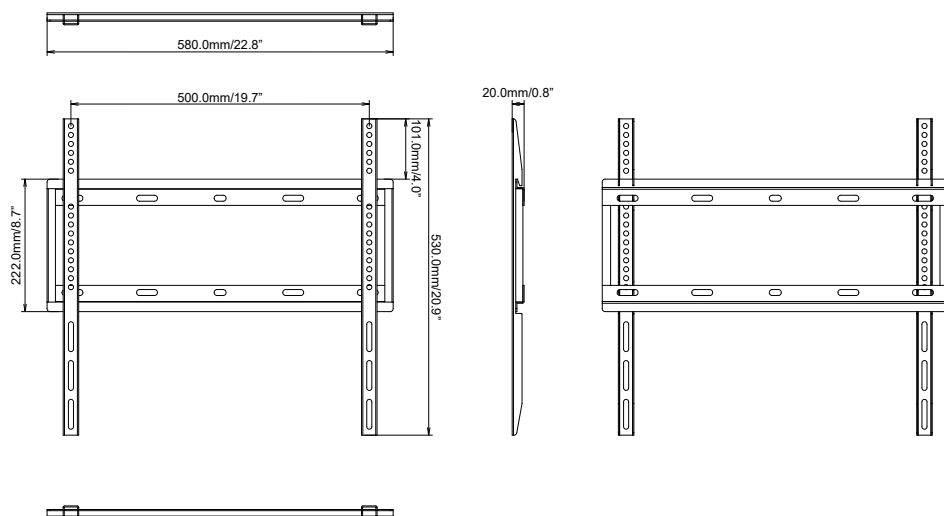

• ProLite LH7564UHS

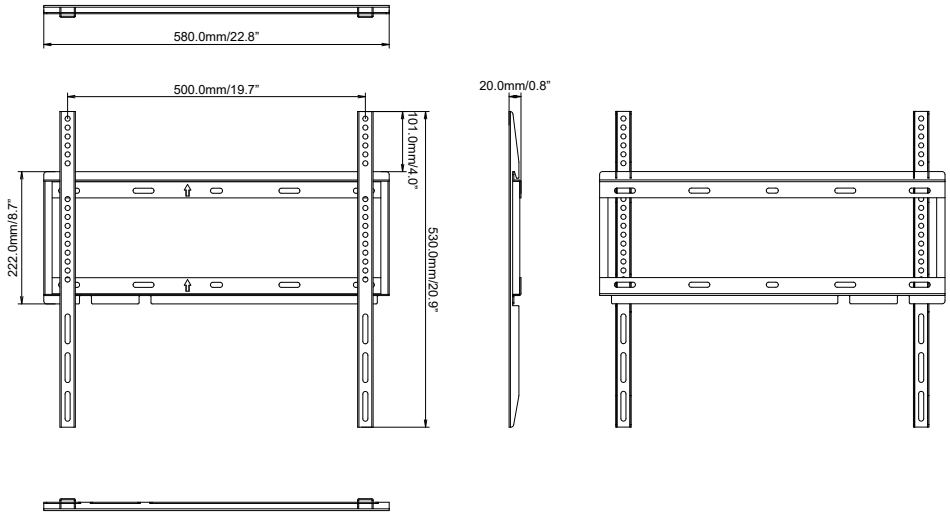

• ProLite LE9864UHS

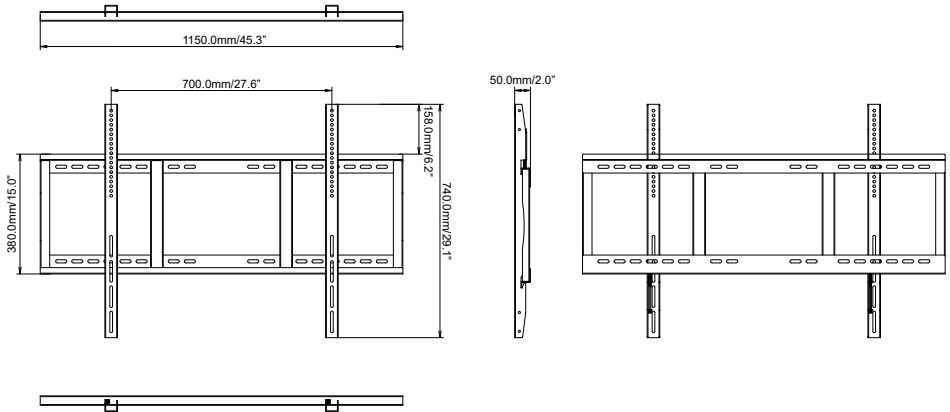

COMPLIANT TIMING

Timing		fH(kHz)	F(Hz)	Dot clock (MHz)	HDMI1	HDMI2	Type-C
VESA	VGA 640x480	31.5	60.0	25.175	○	○	○
	SVGA 800x600	37.9	60.0	40.000	○	○	○
	XGA 1024x768	48.4	60.0	65.000	○	○	○
	QVGA 1280x960	64.0	60.0	108.000	○	○	○
	SXGA 1280x1024	64.0	60.0	108.000	○	○	○
	WXGA 1366x768	47.7	60.0	85.500	○	○	○
	CVT 1440x900	55.9	60.0	106.500	○	○	○
	UXGA 1680x1050	65.3	60.0	146.250	○	○	○
	FHD 1920x1080	67.5	60.0	148.500	○	○	○
	2048x1152	70.9	60.0	156.750	○	○	○
	2560x1080	66.0	60.0	198.000	○	○	○
	2560x1440	88.8	60.0	241.700	○	○	○
	2560x1600	98.7	60.0	268.500	○	○	○
	3200x1800	111.1	60.0	391.140	○	○	○
	4K 3840x2160	67.5	30.0	297.000	○	○	○
		135.0	60.0	594.000	○	○	○
IBM	720x400	31.5	70.0	28.320	○	○	○
SD	480i	15.7	60.0	27.000	○	○	
	576i	15.6	50.0	13.500	○	○	
	480p	31.5	60.0	27.000	○	○	○
	576p	31.3	50.0	27.000	○	○	○
HD	720p	37.5	50.0	27.000	○	○	○
		45.0	60.0	74.250	○	○	○
	1080i	28.1	50.0	74.250	○	○	○
		33.7	60.0	74.250	○	○	○
	1080p	56.3	50.0	148.500	○	○	○
		67.5	60.0	148.500	○	○	○

* ○ means supported the timing.