

VORTEX LUM 240

MANUAL

ACCESSORIES

| | | | |
|------------------------------------|------------------------------------|----------------------------------|------------------------------|
| A Intel Backplate x1 | B Intel Backplate x2 | C AMD Backplate x2 | D Backplate x2 |
| E x4 | F x4 | G x4 | H x8 |
| I x4 | J x8 | K x1 | L x1 |
| M x1 | N x1 | O x4 | P x2 |
| Q x1 | | | |

INTEL PLATFORM INSTALLATION

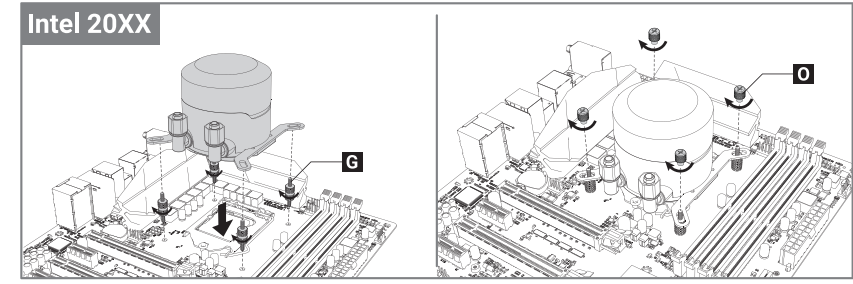
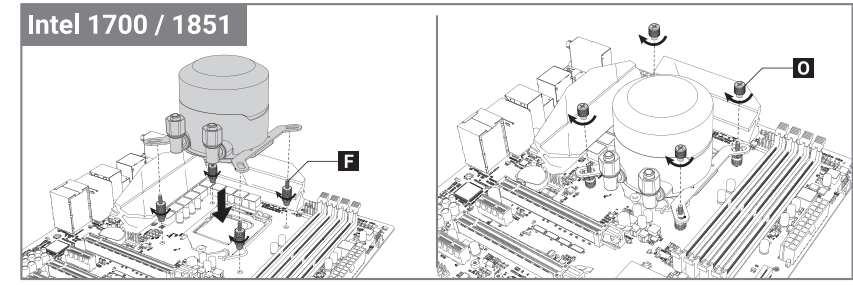
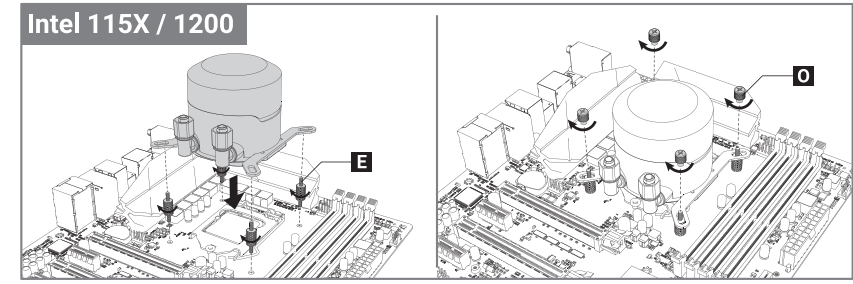
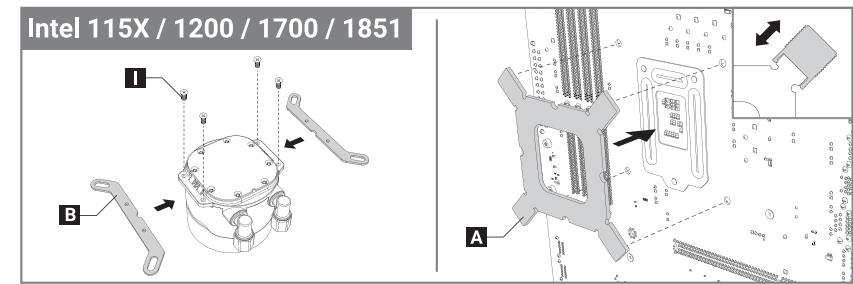

AMD PLATFORM INSTALLATION

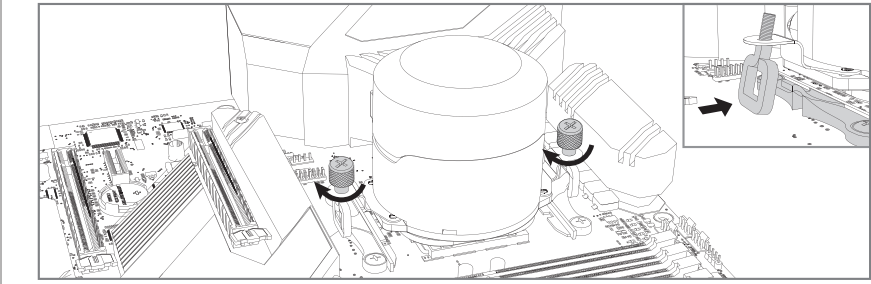
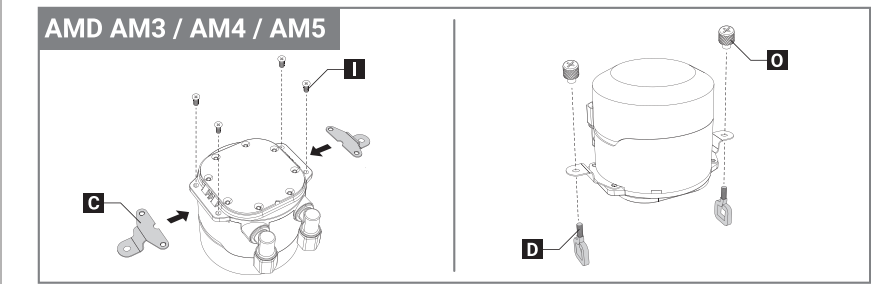

INSTALL THE PUMPHEAD & FAN

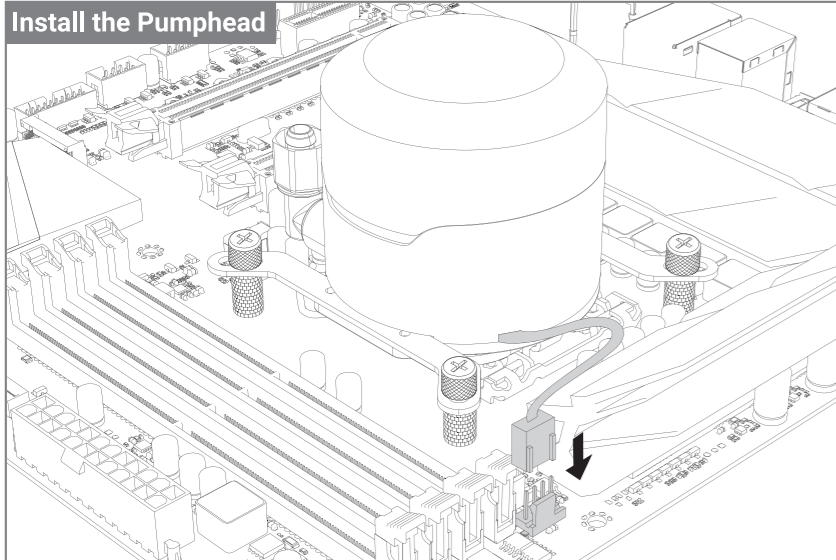

Connect the Fan Controller

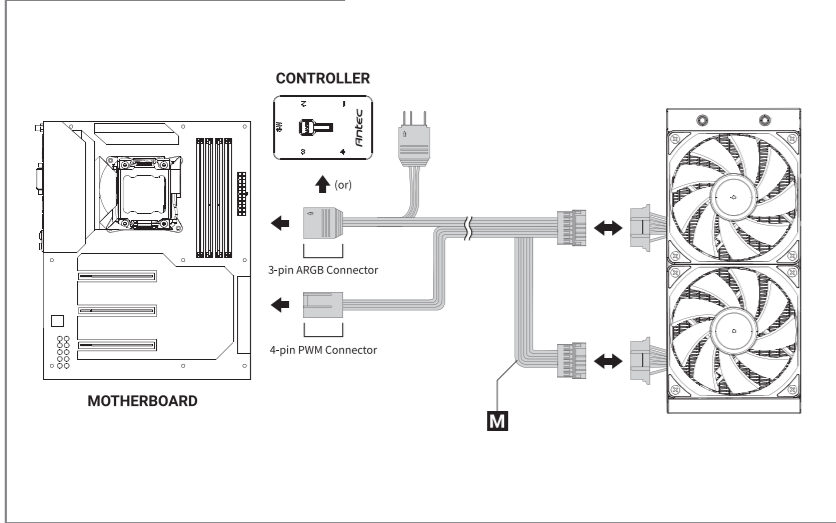

RADIATOR INSTALLATION

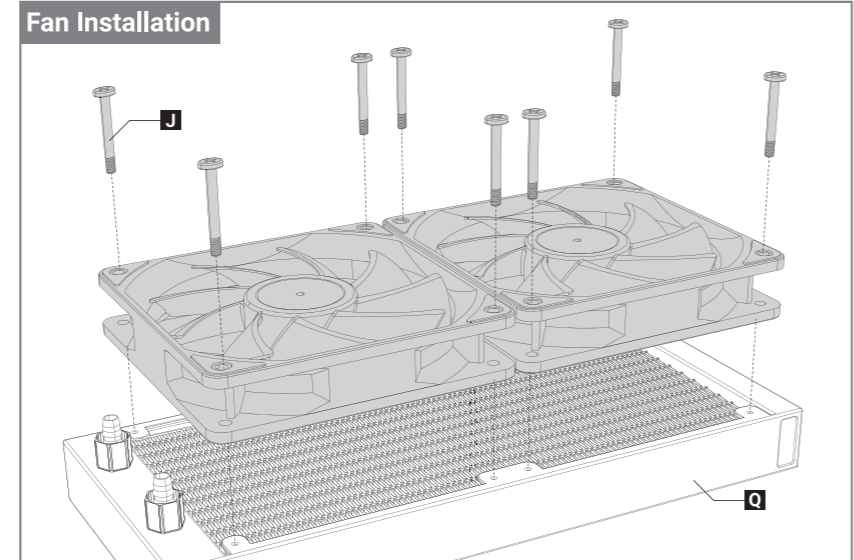

Radiator Installation

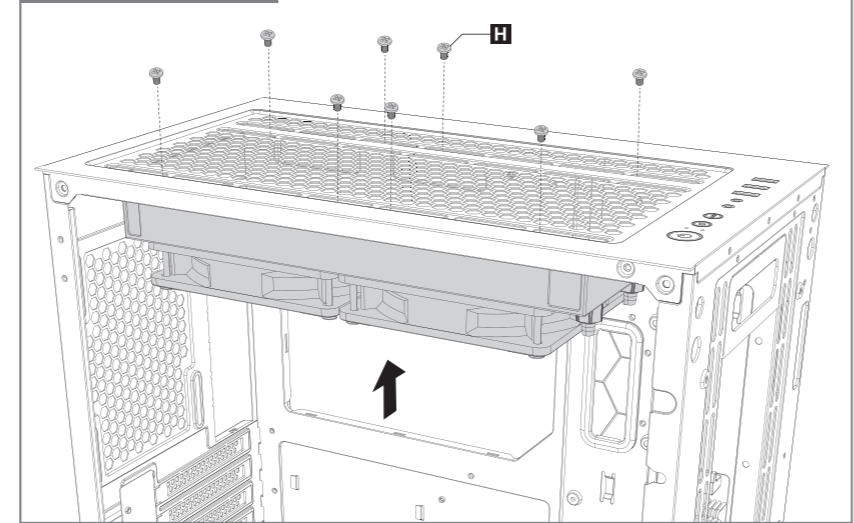

CONTROLLER

Controller Description

1. Each ARGB connector supports up to 48 LEDs. Up to 120 LEDs (12mA) for 4 headers in total.

2. You can combine the extra in series.

*Connect it to the 5V 3-pin ARGB connector on the motherboard. If the controller detects the signal, it will switch to the motherboard control mode.

1. Press it for switching LED modes.

2. When the motherboard is connected, you can press it for three seconds to switch it to motherboard control mode.

3. Long press the button for six seconds to turn it off. Press it can switch back to the controller mode.

1. SATA Power Connector (5V/4.0A)

2. The current of the LED fan cannot surpass 4.0A

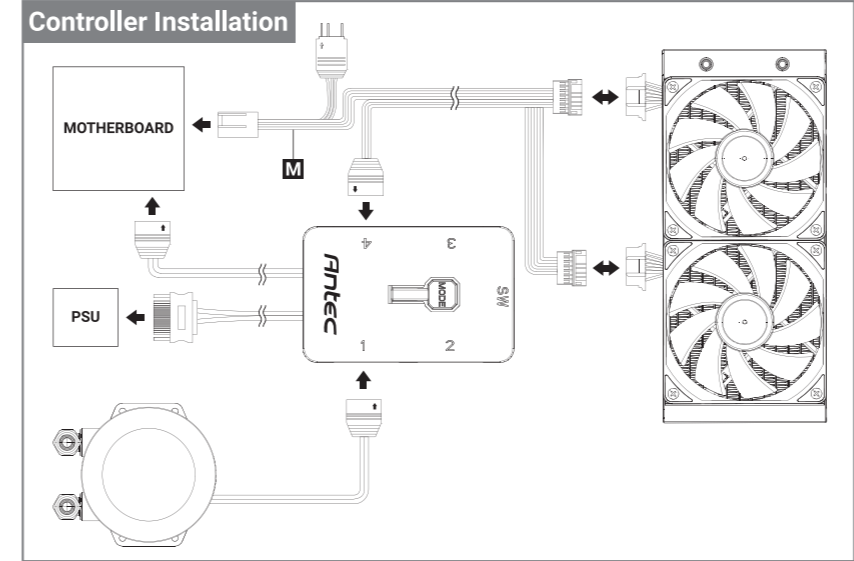

Antec
BELIEVE IT

www.Antec.com

All rights reserved. Specifications are subject to change without prior notice. Actual products and accessories may differ from illustrations. Omissions and printing errors excepted. Content of delivery might differ in different countries or areas. Some trademarks may be claimed as the property of others.

©1986 – 2024 Antec Inc. All rights reserved.