

# Hisense

## 2.1CH Soundbar with Wireless Subwoofer

Model: HS2100



 **Dolby** Audio

 **Bluetooth**®

**HDMI**™  
HIGH-DEFINITION MULTIMEDIA INTERFACE

**dts**®

**Roku TV**  
Ready

## Complete UM on web



Before using the soundbar, please read this manual thoroughly and retain it for future reference.

# Contents

<b>1. Important Safety Instructions</b> .....	<b>3</b>
1.1 Safety.....	3
1.2 Warning.....	4
<b>2. What's in the Box</b> .....	<b>5</b>
<b>3. Product Diagram</b> .....	<b>6</b>
3.1 Main Unit .....	6
3.2 Wireless Subwoofer.....	6
3.3 Remote Control .....	7
<b>4. Preparations</b> .....	<b>7</b>
4.1 Prepare the Remote Control.....	7
4.2 Replace the Remote Control Battery .....	7
4.3 Placement and Mounting .....	8
4.4 Wall Mounting (if using option-B).....	8
<b>5. Connections</b> .....	<b>9</b>
5.1 Use the HDMI ARC Socket.....	9
5.2 Use the OPTICAL Socket.....	9
5.3 Use the AUX Socket.....	9
5.4 Connect Power .....	10
<b>6. Pair up with the Subwoofer</b> .....	<b>10</b>
6.1 Automatic pairing.....	10
6.2 Manual pairing.....	10
6.3 Use the Hisense EzPlay Function.....	10
<b>7. Basic Operation</b> .....	<b>11</b>
7.1 Standby/ON .....	11
7.2 Auto-Standby / Auto-Wake .....	11
7.3 Select Modes .....	11
7.4 Adjust the Volume .....	11
7.5 Turn the Surround Sound ON/OFF.....	12
7.6 Select Equalizer (EQ) Effect.....	12
7.7 Adjust the Bass/Treble .....	12
7.8 Adjust the Brightness.....	12
7.9 Factory reset .....	12
<b>8. AUX/ OPTICAL/HDMI ARC Operation</b> .....	<b>12</b>
<b>9. USB Operation</b> .....	<b>12</b>
<b>10. Bluetooth Operation</b> .....	<b>13</b>
<b>11. Troubleshooting</b> .....	<b>14</b>
<b>12. Specifications</b> .....	<b>15</b>

# 1. Important Safety Instructions



The lightning flash with arrowhead symbol, within an equilateral triangle, is intended to alert the user to the presence of uninsulated “dangerous voltage” within the product’s enclosure that may be of sufficient magnitude as to constitute a risk of electric shock to persons.



The exclamation point within an equilateral triangle is intended to alert the user to the presence of important operating and maintenance (servicing) instructions in the literature accompanying the appliance.

## 1.1 Safety

- 1 **Read these instructions** – All the safety and operating instructions should be read before this product is operated.
- 2 **Keep these instructions** – The safety and operating instructions should be retained for future reference.
- 3 **Heed all warnings** – All warnings on the appliance and in the operating instructions should be adhered to.
- 4 **Follow all instructions** – All operating and usage instructions should be followed.
- 5 **Do not use this apparatus near water** – The appliance should not be used near water or moisture – for example, in a wet basement or near a swimming pool and the like.
- 6 **Clean only with a dry cloth.**
- 7 **Do not block any ventilation openings.** Install in accordance with the manufacturer’s instructions.
- 8 Do not install near any heat sources such as radiators, heaters, stoves, or other apparatus (including amplifiers) that produce heat.
- 9 Do not defeat the safety purpose of the polarized or grounding plug. A polarized plug has two blades with one wider than the other. A grounding plug has two blades and a third grounding prong. The wide blade or the third prong is provided for your safety.

If the provided plug does not fit into your outlet, consult an electrician for replacement of the obsolete outlet.

- 10 Protect the power cord from being walked on or pinched particularly at plugs, convenience receptacles, and the point where they exit from the apparatus.
- 11 Only use attachments/accessories specified by the manufacturer.
- 12  Use only with the cart, stand, tripod, bracket or table specified by the manufacturer, or sold with the apparatus. When a cart or rack is used, use caution when moving the cart/apparatus combination to avoid injury from tip-over.
- 13 Unplug the apparatus during lightning storms or when unused for long periods of time.
- 14 Refer all servicing to qualified personnel. Servicing is required when the apparatus has been damaged in any way, such as power supply cord or plug is damaged, liquid has been spilled or objects have fallen into the apparatus, the unit has been exposed to rain or moisture, does not operate normally, or has been dropped.
- 15  This equipment is a Class II or double insulated electrical appliance. It has been designed in such a way that it does not require a safety connection to electrical earth.
- 16 The apparatus shall not be exposed to dripping or splashing. No objects filled with liquids, such as vases, shall be placed on the apparatus.
- 17 Minimum distance around the apparatus for sufficient ventilation is 5cm.
- 18 The ventilation should not be impeded by covering the ventilation openings with items, such as newspapers, table-cloths, curtains, etc.
- 19 No naked flame sources, such as lighted candles, should be placed on the apparatus.
- 20 Batteries should be recycled or disposed of as per state and local guidelines.
- 21 The use of apparatus in moderate or tropical climates.

### Caution:

- Use of controls or adjustments or performance of procedures other than those described herein, may result in hazardous radiation exposure or other unsafe operation.
- To reduce the risk of fire or electric shock, do not expose this apparatus to rain or moisture. The apparatus must not be exposed to dripping or splashing and objects filled with liquids, such as vases, must not be placed on apparatus.
- The mains plug/appliance coupler is used as the disconnect device, the disconnect device must remain readily operable.
- Danger of explosion if battery is incorrectly replaced. Replace only with the same or equivalent type.

## 1.2 Warning

- The battery (batteries or battery pack) shall not be exposed to excessive heat such as sunshine, fire or the like.
- Before operating this system, check the voltage of this system to see if it is identical to the voltage of your local power supply.
- Do not place this unit close to strong magnetic fields.
- Do not place this unit on the amplifier or receiver.
- If any solid object or liquid falls into the system, unplug the system and have it checked by qualified personnel before operating it any further.
- Do not attempt to clean the unit with chemical solvents as this may damage the finish. Use a clean, dry or slightly damp cloth.
- When removing the power plug from the wall outlet, always pull directly on the plug, never yank on the cord.
- Changes or modifications to this unit not expressly approved by the party responsible for compliance will void the user's authority to operate the equipment.
- The rating label is pasted on the bottom or back of the equipment.

### **Battery usage CAUTION**

To prevent battery leakage which may result in bodily injury, property damage, or damage to the apparatus:

- Install all batteries correctly, + and - as marked on the apparatus.
- Do not mix old and new batteries.
- Do not mix alkaline, standard (Carbon-Zinc) or rechargeable (Ni-Cd, Ni-MH, etc.) batteries.
- Remove batteries when the unit is not used for a long time.



Correct Disposal of this product. This marking indicates that this product should not be disposed with other household wastes throughout the EU.

To prevent possible harm to the environment or human health from uncontrolled waste disposal, recycle it responsibly to promote the sustainable reuse of material resources. To return your used device, please use the return and collection systems or contact the retailer where the product was purchased. They can take this product for environmental safe recycling.

Hereby, XinYang (Hong Kong) Co., Ltd. Declares that the radio equipment type is in compliance with Directive 2014/53/EU and Radio Equipment Regulations 2017 of UK. Please enter the model name at the following internet address to read the full text of the declaration of conformity: <https://global.hisense.com/support/certificate-download/>.



Authorized EU Representative:

Name: Gorenje gospodinjiski aparati, d.o.o.

Address: Partizanska cesta 12, 3320Velenje, Slovenija

Email: [info@gorenje.com](mailto:info@gorenje.com)

Please refer to the rating label for Soundbar or Party Speakers model name and find Bluetooth remote control model name on the remote control label or inside the remote control cover.

## 2. What's in the Box



Main unit

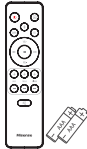

Remote control  
AAA batteries x 2 \*



Wireless subwoofer

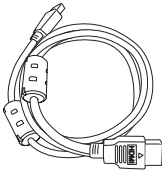

HDMI cable

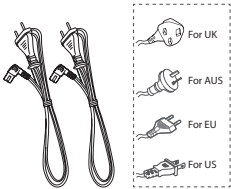

AC Power cord \*

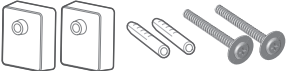

Wall mount kit

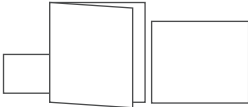

Warranty card/Quick start manual /  
Wall mount guide

- \* Power cord quantity and plug type vary by regions.
- \* AAA Batteries are not available in some locations. Batteries are not included in Colombia and need to be purchased.
- Images, illustrations and drawings shown on this User Manual are for reference only, actual product may vary in appearance.

### 3. Product Diagram

#### 3.1 Main Unit

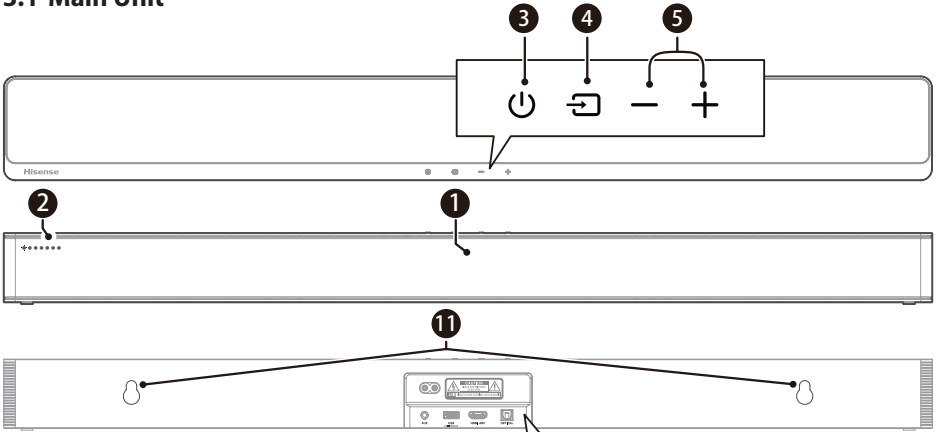

- ① **Remote Control Sensor**  
Receive signal from the remote control.

② **LED Indicators**

Lamp	Mode
● Red	Standby
● Green	AUX
● Blue	BT (Bluetooth)
● Orange	OPTICAL
● White	HDMI ARC
● Yellow	USB

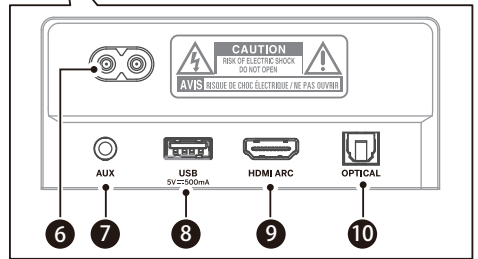

- ③ **⏻ (ON/OFF) Button**  
Switch the soundbar between ON and Standby mode.
- ④ **⏮ (SOURCE) Button**  
Select the play function.
- ⑤ **+ / - (Volume) Buttons**  
Increase/decrease the volume level.
- ⑥ **AC~ Socket**  
Connect to the power supply.
- ⑦ **AUX Socket**  
Connect to an external audio device.
- ⑧ **USB Socket**  
Insert the USB device to play music.
- ⑨ **HDMI ARC Socket**  
Connect to a TV via HDMI cable.
- ⑩ **OPTICAL Socket**  
Connect to an optical audio output on the TV.
- ⑪ **Wall hanging points**

#### 3.2 Wireless Subwoofer

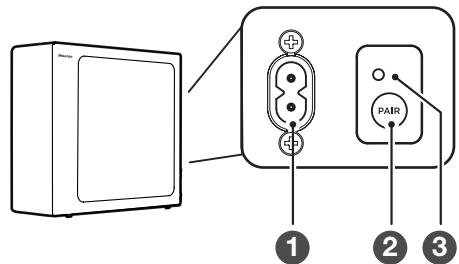

- ① **AC~ Power Cord**  
Connect to power.
- ② **PAIR button**  
Press activate the pairing function between the main unit and the subwoofer.
- ③ **PAIR Indicator**  
Light stops blinking once the Subwoofer is paired with the Soundbar.

### 3.3 Remote Control

- ① Switch the unit between ON and STANDBY mode.
- ② (SOURCE) Select the play function.
- ③ **SURR** Adjust the surround ON/OFF.
- ④ (BT) Select the Bluetooth mode. Press and hold the (BT) button to activate the pairing function in Bluetooth mode or disconnect the existing paired Bluetooth device.
- ⑤ **EQ** Select a preset sound effect.
- ⑥ Skip to previous/next track in BT / USB mode.
- ⑦ **VOL+ / VOL-** Increase/decrease the volume level.
- ⑧ Play/pause/resume playback in BT / USB mode.
- ⑨ **BASS + / -** Adjust bass level.
- ⑩ **TREBLE + / -** Adjust treble level.
- ⑪ **DIMMER + / -** Adjust LED brightness.
- ⑫ (MUTE) Mute or resume the sound.

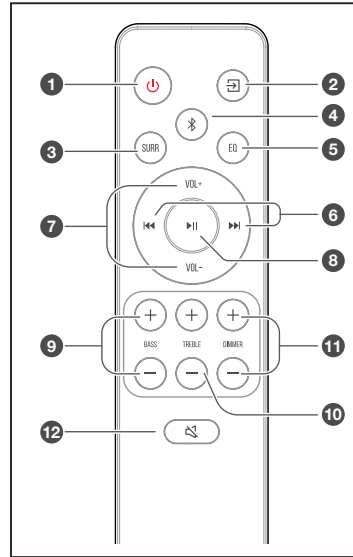

## 4. Preparations

### 4.1 Prepare the Remote Control

The provided Remote Control allows the unit to be operated from a distance.

- Even if the Remote Control is operated within the effective range 19.7 feet (6m), remote control operation may be impossible if there are any obstacles between the unit and the remote control.
- If the Remote Control is operated near other products which generate infrared rays, or if other remote control devices using infra-red rays are used near the unit, it may operate incorrectly. Conversely, the other products may operate incorrectly.

### 4.2 Replace the Remote Control Battery

- 1 Press and slide the back cover to open the battery compartment of the remote control.
- 2 Insert two AAA size batteries. Make sure the (+) and (-) ends of the batteries match the (+) and (-) ends indicated in the battery compartment.
- 3 Close the battery compartment cover.

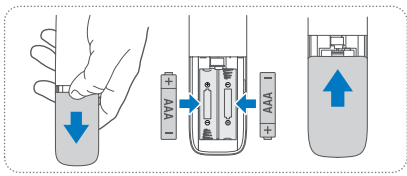

### Precautions Concerning Batteries

- Be sure to insert the batteries with correct positive “+” and negative “-” polarities.
- Use batteries of the same type. Never use different types of batteries together.
- Either rechargeable or non-rechargeable batteries can be used. Refer to the precautions on their labels.
- Be aware of your fingernails when removing the battery cover and the battery.
- Do not drop the remote control.
- Do not allow anything to impact the remote control.
- Do not spill water or any liquid on the remote control.
- Do not place the remote control on a wet object.
- Do not place the remote control under direct sunlight or near sources of excessive heat.
- Remove the battery from the remote control when not in use for a long period of time, as corrosion or battery leakage may occur and result in physical injury, and/or property damage, and/or fire.
- Do not use any batteries other than those specified.
- Do not mix new batteries with old ones.
- Never recharge a battery unless it is confirmed to be a rechargeable type.

### 4.3 Placement and Mounting

#### Placement

- A If your TV is placed on a table, you can place the unit on the table directly in front of the TV stand, centered with the TV screen.
- B If your TV is attached to a wall, you can mount the unit on the wall directly below the TV screen.

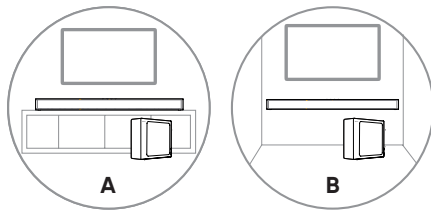

### 4.4 Wall Mounting (if using option-B)

#### Note:

- Installation must be carried out by qualified personnel only. Incorrect assembly can result in severe personal injury and property damage (if you intend to install this product yourself, you must check for installations such as electrical wiring and plumbing that may be buried inside the wall). It is the installer's responsibility to verify that the wall will safely support the total load of the unit and wall brackets.
- Additional tools (not included) are required for the installation.
- Do not overtighten screws.
- Keep this instruction manual for future reference.
- Use an electronic stud finder to check the wall type before drilling and mounting.

#### WARNING

- To prevent injury, this apparatus must be securely attached to the floor/wall in accordance with the installation instructions.
- Suggested wall mounting height:  $\leq 1.5$  meters.

1. Drill 2 parallel holes ( $\varnothing 5.5$ -6 mm each according to wall type) in the wall. The distance between the holes should be **580 mm**.
2. Insert the supplied wall anchors into 2 screw holes on the wall. Insert the supplied wall bracket screws through the wall brackets into the wall anchors. Fix and tighten the screws on the wall.
3. Hang the unit on the wall mount brackets.

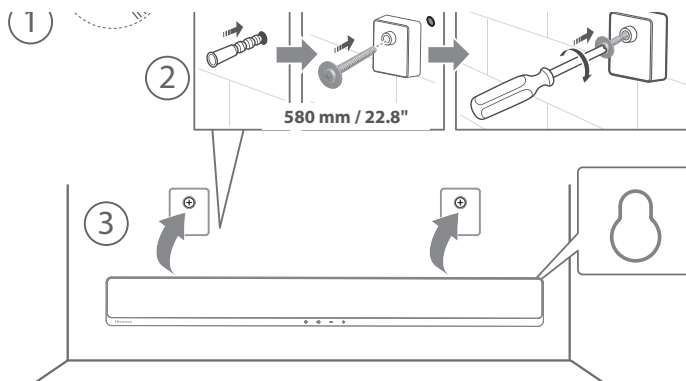

## 5. Connections

### 5.1 Use the HDMI ARC Socket

The ARC (Audio Return Channel) function allows you to send audio from your ARC-compliant TV to your soundbar through a single HDMI connection. To enjoy the ARC function, please ensure your TV is both HDMI-CEC and ARC compliant and set up accordingly. When correctly set up, you can use your TV remote control to adjust the volume output (VOL + /- and Mute) of the soundbar.

- Connect the HDMI cable from unit's **HDMI ARC** socket to the HDMI (ARC) socket on your ARC compliant TV. Then press the remote control to select **HDMI ARC**.

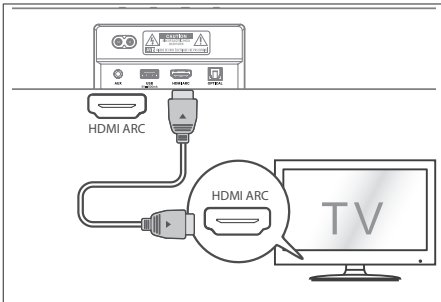

#### Tips:

- Your TV must support the HDMI-CEC and ARC function. HDMI-CEC and ARC must be set to On.
- The setting method of HDMI-CEC and ARC may differ depending on the TV. For details about ARC function, please refer to the owner's manual.
- Only HDMI 1.4 or higher version cable can support the ARC function.

#### Use the Roku TV

- If you have a Roku TV™, simply plug in the HDMI cable to the ARC ports and follow the Roku TV™ Ready on-screen instructions.



- ✓ Simple setup
- ✓ One remote
- ✓ Quick Settings

### 5.2 Use the OPTICAL Socket

- Connect an OPTICAL cable to the TV's OPTICAL OUT socket and the **OPTICAL** socket on the unit.

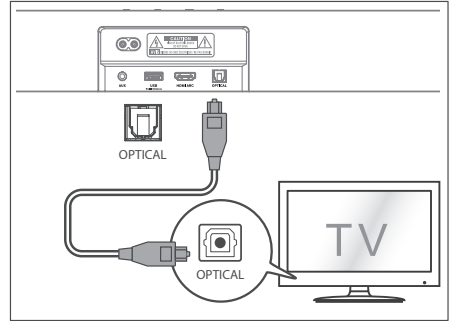

**Tip:** The Soundbar may not be able to decode all digital audio formats from the input source. In this case, the Soundbar will mute. This is NOT a defect. Ensure that the audio setting of the input source (e.g. TV, game console, DVD player, etc.) is set to **PCM** or **Dolby Digital** (Refer to the user manual of the input source device for its audio setting details) with HDMI ARC / OPTICAL input.

### 5.3 Use the AUX Socket

- Use a 3.5mm to 3.5mm audio cable to connect the TV's or external audio device headphone socket to the **AUX** socket on the unit.
- Use a RCA to 3.5mm audio cable to connect the TV's audio output sockets to the **AUX** socket on the unit.

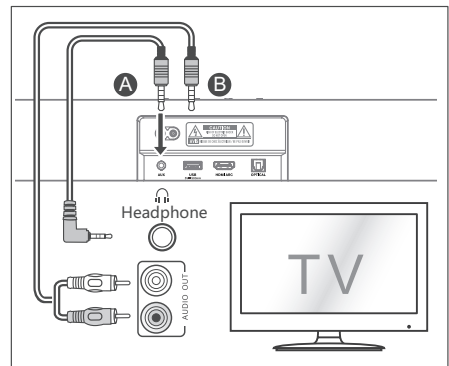

## 5.4 Connect Power

### Risk of product damage!

- Ensure that the power supply voltage corresponds to the voltage printed on the back or the underside of the unit.
- Before connecting the AC power cord, ensure you have completed all other connections.

#### Soundbar

- Connect the mains cable to the **AC~** socket of the Sound Bar and then into a mains socket.

#### Subwoofer

- Connect the mains cable to the **AC~** socket of the subwoofer and then into a mains socket.

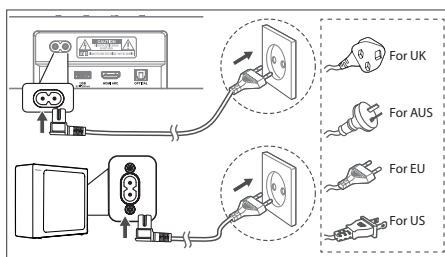

\* Power cord quantity and plug vary by regions.

## 6. Pair up with the Subwoofer

### 6.1 Automatic pairing

The subwoofer and soundbar will automatically pair when both units are plugged into the mains sockets and turned on. No cable is needed for connecting the two units.

- Determine the status based on the wireless Subwoofer indicator.

Lamp	Status
Fast blink	Subwoofer in pairing mode
Slow blink	Connection / Pairing Failed
Constant on	Connected / Pairing successful

#### NOTE:

- Do not press the **PAIR** button on the rear of the subwoofer, except for manual pairing.
- If the automatic pairing fails, pair the subwoofer with the Soundbar manually.

## 6.2 Manual pairing

1. Ensure that all the cables are well connected and the Soundbar is in Standby mode.
2. Press and hold the **PAIR** button on the rear of the subwoofer for a few seconds. The subwoofer will enter the pairing mode and the Pair Indicator will blink quickly.
3. Press the **⏻** button on the Soundbar or on the remote control to switch the Soundbar on.
4. Press and hold the **⏻** button on the Soundbar or on the remote control for a few seconds.
5. After the wireless connection succeeded, the Pair Indicator will light up.
6. If the Pair indicator blinks, the wireless connection has failed. Unplug the cable of the subwoofer and then reconnect the main cable after 4 minutes. Repeat step 1 ~ 4.

#### NOTE:

- If the wireless connection fails again, check if there is conflict or strong interference (for example, interference from an electronic device) around your location. Remove these conflicts or strong interferences and repeat the above procedures.
- The subwoofer should be within 6m (19.7 feet) of the soundbar in an open area.
- If the Soundbar is not connected with the subwoofer and it is in On mode, the POWER Indicator will flash. Follow step 1 ~ 4 above to pair the subwoofer to the Soundbar.

## 6.3 Use the Hisense EzPlay Function

For Hisense EzPlay, when the Soundbar connects with a Hisense TV via HDMI ARC, the will be a Soundbar Setting menu on the TV, and you can control this menu via you TV remote to control most of the Soundbar features.

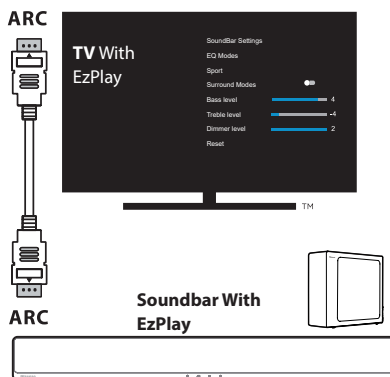

TV menu example (different models may have different menus) :

**Setting--sound--Soundbar Setting.**

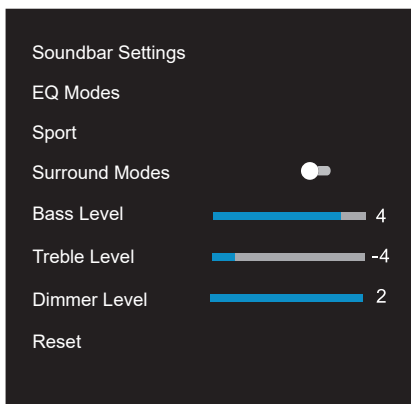

**Note:**

- This function is available only when both Soundbar and TV support Hisense Ezplay.
- This function requires Soundbar and TV connected via HDMI ARC, and the CEC of the TV must be turned ON.
- If everytime setting right, for the first time connect, there would be a tip on the TV screen to guide you find the Soundbar setting menu.

## 7. Basic Operation

### 7.1 Standby/ON

When you first connect the main unit to the mains socket, the main unit will be in Standby mode.

- Press the **⏻** button on the unit or on the remote control to switch the unit ON.
- Press the **⏻** button again to switch the unit back to STANDBY mode.
- Disconnect the mains plug from the mains socket if you want to switch the unit OFF completely.

### 7.2 Auto-Standby / Auto-Wake

**[Auto-Standby]** The soundbar automatically turns to Standby mode after about 15 minutes if the TV or the external soundbar is disconnected (or USB, BT function bit playback pause), or switched off.

**[Auto-Wake]** If a TV or an external device is connected (AUX / OPTICAL / HDMI ARC socket), the unit will switch on automatically when the TV or the external device is switched on.

### Auto-standby ON/OFF

Switch the soundbar on the optical mode, double click the **⏮** (x2) and **⏭** (x2) buttons on the remote control to activate and deactivate the auto-standby:

Auto Standby	
<b>On</b>	Your Soundbar has been programmed to enter Standby mode automatically when no audio is detected for <b>15</b> minutes.
<b>Off</b>	You can turn off the Auto Standby to keep your Soundbar always working.

### Activate and Deactivate the Auto-Wake:

Turn on the soundbar, press the **[⏮] [+]** button at the same time on the soundbar to activate and deactivate the auto-wake:

Auto-Wake	
<b>On</b>	The Soundbar will wake up automatically when audio input is detected.
<b>Off</b>	The Soundbar does not wake up automatically.

## 7.3 Select Modes

- Press the **⏮** (SOURCE) button repeatedly on the unit or on the remote control to select the desired mode.
- The indicator light on the front of the main unit will show which mode is currently in use.

Lamp	Mode
● Red	Standby
● Green	AUX
● Blue	BT (Bluetooth)
● Orange	OPTICAL
● White	HDMI ARC
● Yellow	USB

## 7.4 Adjust the Volume

- Press the **VOL+** / **VOL-** buttons on the unit or on the remote control to adjust the volume.
- If you wish to turn the sound off, press the **⏸** (MUTE) button on the remote control. Press the **⏸** (MUTE) button again or press the **VOL +/–** buttons to resume normal listening.

## 7.5 Turn the Surround Sound ON/OFF

- Press the **SURR** button on the remote control to turn on the surround sound. Press this button again to turn off the surround sound.

## 7.6 Select Equalizer (EQ) Effect

- While playing, press the **EQ** button on the remote control to select desired preset equalizers: **music, movie, news, game, sport, night**.

## 7.7 Adjust the Bass/Treble

- Press the **BASS +/-** buttons on the remote control to adjust bass level.
- Press the **TREBLE +/-** buttons on the remote control to adjust treble level.

## 7.8 Adjust the Brightness

- Press the **DIMMER +/-** button on the remote control to select brightness level.

## 7.9 Factory reset

Reset device to default setting.

- Switch the soundbar on the optical mode, press and hold the [**U**] button on the soundbar, the soundbar will enter factory reset mode and turn to standby state.

MODE	DEFAULT
SOURCE	OPTICAL
Volume	30
Surround	ON
Dimmer	MAX
Bass	0
Treble	0
EQ	Music
Auto Wake	OFF
Auto Standby	ON

## 8. AUX/ OPTICAL/HDMI ARC Operation

- 1 Ensure that the unit is connected to the TV or audio device.
- 2 Press the [**□**] button repeatedly on the unit or on the remote control to select **AUX, OPTICAL, HDMI ARC** mode.
- 3 Operate your audio device directly for playback features.
- 4 Press the **VOL +/-** button to adjust the volume to your desired level.

**Tip:** The Soundbar may not be able to decode all digital audio formats from the input source. In this case, the Soundbar will mute. This is NOT a defect. Ensure that the audio setting of the input source (e.g. TV, game console, DVD player, etc.) is set to **PCM** or **Dolby Digital** (Refer to the user manual of the input source device for its audio setting details) with HDMI ARC / OPTICAL input.

## 9. USB Operation

- 1 Insert the USB device.

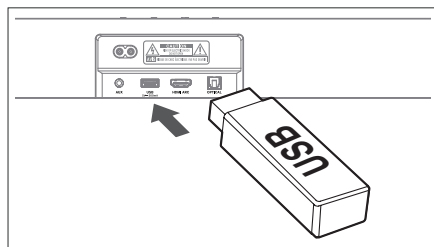

- 2 Press the [**□**] button repeatedly on the unit or on the remote control to select **USB** mode.
- 3 During playback:

**▶||** Start, pause or resume play

**◀◀, ▶▶** Skip to the previous or next track

**Tips:**

- The unit can support USB devices with up to 32 GB of memory.
- This unit can play WAV / WMA / MP3 / FLAC.
- This product may not be compatible with certain types of USB storage devices.
- If you use a USB extension cable, USB hub, or USB Multifunctional card reader, the USB storage device may not be recognized.
- Do not remove the USB storage device while reading files.

## 10. Bluetooth Operation

Through Bluetooth, connect the Soundbar with your Bluetooth device (such as an iPad, iPhone, iPod touch, Android phone, or laptop), and then you can listen to the audio files stored on the device through your Soundbar speakers.

### First time pairing

- 1 Press the  (SOURCE) button on the unit or the  button on the remote control to select **Bluetooth** mode. The Blue indicator will flash slowly and the white running horse lamp rolling.
  - 2 Activate your Bluetooth device and select the search mode.
  - 3 Select **"Hisense HS2100"** in the pairing list. After audio prompt, the system is successfully connected and Blue indicator will light up solidly.
- If you want to connect your soundbar with another Bluetooth device, press and hold the  button on the remote control to disconnect the currently connected Bluetooth device. Follow step 2-3 to pair your Bluetooth device.

### To disconnect the Bluetooth function, you can :

- Switch to another function on the unit.
- Disable the function from your Bluetooth device.
- Press and hold the  button, the Bluetooth device will be disconnected from the soundbar.

## Listen to music from Bluetooth Device

- If the connected Bluetooth device supports Advanced Audio Distribution Profile (A2DP), you can listen to the music stored on the device through the player.
  - If the device also supports Audio Video Remote Control Profile (AVRCP), you can use the player's remote control to play music stored on the device.
1. Pair your device with the player.
  2. Play music via your device (if it supports A2DP).
  3. Use supplied remote control to control play (if it supports AVRCP).

---

 Start, pause or resume play

---

 Skip to the previous or next track

---

**Tips:**

- The operational range between the Sound Bar and the device is approximately 8 metres.
- Before connecting a Bluetooth® device to the Sound Bar, ensure you know the device's capabilities.
- Compatibility with all Bluetooth® devices is not guaranteed.
- Any obstacle between the device and the Sound Bar can reduce operational range.
- Keep this player away from other electronic devices that may cause interference.
- The player will also be disconnected when your device is moved beyond the operational range.

## 11. Troubleshooting

To keep the warranty valid, never try to repair the system yourself. If you encounter problems when using this unit, check the following points before requesting service.



### No power

- Ensure that the AC cord of the apparatus is properly connected.
- Ensure that there is power at the AC outlet.
- Press standby button to turn the unit on.

### Remote control does not work

- Before you press any playback control button, first select the correct source.
- Reduce the distance between the remote control and the unit.
- Insert the battery with its polarities (+/-) aligned as indicated.
- Replace the battery.
- Aim the remote control directly at the sensor on the front of the unit.

### No sound

- Make sure that the unit is not muted. Press  or VOL+/- button to resume normal listening.
- Press  button on the unit or on the remote control to switch the soundbar to standby mode. Then press the  button again to switch the soundbar on.
- Unplug both the soundbar and the subwoofer from the mains socket, then plug them again. Switch on the soundbar.
- Ensure the audio setting of the input source (e.g. TV, game console, DVD player, etc.) is set to PCM or Dolby Digital mode while using digital (e.g. HDMI, OPTICAL, COAXIAL) connection.
- The subwoofer is out of range, please move the subwoofer closer to the soundbar. Make sure the subwoofer is within 5 m of the soundbar (the closer the better).
- The soundbar may have lost connection with the subwoofer. Re-pair the units by following the steps on the section "Pairing the Wireless Subwoofer with the Soundbar".
- The unit may not be able to decode all digital audio formats from the input source. In this case, the unit will mute. This is NOT a defect. device is not muted.

### I can't find the Bluetooth name of this unit on my Bluetooth device for Bluetooth pairing

- Ensure the Bluetooth function is activated on your Bluetooth device.
- Ensure you have paired the unit with your Bluetooth device.

### The Soundbar turns off

- When the unit's external input signal level is too low, the unit will be turned off automatically in 15 minutes. Please increase the volume level of your external device.

### The Subwoofer is idle or the indicator of Subwoofer do not light up.

- Please unplug power cord from the mains socket, and plug it in again after 4 minutes to reset the subwoofer.

## 12.Specifications

Brand	Hisense
Model	HS2100

### Soundbar

Power Supply	100-240V~ 50/60Hz
Power Consumption	20 W < 0.5 W (StandBy)
USB	5V --- 500mA Hi-Speed USB (2.0) / FAT32 / FAT16 32G (max) , WAV / WMA / MP3 / FLAC.
Dimension (WxHxD)	800 x 60 x 90 mm / 31.5" x 2.4" x 3.5"
Net weight	1.5 kg
Audio input sensitivity	700mV
Frequency Response	120Hz - 20KHz
Operating Temperature	0°C - 45°C

### Wireless Specification

Bluetooth version / profiles	V 5.3 (A2DP, AVRCP)
Bluetooth frequency range	2400 MHz ~ 2483.5 MHz
Bluetooth Max. transmitting power	≤ 5 dBm
2.4G Wireless frequency range	2400 MHz ~ 2483 MHz
2.4G Max. transmitting power	≤ 6 dBm
Modulation Type	GFSK, $\pi/4$ DQPSK

### Subwoofer

Power Supply	100-240V~ 50/60Hz
Power Consumption	20 W < 0.5 W (StandBy)
Dimension (W x H x D)	110 x 300 x 350 mm / 4.3" x 11.8" x 13.8"
Net weight	3.4 kg
Frequency Response	40Hz - 120Hz

### Amplifier (max audio power)

Total	240 W
Soundbar	60 W x 2
Subwoofer	120 W

### Remote Control

Distance/Angle	19.7 feet (6m) / 30°
Battery type	AAA (1.5V x 2)

- Design and specifications are subject to change without notice.

# Trademarks

---



The Bluetooth® word mark and logos are registered trademarks owned by Bluetooth SIG, Inc. and any use of such marks by Hisense is under license. Other trademarks and trade names are those of their respective owners.



The Adopted Trademarks HDMI, HDMI High-Definition Multimedia Interface, and the HDMI Logo are trademarks or registered trademarks of HDMI Licensing Administrator, Inc. in the United States and other countries.



Manufactured under license from Dolby Laboratories. Dolby, Dolby Audio, and the double-D symbol are trademarks of Dolby Laboratories.



For DTS patents, see <http://patents.dts.com>. Manufactured under license from DTS, Inc. (for companies headquartered in the U.S./Japan/Taiwan) or under license from DTS Licensing Limited (for all other companies). DTS, Digital Surround, Virtual:X, and the DTS logo are registered trademarks or trademarks of DTS, Inc. in the United States and other countries. © 2021 DTS, Inc. ALL RIGHTS RESERVED.



- EN** Roku, the Roku logo, Roku TV, Roku TV Ready, and the Roku TV Ready logo are trademarks and/or registered trademarks of Roku, Inc. This product is Roku TV Ready-supported in the United States, Canada, United Kingdom and Mexico. Countries are subject to change. For the most current list of countries in which this product is Roku TV Ready-supported, please email [rokutvready@roku.com](mailto:rokutvready@roku.com).
- FR** Roku, le logo Roku, Roku TV, Roku TV Ready et le logo Roku TV Ready sont des marques de commerce et/ou des marques déposées de Roku Inc. Ce produit est certifié Roku TV Ready au/en États-Unis, Canada, Royaume-Uni, et Mexique. La liste de pays peut varier. Pour obtenir la liste la plus récente des pays dans lesquels ce produit est pris en charge par Roku TV Ready, veuillez envoyer un courriel à [rokutvready@roku.com](mailto:rokutvready@roku.com).
- ES** Roku, el logotipo de Roku, Roku TV, Roku TV Ready y el logotipo de Roku TV Ready son marcas comerciales o marcas comerciales registradas de Roku, Inc. Este producto es compatible con Roku TV Ready en Estados Unidos, Canadá, Reino Unido, y México. Los países están sujetos a cambios. Para obtener la lista más actualizada de países en los que este producto es compatible con Roku TV, envía un correo electrónico a [rokutvready@roku.com](mailto:rokutvready@roku.com).



Séparez les éléments avant de trier