

DTT169
TWIN TUB WASHING MACHINE



Believe in better

Customer Care Line
(after sales service)

086 100 3339

Laundry
Instruction manual

INDEX



- 3 SAFETY INSTRUCTIONS**
- 5 PRECAUTIONS**
- 6 YOUR WASHING MACHINE**
- 7 INSTALLATION**
- 8 WASHING**
- 11 RINSING**
- 14 SPIN DRYING**
- 15 AFTER USE**
- 16 MAINTENANCE**
- 17 HELP**
- 18 CUSTOMER CARE**
- 19 WARRANTY**
- 20 SPECIFICATIONS**

Safety instructions

General safety

- This washing machine is not intended for use by persons (including children) with reduced physical, sensory or mental capabilities or lack of experience and knowledge unless they have been given supervision or instruction concerning the use of the washing machine by a person responsible for their safety.
- Children should be supervised to ensure that they do not play with the washing machine.
- Never place the washing machine on a carpeted floor. Lack of airflow beneath the machine could cause overheating.
- In case of a malfunction or maintenance work, disconnect the washing machine from the electrical mains immediately. Repairs must only be made by a qualified technician.
- Before washing, check all clothes for loose buttons and tears. Check pockets for coins, pins or other small articles. Close zips and fasteners. Wash small articles inside a pillow case.
- Do not wash clothes stained with or soaked in petrol, thinners, kerosene, vegetable oil or any other flammable liquids. Nor should any of these liquids be added to the wash water as they constitute a fire hazard or there may be a risk of an explosion.
- Only use the machine for washing fabrics. Do not attempt to wash plastic leather or fibreglass. Sort and separate clothes by fabric, colour and degree of dirt.
- Use detergents, softeners and supplements suitable for top loading automatic washing machines only.
- Always unplug the machine from the wall socket when it requires cleaning or service. Only permit qualified persons to repair or install parts in the washer.
- Do not use water which is hotter than 50 degrees Celsius as this may deform plastic parts of the machine, which could result in injury, electric shock or water leakage.
- The water supply and draining hoses must be securely fastened and remain undamaged to prevent water leakage.

- Check the water supply hose connection by turning on the water before washing and ensure there is no water leakage.
- Follow the instructions on the textile tags and on the detergent package.
- Installation and repairing procedures must be carried out by an Authorized Service Agent. Repairs carried out by incompetent persons create a user risk: There may be a risk of accidental fire. If the washer operates abnormally, it may cause an injury. The Manufacturer shall not be held liable for damages that may arise from procedures carried out by unauthorized persons.
- Do not expose the machine to any type of flame or put cigarettes or any volatile substances on the machine top. The machine may catch fire or the machine may be deformed due to its large number of plastic components.
- Do not install the machine in a bathroom or very humid place. Doing so may cause a malfunction or result in a short circuit and there is a risk of an electric shock.
- Never wash the machine by spreading or pouring water onto it! Avoid spraying water on to the control panel and back of the machine. There is the risk of an electric shock, and it may cause the machine to malfunction.

	<p>Warning! Never reach into or put your hands into the wash/spin tub whilst the machine is operating. If you reach into the wash/spin tub serious injury could result. Wait until all motion stops.</p>
	<p>Warning! The machine must be unplugged during installation, maintenance, cleaning and repairing procedures to avoid the risk of an electric shock.</p>

- **Do not wash, rinse or spin water proof fabrics such as sleeping bags, raincoats, car covers etc.** Washing these types of materials may lead to injury through abnormal vibration during spinning or damage may result to the washing machine, wall, floor and clothes.
- Keep hands and feet away from the bottom of the washing machine when it is in use to avoid the risk of injury.
- Do not stand on the washing machine or place weight on the washing machine. Damage to the washing machine may result and there is a risk of personal injury.
- Turn off the water supply at the tap when the washing machine is not in use to minimise the risk of damage that could arise from water leakage. Unplug the washing machine if it is not going to be used for a long period of time.

Intended use

- The washing machine must only be used domestically and for the purposes for which it was designed.

Children's safety

- Electrical products are dangerous for children. Keep children away from the washing machine when it is in use. Use child lock to prevent children from tampering with the washing machine controls.
- Store all detergents and additives in a safe place away from the reach of the children by closing the cover of the detergent container or sealing the detergent package.
- Do not allow children to play on or in the machine. If a child accidentally falls into the wash/spin tub, serious injury could occur. Close the lid when leaving the room where the machine is located.
- Keep children away from the washing machine and keep boxes or steps well away from the washing machine to prevent children from stepping up and accessing the controls, lid and wash tub of the washing machine.

Transportation of the machine

1. Unplug the machine before transporting it.
2. Remove water drain hose and water supply hose connections.

3. Drain all remaining water from the machine.

Unpacking

- Remove all packaging and dispose of it in a responsible manner. Plastic bags should be cut up to prevent children playing with them and accidentally suffocating.
- Open the wash-tub lid and remove all the accessories stored in the wash tub.
- Do not attempt to operate the machine while any of the packaging is still in place.

Electrical connection

- The washing machine must be earthed and the manufacturer and seller do not accept responsibility for any damage due to incorrect electrical connection.
- Connection must comply with national regulations.
- The washing machine should be plugged into a 16 Amp, 230-240V~50Hz earthed 3 pin wall socket. If the current value of the fuse or breaker in the house is less than 16 Amps, have a qualified electrician install a 16 Amp fuse.

Ensure that the power plug and power cord are properly connected.

- Never touch the plug with wet hands!
- Never unplug by pulling on the cable, always pull out by grabbing the plug.
- Do not operate a damaged washing machine. Consult with your nearest DEFY service centre should you have any concerns.
- If the power cable is damaged, it must be replaced by the manufacturer, after sales service or a similarly qualified person.
- Never plug the washing machine into the wall socket during installation. Death or serious injury may result.
- For safety reasons, the wall socket and the plug should be accessible after installation.
- Do not make connections via extension cables or multi-plugs.



Warning: Installation and electrical connections of the machine must be carried out by an Authorized Service Agent. The Manufacturer shall not be held liable for damages that may arise.

Precautions

1



DO NOT TOUCH THE SPIN DRUM WHEN IT IS ROTATING

2

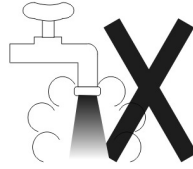

DO NOT USE WATER HOTTER THAN 55°C. VERY HOT WATER COULD DAMAGE PARTS OF THE MACHINE

3



IMPORTANT ALWAYS USE THE SPIN TUB DISC COVER AS THIS PREVENTS CLOTHING FROM RISING OUT OF THE SPIN TUB

4



DO NOT MACHINE WASH CLOTHES SOAKED IN PETROL, THINNERS, PARAFFIN OR ANY OTHER FLAMMABLE LIQUIDS

5



**CHECK ALL CLOTHES FOR LOOSE BUTTONS AND TEARS
CHECK POCKETS FOR COINS, PINS ETC.**

6

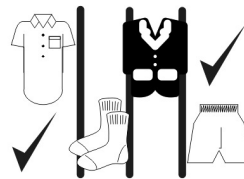

SORT AND SEPARATE CLOTHES BY FABRIC, COLOUR AND DEGREE OF DIRT

7



USE ONLY SOAP POWDERS SPECIALLY DESIGNED FOR TWIN TUB WASHING MACHINES

8



DO NOT SPLASH WATER OVER THE CONTROLS AS THIS COULD LEAD TO AN ELECTRICAL PROBLEM

**IMPORTANT NEVER TRY TO TURN A KNOB FURTHER THAN THE MARKING ON THE DIAL
TURN ANTI CLOCKWISE TO RETURN THE KNOB TO "0"**

Your washing machine

Control panel

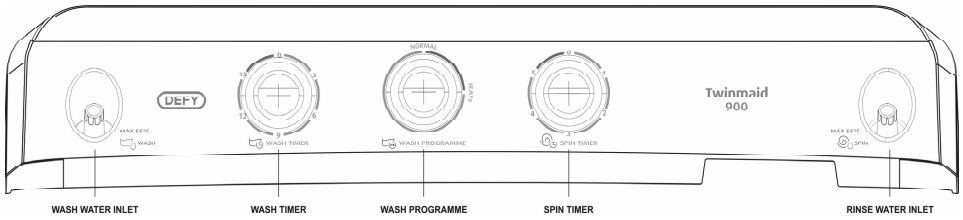

**CONTROL
PANEL**

**WASH
WATER
INLET**

**RINSE
WATER
INLET**

**WASH
TUB**

**SPIN
TUB**



Accessories

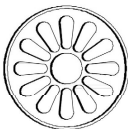

**SPIN TUB
LID COVER**



**WATER SUPPLY
HOSE**



**DRAIN HOSE
AND CLAMP**

Installation

1 DO NOT STAND THE MACHINE WHERE IT IS EXPOSED TO DIRECT SUNLIGHT OR RAIN

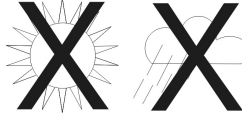

2 CONNECT THE INLET HOSE TO THE WATER TAP AND TO THE MACHINE



3 PUSH THE 3 PIN PLUG INTO A 15A. EARTHED WALL SOCKET

WARNING:
THIS APPLIANCE MUST BE EARTHED

4 TURN THE TIMER CONTROL KNOB TO "0"

5 SECURE THE END OF THE DRAIN HOSE OVER THE PUMP OUTLET AT THE LOWER BACK OF THE MACHINE.

HANG THE HOOKED END OF THE DRAIN HOSE OVER A DRAIN OUTLET. SINK, BATH OR PIPE NOT HIGHER THAN 1.5 METRES ABOVE FLOOR LEVEL.

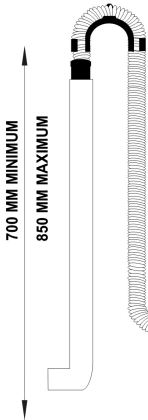

PUMP OUTLET AT BACK OF MACHINE

THE MACHINE MUST STAND ON A LEVEL SURFACE

Washing

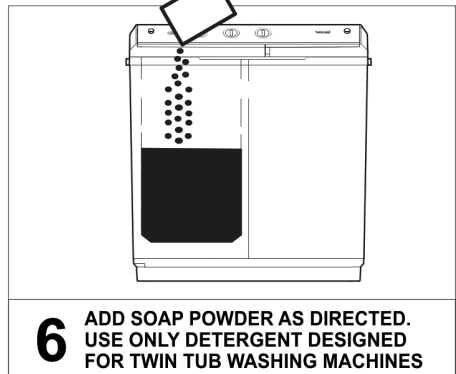
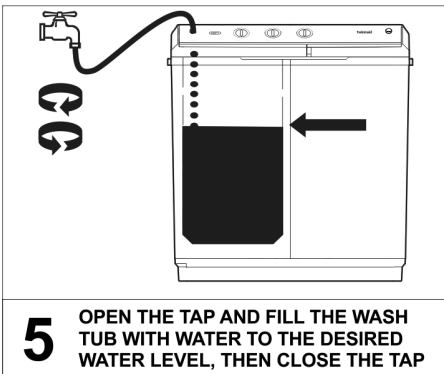
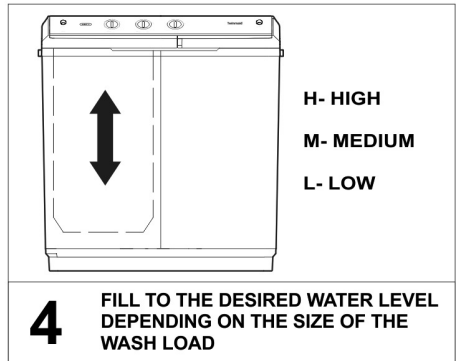
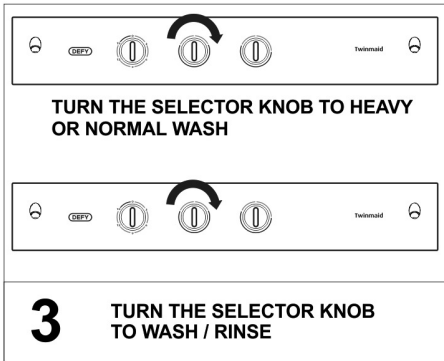
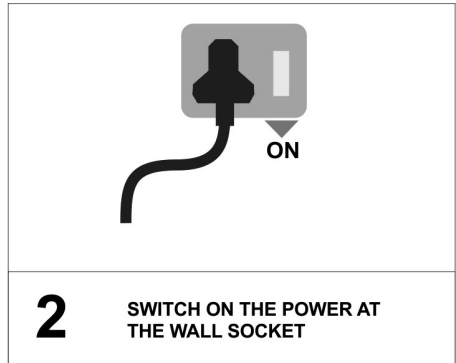

Washing continued



8 TURN THE WASH TIMER KNOB TO THE DESIRED TIME.

WASH	FABRIC	TIME
GENTLE	SYNTHETICS WOOL, SILK	2-5 min.
NORMAL	COTTON LINEN	5-15 min.
HEAVY	VERY DIRTY WASHING	9-15 min.

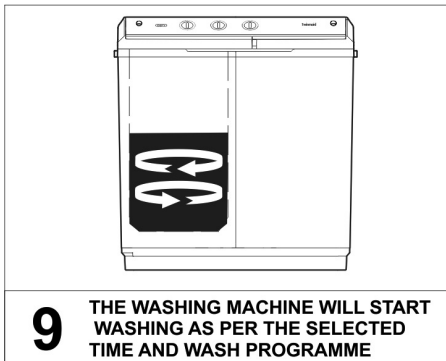

WARNING

IMPORTANT
NEVER TURN A KNOB FURTHER THAN THE MARKING ON THE DIAL
TURN ANTI CLOCKWISE TO RETURN TO "0"

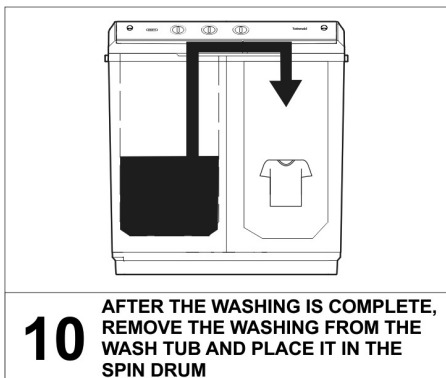

11 IF REQUIRED, ANOTHER LOAD MAY BE WASHED IN THE SAME SOAPY WATER. IF NOT, THE MODE SELECTOR KNOB SHOULD BE TURNED TO DRAIN

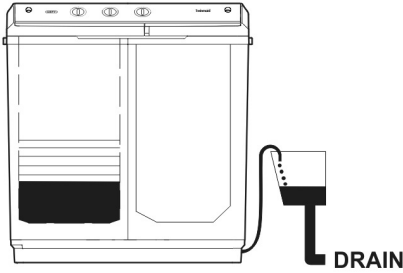

12 THE SOAPY WATER WILL DRAIN FROM THE MACHINE

WARNING

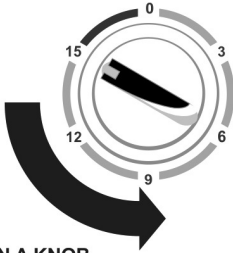

IMPORTANT
NEVER TURN A KNOB FURTHER THAN THE MARKING ON THE DIAL
TURN ANTI CLOCKWISE TO RETURN TO "0"

IMPORTANT

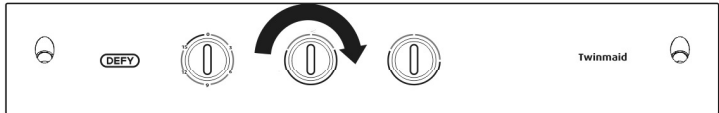

13

AFTER ALL THE WATER HAS DRAINED, THE SELECTOR MUST BE RETURNED TO THE WASH / RINSE MODE. FAILURE TO DO SO WILL ALLOW THE PUMP TO CONTINUE RUNNING AND MAY CREATE AN AIR LOCK WHICH WILL PROHIBIT EFFECTIVE DRAINING. IF THE DRAIN MODE HAS BEEN SELECTED AND THE MACHINE DOES NOT DRAIN, IT IS PROBABLE THAT AN AIR LOCK HAS OCCURRED. TO CLEAR AN AIR LOCK, THE SELECTOR SHOULD BE TURNED TO THE "WASH / RINSE" MODE FOR ABOUT FIVE SECONDS BEFORE RETURNING IT TO THE DRAIN POSITION.

Rinsing

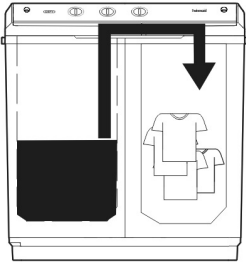

1 PLACE THE WET WASHING IN THE SPIN DRUM, DISTRIBUTING IT EVENLY

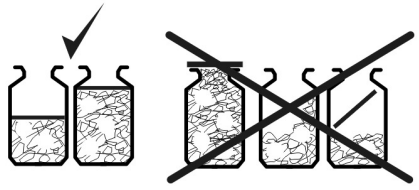

2 PUSH THE WASHING DOWN GENTLY INTO THE SPIN DRUM AND PLACE THE DISC COVER IN THE DRUM SO THAT IT COMPLETELY COVERS THE WASH LOAD

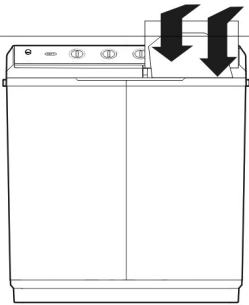

3 CLOSE BOTH THE INNER AND OUTER LIDS OF THE SPIN TUB



4 TURN THE SPIN TIMER KNOB TO APPROXIMATELY 2 MINUTES

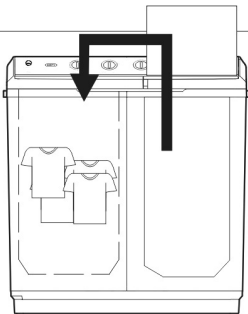

5 REMOVE THE WASH LOAD FROM THE SPIN DRUM AND PLACE IT IN THE EMPTY WASH TUB

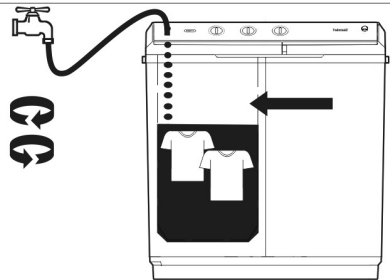

6 OPEN THE TAP AND FILL THE WASH TUB WITH WATER TO THE DESIRED LEVEL, THEN CLOSE THE TAP

Rinsing - continued

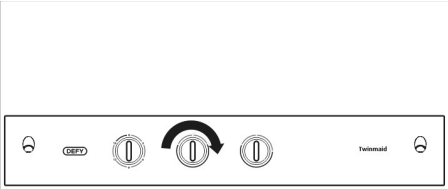

7 SET THE WASH PROGRAMME KNOB TO NORMAL

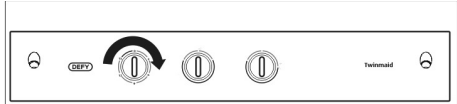

8 SET THE WASH TIMER KNOB TO THE REQUIRED RINSING TIME

DELICATE RINSE - SYNTHETICS, WOOL, SILK 2 - 5 MIN

NORMAL RINSE - COTTON, LINEN 5- 15 MIN

HEAVY RINSE - HEAVY ROBUST FABRICS 9 - 15 MIN

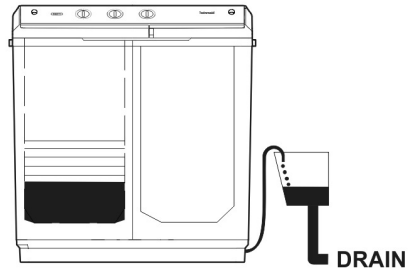
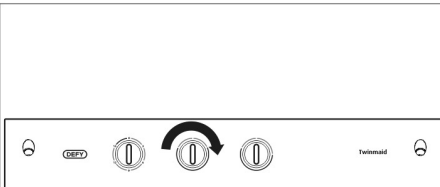

9 AFTER RINSING, TURN THE SELECTOR KNOB TO DRAIN.
THE RINSE WATER WILL DRAIN FROM THE MACHINE

10
IMPORTANT

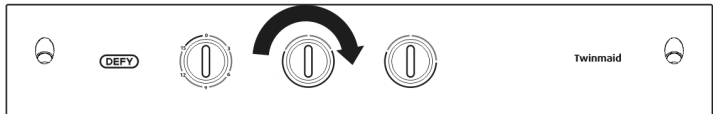

YOU MAY WISH TO REPEAT STEPS 6 TO 9 UNTIL YOU ARE SATISFIED THAT THE WASHING HAS BEEN PROPERLY RINSED.

AFTER ALL THE WATER HAS DRAINED, **THE SELECTOR MUST BE RETURNED TO THE WASH / RINSE MODE** FAILURE TO DO SO WILL ALLOW THE PUMP TO CONTINUE RUNNING AND MAY CREATE AN AIR LOCK WHICH WILL PROHIBIT EFFECTIVE DRAINING.

IF THE DRAIN MODE HAS BEEN SELECTED AND THE MACHINE DOES NOT DRAIN, IT IS PROBABLE THAT AN AIR LOCK HAS OCCURRED.

TO CLEAR AN AIR LOCK, THE SELECTOR SHOULD BE TURNED TO THE "WASH / RINSE" MODE FOR ABOUT FIVE SECONDS BEFORE RETURNING IT TO THE DRAIN POSITION.

Rinsing Option

IT IS POSSIBLE TO RINSE LAUNDRY BY ADDING CLEAN WATER TO THE SPIN TUB WHILST SPINNING.

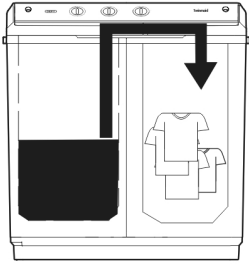

- 1** PLACE THE WET WASHING IN THE SPIN DRUM, DISTRIBUTING IT EVENLY

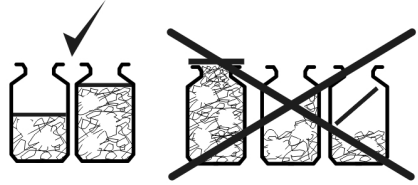

- 2** PUSH THE WASHING DOWN GENTLY INTO THE SPIN DRUM AND PLACE THE DISC COVER IN THE DRUM SO THAT IT COMPLETELY COVERS THE WASH LOAD

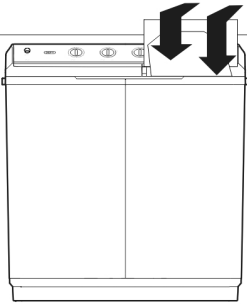

- 3** CLOSE BOTH THE INNER AND OUTER LIDS OF THE SPIN TUB



- 4** TURN THE SPIN TIMER KNOB TO APPROXIMATELY 2 MINUTES

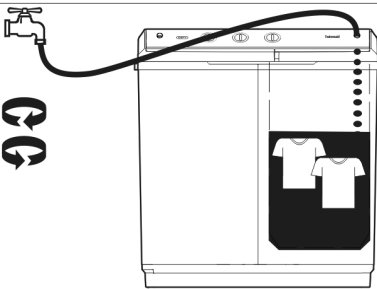

- 5** OPEN THE TAP. ADD WATER TO THE SPIN TUB WHILE SPINNING

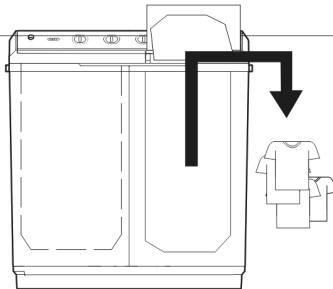

- 6** CLOSE THE TAP. COMPLETE THE SPIN CYCLE. REMOVE THE WASHING FROM THE SPIN TUB AND DRAIN THE WATER FROM THE WASH TUB.

Spin drying

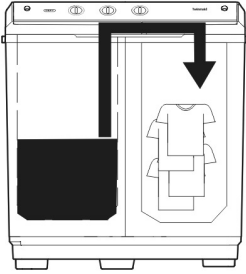

1 PLACE THE WET WASHING IN THE SPIN DRUM, DISTRIBUTING IT EVENLY

PUSH THE WASHING DOWN GENTLY INTO THE SPIN DRUM AND PLACE THE DISK COVER IN THE DRUM SO THAT IT COMPLETELY COVERS THE WASH LOAD



2 FAILING TO PLACE THE DISK COVER INTO THE SPIN DRUM COULD CAUSE THE CLOTHING TO RISE OUT OF AND GET ENTANGLED ROUND THE DRUM

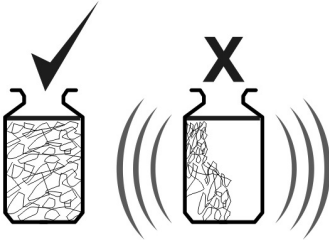

3 CAUTION: EVENLY DISTRIBUTE WET WASHING IN THE SPIN DRUM. AN OUT OF BALANCE LOAD COULD DAMAGE THE SPIN TUB

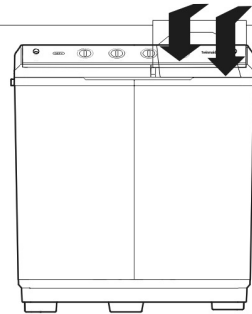

4 CLOSE BOTH THE INNER AND OUTER LIDS OF THE SPIN TUB

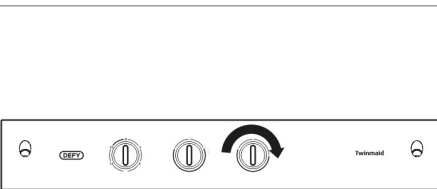

5 TURN THE SPIN TIMER KNOB TO THE DESIRED SPIN TIME

RECOMMENDED SPIN TIMES

FABRIC	TIME
DELICATE FABRICS SYNTHETICS WOOL, SILK	1 min.
COTTON LINEN	2-4 min.
HEAVY FABRICS COTTON	3-5 min.

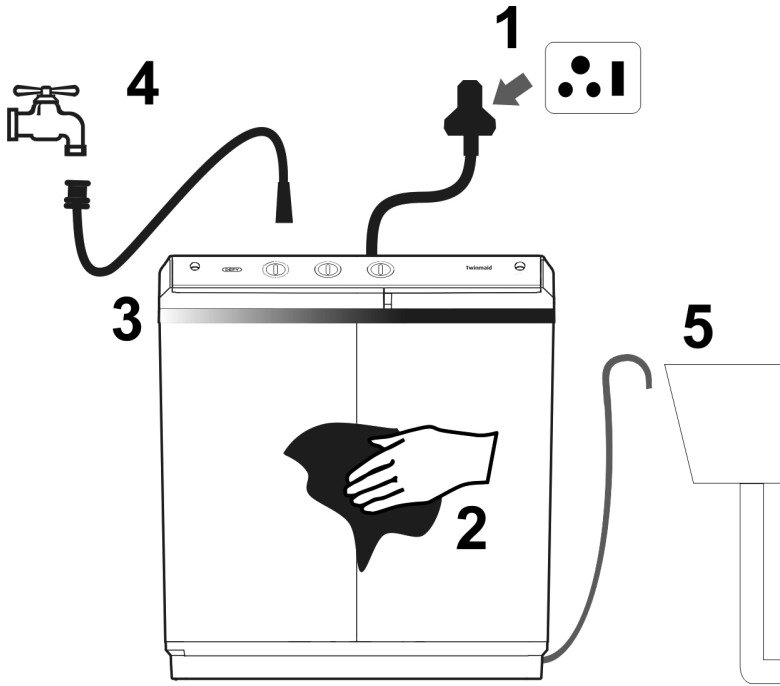

NEVER TOUCH THE ELECTRICAL PLUG OR SOCKET WITH WET HANDS

- 1 SWITCH THE POWER OFF AT THE WALL SOCKET AND REMOVE THE PLUG FROM THE SOCKET.
- 2 DRY THE CABINET, THE CONTROL PANEL AND INSIDE THE TUBS WITH A SOFT, LINT FREE CLOTH.
- 3 PLACE THE WASH TUB LID IN POSITION OVER THE WASH TUB.
- 4 IF YOU WISH TO MOVE THE MACHINE, FIRST UNCOUPLE THE INLET HOSE FROM BOTH THE TAP AND THE MACHINE.
- 5 REMOVE THE OUTLET HOSE FROM THE DRAIN BUT DO NOT DETACH THE OUTLET HOSE FROM THE MACHINE.

Maintenance

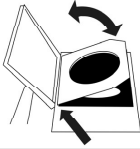

ARTICLES LOST FROM THE SPIN TUB
ARTICLES MAY BE RETRIEVED BY PULLING THE SAFETY COVER UPWARDS. REMOVE THE CLOTHES AND REPLACE THE COVER. BY PRESSING DOWN ON THE TWO FRONT CORNERS.

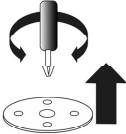

BLOCKED PULSATOR

HOLD THE PULSATOR AND LOOSEN THE PHILIPS SCREW. LIFT OFF THE PULSATOR AND REMOVE THE BLOCKAGE. REPLACE THE PULSATOR, TIGHTEN THE SCREW AND REPLACE THE LID.



CLEANING THE LINT FILTER

CLEAN THE LINT FILTER ONCE EVERY 7 DAYS

- REMOVE THE LINT FILTER.
- PULL OUT THE DEBRIS AND WASH THE LINT FILTER IN WATER.
- REFIT THE FILTER. ENSURE THAT IT IS CORRECTLY SEATED.

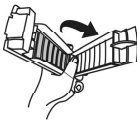

CLEANING THE CABINET

WIPE THE CABINET WITH A DAMP SOAPY CLOTH. RINSE AND WIPE DRY. DO NOT USE HOUSEHOLD CLEANERS, ABRASIVES OR VOLATILE LIQUID CLEANERS

REGULARLY CLEAN THE DRAIN FILTER ,LOCATED AT THE REAR OF THE MACHINE

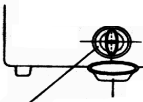

Place a shallow container under drain to collect any residual spillage



Turn the filter cap in an anticlockwise direction

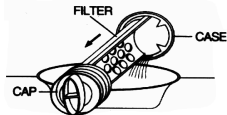

Pull the filter assembly out.



Clean the drain filter.

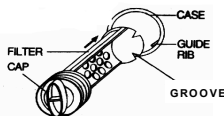

Re-fit the filter guides ensuring that the groove in the filter aligns with the guide rib

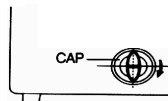

Tighten the cap by turning in a clockwise direction

Help

**IF YOUR MACHINE WILL NOT WORK,
CHECK THE FOLLOWING BEFORE CALLING A SERVICE TECHNICIAN**

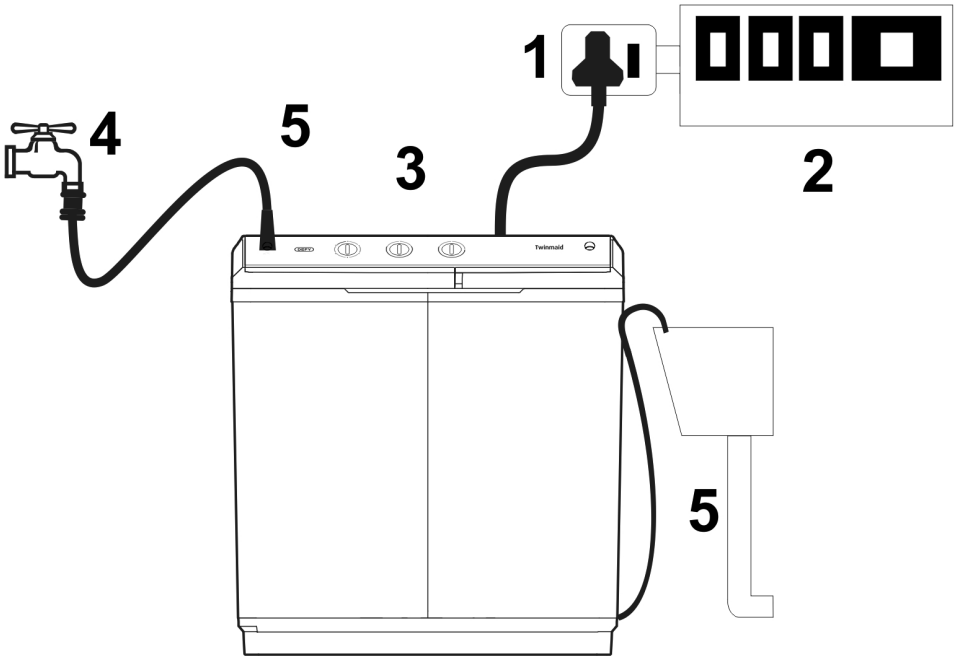

- 1 IS THE PLUG IN THE WALL SOCKET AND HAS THE POWER BEEN SWITCHED ON?
- 2 HAS A HOUSE FUSE BLOWN OR HAS A CIRCUIT BREAKER TRIPPED?
- 3 ARE THE CONTROL KNOBS IN THE CORRECT POSITION?
- 4 HAS THE WATER TAP BEEN TURNED OPEN?
- 5 HAS AN INLET OR OUTLET HOSE BEEN KINKED, TWISTED OR BENT?
- 6 HAVE THE FILTERS BEEN CLEANED?
- 7 CHECK FOR CLOTHES ENTANGLED ROUND THE SPIN DRUM.
- 8 HAS THE SPIN TUB LID BEEN CLOSED PROPERLY?

**IF YOU HAVE FOLLOWED THE INSTRUCTIONS AND STILL HAVE A PROBLEM,
CONTACT THE NEAREST DEFY SERVICE CENTRE.
THEY WILL BE ABLE TO HELP OR SEND A FACTORY TRAINED TECHNICIAN
TO ASSIST YOU.**

Defy customer care call centre

If you have followed the instructions and still have a problem or have any service or spares queries, please contact the customer care line by sending an email to service@defy.co.za or by calling **0861 00 3339**. They will be able to advise you on any aspect of the appliance.

Defy Sub-Saharan Africa Branch contact details

ZAMBIA: SOUTHGATE INVESTMENTS LTD

Plot 1606, Sheki Sheki Road
P.O. Box 33681
Lusaka, 10101, Zambia
Tel: +260 0211 242332/3
Fax: +260 0211 242933
defyservicecenter@outlook.com

NAMIBIA: ATLANTIC DISTRIBUTORS (PTY) LTD

10 Tienie Louw Street, Northern Industrial Area
P.O. Box 21158, Windhoek, Namibia
Tel: (061) 216162
Fax: (061) 216134
atlantic@mweb.com.na

ZIMBABWE: TRADE COM AFRICA

Trade Com Africa, 183 Loreley Crescent
Msasa, Harare, Zimbabwe
Tel: +00263 773 438001
servicecentre@tradecomafrika.com

BOTSWANA: RAY MORGAN AGENCIES

RMA Service Centre, Plot 48, East Gate
Gaborone International Commerce Park
Kgale View, Gaborone
Botswana
Tel: +267 390 3996 / 390 3912
Fax: +267 318 7376
Cell: +267 7134 6539
service@rma.co.bw

SWAZILAND: LYNDS DISTRIBUTORS

P.O Box 716, Mbabane, Swaziland, H100
Tel: (00268) 2515 4310/8
Fax: (00268) 2518 4318
workshop@hoageys.co.sz

MOZAMBIQUE: COOL WORLD. LDA

Rua da Resistencia No. 97B R/C
Cell: +258 84 44 61 234
mdwholesale@mweb.co.za
Nosso Show Room
Av: da Industrias, Parcela No.735 * 735A
Machava, Maputo

Warranty

This certificate is issued by DEFY APPLIANCES (PTY) LIMITED manufacturers of Defy and Ocean products, hereinafter the Company, to the original purchaser only, of the appliance described on the certificate and shall constitute the only warranty given in respect of this appliance.

The Company warrants to the original purchaser that for a period of ONE YEAR from date of purchase the appliance is free from defect under normal domestic use, both in workmanship and material, subject to the following conditions.

1. Repair or replacement of any part of this appliance, found by the Company to be defective, shall be at the election of the Company. The Company reserves the right to effect such service through any of its Service Divisions or Authorised Service Dealers. The cost of such service shall be borne by the Company in full, provided that the appliance is located no further than 50km from a Company Service Centre or an Authorised Service Dealer. Where the appliance is located beyond the 50km radius, the purchaser shall be liable for the standard travelling charges, as determined by the Company.
2. Cracked, rusted or corroded solid plates, vitreous enamelware, rust, cosmetic wear or cosmetic/external damage to products/components/fuses and lamps are specifically excluded from these warranties. It is an express condition of these warranties that the purchaser takes due care and attention in the use and maintenance of the appliance. Abuse, misuse in conflict with operating instructions, connection to incorrect voltages and subjection to commercial use shall release the Company from its obligations.
3. This warranty shall become void and cease to operate if the appliance is dismantled by, or any repairs to the appliance are effected by any persons not duly authorised by the Company, or if substitute parts not approved by the Company are used in the appliance, or if the serial number of the appliance is removed.
4. The Company shall not be responsible for damages resulting from fire, flood, civil disturbances or any Act of God. The Company shall not, in terms of these warranties be responsible nor held liable for any consequential loss or damage of any kind caused by or due to the failure or malfunction of the appliance. The Company shall not be responsible for damages caused by insect and/or animal infestation.
5. The Company shall not be responsible for transportation or other costs other than those incurred within the provisions of Point 1 of this Certificate.
6. **For warranties in the Republic of South Africa and Sub-Saharan Africa, please contact the customer care line. Please refer to the previous page for South African and Sub-Saharan African contact details.**
7. Where service is requested under warranty and no fault or defect can be found by the Company, all costs incurred will be for the purchaser's account.
8. This Certificate as well as your invoice will serve as proof of purchase. For the purpose of warranty, it will be essential to produce this Certificate and invoice. Failure to do so, will render the purchaser liable for service costs.

**KEEP THIS CERTIFICATE AND SALES INVOICE AS PROOF OF
PURCHASE FOR WARRANTY PURPOSES.**

Specifications

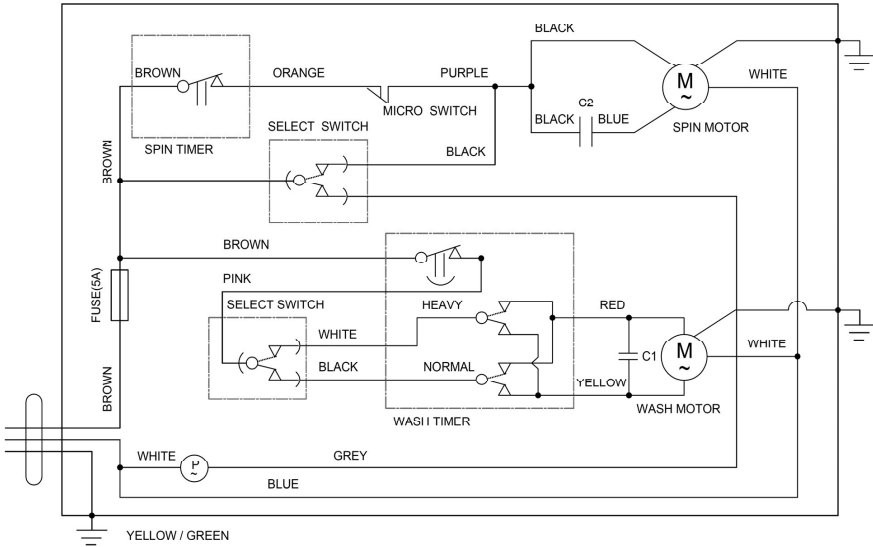

NOTE

C1: 13 μ F AC450V 50 Hz C2: 5 μ F AC450V 50 Hz

POWER SOURCE	AC 230 V
FREQUENCY	50Hz
MAXIMUM MASS OF DRY CLOTH	8 Kg
POWER CONSUMPTION	
WASH MOTOR	280 W
SPIN MOTOR	140 W
PUMP	30 W
EXTERNAL DIMENSIONS	
HEIGHT	1020 mm
WIDTH	830 mm
DEPTH	490 mm
NETT WEIGHT	22 Kg
WATER CAPACITY	
HIGH	60 LITRES
MEDIUM	50 LITRES
LOW	45 LITRES
MAINS CABLE	TYPE Y