



User's Manual

2023/03 (v1.0)

Body Camera DrivePro Body 70



Table of Contents

- **1. Package Contents**
- **2. Getting Started**
 - **2-1 Function Buttons**
 - **2-2 Mounting the DrivePro Body**
 - **2-3 Function Button Description**
 - **2-4 LED Indicators**
 - **2-5 Charging the DrivePro Body**
- **3. Recording Videos**
 - **3-1 Buffering Mode**
 - **3-2 Recording Mode**
- **4. Taking Photos**
- **5. Audio Recording**
- **6. Advanced Feature**
 - **6-1 Bluetooth Team Sync**
- **7. Using the DrivePro Body App**
 - **7-1 Downloading and Installing the DrivePro Body App**
 - **7-2 Connecting to the DrivePro Body App**
 - **7-3 DrivePro Body App Homepage**
 - **7-4 Playing Videos and Browsing Photos**
 - **7-5 Settings**
- **8. Using the DrivePro Body Toolbox Software**
 - **8-1 System Requirements**
 - **8-2 Status**
 - **8-3 Settings**
 - **8-4 Tools**
 - **8-5 File Manager**
 - **8-6 Preference**
- **9. Transferring Files to a Computer**
- **10. Docking Station (Optional)**
- **11. Cautions**
- **12. IP68 Protection**
- **13. Specifications**
- **14. Frequently Asked Questions**
- **15. EU Compliance Statement**
- **16. Recycling and Environmental Protection**

- **17. Warranty Policy**
- **18. GNU General Public License (GPL) Disclosure**
- **19. End-User License Agreement (EULA)**
- **20. Federal Communications Commission (FCC) Statement**
- **21. Eurasian Conformity Mark (EAC)**

1. Package Contents

DrivePro Body 70



Belt holster



Adapter



3.5mm to USB cable



Clip mount



Velcro holder

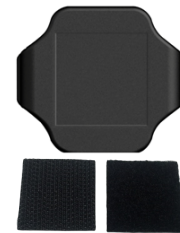

Quick Start Guide

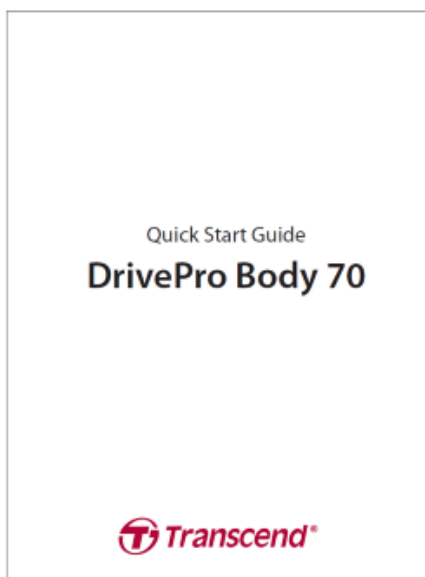

2. Getting Started

2-1 Function Buttons

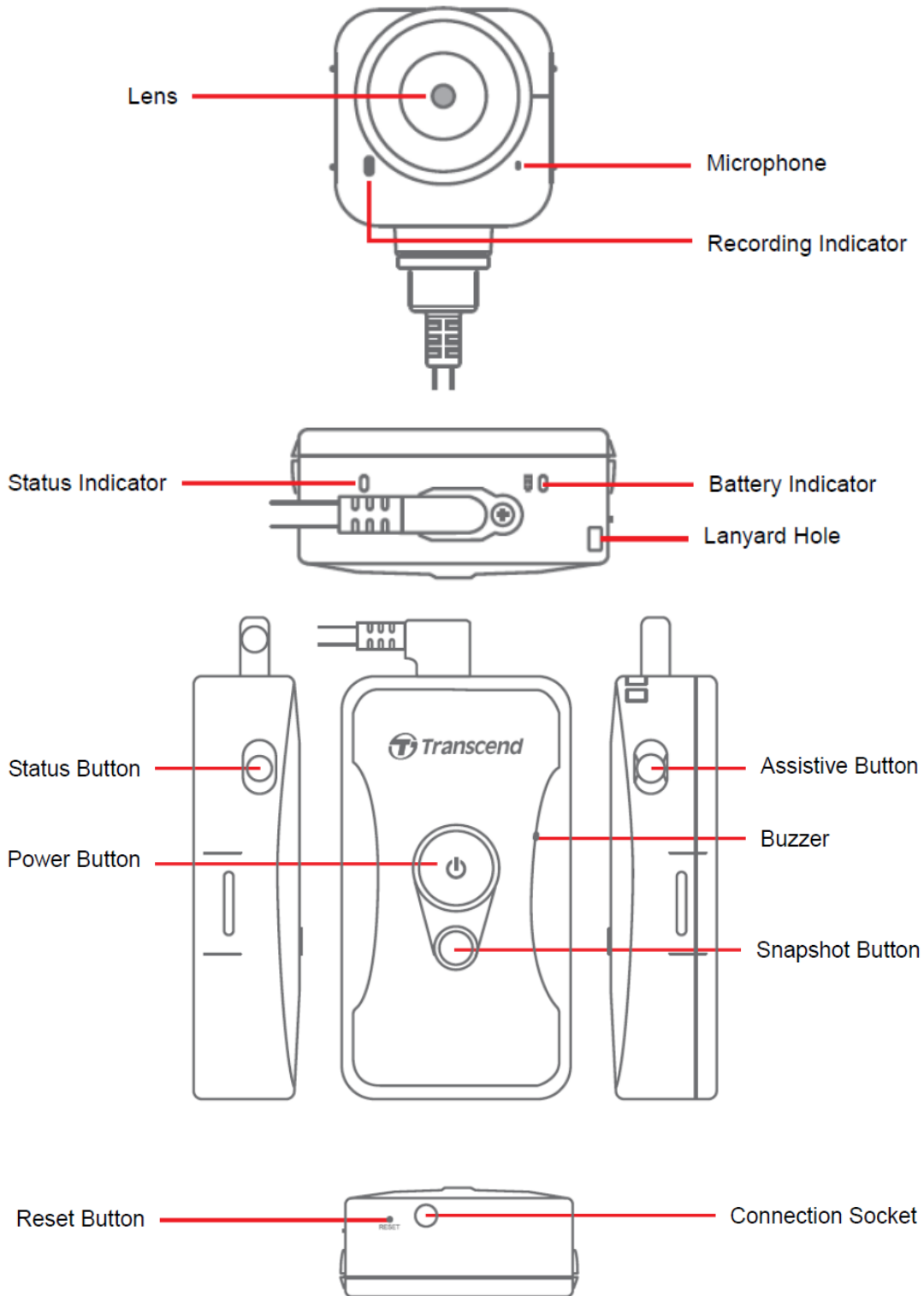

2-2 Mounting the DrivePro Body

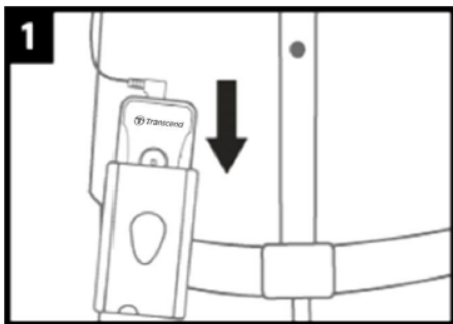

1. Attach the main unit to your duty belt.

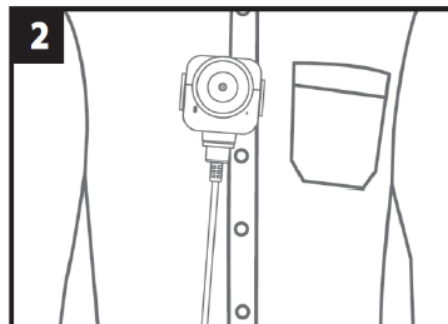

2. Put the camera on.

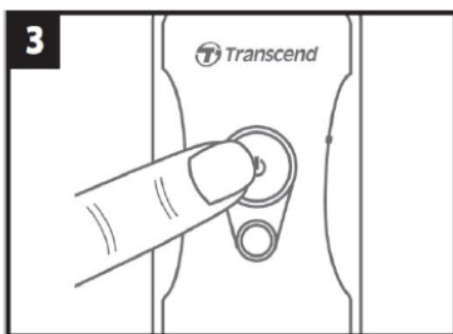

3. To power it on,
long press the  button.

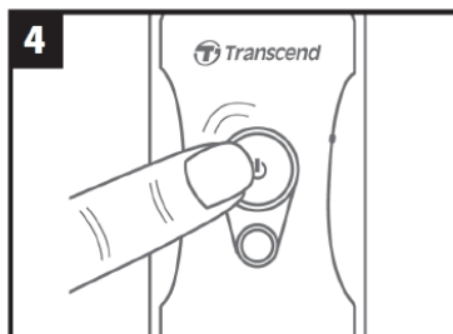



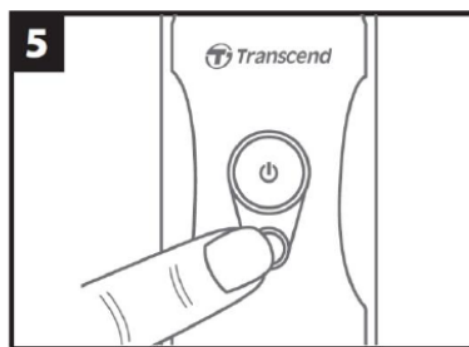

4. To switch between
Buffering and Recording modes,
double-press the  button.

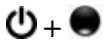

5. To take a snapshot,
short press the  button.

2-3 Function Button Description

Button	Instruction	Description
Power Button 	Long press once	Power on/off
	Short press twice	Switch between Buffering mode and Recording mode. Default: Buffering mode
Snapshot Button 	Long press once	Audio recording
	Short press once	Take a snapshot.
	Press for 5+ seconds	Reset, format and power off the device. This function is disabled by default and can be enabled using the DrivePro Body Toolbox. Warning: All data will be permanently erased.
Status Button 	Press for 5 seconds	Pair and connect to Bluetooth.
	Short press once	Check the battery and recording status.
Assistive Button 	Long press once	Turn on/off the light indicators and the buzzer (Stealth Mode)
	Short press twice	Turn on/off the microphone (Silent Mode)

2-4 LED Indicators

Top View 1

Battery Indicator



Recording

LED	Status	LED Definition
●	Flashing	Low battery

Connected to a computer / power source

LED	Status	LED Definition
●	Solid	Charging

Checking the battery status

LED	Status	LED Definition
●	Solid	> 67% remaining
●	Solid	31% to 67% remaining
●	Solid	< 31% remaining

Top View 2

Status Indicator



Recording

LED	Status	LED Definition
●	Flashing	Memory almost full
●	Flashing quickly	Bluetooth pairing
	Flashing	GPS positioning
	Solid	Checking status in Buffering mode
●	Flashing steadily	Checking status in Recording mode
	Flashing twice	Checking status in Audio recording mode
	Solid	Silent mode (Microphone off)

Connected to a computer

LED	Status	LED Definition
●	Flashing	Transferring data

Front View



LED	Status	LED Definition
●	Solid	Buffering mode
●	Flashing quickly	Powering on
	Flashing steadily	Recording mode
	Flashing twice	Audio recording mode
	Solid	Browser / Connected to a computer

2-5 Charging the DrivePro Body

Before use, please ensure that the battery is fully charged. Charge the DrivePro Body via the adapter or by connecting the USB cable to the computer. A solid orange light of the battery indicator is visible while charging and will turn off when fully charged.

To charge the DrivePro Body, you can either:

- Connect the 3.5 mm to USB cable to the body camera and a wall outlet with the included adapter.
- Connect the 3.5 mm to USB cable to the body camera and a computer.
- Connect the DrivePro Body to Transcend's Docking Station (Optional).



"WARNING"

Do not use non-original 3.5 mm to USB cable to charge.

3. Recording Videos

3-1 Buffering Mode

Recording in Buffering mode can significantly save storage space as the files are not recorded to the internal storage.

To power on and start Buffering mode (by default), long press the  button; you will hear a beep. The recording indicator will flash red when powering on and then turn solid blue in Buffering mode.

To stop recording and power off, long press the  button; you will hear a beep. The LED light and the device will turn off.

To switch between Buffering mode and Recording mode, double-press the  button. You will hear two beeps.





"Note"

Buffered video length is adjustable via the DrivePro Body Toolbox.

3-2 Recording Mode

When an incident occurs, switch to Recording mode. The recorded file and up to 2 minutes of footage before the incident will then be stored in internal memory.

To start Recording mode, double-press the  button while DrivePro Body 70 is in Buffering mode. You will hear two beeps, and the recording indicator will flash red. To stop recording, long press the  button again. After hearing a beep, the LED light and the device will turn off.

Video files recorded in Recording mode will be saved in the folder named “VIDEO” and overwritten with loop recording enabled.

DrivePro Body 70 saves video files every 3 minutes automatically. (The default recording length is 3 minutes).



"Note"

Loop recording is disabled by default and can be enabled using the DrivePro Body Toolbox.

4. Taking Photos

Short press the  button to take photos while recording. When you hear a beep, it means the snapshot has been taken. Pictures will be saved in the folder named “PHOTO.”



5. Audio Recording

To start Audio recording mode, long press the  button. Audio Recording files will be saved in the folder named "AUDIO."

6. Advanced Feature

6-1 Bluetooth Team Sync

"Bluetooth Team Sync" is a function based on Bluetooth technology. Within an acceptable range of Bluetooth, as long as a body camera enters Recording mode from Buffering mode, other body cameras of the same team will also enter Recording mode.



"Note"

1. Bluetooth Team Sync is disabled by default and can be enabled using the DrivePro Body Toolbox.
2. This feature is available on DrivePro Body 30/60/70.

7. Using the DrivePro Body App

Developed for iOS and Android devices, the DrivePro Body App lets you watch live-view videos and adjust the camera settings wirelessly on your smart devices.



DrivePro Body App



7-1 Downloading and Installing the DrivePro Body App

1. Search for DrivePro Body App on the App Store or Google Play.
2. Download and install the [DrivePro Body App](#).

Once the installation is complete, the App will be displayed on your device's home screen.

7-2 Connecting to the DrivePro Body App

1. Tap “DrivePro Body” App and turn on Bluetooth to pair. Select “DrivePro Body 70” on the App.

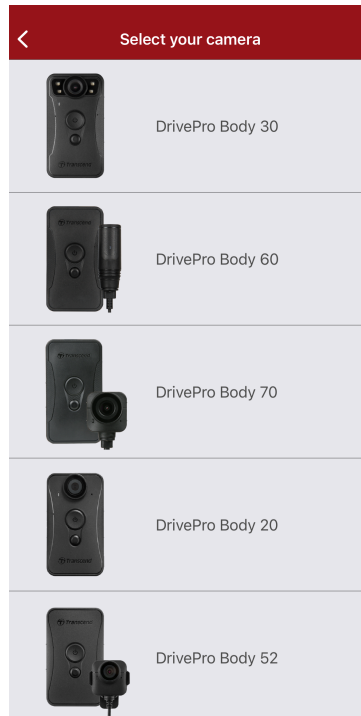

2. Power on the DrivePro Body by long pressing the  button. Tap “Next” to continue.

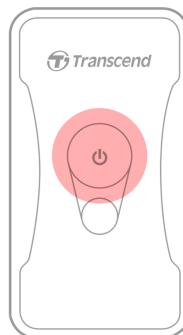

Power on the device



3. Long press the Status button until you hear a beep. Tap “Connect” on the App to connect to Bluetooth. After hearing three beeps, you can take snapshots, switch recording modes, or adjust settings via the App.

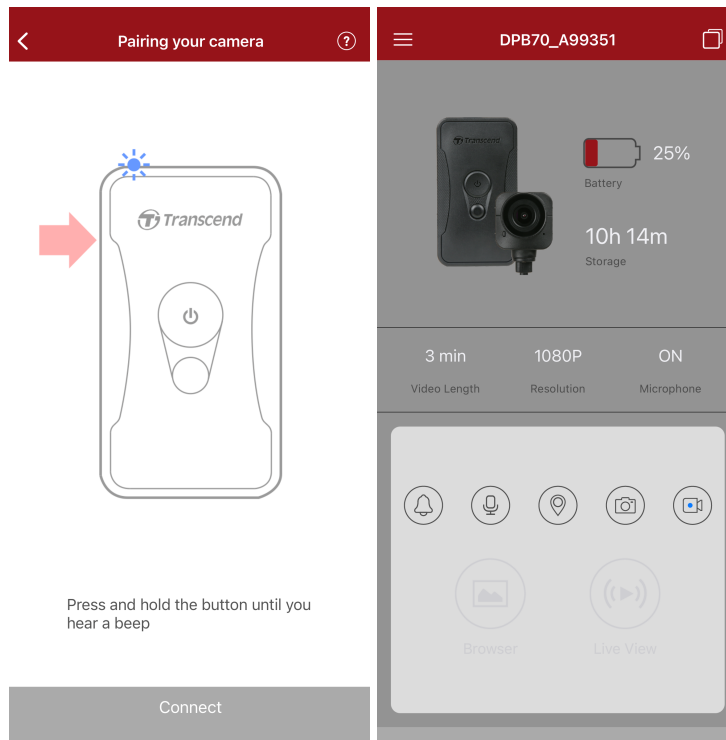

4. Tap “Browser” or “Live View” to connect to Wi-Fi named “DPB70_XXXXXX” with the default password “12345678”.

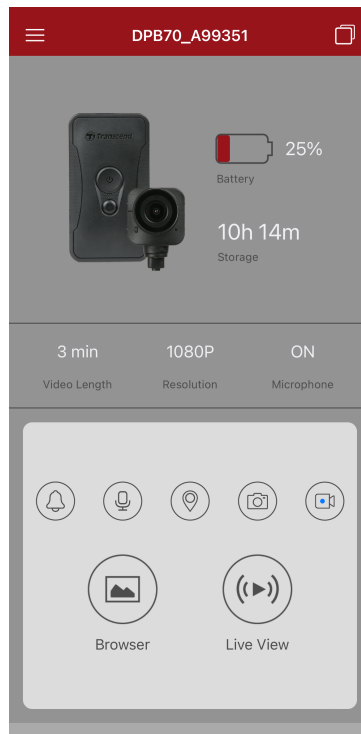

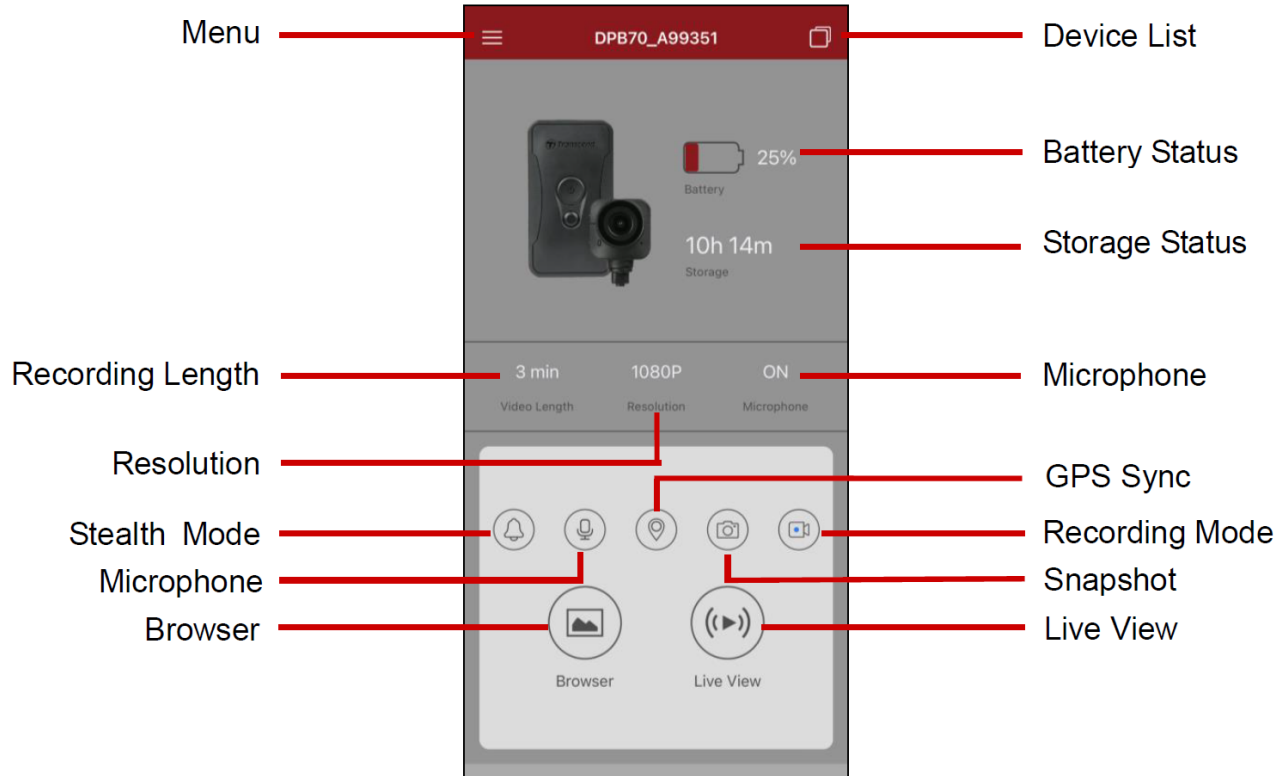

7-3 DrivePro Body App Homepage



"Note"

The camera stops recording when you tap "Browser" or "Settings" on the DrivePro Body App, and the front LED turns solid red.

7-4 Playing Videos and Browsing Photos

1. To play videos and browse photos, tap “Browser” on the Homepage or  on the top left corner first, then tap  DrivePro™ Body .
2. Tap the icons on the bottom to watch videos, browse pictures, or listen to audio recordings.

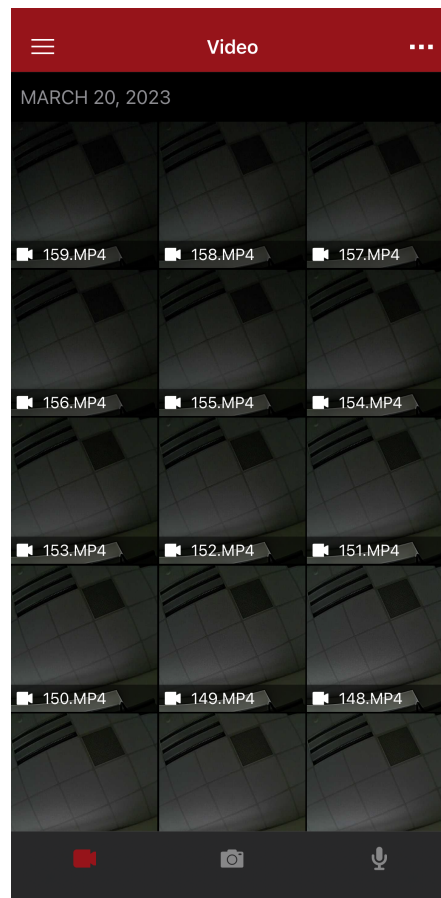







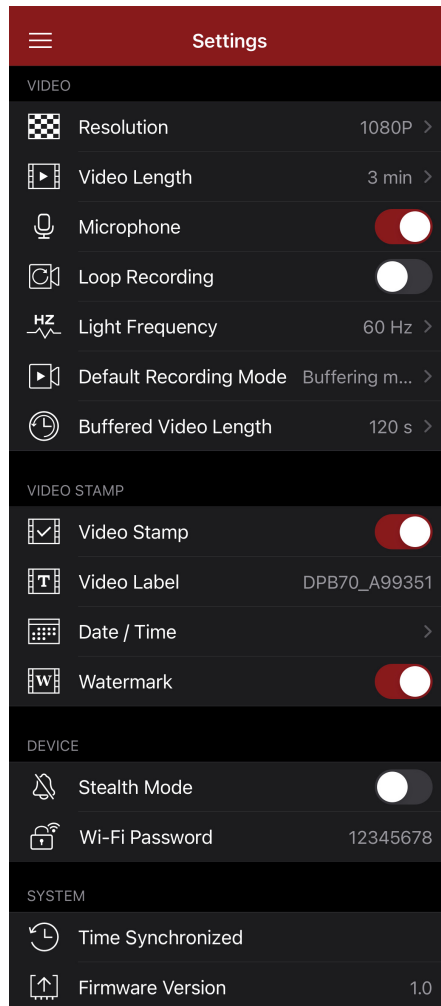

7-5 Settings







Tap  on the top left corner first, then tap  to enter the Settings menu.

In the Settings menu, you can adjust the video, device, Wi-Fi, and system settings.



Menu options

VIDEO		
Icon	Function	Description / Options
	Resolution	Set the quality for video recording.
		1440P / 1080P / 720P / 480P
	Video Length	Set the recording length of each recorded video.
		3 min / 5 min / 10 min
	Microphone	Turn off/on the microphone during video recording.
		Disable / Enable
	Loop Recording	Overwrite the old video files with new ones.
		Disable (default) / Enable
	Light Frequency	Select the appropriate frequency to avoid flashing A/C light.
		50 Hz / 60 Hz
	Default Recording Mode	Select the default recording mode.
		Buffering mode / Recording mode
	Buffered Video Length	Set the buffered video length to record footage that happens prior to switching to Recording mode.
		30 s / 60 s / 90 s / 120 s
VIDEO STAMP		
Icon	Function	Description / Options
	Video Stamp	Display the video label, date/time, watermark, and GPS coordinates, on photos or videos.
		Disable / Enable
	Video Label	Tap to edit the video label to be displayed. (The default label is DPB70_XXXXXX.)

	Date / Time	Select the date and time format.
		Date: Y/M/D / M/D/Y / D/M/Y Time: 24HR / AM/PM
	Watermark	Display the Transcend logo watermark on photos or videos.
		Disable / Enable
DEVICE		
Icon	Function	Description / Options
	Stealth Mode	Turn off/on the stealth mode. When the stealth mode is on, the light indicators, buzzer, and vibrator are disabled.
		Disable / Enable
	Wi-Fi Password	Set the Wi-Fi password of the DrivePro Body 70. Password should be between 8 to 16 characters, either letters or numbers. (The default password is 12345678)
SYSTEM		
Icon	Function	Description / Options
	Time Synchronized	Sync the DrivePro Body time with your smart device.
	Firmware Version	Tap to upgrade the firmware to the latest version.
	About	Display the App version, End-User License Agreement, and Open Source Statement.

 **"WARNING"**

1. Before proceeding with the firmware update using the DrivePro Body App, ensure the battery level is at least 50%. Alternatively, you can connect the power cord for a stable power source.
2. The DrivePro Body will shut down and the status indicator will flash red while the firmware is being upgraded. Please wait until the firmware upgrade is complete before manually restarting the DrivePro Body.

3. If the DrivePro Body cannot be turned on due to firmware upgrade failure, please contact Transcend customer service for technical support.

8. Using the DrivePro Body Toolbox Software

DrivePro Body Toolbox is a video file management software which simplifies the settings of the camera. The software features a user-friendly interface that allows users to set the basic functions of the DrivePro Body camera.

8-1 System Requirements

System requirements for connecting the DrivePro Body 70 to a computer and for using the DrivePro Body Toolbox software:

A desktop or a laptop with a working USB port:

- Windows® 10 or later
- macOS® 10.14 or later

Downloading and installing the DrivePro Body Toolbox:

1. Download the installation files:

<https://www.transcend-info.com/downloads>

2. Install DrivePro Body Toolbox software on your desktop or laptop.

8-2 Status

Please find the basic information of the DrivePro Body, including the user label, model, device serial number, and firmware version, on the Status page.

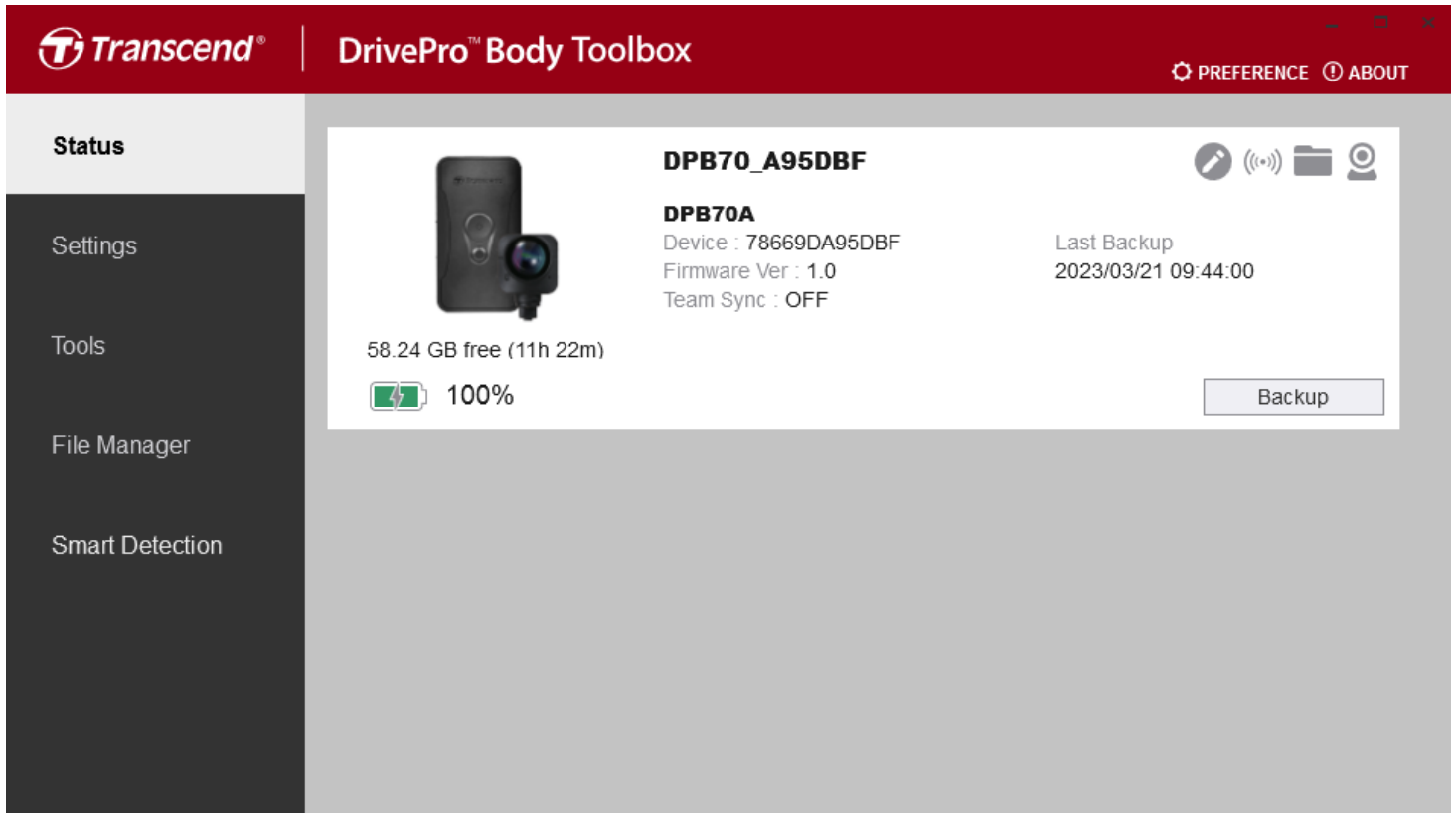

The screenshot shows the 'Status' page of the DrivePro Body Toolbox. The top bar is red with the Transcend logo and 'DrivePro™ Body Toolbox' text. On the right of the top bar are 'PREFERENCE' and 'ABOUT' links. The left sidebar is dark grey with 'Status' selected. The main content area is light grey and contains a white card with the following information: a device image, the user label 'DPB70_A95DBF', the model 'DPB70A', device ID '78669DA95DBF', firmware version '1.0', and team sync status 'OFF'. It also shows '58.24 GB free (11h 22m)' and a '100%' battery icon. A 'Backup' button is located at the bottom right of the card. Icons for edit, Bluetooth, folder, and webcam are in the top right corner of the card.

To adjust the user label and Bluetooth Team Sync function, click .

"Note"

Select "preferred team number" for Bluetooth Team Sync from 1 to 10.

- To find a device, click .
- To play videos and browse photos, click .
- To start backing up, click .
- To enter Webcam mode, click  to use the device as a camera and microphone.

8-3 Settings

On the Settings page, you can adjust the Device, Video, and Video Stamp settings.

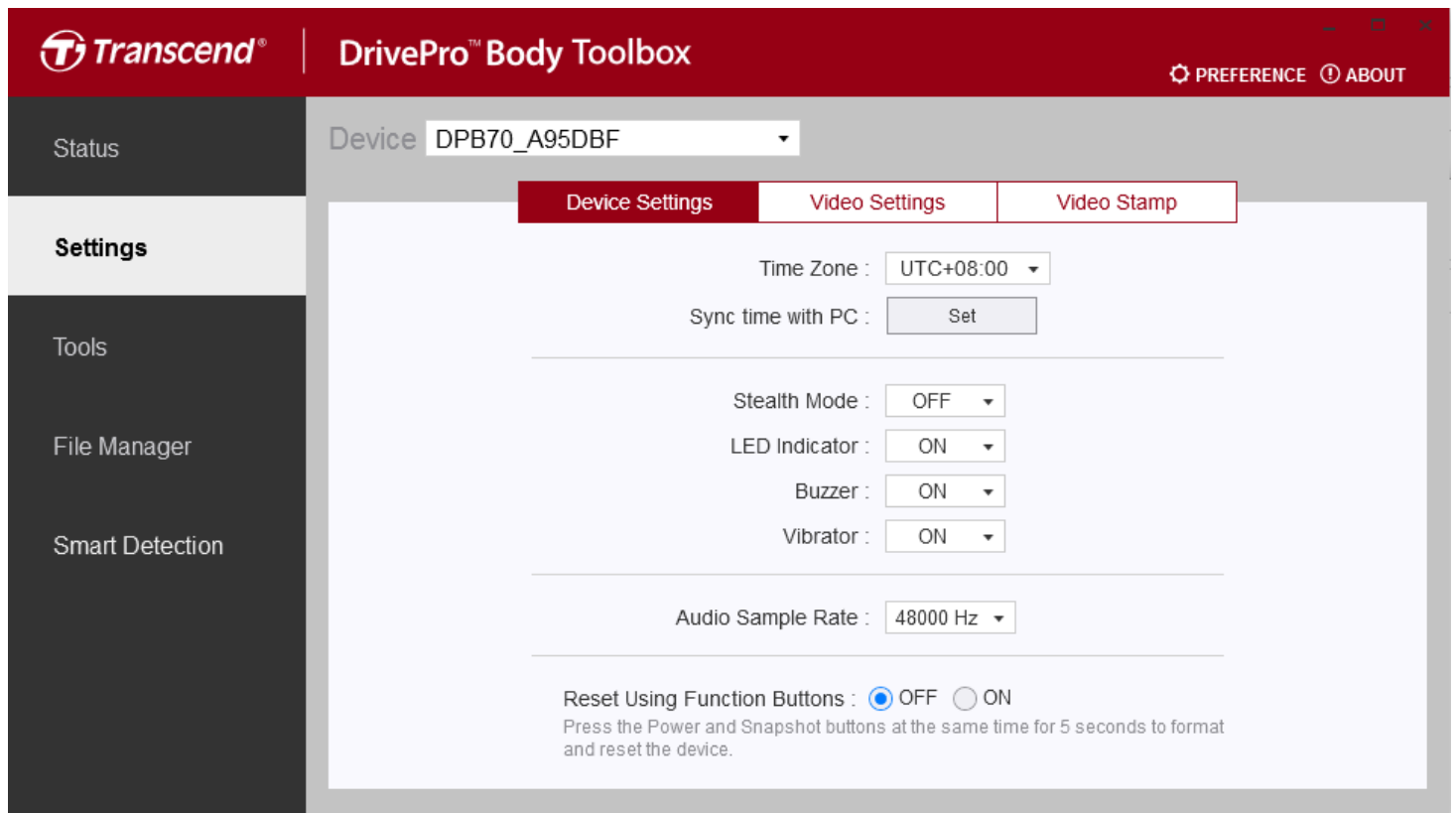

Device Settings	
Function	Description / Options
Sync time with PC	Click the “Set” button to sync the time of the device with the PC.
Stealth Mode	Turn on/off Stealth mode. When the Stealth mode is on, the light indicators and buzzer are disabled.
	ON / OFF
LED Indicator	Turn on/off LEDs when recording.
	ON / OFF
Buzzer	Turn on/off Buzzer when recording.
	ON / OFF
Vibrator	Turn on/off Vibrator when recording.

	ON / OFF
Audio Sample Rate	Set the audio sampling frequency. The higher the frequency, the better the sound quality.
	48000 Hz / 44100 Hz / 32000 Hz / 24000 Hz / 22050 Hz
Reset Using Function Buttons	When the power is on, press the Power and Snapshot buttons simultaneously for 5 seconds to format and reset the device. After that, the camera will turn off. (Default: OFF).

Status

Settings

 Tools

 File Manager

 Smart Detection

Device DPB70_A95DBF

Device Settings
Video Settings
Video Stamp

Resolution : 1080P / 30FPS

Video Format : MP4

Loop Recording : OFF

Video Length : 3 mins

Light Frequency : 60 Hz

Microphone : ON

Default Recording Mode : Buffering mode

Buffered Video Length : 120 Seconds

Buffering Recording Audio : ON

Video Settings

Function	Description / Options
Resolution	Set the quality for video recording.
	1440P/30FPS / 1080P/30FPS / 720P/30FPS / 480P/30FPS
Video Format	Set the recording file format.
	MOV / MP4
Loop Recording	Overwrite the old video files with new ones.
	ON / OFF
Video Length	Set the recording length of each recorded video.
	3 mins / 5 mins / 10 mins
Light Frequency	Select the appropriate frequency to avoid flashing A/C light.
	50 Hz / 60 Hz
Microphone	Turn on/off the microphone during video recording.
	ON / OFF

Default Recording Mode	Select the default recording mode.
	Buffering mode / Recording mode
Buffered Video Length	Set the buffered video length to record footage that happens prior to activating the Recording mode.
	30 seconds / 60 seconds / 90 seconds / 120 seconds
Buffering Recording Audio	Turn on/off the microphone in Buffering mode.
	ON / OFF

Status

Settings

Tools

File Manager

Smart Detection

Device DPB70_A95DBF

Device Settings
Video Settings
Video Stamp

Video Stamp : ON

Date Format : Y/M/D

Time Format : 24HR

Watermark : ON

Video Stamp

Function	Description / Options
Video Stamp	Display the video recording time and the video label.
	ON / OFF
Date Format	Set the date format.
	Y/M/D / M/D/Y / D/M/Y
Time Format	Select the time format. 24 or 12-hour clock.
	24HR / AM/PM
Watermark	Display the Transcend logo watermark on photos or videos.
	ON / OFF

8-4 Tools

On the Tools page, you can upgrade firmware to the latest version, format disk or reset DrivePro Body to its default status.

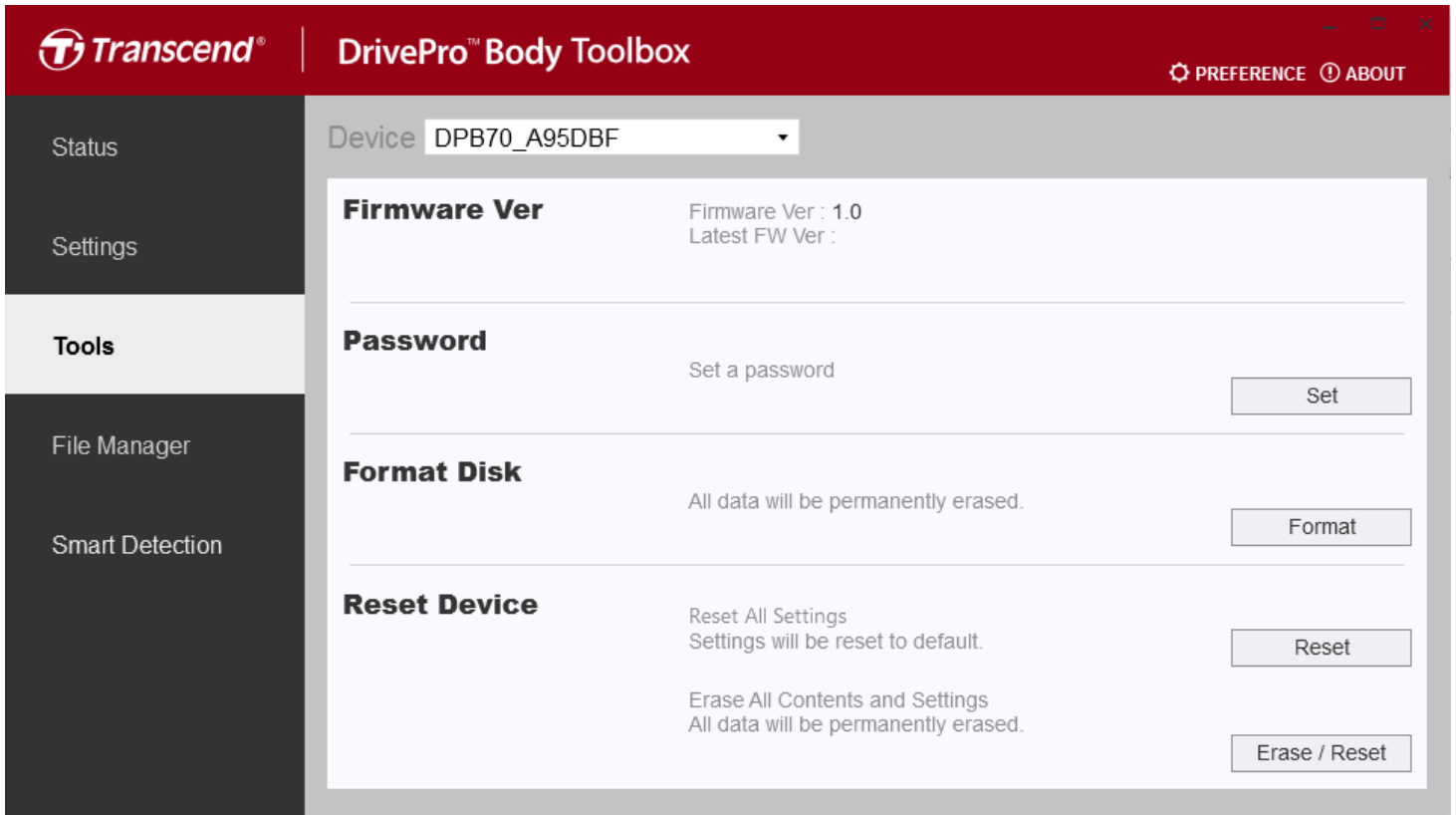

Tools	
Function	Description / Options
Firmware Ver	Upgrade your firmware to the latest version available.
Password	Set a password to protect the drive of the body camera. Password should be between 8 to 16 characters, either letters or numbers.
Format Disk	Format your disk.
Reset Device	Reset all settings to default or erase all contents and settings.



"WARNING"

1. For best recording stability, you are suggested to back up your data with the DrivePro Body Toolbox each time you finish using the device or format it using the Toolbox every three months.
2. Please use DrivePro Body Toolbox only to format your DrivePro Body.
3. Formatting the disk permanently erases all data.

8-5 File Manager

Once the data is backed up, you can search and manage your videos and photos on the File Manager page.

Title	Type	Date	Camera	Owner	Category
2014_0108_092752_341	MP4	2014/01/08 09:27:57	78669DA97CA9		
2023_0209_222333_340	MP4	2023/02/14 16:41:22	78669DA97CA9		
2023_0209_222033_339	MP4	2023/02/14 16:40:28	78669DA97CA9		
2023_0209_221733_338	MP4	2023/02/14 16:39:32	78669DA97CA9		
2023_0209_221435_337	MP4	2023/02/14 16:38:20	78669DA97CA9		

- Click to play videos on the screen.
- Click to enlarge videos to full screen. With a GPS receiver, the paths can be displayed along with the recorded video.



- Click  on the right side of the page to add, delete, or edit the Owner and Category.

Settings

Owner	Category
Bryson	Auto Theft
Joyce	Murder
Winnie	Armed Robbery
Anton	Residential Burglary
	Carjacking

OK

- Click  to classify the Owner and Category of the selected file.

Edit

2023_0303_091826_002

Category :

Owner :

Description :

8-6 Preference

Click  **PREFERENCE** on top of the page to adjust the settings of the DrivePro Body Toolbox.
Check the available options below according to your preference.

Preference

Run on Windows startup

Run minimized

Language:

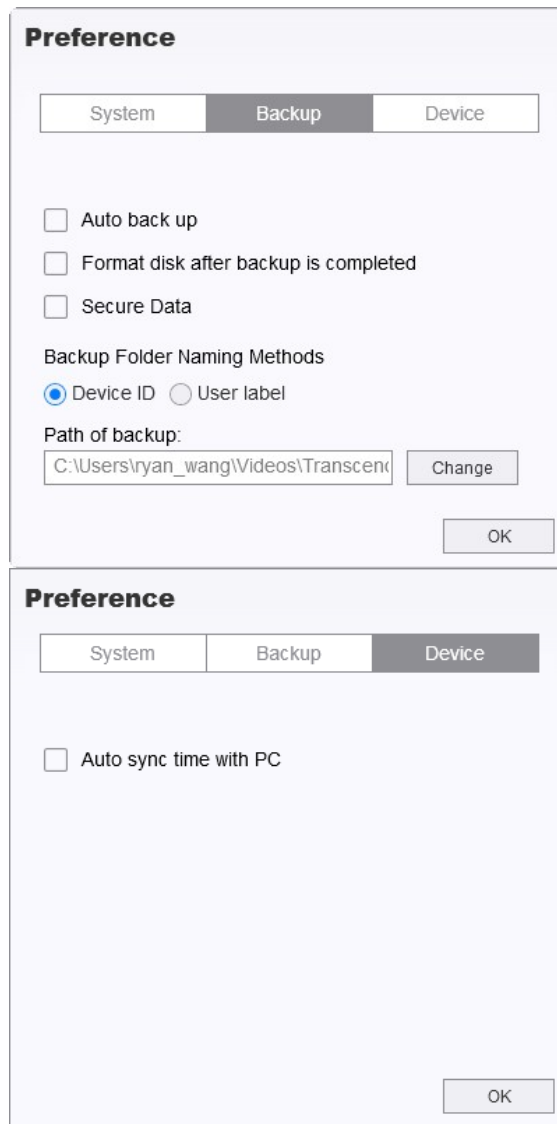

Please refer to the User's Manual of DrivePro Body Toolbox via the link below.
<https://www.transcend-info.com/Manual/DriveProBody/Toolbox/EN/>

9. Transferring Files to a Computer

To transfer files between the DrivePro Body and the computer:

1. Plug the 3.5 mm to USB cable into the connection socket of the DrivePro Body.
2. Connect the other end of the cable to the desktop or laptop.



Your DrivePro Body is now ready to transfer data like an external hard drive. To transfer files to the computer, copy them from the folder of the body camera.

⚠ "WARNING"

- 1. To prevent data loss, always follow the proper removal procedures when disconnecting the DrivePro Body from your computer.**
- 2. You can only transfer files when connecting the DrivePro Body to a computer. The DrivePro Body does not function as a body camera at this time. Please disconnect your camera from the computer to resume its functions.**

10. Docking Station (Optional)

Transcend's DPD6N networked docking station is designed specifically for the DrivePro Body 30/60/70 and offers a complete charging, data upload, and camera management solution via the network. Users can charge multiple DrivePro Body 30/60/70 devices simultaneously and share files (including video recordings and snapshots) to an external storage device via a USB port.



Please refer to the DPD6N User's Manual through the link below.

<https://www.transcend-info.com/support/product/body-camera/docking-station-ts-dpd6n>

11. Cautions

1. Do not use or store the DrivePro Body in the following places to prevent malfunction or deformation:

- In extremely hot, cold, or humid places, such as in a car parked in the sun
- Under direct sunlight or near a heater
- Near strong magnetic fields
- In sandy or dusty places

2. Please clean and protect the lens of the DrivePro Body frequently and carefully.

- Wipe the lens with a soft cloth in the following cases:
 - When there are fingerprints on the lens
 - When the lens is exposed to salty air, such as at the seaside
- Store in a ventilated place with little sand and dust.
- To prevent mold, periodically clean the lens.

3. Cleaning

- Clean the surface of the DrivePro Body with a soft cloth slightly moistened with water, and wipe the surface with a dry cloth.
- Do not clean the camera with chemical products (e.g., thinner, benzine, alcohol, insect repellent, sunscreen or insecticide, etc.) and disposable cloths, as they may damage the finish or the casing.
- Do not touch the camera with any of the abovementioned chemicals on your hand.
- Do not leave the camera in contact with rubber or vinyl for long.

4. Moisture condensation

- If the DrivePro Body is brought directly from a warm to a cold place (or on the contrary), moisture may condense inside or outside the camera to cause malfunction of the DrivePro Body.
- If moisture condensation occurs, turn off the DrivePro Body immediately and wait about 1 hour for the moisture to evaporate.

5. GPS receiver

- The performance and accuracy of the GPS system may vary with the environment.
- GPS signals cannot penetrate buildings and metallic tinted films. GPS data accuracy depends on the surroundings, including the weather and the location the DrivePro Body is used (e.g., high buildings, tunnels, bridges, and forests). For first-time use, please place the device in an outdoor open area for GPS positioning.

12. IP68 Protection

The camera body of the DrivePro Body 70 is rated at IP68, offering splash, water, and dust resistance. However, splash, water, and dust resistance are not permanent conditions, which might decrease due to normal wear. The warranty does not cover liquid damage.

The limited warranty does not cover malfunctions or damage caused by improper use.

- Do not use the DrivePro Body 70 in water.
- Do not use the DrivePro Body 70 in high temperatures and humidity, such as saunas, steams, and shower rooms.
- Do not use the DrivePro Body 70 for long in heavy rains to prevent moisture from penetrating. Ensure the power cable, adapter, and connection socket are completely dry before charging.



"WARNING"

DrivePro Body 70 is not water resistant in the following situations:

- **when connected to a USB cable**
- **when any of the screws is removed from the device**

13. Specifications

Dimensions	Main unit: 95.9 mm (L) × 52.2 mm (W) × 24.9 mm (H) 3.78" (L) × 2.06" (W) × 0.98" (H) Camera unit: 48.6 mm (L) × 40 mm (W) × 31.7 mm (H) 1.91" (L) × 1.57" (W) × 1.25" (H)
Weight	184 g (6.5 oz)
Connect Interface	USB 2.0
Storage	Internal 64 GB storage
Lens	F/2.0, 140° wide angle
Resolution / Frame Rate	QHD 1440P / 30 FPS
Video Format	MP4 (H.264)
Battery	Li-Polymer 3120 mAh
Battery Life (max.)	Up to 9 hours*
Power Supply	Input (max.): AC 100 V to 240 V, 50 Hz to 60 Hz, 0.4 A Output: DC 5 V / 2 A
Operating Temperature	-20°C (-4°F) to 60°C (140°F) 5°C (41°F) to 45°C (113°F) when charging with the adapter
Ingress Protection	IP68
Certification	BSMI, CE, EAC, FCC, KC, MIC, NCC, UKCA
Shock Resistance	MIL-STD-810G 516.6 – Transit Drop Test
Warranty	2-Year Limited

*The actual video recording length may vary with environmental conditions.

14. Frequently Asked Questions

If you have issues using DrivePro Body, please refer to the following information to troubleshoot problems. If you cannot find any ideal solution to your questions, please consult the store where you purchased the product or the service center, or contact the local Transcend branch office.

You can also visit Transcend's website for more FAQs and Technical Support services.

<https://www.transcend-info.com/>

https://www.transcend-info.com/Support/contact_form

1. My computer operating system cannot detect my DrivePro Body.

Please check the followings:

(1) Is your DrivePro Body properly connected to the USB port? If not, unplug it and reconnect it. Ensure both USB cable ends are correctly connected, as shown in the User's Manual.

(2) Is the computer's USB ports enabled? If not, refer to the User's Manual of your computer (or motherboard) to enable them.

2. None of the DrivePro Body buttons are responding.

Please press the Reset button on the bottom of the DrivePro Body using a thin object with a flat tip, such as a straightened paper clip, to turn it off and on again.

3. Is the DrivePro Body 70 waterproof and shockproof?

The DrivePro Body 70 is IP68 dust and water protected and meets rigorous U.S. military drop-test standards*.

*Based on MIL-STD-810G 516.6 – Transit Drop Test

15. EU Compliance Statement

Transcend Information hereby declares that all CE marked Transcend products incorporating radio equipment functionality are in compliance with Directive 2014/53/EU.

The full text of the EU declaration of conformity is available at the following internet address:
https://www.transcend-info.com/eu_compliance



DrivePro Body 70	
Frequency: 2400 MHz to 2483.5 MHz	Maximum transmit power: < 100 mW

16. Recycling and Environmental Protection

For more information on recycling the product (WEEE) and battery disposal, please refer to the following link:

<https://www.transcend-info.com/about/green>

17. Warranty Policy

Please find the warranty period of this product on its package. For details of Warranty Terms and Conditions and Warranty Periods, please refer to the link below:

<https://www.transcend-info.com/warranty>

18. GNU General Public License (GPL) Disclosure

For more information on open-source licensing, please refer to the link below:

<https://www.transcend-info.com/Legal/?no=10>

19. End-User License Agreement (EULA)

For details of software license terms, please refer to the following link:

<https://www.transcend-info.com/legal/gpl-disclosure-eula>

20. Federal Communications Commission (FCC) Statement

This device complies with Part 15 FCC Rules. Operation is subject to the following two conditions: (1) This device may not cause harmful interference. (2) This device must accept any interference received including interference that may cause undesired operation.

This Equipment has been tested and found to comply with the limits for a Class B digital device, pursuant to Part 15 of the FCC rules. These limits are designed to provide reasonable protection against harmful interference in a residential installation. This equipment generates, uses and can radiate radio frequency energy and, if not installed and used in accordance with the instructions, may cause harmful interference to radio communications. However, there is no guarantee that interference will not occur in a particular installation. If this equipment does cause harmful interference to radio or television reception, which can be determined by turning the equipment off and on, the user is encouraged to try to correct the interference by one or more of the following measures:

- Reorient or relocate the receiving antenna.
- Increase the separation between the equipment and receiver.
- Connect the equipment into an outlet on a circuit different from that to which the receiver is connected.
- Consult the dealer or an experienced radio/TV technician for help.

RF Exposure Information (SAR)

This equipment complies with the FCC portable RF exposure limit set forth for an uncontrolled environment. The exposure standard for wireless devices employing a unit of measurement is known as the Specific Absorption Rate, or SAR. The SAR limit set by the FCC is 1.6W/kg.

This equipment could be installed and operated with minimum distance 0cm between the radiator & your body.

- Any changes or modifications not expressly approved by the party responsible for compliance could void the authority to operate equipment.
- This device and its antenna must not be co-located or operating in conjunction with any other antenna or transmitter.

Transcend Information Inc (USA)

1645 North Brian Street, Orange, CA 92867, U.S.A

TEL: +1-714-921-2000

21. Eurasian Conformity Mark (EAC)

