

Jabra GN

USER MANUAL



EVOLVE2 65 FLEX

Technology for life's new rhythm

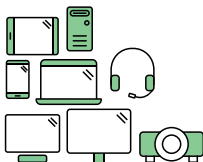

Say hello to a more sustainable product

IT products are associated with a wide range of sustainability risks throughout their life cycle. Human rights violations are common in the factories. Harmful substances are used both in products and their manufacture. Products can often have a short lifespan because of poor ergonomics, low quality and when they are not able to be repaired or upgraded.

This product is a better choice. It meets all the criteria in TCO Certified, the world's most comprehensive sustainability certification for IT products. Thank you for making a responsible product choice, that help drive progress towards a more sustainable future!

Criteria in TCO Certified have a life-cycle perspective and balance environmental and social responsibility. Conformity is verified by independent and approved verifiers that specialize in IT products, social responsibility or other sustainability issues. Verification is done both before and after the certificate is issued, covering the entire validity period. The process also includes ensuring that corrective actions are implemented in all cases of factory non-conformities. And last but not least, to make sure that the certification and independent verification is accurate, both TCO Certified and the verifiers are reviewed regularly.

Want to know more?

Read information about TCO Certified, full criteria documents, news and updates at [tcocertified.com](https://www.tcocertified.com). On the website you'll also find our Product Finder, which presents a complete, searchable listing of certified products.

© 2023 GN Audio A/S. All rights reserved. Jabra® is a trademark of GN Audio A/S. The Bluetooth® word mark and logos are registered trademarks owned by the Bluetooth SIG, Inc. and any use of such marks by GN Audio A/S is under license.

Made in China
MODEL: HSC190W



Declaration of Conformity can be found on
www.jabra.com/doc

1. Welcome.....	6
2. Jabra Evolve2 65 Flex overview	7
2.1 Included accessories	
2.2 Optional accessories	
3. How to wear.....	10
3.1 Adjusting the headset	
3.2 Positioning the microphone boom arm	
4. How to charge.....	12
4.1 Charge using the wireless charging pad (optional accessory)	
4.2 Charge using USB charging cable	
4.3 Power saving modes	
5. What the LEDs mean	17
6. How to connect.....	19
6.1 Connect to computer	
6.2 Pair with a smartphone	
7. How to use	21
7.1 Power the headset on/off	
7.2 Calls & music	
7.3 On-head detection	
7.4 Voice Assistant	
7.5 Busylights	
7.6 Active Noise Cancellation (ANC)	

7.7	HearThrough™	
7.8	Mute/unmute using the microphone boom arm	
7.9	Answer call using the microphone boom arm	
7.10	Multiuse	
7.11	Multiple call handling	
7.12	Audio notifications	
7.13	How to reset	
8.	Software and firmware	38
8.1	Jabra Sound+	
8.2	Jabra Direct	
8.3	Update firmware	
9.	Support	40
9.1	FAQ	
9.2	How to care for your headset	

1. Welcome

Thank you for using the Jabra Evolve2 65 Flex. We hope you will enjoy it!

Jabra Evolve2 65 Flex features

- Unique fold-and-go design
- Jabra ClearVoice microphone technology
- Hybrid Active Noise Cancellation (ANC)
- Jabra Air Comfort technology
- Certified for leading virtual meeting platforms
- Easy to customize, manage and deploy*
- Hideaway boom arm
- Wireless range of up to 30m/100ft

* via free to download Jabra Direct management software (desktop) or Sound+ app (smartphone)

2. Jabra Evolve2 65 Flex overview

Left

Right

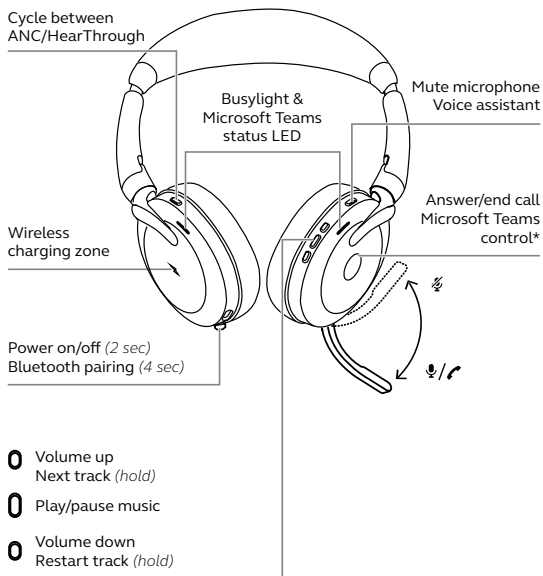

*requires Microsoft Teams headset variant

2.1 Included accessories

USB-A version



Jabra Link 380 USB-A
Bluetooth adapter

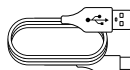

USB-A to USB-C
cable

USB-C version



Jabra Link 380 USB-C
Bluetooth adapter

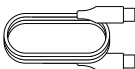

USB-C to USB-C
cable



Carry pouch

2.2 Optional accessories

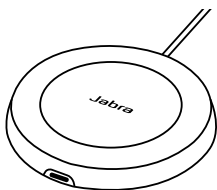

Wireless charging pad



Replacement ear cushions

3. How to wear

3.1 Adjusting the headset

Adjust the headband so that the headset fits your head comfortably.



3.2 Positioning the microphone boom arm

Pull the microphone boom arm down or up in one smooth motion.

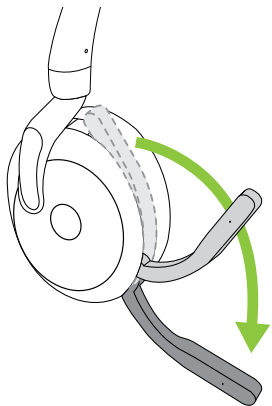

When using the microphone, the tip of the boom arm should be positioned close to your mouth.

4. How to charge

The headset can be charged using the wireless charging pad, or via a USB charging cable plugged directly into the headset.

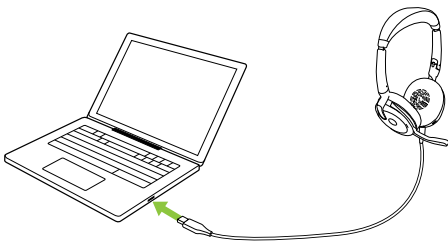

It takes approx. 2 hours to fully charge the battery. The headset battery life is up to 32 hours. If the headset is out of battery, it can be charged for 15 minutes to get 6 hours of battery life.

4.1 Charge using the wireless charging pad (optional accessory)

Connect the wireless charging pad to a powered USB port on your computer using the supplied USB charging cable, and then place the left earcup on the wireless charging pad.

The wireless charging pad is for charging only.

Powered USB port

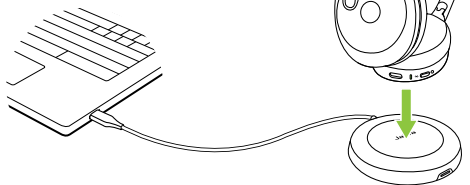
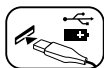

The LED on the wireless charging pad will light up to indicate the left earcup has been correctly placed on the wireless charging pad and headset the battery is charging.

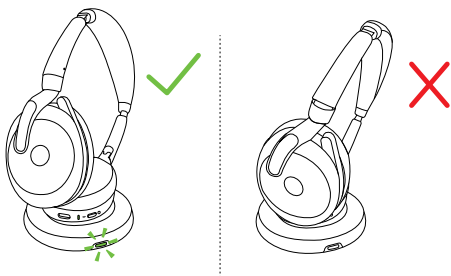

The status LED on the headset will then briefly flash green, yellow or red to indicate the current battery charging status. When the status LED turns solid green, the headset is fully charged.

4.2 Charge using USB charging cable

Plug the USB charging cable into the USB-C charging port on the left earcup and any available USB port on your computer. It is recommended to charge the headset using the supplied Jabra charging cable, however it is possible to use a compatible charger.

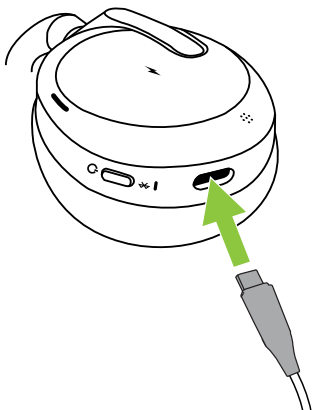

4.3 Power saving modes

The headset has two levels of power saving modes: nap mode and sleep mode.

NAP MODE

When the headset is powered on, but not being worn, it will automatically enter nap mode to conserve battery. To exit nap mode, simply wear the headset.

SLEEP MODE

When the headset has been in nap mode for 4 hours it will automatically enter sleep mode to further conserve battery. To exit sleep mode, simply press any button.

The length of time before the headset enters sleep mode can be adjusted using the Jabra Sound+ app on your smartphone or Jabra Direct on your computer.

After 24 hours of sleep mode, the headset will power down completely. To power the headset on, slide the On/Off switch to Off and then On.



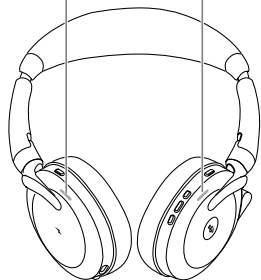

5. What the LEDs mean

Busylight LED









Busylight/Microsoft Teams LED

BUSYLIGHT/
MICROSOFT* LED

-  Busylight
-  Incoming call
-  (slow flash) Headset is trying to connect to Microsoft Teams. Will time out after 10 seconds*
-  (fast flash) Microsoft Teams notification*
-  Headset placed on wireless charging pad

STATUS LED

-  Power on/Battery full
-  Battery medium
-  Battery low
-  Battery critically low
-  Pairing mode
-  Resetting/Firmware updating
-  Headset placed on wireless charging pad

*requires Microsoft Teams headset variant

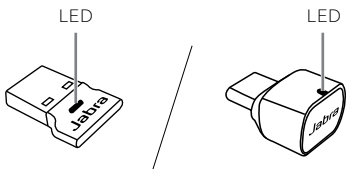

JABRA LINK 380 LED

- Microphone muted
- Plugged into computer and signed into Microsoft Teams*
- ⚡ (slow flash) Headset is trying to connect to Microsoft Teams. Will time out after 10 seconds*
- ⚡ (fast flash) Microsoft Teams notification*
- Bluetooth connection
- Streaming music/media
- Incoming call/Active call

*requires Microsoft Teams headset variant

6. How to connect

6.1 Connect to computer

Plug the supplied Jabra Link 380 into a USB port on your computer. The Jabra Evolve2 65 Flex and the Jabra Link 380 are pre-paired and ready for use out of the box. The Bluetooth range is up to 30 meters or 100 feet.

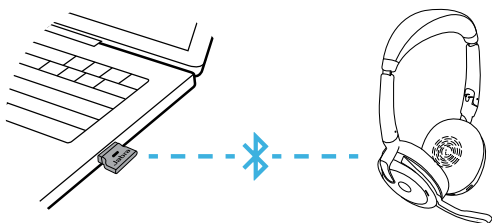

To hear audio in the headset you may need to select the Jabra Link 380 as the playback device in your operating system's audio settings.

To manually pair the Jabra Evolve2 65 Flex with the Jabra Link 380, download and use Jabra Direct.

6.2 Pair with a smartphone

1. Press and hold the **Power** button for 4 seconds until the LED flashes blue and you hear a pairing announcement in the headset.

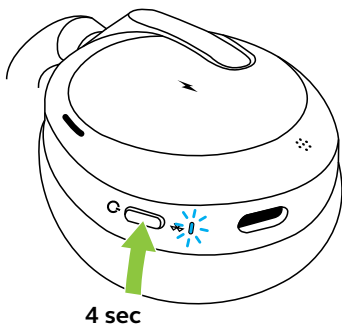

2. Go to the Bluetooth menu on your smartphone and select the Jabra Evolve2 65 Flex from the list of available devices.

When pairing with an Android device that has Google Fast Pair enabled, simply put the headset into pairing mode and you will be prompted on your nearby Android device if you wish to pair the headset.

7. How to use

Left

Right

Sound modes
button

Voice button

Call button
Microsoft Teams
button*

Power button

0 Volume up button

0 Play/pause button

0 Volume down button

*requires Microsoft Teams headset variant

7.1 Power the headset on/off

Press the **Power** button for 2 seconds to power the headset on or off.

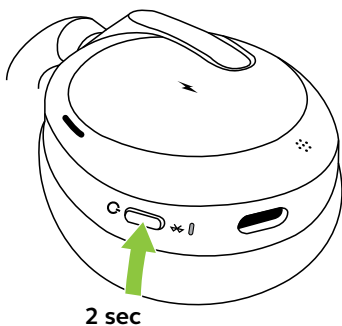

7.2 Calls & music

Right earcup Calls & music



Play/pause
music

Press the **Play/pause**
button



Answer call

Press the **Call** button

Alternatively, move
the microphone boom
arm down to answer an
incoming call

End call

Press the **Call** button

Reject call

Double-press the
Call button

Adjust volume	Press the Volume up or Volume down button, when listening to music or on a call
Next track	Press and hold (1 sec) the Volume up button
Restart track	Press and hold (1 sec) the Volume down button to restart the current track
Turn Busylight on/off	Press and hold twice to play the previous track
Hear battery and connection status	Press the Volume up and Volume down buttons at the same time. You will hear 'Busy' or 'Available' in the headset
Hear battery and connection status	Press the Volume up or Volume down button, when not listening to music or on a call

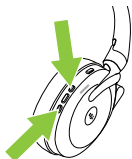

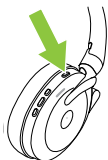

Activate Voice Assistant (i.e. Siri, Google Assistant, Amazon Alexa)

Press the **Voice** button, when not on a call

Mute/unmute microphone

Press the **Voice** button, when on a call

Alternatively, move the microphone boom arm up to mute, or down to unmute



Bring Microsoft Teams to foreground on computer

Press the **Microsoft Teams** button* (when signed into Microsoft Teams)

Join active Microsoft Teams meeting

Press the **Microsoft Teams** button* (when signed into Microsoft Teams)

View Microsoft Teams missed calls and voicemails

Press the **Microsoft Teams** button* (when signed into Microsoft Teams)

*requires Microsoft Teams headset variant

Left earcup

Sound modes

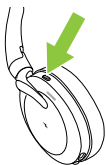

Cycle between ANC and HearThrough

Press the **Sound modes** button

Turn off Sound modes

Press and hold (1 sec) the **Sound modes** button

7.3 On-head detection

The Jabra Evolve2 65 Flex has sensors that detect when the headset is lying flat on a table or is being worn.

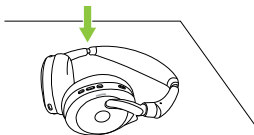
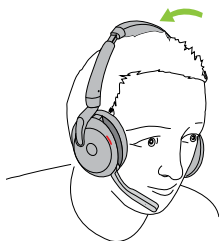

The sensors enable the following controls:

AUTO-PAUSE MUSIC

When listening to music, taking off the headset will automatically pause the music.

Wearing the headset again will automatically resume the music. To manually resume the music, press the Play/pause button on the headset.

*MICROSOFT TEAMS STATUS**

The Microsoft Teams status LED will only indicate Microsoft notifications when the headset is not being worn.

On-head detection can be configured using the Jabra Sound+ app on your smartphone or Jabra Direct on your computer.

*requires Microsoft Teams headset variant

7.4 Voice Assistant

The Jabra Evolve2 65 Flex enables you to speak to Siri, Google Assistant or Amazon Alexa on your smartphone using the **Voice** button.

Right earcup

Voice Assistant

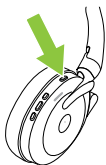

Activate Voice Assistant (Siri, Google Assistant, Amazon Alexa)

Press the **Voice** button, when not on a call

7.5 Busylights

The Busylights on the headset automatically light up red when you are on a call to indicate that you are busy.

To manually switch the Busylights on/off, press the Volume up and Volume down buttons at the same time.



Busylight settings can be configured using the Jabra Sound+ app on your smartphone or Jabra Direct on your computer.

7.6 Active Noise Cancellation (ANC)

Active Noise Cancellation (ANC) counters noise by detecting and analyzing the pattern of incoming sound and then generating an anti-noise signal to cancel noise out. As a result, you experience a reduced level of surrounding noise during music and calls.

Left earcup

ANC

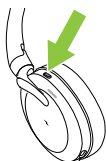

Cycle between
ANC and
HearThrough

Press the **Sound
modes** button

Turn off Sound
Modes

Press and hold (1 sec)
the **Sound modes**
button

The level of Active Noise Cancellation can be configured using the Jabra Sound+ app on your smartphone or Jabra Direct on your computer.

7.7 HearThrough™

HearThrough utilizes the built-in microphones to enable you to pay attention to your surroundings and engage in conversation without needing to remove the headset.

Left earcup	HearThrough	
	Cycle between ANC and HearThrough	Press the Sound modes button
	Turn off Sound Modes	Press and hold (1 sec) the Sound modes button

The level of HearThrough can be configured using the Jabra Sound+ app on your smartphone or Jabra Direct on your computer.

7.8 Mute/unmute using the microphone boom arm

The headset microphone can be muted by moving the microphone boom arm up, or unmuted by moving it down.

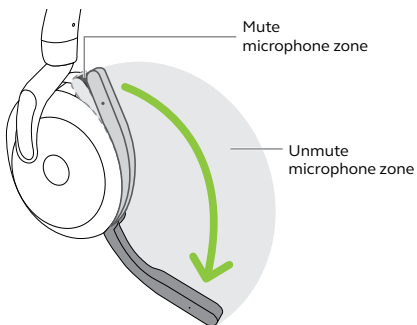

This feature is on by default, and can be disabled using Jabra Sound+ on your smartphone or Jabra Direct on your computer.

7.9 Answer call using the microphone boom arm

An incoming call can be answered by moving the microphone boom arm down.

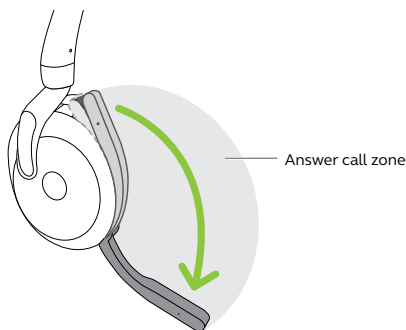

This feature is on by default, and can be disabled using Jabra Sound+ on your smartphone or Jabra Direct on your computer.

7.10 Multiuse

The headset can pair with up to eight Bluetooth devices and connect to two Bluetooth devices at once (e.g. the Jabra Link 380 and a Smartphone, or two Bluetooth devices). The headset can accept multiple incoming calls from either device.

To pair with two Bluetooth devices, use the normal pairing process separately for each Bluetooth device (refer to section 6.2).

Note: Voice assistant will be activated on the last connected Bluetooth device.

7.11 Multiple call handling

The headset can accept and handle multiple calls at the same time.

Right earcup	Multiple call handling	
	End current call and answer incoming call	Press the Call button
	Put current call on hold and answer incoming call	Hold (2 secs) the Call button*
	Switch between held call and active call	Hold (2 secs) the Call button*
	Reject incoming call, when on a call	Double-press the Call button

*Non-Microsoft Teams headset variant only

7.12 Audio notifications

Audio notifications indicate connection and battery status and announce pairing instructions. Audio notifications are enabled by default.

Right ear-
cup

Voice guidance

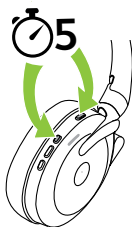

Turn audio
notifications
on/off

Press and hold
(5 sec) the **Voice**
button and the
Volume up button
until you hear an
announcement in the
headset

Audio notifications can be configured using the Jabra Sound+ app on your smartphone or Jabra Direct on your computer.

For the latest list of supported languages, refer to the Jabra Sound+ app or Jabra Direct.

7.13 How to reset

Resetting the headset clears the list of paired devices and resets all settings.

Right
earcup

Reset headset



Reset pairing
list and
settings

Ensure the headset is powered on and you are not on a call. Then press and hold (3 sec) the **Call** button and the **Volume up** button simultaneously until the LED lights up pink and you hear an announcement in the headset

You will need to re-pair the headset with the Jabra Link 380 using Jabra Direct, or with your Smartphone (see section 6.2)

8. Software and firmware

8.1 Jabra Sound+

Jabra Sound+ is a mobile application that allows you to configure the Jabra Evolve2 65 Flex based on your needs.



8.2 Jabra Direct

Jabra Direct is a desktop application designed to support, manage and enable optimal functionality for Jabra devices.



Download the latest free version from jabra.com/direct

8.3 Update firmware

Firmware updates improve performance or add new functionality to Jabra devices.

The headset firmware can be updated using either Jabra Direct on your computer or the Jabra Sound+ app on your smartphone. Both applications will notify you when a firmware update is available.

The Jabra Link 380 Bluetooth adapter firmware can be updated using Jabra Direct on your computer.

9. Support

9.1 FAQ

View the FAQs on Jabra.com/help/evolve2-65flex

9.2 How to care for your headset

- Always store the headset in the supplied pouch.
- To prevent the depletion of the battery lifetime or capacity, avoid storing the headset in hot or cold environments, such as a closed car in summer, or in winter conditions.
- It is recommended to keep the headset between -10°C and 55°C (14°F and 131°F).
- Do not store the headset for extended periods of time without recharging them (max. three months).